

Arboricultural Impacts: Summary
(For details, see below)

| Impact | No. of Trees |
|--|--------------|
| Trees to be removed | 0 |
| TPO trees to be removed | 0 |
| Trees to be pruned | 0 |
| Trees where manual excavation needed within RPAs | 0 |
| Trees where above soil surfacing needed within RPAs | 0 |
| Trees with proposed underground services within RPAs | 0 |

Protective trunk wrapping

Prior to commencement of works, protective wrappings shall be fitted to the trunks of trees nos. 2, 3, 4 & 5 to prevent accidental damage by impacts from materials or machinery during construction. The trunk wrappings (shown by blue circles) shall consist of not less than three thicknesses of hessian around each trunk, surmounted by an outer layer of either two rounds of chestnut paling fencing, or 50mm X 25mm sawn battens arranged vertically around the trunk at intervals of no greater than 100mm, and held in place with galvanised staples and tightened 5mm multi-strand fencing wire. The trunk wrappings shall extend from as close as possible to ground level, up to a minimum height of 2m above ground on each tree. They shall be retained in place for the duration of construction operations, and shall not be removed until all works are completed, and all equipment and materials are removed from site.

Arboricultural Supervision

The arboricultural consultant will directly supervise all construction works that have to be undertaken within root protection areas. These include:

1. Location of protective trunk wrapping.
2. Any excavations, whether for proposed foundations, hard surfacing or underground services.

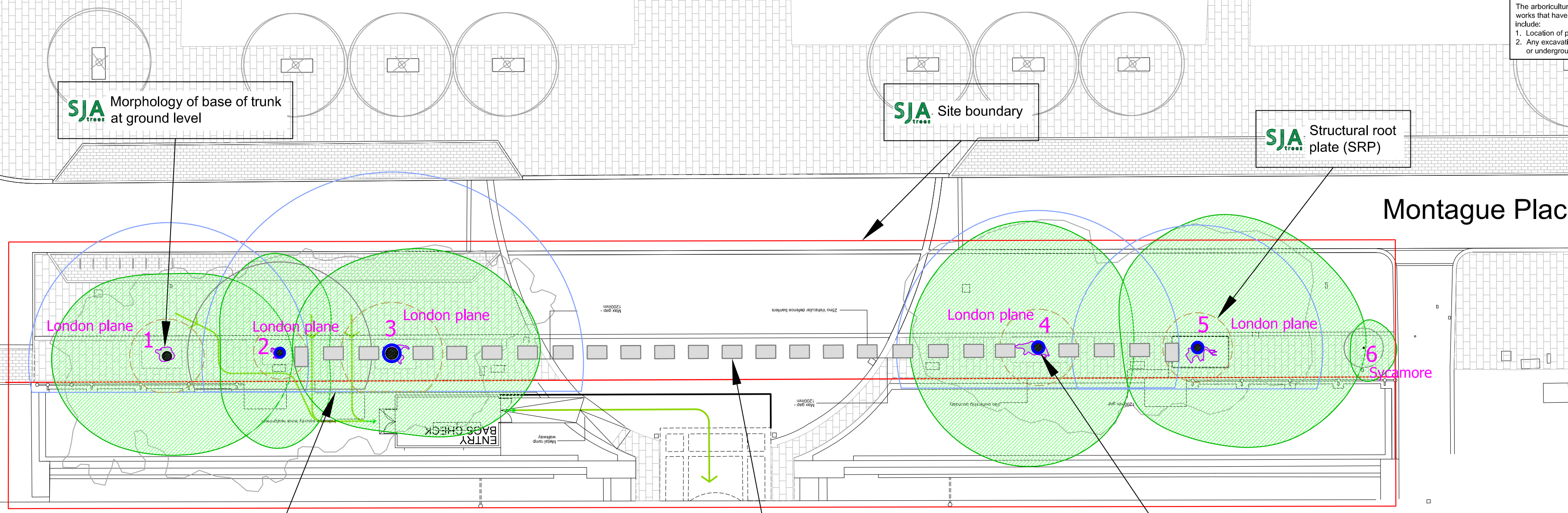

SJA Morphology of base of trunk at ground level

SJA Site boundary

SJA Structural root plate (SRP)

Montague Place

London plane 1

London plane 2

London plane 3

London plane 4

London plane 5

Sycamore 6

SJA Shape of Root Protection Area modified to reflect restriction to root growth by museum basement.

SJA Proposed security barriers to be installed above ground thereby obviating the need for manual excavation within root protection areas

SJA Protective trunk wrapping

SJA ARBORICULTURAL PLANNING CONSULTANTS

| | | |
|--------------------|---|-------------------|
| Project: | The British Museum, Montague Place, London WC1B | |
| Client: | The British Museum | |
| Drawing: | TREE PROTECTION PLAN | |
| Drawing No: | SJA TPP 18272-01 | Revision No: n/a |
| Based On: | 1914-JMP-xxxx-P-L-PROPOSAL-CTBlocks_1 | |
| Drawn By: | APH | Date: Nov 2018 |
| | | Scale: 1:250 @ A2 |
| Tel:(01737) 813058 | Fax:(01737) 816140 | sj@sjatrees.co.uk |

| | | | | | |
|-------------------|-----|-------------------|---|------------------------|---|
| Tree nos.: | ● 1 | Tree canopies: | ○ | Structural root plate: | ○ |
| Category 'B' RPA: | ○ | Category 'C' RPA: | ○ | Trunk wrapping: | ○ |

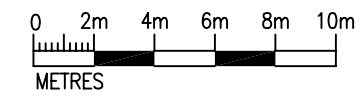

1 : 250 @A2

For further information refer to the SJAtrees Tree Survey Schedule. Do not scale from this drawing; please check all dimensions on site, and notify us of any discrepancies. SJAtrees (the trading name of Simon Jones Associates Ltd.) cannot be held responsible for inaccuracies in the topographical plan on which this drawing is based. © Simon Jones Associates Ltd. 2018. This drawing is copyright and may not be used or changed without the written consent of SJAtrees. This drawing is based on the proposed layout plan shown and referred to above. SJAtrees authorises its reproduction, without amendment, by the Local Planning Authority (LPA), and its posting on the LPA website, to assist in consideration of this application only. This drawing is designed to reflect only the principles of layout and/or design insofar as these relate to the protection of trees to be retained, and should NOT be read as a definitive engineering or construction method statement. Reference should be made to the architect or structural engineer, as appropriate, over any matters of construction detail or specification, or any engineering standards or regulatory requirements relating to proposed structures, hard surfaces or underground services.