

GATE HOUSE (GROUND FLOOR)

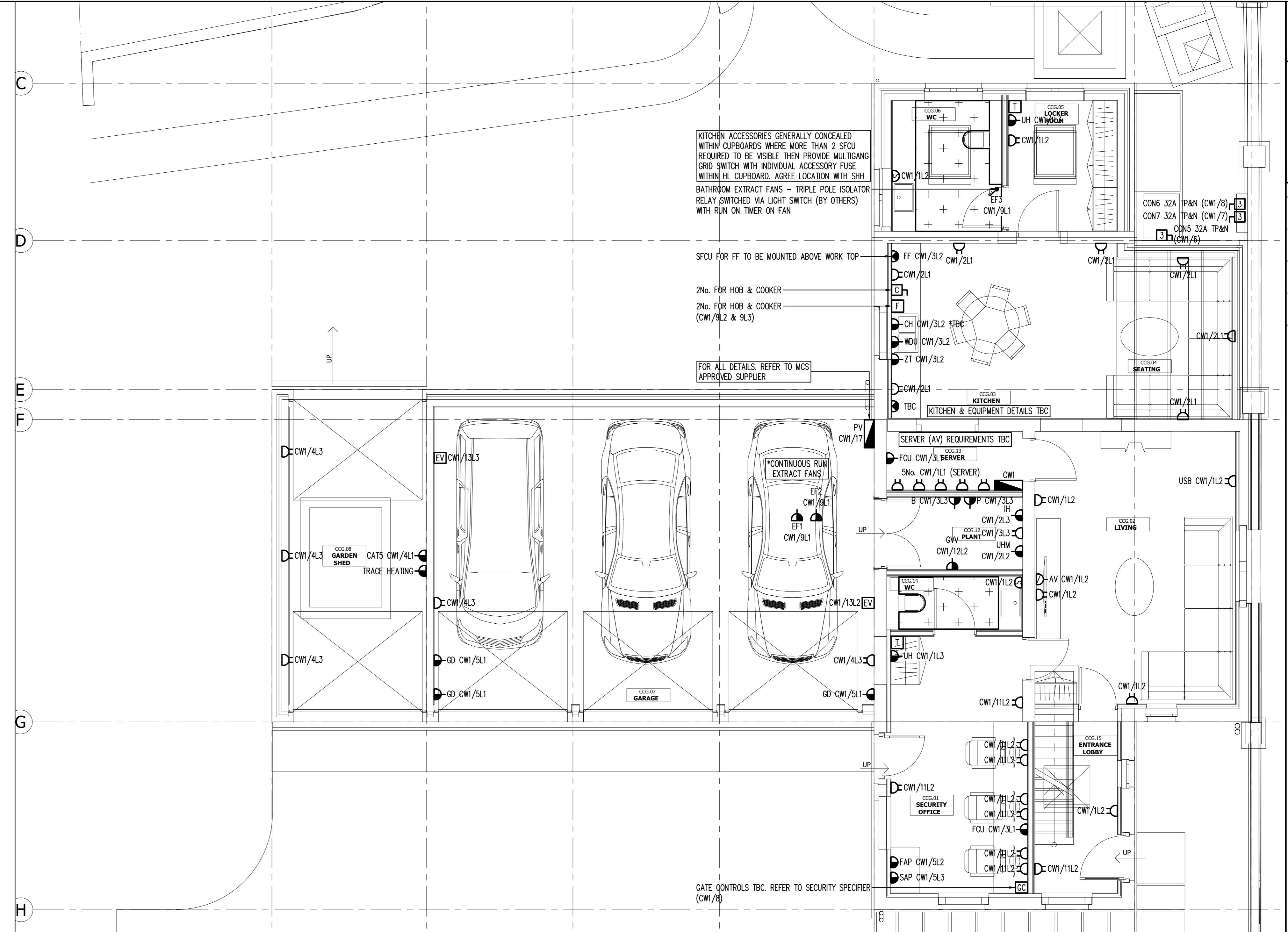

CAENWOOD COTTAGE (GROUND FLOOR)

- NOTES**
- ALL SETTING OUT REFER TO ARCHITECTS.
 - FINAL AV REQUIREMENTS TBC.
 - FINAL LIGHTING POWER SUPPLY REQUIREMENTS TBC.
 - EC TO CO-ORDINATE ALL WIRING ROUTES, CONTAINMENT REQUIREMENTS WITH OTHER TRADES.
 - FINAL KITCHEN EQUIPMENT SCHEDULES TBC.
 - MIRROR DIMENSIONS REFER TO LIGHTING CONTROLS FOR CIRCUIT REFERENCE.
 - SECURITY REQUIREMENTS TO CONFIRM FINAL REQUIREMENTS WITH SPECIALIST.
 - QUANTITY & LOCATION OF USB SOCKETS TBC BY SHH/CLIENT.

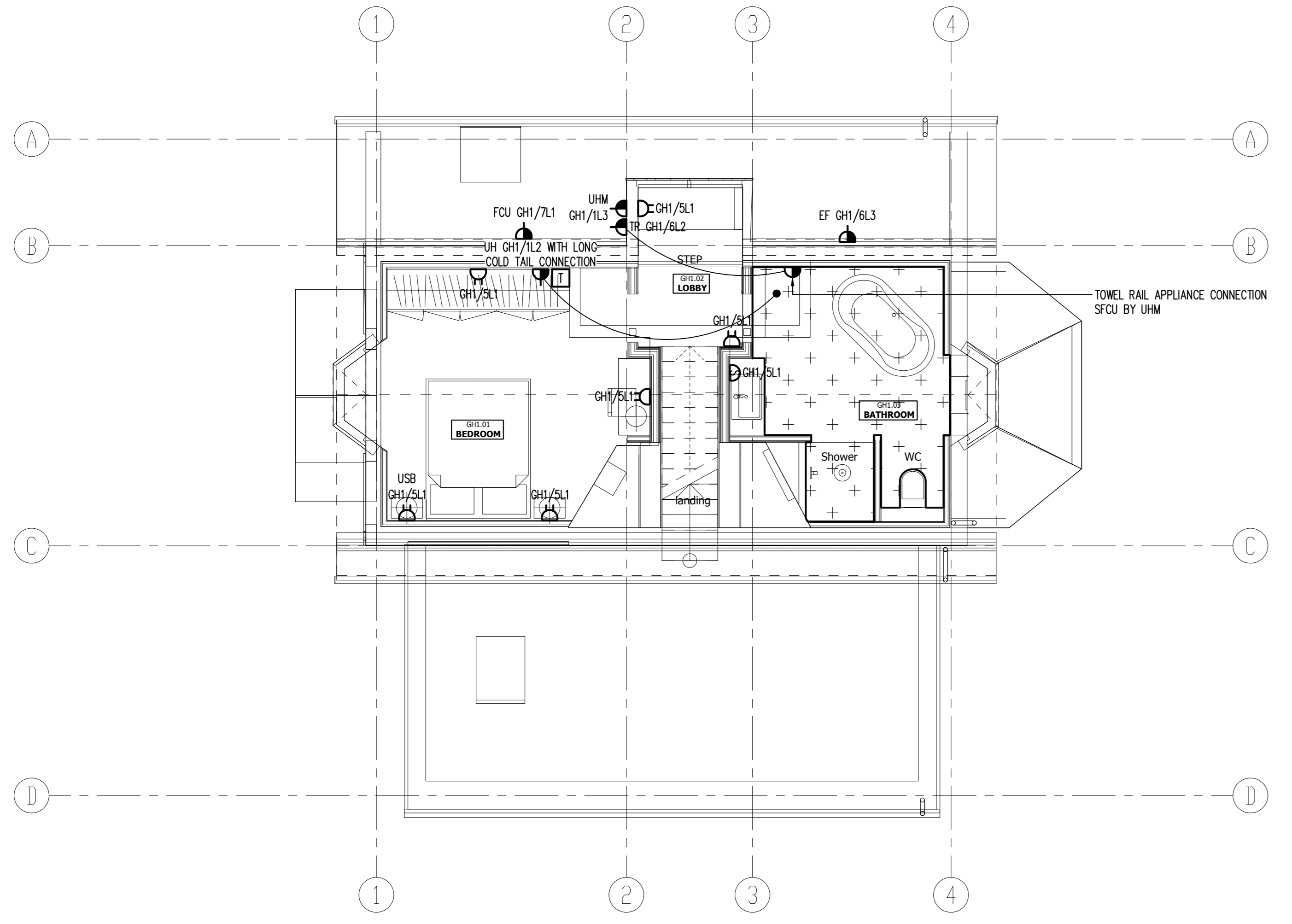

GATE HOUSE (FIRST FLOOR)

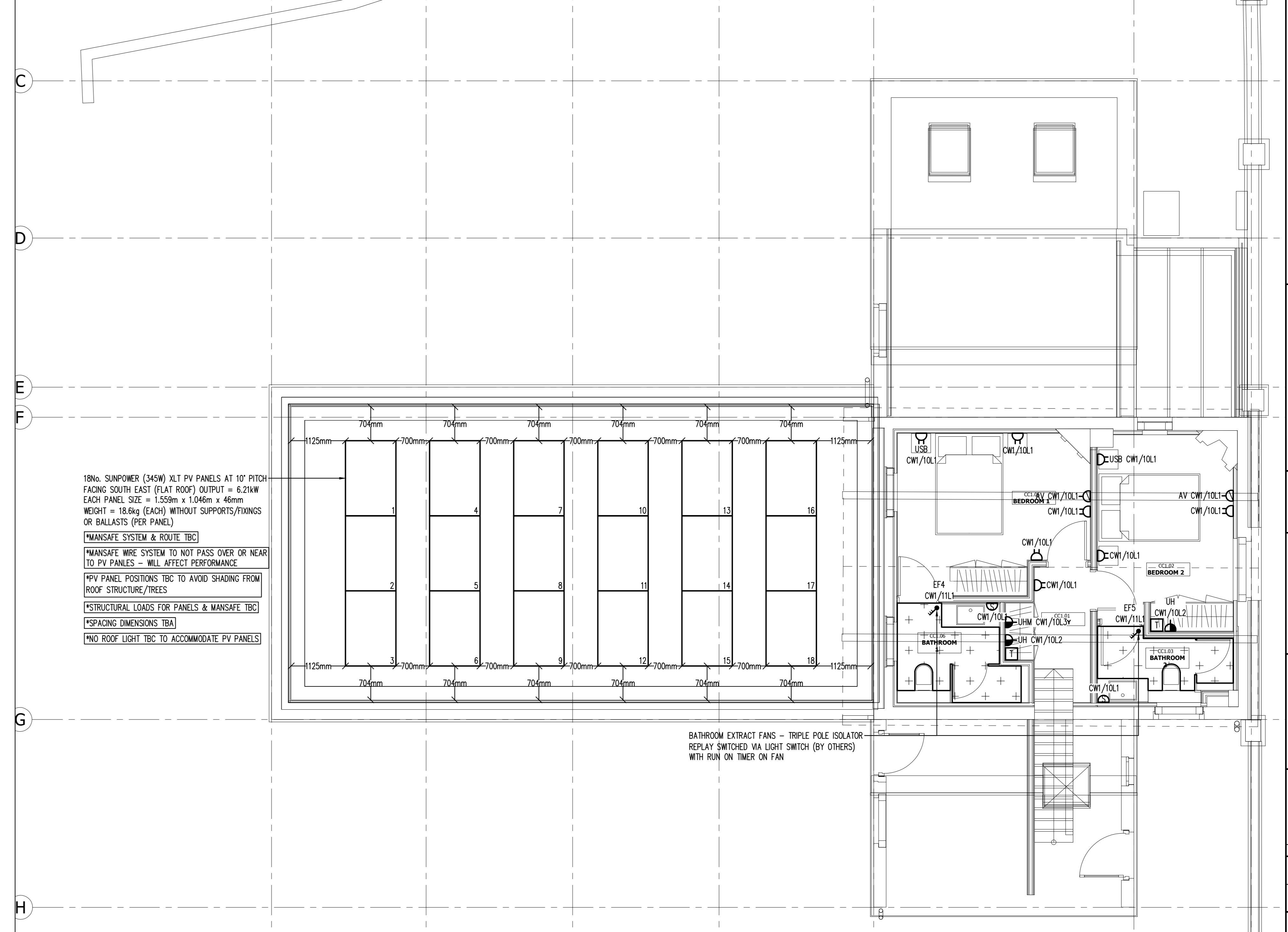

CAENWOOD COTTAGE (FIRST FLOOR)

Notes

ALL DIMENSIONS TO BE VERIFIED ON SITE BEFORE SETTING OUT OR MAKING ANY SHOP DRAWINGS. THE DRAWING IS TO BE READ IN CONJUNCTION WITH THE CONSULTANT ENGINEER'S SPECIFICATION.

Orientation

Rev./Date	REVISIONS
P 03.07.17	STAGE 3 ISSUE
P1 06.04.18	REDRAWN
T 21.05.18	STAGE 1 TENDER ISSUE
C 23.05.18	CONTRACT ISSUE

ME7

ME7 Ltd.
 Jorand House, Bebington Close,
 Billericay, Essex, CM12 0DT
 Email: info@me7.eu
 Web: www.me7.eu
 Tel: +44(0)1277 353225
 M&E Consultants Energy Consultants

ace
www.ace.net.co.uk

ANCILLARY BUILDINGS
SMALL POWER SERVICES

Project
ATHLONE HOUSE
HAMPSTEAD LANE
HAMPSTEAD
LONDON, N6 4RU

Architect
SHH Architects
1 Vincourt Place
Riverscourt Park
Hammersmith, London, W6 9NU
+44 (0) 20 8600 4171

Scale	Drawn	KW / CA
AD @ 1:50		
Date	Checked	KW
July 2017		

Project No.	Services	Eng No.	Rev.
633	E	7	C