



Mr John Diver

London Borough of Camden
Town Hall
Judd Street
London
WC1H9JE

Application Ref: 2017/1328/P

35 Flask Walk
London
NW3 1HH

25 October 2018

Method statement for discharge of condition no. 5 to full Granted Planning Permission to a Section 106 Legal Agreement

Following granting of full planning permission for the “Alterations to Grade II listed dwelling including the extension and alterations to rear garden annex, construction of a covered walkway in the garden courtyard; alterations to fenestrations; replacement boundary treatment to front and side and minor alterations to main dwelling”, we have been requested details demonstrating how trees to be retained shall be protected during construction work.

In regards to the protection measures for the above tree and in compliance with British Standard BS 5837:2012 we hereby state the below:

Feasibility: Survey & constraints

- No trees are located within the site.
- A silver birch tree (*Betula Pendula*) with stem diameter of approximately 170mm is located adjacent to the site on Lakis Close, a private road.
- The crown spread of this silver birch tree is not overhanging the site.
- Soil assessment: not applicable, as not on the site.
- Root protection area (RPA): is calculated as $12 \times 170\text{mm} = 2040\text{mm}$ radius. This area overshadows the existing building of the site slightly. – See *graphic 1*

Proposals: conception and design

- The tree does not affect the site – no constraints imposed by the tree.
- RPA – No groundwork’s are planned within the RPA of the tree – no constraints imposed by the tree.
- No direct obstruction or sunlight loss will occur
- The tree is within a conservation area
- Working space needed for construction: The canopy of the tree does not overhang the site. The repair to the flat roof at the studio will not affect it. The contractor does not require scaffolding outside the site boundaries. The contractor has no permission to access Lakis Close.

Tree protection plan:

- A tree protective barrier 1m of height as shown in *graphic 2* will be erected on roof level of the site to protect building materials to fall onto the tree or construction activity to damage the roof canopy.
- The contractor installing the barrier will be the main contractor Amirilan.
- Site monitoring: whenever development activity on the roof of the studio will take place the works will be monitored by the site manager.
- Site works: no groundwork's are planned within the RPA of the tree.

We trust the above measures will be satisfactory to ensure that the development will not have any adverse effect on the existing tree and that the character and amenity of the area is maintained.

Yours faithfully,

Thomas Griem

Director
TG-Studio

Graphic 0.1

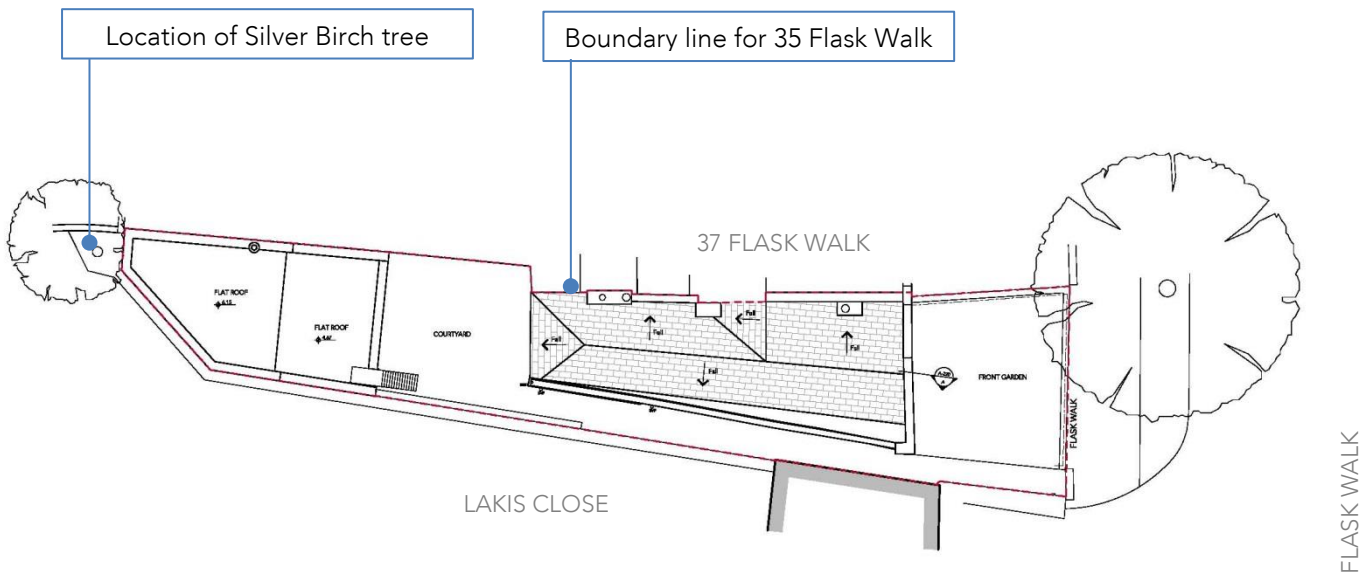

Graphic 0.2

