

Do Not Scale.
All Figured Dimensions To Be Checked On Site Prior To Construction.
All Copyright Reserved.

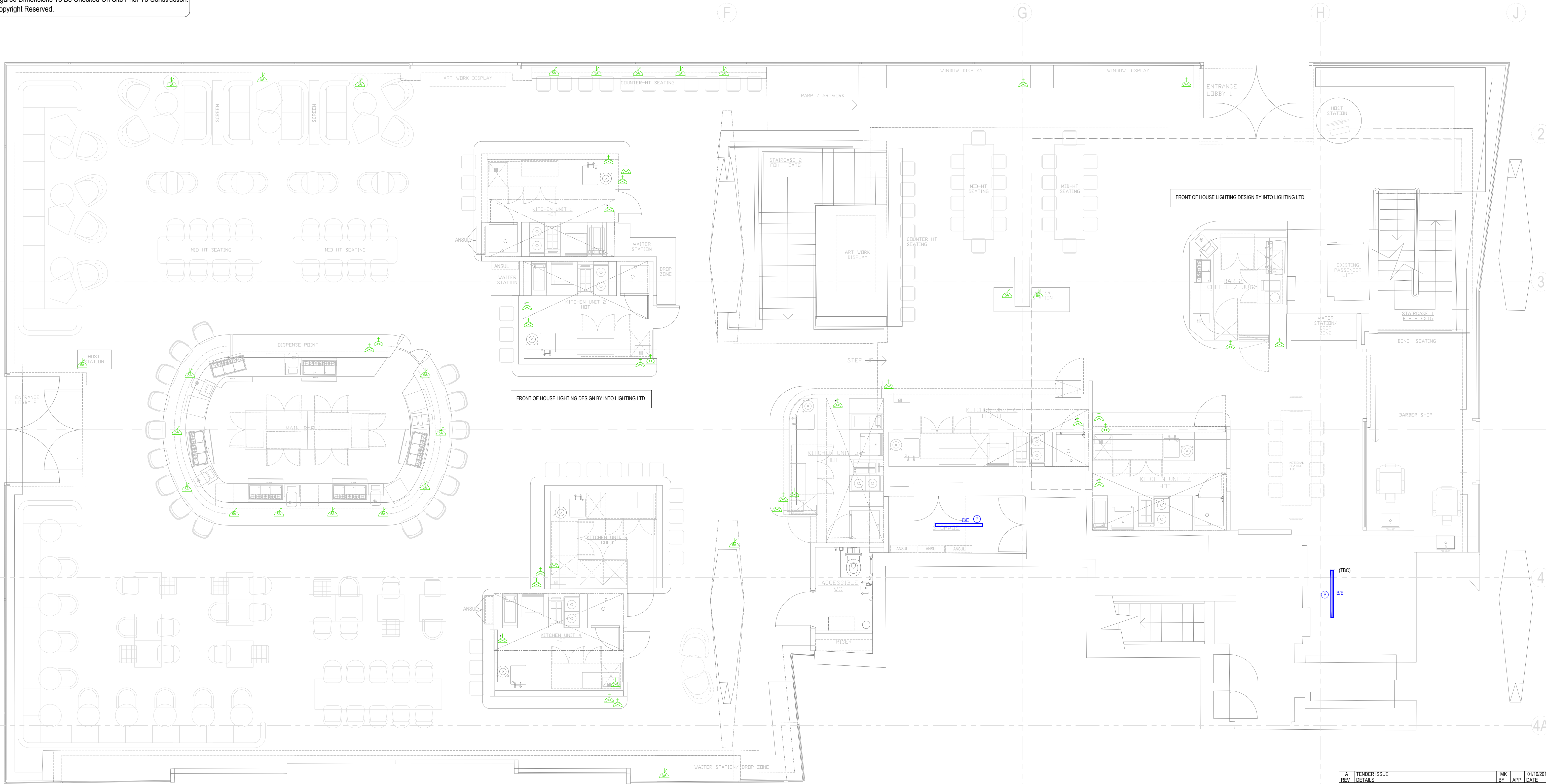

GENERAL NOTES

DRAWING TO BE READ IN CONJUNCTION WITH THE INSTALLATION SPECIFICATION AND ALL OTHER RELEVANT DRAWINGS.

ALL WIRING AND ELECTRICAL WORKS TO BE INSTALLED IN ACCORDANCE WITH BS7671 THE IET WIRING REGULATIONS 18th EDITION & LATEST AMENDMENTS.

ALL EARTHING AND BONDING SHALL BE PROVIDED IN ACCORDANCE WITH BS7671 THE IET WIRING REGULATIONS 18th EDITION & LATEST AMENDMENTS. IN ADDITION THE SUSPENDED GRID CEILINGS REQUIRE SUPPLEMENTARY EARTHING EVERY 100m².

ALL ESCAPE LIGHTING TO COMPLY WITH BS5266 & EN 1838.

ALL EXIT SIGNS TO COMPLY WITH BS5499 PART 1:2013.

ALL CABLING AND CONTAINMENT TO BE LSOH TO BS EN 50267-2-1, BASEC MARKED AND BS EN 50525-3-11 COMPLIANT.

ALL WIREWAYS TO BE CONCEALED WITHIN THE BUILDING FABRIC, EXCEPT IN RISERS, CEILING VOIDS AND FLOOR VOIDS.

UNLESS OTHERWISE INDICATED ACCESSORIES FINISH TO BE FLUSH MOUNTED WHITE PLASTIC IN ALL AREAS EXCEPT IN PLANT AREAS WHICH SHALL BE SURFACE METAL CLAD.

ALL LAMPS SHALL BE COOL WHITE COLOUR UNLESS OTHERWISE STATED.

ALL LIGHTS TO BE CONNECTED USING PLUG-IN CEILING ROSES UNLESS OTHERWISE STATED.

ALL EMERGENCY LIGHTING AND EXIT LIGHTS TO BE CABLED FROM NEAREST LIGHTING CIRCUIT WHEN NO SPECIFIED CIRCUIT SHOWN.

ALL SERVICES/ROUTES THROUGHOUT BUILDING TO BE FULLY CO-ORDINATED ON SITE PRIOR TO INSTALLATION.

A1

NOTE:

ALL WIRING AND INSTALLATION, TESTING & COMMISSIONING IS BY ELECTRICAL CONTRACTOR INCLUDING ANY FF&E FITTINGS. ALL LIGHTING WIRED VIA DIMMER RACKS UNLESS OTHERWISE INDICATED.

FRONT OF HOUSE LIGHTING DESIGN BY INTO LIGHTING LTD.; REFER TO INTO LIGHTING DRAWINGS & SCHEDULES. PC SUM ALLOWED IN TENDER FOR SUPPLY.

LEGEND:
SUPPLY, WIRING AND INSTALLATION BY ELECTRICAL CONTRACTOR

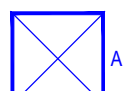

600x600 MODULAR RECESSED LED HF IP65 KITCHEN SAFE, COLOUR CORRECT, LUMINAIRE AS PER EATON MODUSEAL 2 LED OR EQUAL AND APPROVED.



LED LINEAR 1200mm HF IP66 IK08 MIN RATED BATTEN LUMINAIRE c/w POLYCARBONATE DIFFUSER, AS PER COOPER TUFFLITE LED OR EQUAL AND APPROVED. B/E DENOTES EMERGENCY VERSION c/w 3 HR BATTERY BACKUP.



LED LINEAR 43W 1200mm HF BATTEN LUMINAIRE AS PER EATON COOPER VARSITY LED.

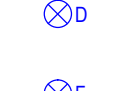

32W RECESSED LED DOWNLIGHT AS PER TRILUX INPERLA OR EQUAL AND APPROVED.



LED HIGH OUTPUT HIGH EFFICIENCY SURFACE WALL / CEILING MOUNTED UTILITY LUMINAIRE AS PER EATON CAIS OR EQUAL AND APPROVED.



3W LED EMERGENCY LUMINAIRE AS PER EATON COOPER HALO-PACK 2 OR EQUAL AND APPROVED.



EXTERNAL BULKHEAD LED EMERGENCY MAINTAINED LUMINAIRE



LED DIRECTIONAL EMERGENCY EXIT LUMINAIRE TO c/w APPROPRIATE RUNNING MAN SIGNAGE TO EN 1838. 'D' DENOTES DOUBLE SIDED.



PIR PRESENCE SENSOR



20A LOCAL SWITCH



20A LOCAL 2 WAY SWITCH



EMERGENCY LIGHTING KEY TEST SWITCH



I-LIGHT, UNLESS OTHERWISE SPECIFIED BY SPECIALIST DESIGNER, DIMMING RACK c/w 365 DAY ASTRO TIME CLOCK. NUMBER OF RACKS TO BE DETERMINED.



LOCAL LIGHTING CONTROL PANEL - No & FINITE LOCATIONS T.B.C.



POWER SUPPLY FOR LIGHTING TO CANOPY / JOINERY ETC. NOTE: CANOPY TO INCLUDE EMERGENCY LIGHTING, TO BE INCORPORATED INTO EMERGENCY LIGHTING TESTING AND CERTIFICATION.



6A OUTLET FOR TABLE LAMP / FLOOR LAMP ETC. REFER INTO LIGHTING LTD DRAWINGS.

A	TENDER ISSUE	MK	01/10/2018
REV	DETAILS	BY	APP DATE

CLIENT:

STREET MARKETS LTD

PROJECT:

CENTRE POINT, LINK BLDG, W1

DRAWING TITLE:

GROUND FLOOR, LEVEL 0

LIGHTING INSTALLATION

DRAWN BY:	M.KNOTT	APPROVED BY:	DATE:
PROJECT No.:	L2171	DRAWING No.:	E006
		SCALE:	1:50

LSD

LEHNDING SERVICES DESIGN LTD

Unit 10, 10 Redlands Crescent, Larn, Co. Antrim, N.Ireland. BT40 1FF. Tel. +44(0) 2828 277 123.
Global House, Ashley Avenue, Epsom, London. KT18 5AD. Tel. +44(0) 1372 253 207.
Web: www.lehnding.co.uk Email: info@lehnding.co.uk