

notes:
The contractors are to check all dimensions, drain runs and general conditions on site before works commence, and inform Akelius immediately upon discovery of any errors, omissions or discrepancies.
All works are to be carried out in accordance with current building regulations, British standards, codes of practice and local authority requirements.

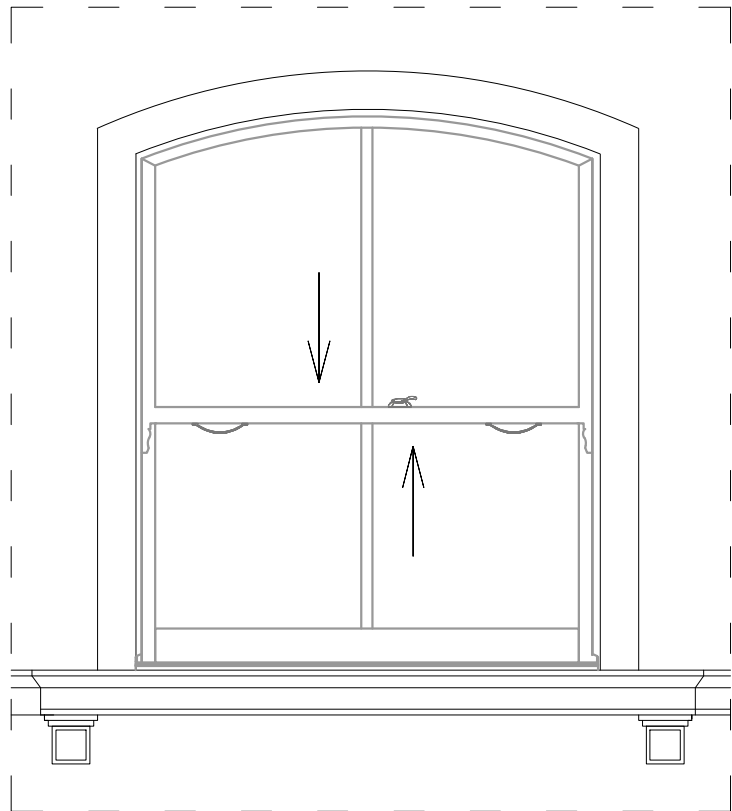

1 TYPE 66 C ELEVATION



2 TYPE 66 C PLAN

Structural glazing bars
to match existing

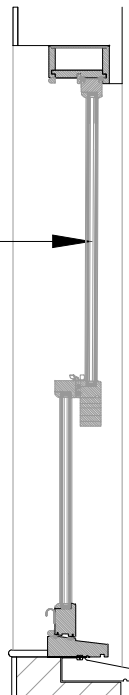

3 TYPE 66 C SECTION

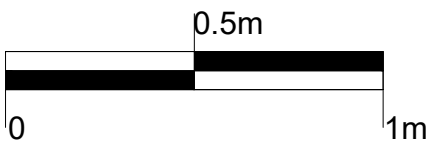

Revisions		
26/10/18 - A	66&72BL-10/07/2018 - PL 04 A	Structural Glazing bars
29/10/18 - A	66&72BL-10/07/2018 - PL 04 B	Structural Glazing bar amendment

The contents of this plan including the printed notes are copyright. Reproduction in whole or part is not permitted without prior consent of Akelius in writing.

Project
66 & 72 Belsize Lane,
London
NW3 5BJ

Drawing Title
Proposed Front Window
Type 66C

Scale	Drawn by	Checked by
A3@1:20	P.M	S.A