

Notes:

- Final Measurements to be taken by manufacturer on site prior to manufacture.
- Ironmongery - Refer to schedule for all types Refer to 5370-5372 for Typical Louvre Screen Details.
- Specification Reference 25-55-45/170
- Upstand detail and steel posts to be by SE, not part of louvre package
- Please note that a specific system has been drawn at this stage to be read in conjunction with Alps proposals
- Openings for ductwork/service routes to be co-ordinated with MEP engineers prior to manufacture.

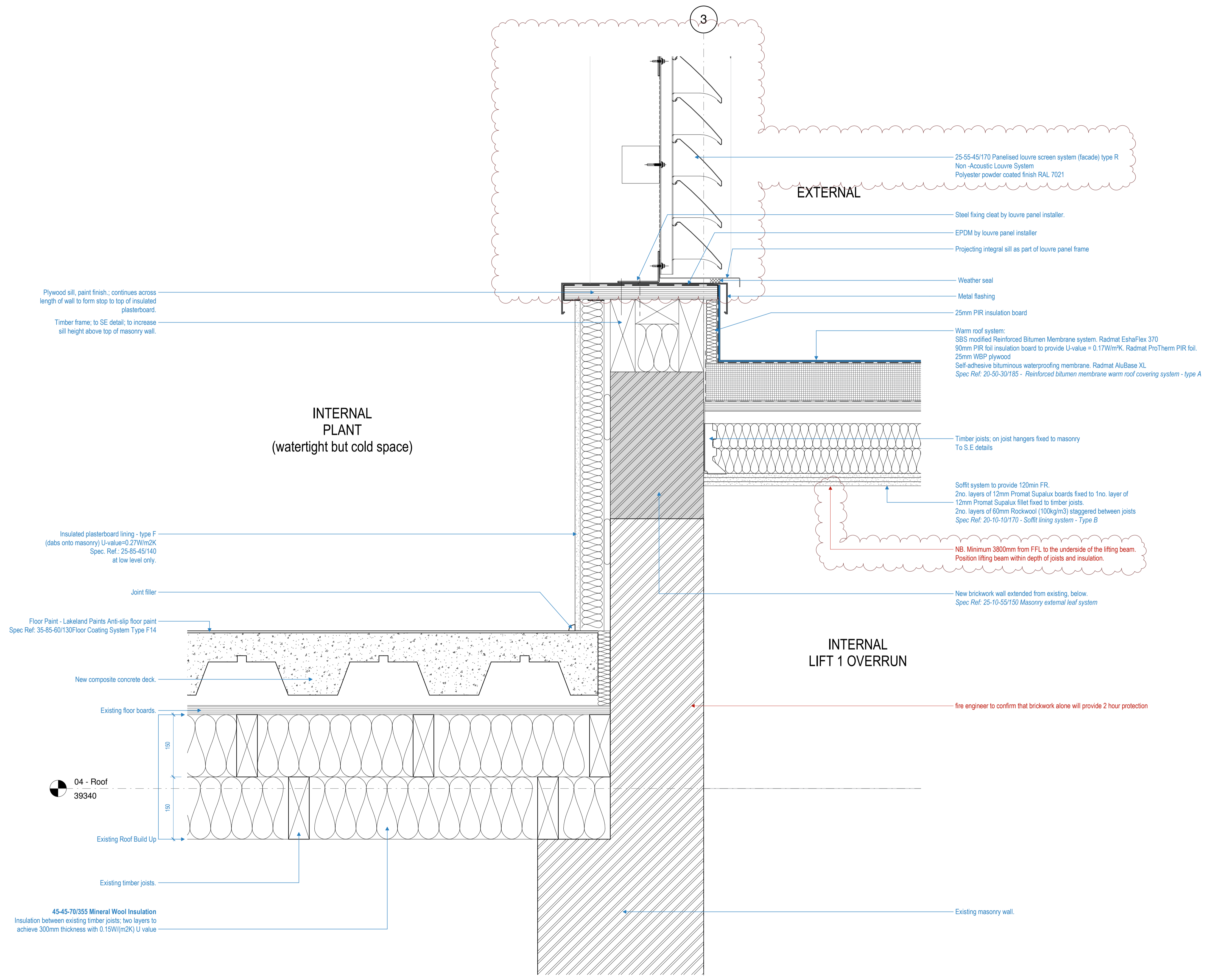

C1	19.09.18	First Construction Issue - Louvres -MJF	LM
A12	25.06.18	REVISED STAGE 4 ISSUE / LM / MJF	LM
A7	07.02.18	STAGE 4 SUBMISSION/ LM	AML

Rev	Date	Details/ Amended by	Sign
-----	------	---------------------	------

**sonnemanntoon architects**

Quality House  
6-9 Quality Court  
Chancery Lane  
London WC2A 1HP  
United Kingdom

tel: +44 (0)20 7580 8881  
email: info@st-arch.co.uk  
web: www.st-arch.co.uk

© This drawing is copyright

Do not scale this drawing. Architect to be informed of all discrepancies in dimensions. Contractor to check all dimensions on site.

Project title  
**ITALIAN HOSPITAL**

Drawing title  
**DETAIL**  
**Lift overrun/ plant room wall junction**

Scale Status Revision  
1: 50 @A1 CONSTR. C1  
1: 100 @A3

Drawing number  
**1615-ST-Q1-04-DR-A-5116**