

B

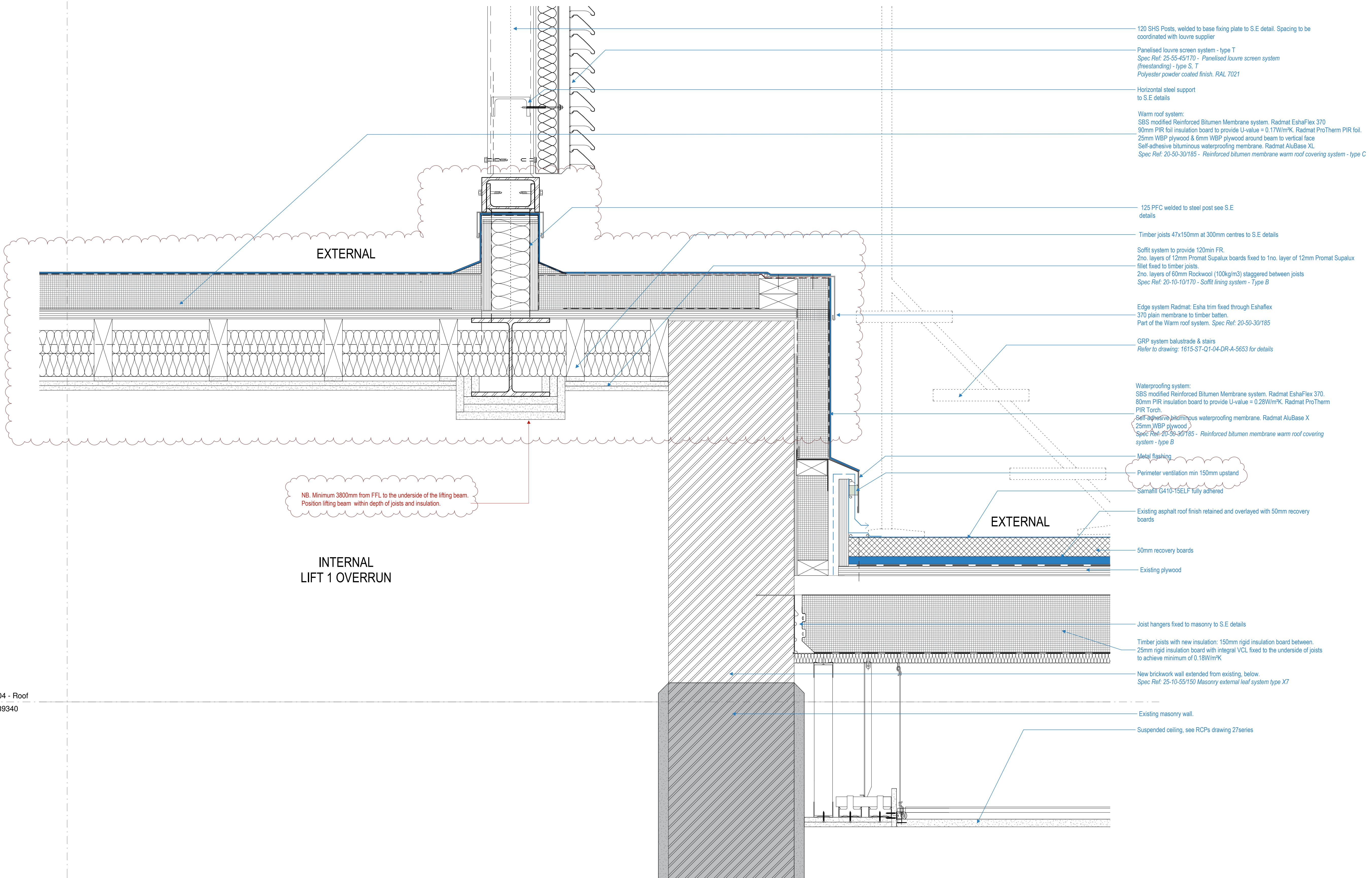

NB. Minimum 3800mm from FFL to the underside of the lifting beam.
Position lifting beam within depth of joists and insulation.

- 120 SHS Posts, welded to base fixing plate to S.E detail. Spacing to be coordinated with louvre supplier
- Panelised louvre screen system - type T
Spec Ref: 25-55-45/170 - Panelised louvre screen system (freestanding) - type S, T
Polyester powder coated finish, RAL 7021
- Horizontal steel support to S.E details
- Warm roof system:
SBS modified Reinforced Bitumen Membrane system, Radmat EshaFlex 370
90mm PIR foil insulation board to provide U-value = 0.17W/m²K, Radmat ProTherm PIR foil.
25mm WBP plywood & 6mm WBP plywood around beam to vertical face
Self-adhesive bituminous waterproofing membrane, Radmat AluBase XL
Spec Ref: 20-50-30/185 - Reinforced bitumen membrane warm roof covering system - type C
- 125 PFC welded to steel post see S.E details
- Timber joists 47x150mm at 300mm centres to S.E details
- Soffit system to provide 120mm FR:
2no. layers of 12mm Promat Supalux boards fixed to 1no. layer of 12mm Promat Supalux fillet fixed to timber joists.
2no. layers of 60mm Rockwool (100kg/m³) staggered between joists
Spec Ref: 20-10-10/170 - Soffit lining system - Type B
- Edge system Radmat: Esha trim fixed through Eshaflex 370 plain membrane to timber batten.
Part of the Warm roof system. Spec Ref: 20-50-30/185
- GRP system balustrade & stairs
Refer to drawing: 1615-ST-Q1-04-DR-A-5653 for details
- Waterproofing system:
SBS modified Reinforced Bitumen Membrane system, Radmat EshaFlex 370.
80mm PIR insulation board to provide U-value = 0.28W/m²K, Radmat ProTherm PIR Torch.
Self-adhesive bituminous waterproofing membrane, Radmat AluBase X
25mm WBP plywood
Spec Ref: 20-50-30/185 - Reinforced bitumen membrane warm roof covering system - type B
- Metal flashing
- Perimeter ventilation min 150mm upstand
- Samafill G410-15ELF fully adhered
- Existing asphalt roof finish retained and overlaid with 50mm recovery boards
- 50mm recovery boards
- Existing plywood
- Joist hangers fixed to masonry to S.E details
- Timber joists with new insulation: 150mm rigid insulation board between. 25mm rigid insulation board with integral VCL fixed to the underside of joists to achieve minimum of 0.18W/m²K
- New brickwork wall extended from existing, below.
Spec Ref: 25-10-55/150 Masonry external leaf system type X7
- Existing masonry wall.
- Suspended ceiling, see RCPs drawing 27series

- Notes:**
- 1 Final Measurements to be taken by manufacturer on site prior to manufacture.
 - 2 Ironmongery - Refer to schedule for all types. Refer to 5370-5372 for Typical Louvre Screen Details.
 - 3 Specification Reference 25-55-45/170
 - 4 Upstand detail and steel posts to be by SE, not part of louvre package
 - 5 Please note that a specific system has been drawn at this stage to be read in conjunction with Alps proposals
 - 6 Openings for ductwork/service routes to be co-ordinated with MEP engineers prior to manufacture.

04 - Roof
39340

C Lift 1 - Section C
5114 1:5

C1	19.09.18	First Construction	Issue - LM
A12	25.06.18	REVISED STAGE 4 ISSUE / LM / MJF	LM
A7	07.02.18	STAGE 4 SUBMISSION/ LM	AML

Rev	Date	Details/ Amended by	Sign
-----	------	---------------------	------

sonnemanntoon
architects

Quality House
6-9 Quality Court
Chancery Lane
London WC2A 1HP
United Kingdom
tel: +44 (0)20 7580 8881
email: info@st-arch.co.uk
web: www.st-arch.co.uk
© This drawing is copyright

Do not scale this drawing. Architect to be informed of all discrepancies in dimensions. Contractor to check all dimensions on site.

Project title
ITALIAN HOSPITAL
Drawing title
DETAIL
Lift 1 overrun
Scale Status Revision
1:5 @A1 CONSTR. C1
1:10 @A3
Drawing number

1615-ST-Q1-04-DR-A-5114

