

Notes:

- 1 Final Measurements to be taken by manufacturer on site prior to manufacture.
- 2 Ironmongery - Refer to schedule for all types Refer to 5370-5372 for Typical Louvre Screen Details.
- 3 Specification Reference 25-55-45/170
- 4 Upstand detail and steel posts to be by SE, not part of louvre package
- 5 Please note that a specific system has been drawn at this stage to be read in conjunction with Alps proposals
- 6 Openings for ductwork/service routes to be co-ordinated with MEP engineers prior to manufacture.

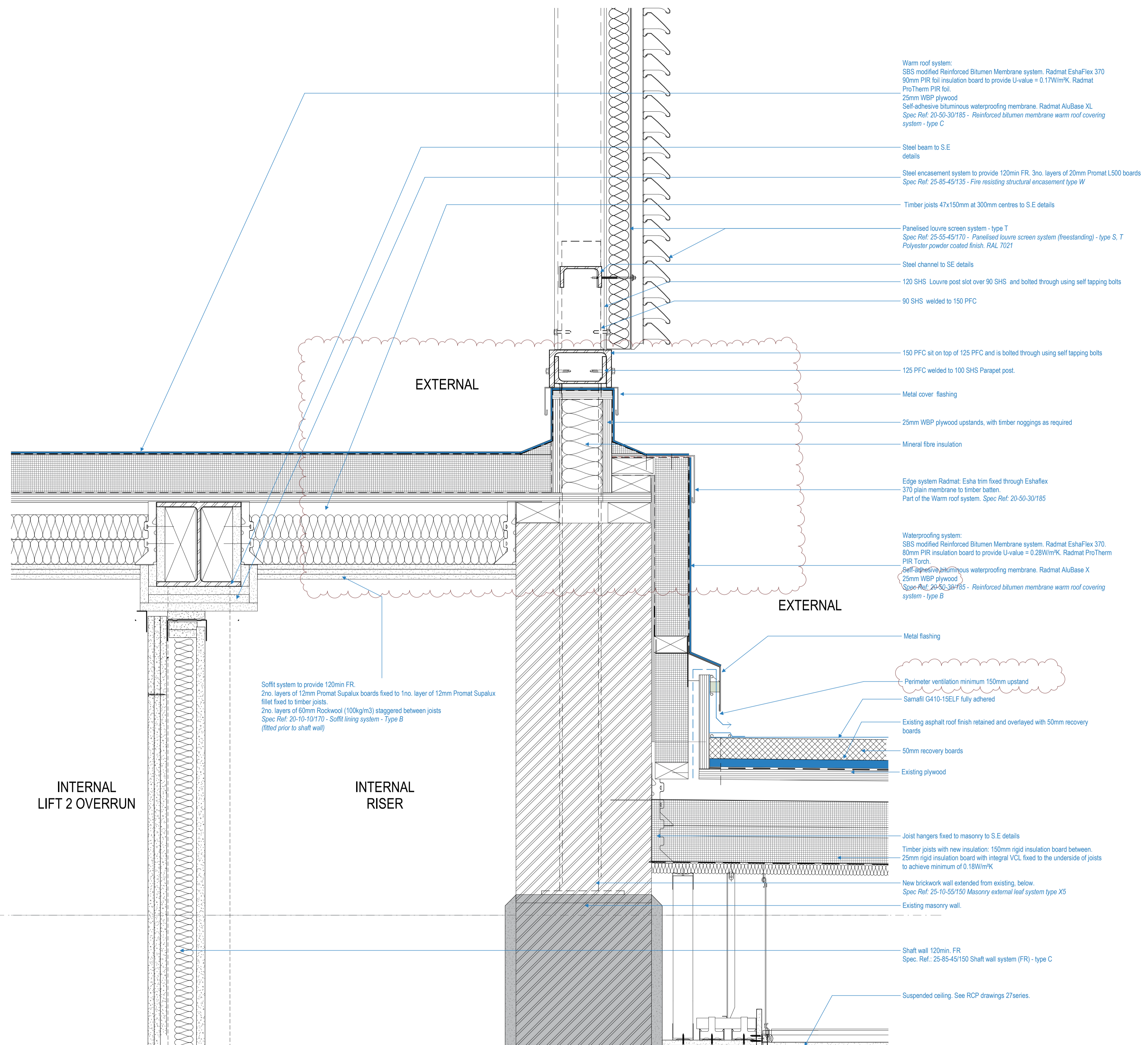

04 - Roof  
39340

A  
5112 Lift 2 Overrun - Section A  
1 : 5

C1	19.09.18	First Construction Issue - Louvres -MJF	LM
A12	25.06.18	REVISED STAGE 4 ISSUE / LM / MJF	LM
A7	07.02.18	STAGE 4 SUBMISSION/ LM	AML

Rev	Date	Details/ Amended by	Sign
-----	------	---------------------	------

**sonnemanntoon**  
architects

Quality House  
6-9 Quality Court  
Chancery Lane  
London WC2A 1HP  
United Kingdom

tel: +44 (0)20 7580 8881  
email: info@st-arch.co.uk  
web: www.st-arch.co.uk

© This drawing is copyright

Do not scale this drawing. Architect to be informed of all discrepancies in dimensions. Contractor to check all dimensions on site.

Project title  
ITALIAN HOSPITAL

Drawing title  
DETAILS  
Lift 2 overrun

Scale	Status	Revision
1:5 @A1	CONSTR.	C1
1:10 @A3		

Drawing number  
1615-ST-Q1-04-DR-A-5112

