

Key

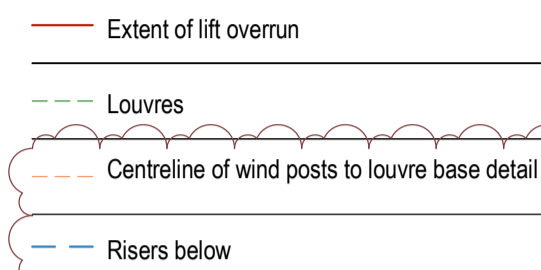

Notes

- Louvre thickness has not been modelled as per subcontractor information. Linework and dimensions on this drawing to be used for setting out. Refer to M&E drawings for plant layouts
-

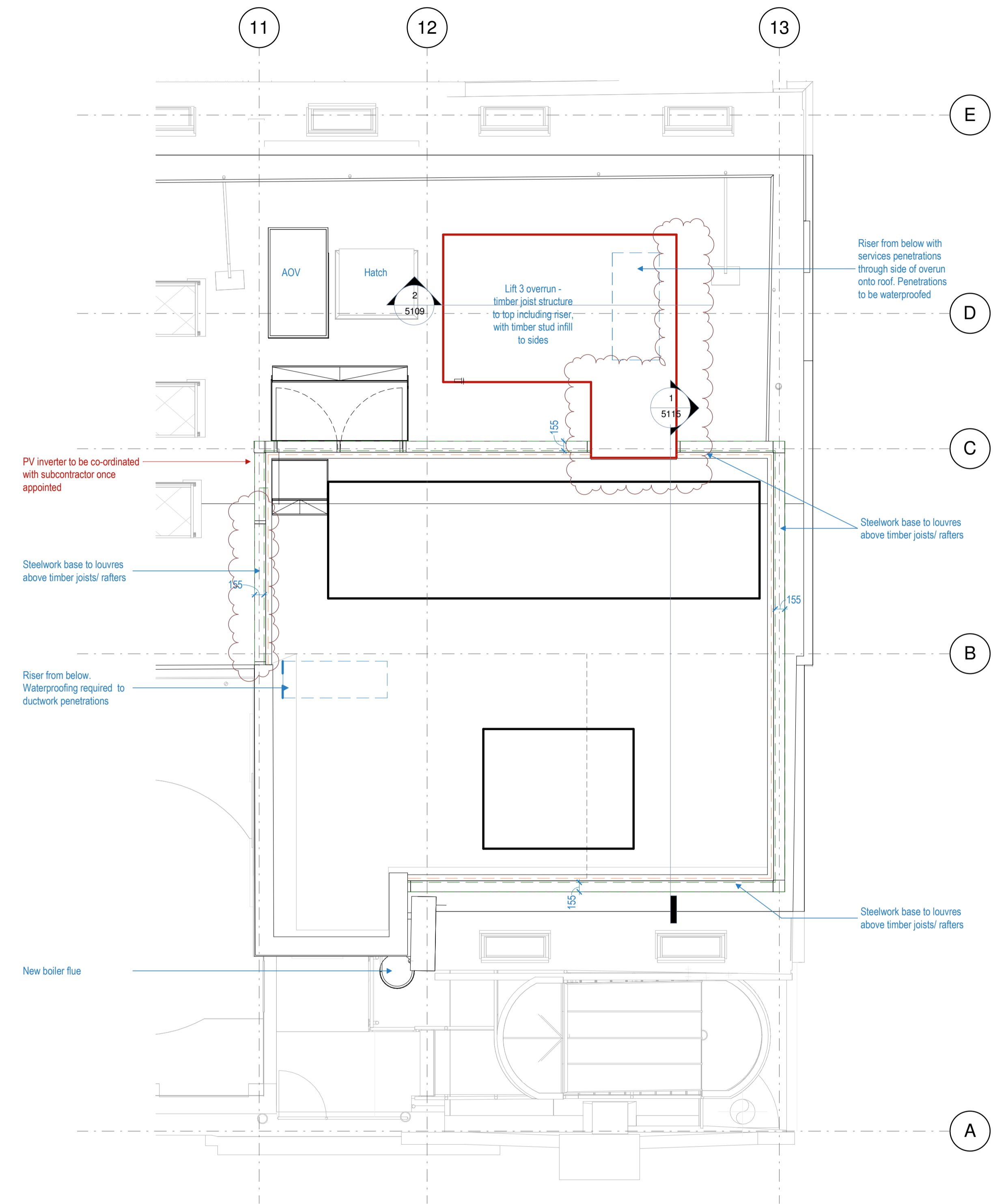
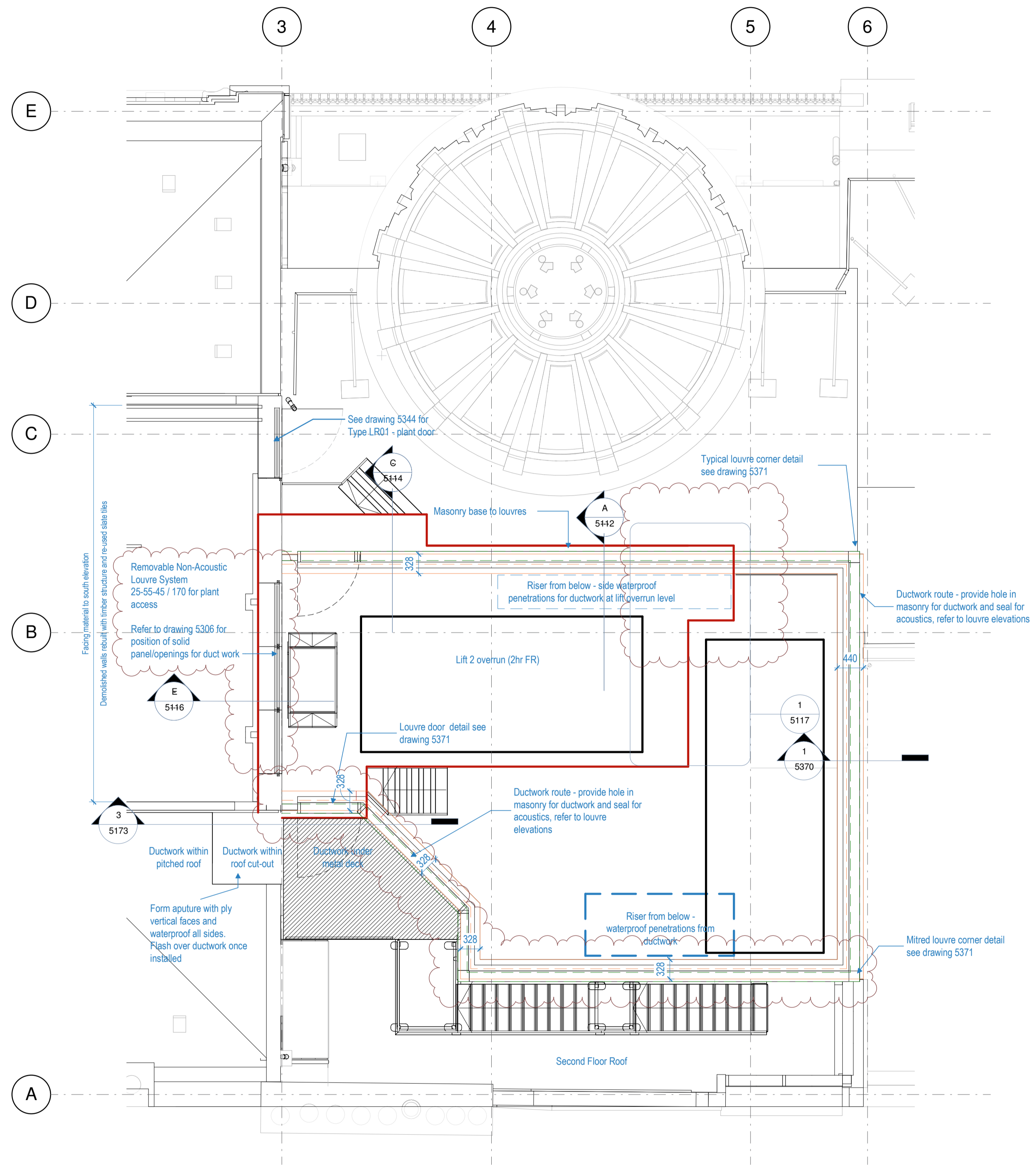

c 5108 **Plant compound - North**
1 : 50

2 5108 **Plant compound - South**
1 : 50

C1	19.09.18	First Construction Issue - Louvres -MJF	LM
A12	25.06.18	REVISED STAGE 4 ISSUE / LM / MJF	LM
A7	07.02.18	STAGE 4 SUBMISSION/ LM	AML
P1	24.01.18	Draft Stage 4 Issue / GV	LM

Rev	Date	Details/ Amended by	Sign
-----	------	---------------------	------

sonnemanntoon
architects

Quality House
6-9 Quality Court
Chancery Lane
London WC2A 1HP
United Kingdom
tel: +44 (0)20 7580 8881
email: info@st-arch.co.uk
web: www.st-arch.co.uk
© This drawing is copyright

Do not scale this drawing. Architect to be informed of all discrepancies in dimensions. Contractor to check all dimensions on site.

Project title
ITALIAN HOSPITAL

Drawing title
DETAILS
Lift overruns / Plant compound

Scale	Status	Revision
1: 50 @A1	CONSTR.	C1
1: 100 @A3		

Drawing number
1615-ST-Q1-04-DR-A-5108

