

Do Not Scale.
All Figured Dimensions To Be Checked On Site Prior To Construction.
All Copyright Reserved.

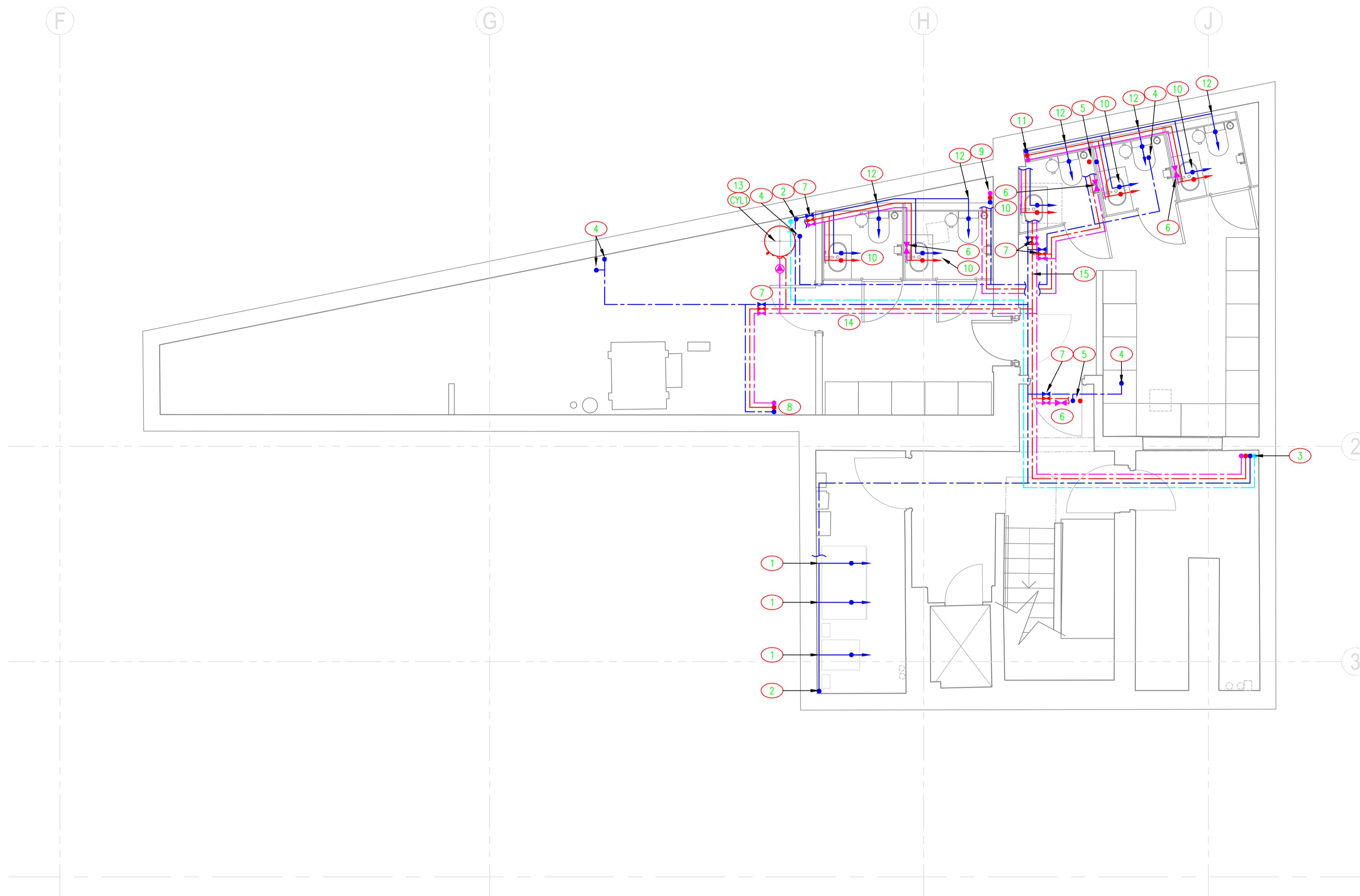

GENERAL NOTES:

1. ALL SERVICES/ROUTES THROUGHOUT BUILDING TO BE FULLY CO-ORDINATED ON SITE.
2. DRAWING TO BE READ IN CONJUNCTION WITH THE INSTALLATION SPECIFICATION AND ALL OTHER RELEVANT DRAWINGS.
3. ALL PIPEWORK TO BE INSULATED TO BS EN ISO 12241, USING CLASS 0 INSULATION, MINIMAL THICKNESS AS PER INSULATION SCHEDULE.
4. ALL WATER SERVICES SHALL BE PRESSURE TESTED AND DISINFECTED AFTER INSTALLATION.
5. ALL PLUMBING PIPEWORK TO BE COPPER. EXPOSED PIPEWORK TO BE CHROME PLATED AS COPPER, TABLE X, IN ACCORDANCE WITH BS2871, CAPILLARY JOINTED WITH LEAD FREE SOLDER.
6. ALL SANITARY WARE TO BE FITTED WITH REGULATING / ISOLATING VALVES ON MWS AND HWS PIPEWORK.
7. ALL CONCEALED PIPEWORK TO BE REASONABLY ACCESSIBLE THROUGHOUT ITS LENGTH IN ACCORDANCE WITH BUILDING REGULATIONS. ACCESS PANELS TO BE PROVIDED ADJACENT TO ALL VALVES WHEREVER THE SAME MIGHT OTHERWISE BE CONCEALED.

NOTES:

- 1 150 MWS SERVING APPLIANCE
- 2 150 MWS DROPS TO LOW LEVEL IN CORNER
- 3 280 MWS & DEDICATED CYLINDER MWS FROM ABOVE TO HIGH LEVEL
280 HWS & 150 HWR RISE TO ABOVE
- 4 150 MWS RISE TO ABOVE
- 5 150 MWS & HWS RISE TO ABOVE
- 6 150 HWR JOINS HWS CW BALANCING VALVE
- 7 PLUMBING SOLENOID VALVES
- 8 220 MWS, HWS & HWR RISE TO ABOVE
- 9 150 MWS, HWS & HWR RISE TO ABOVE
- 10 150 MWS & HWS SERVING WHB
- 11 150 MWS, HWS & 150 HWR DROP TO LOW LEVEL IN CORNER
- 12 150 MWS SERVING WC
- 13 280 DEDICATED CYLINDER MWS TO CYLINDER
280 HWS FROM CYLINDER TO HIGH LEVEL
150 HWR TO CYLINDER VIA DHWR PUMP
- 14 280 DEDICATED CYLINDER MWS, HWS, 220 MWS & 150 HWR AT HIGH LEVEL
- 15 220 MWS, HWS & 150 HWR AT HIGH LEVEL

PLANT SCHEDULE:

| REF | MANUFACTURER | MODEL | CAPACITY | DIMENSIONS |
|------|--------------|--------|----------|--------------|
| CYL1 | AO SMITH | IT 500 | 500L | 7600 x 2049H |

*NB - CYLINDER CW 18KW IMMERSION HEATER

| | | | |
|-----|--------------|----|------------|
| A | TENDER ISSUE | HN | 28/09/2018 |
| REV | DETAILS | BY | APP DATE |

CLIENT:

STREET MARKETS LTD

PROJECT:

CENTRE POINT, LINK BUILD. W1

DRAWING

BASEMENT LEVEL -2

TITLE:

PLUMBING

DRAWN

BY: **J.HARPER**

APPROVED

BY:

PROJECT

No.: **L2171**

DRAWING

No.: **M012**

DATE:

SEP'18

SCALE:

1:50



LEHDING SERVICES DESIGN LTD
Unit 10, 10 Redlands Crescent, Larne, Co. Antrim, N Ireland. BT40 1FF. Tel: +44(0) 2838 277 123.
Global House, Ashley Avenue, Epsom, London. KT18 5AD. Tel: +44(0) 1372 253 207.
Web: www.lehding.co.uk Email: info@lehding.co.uk