

Do Not Scale.
 All Figured Dimensions To Be Checked On Site Prior To Construction.
 All Copyright Reserved.

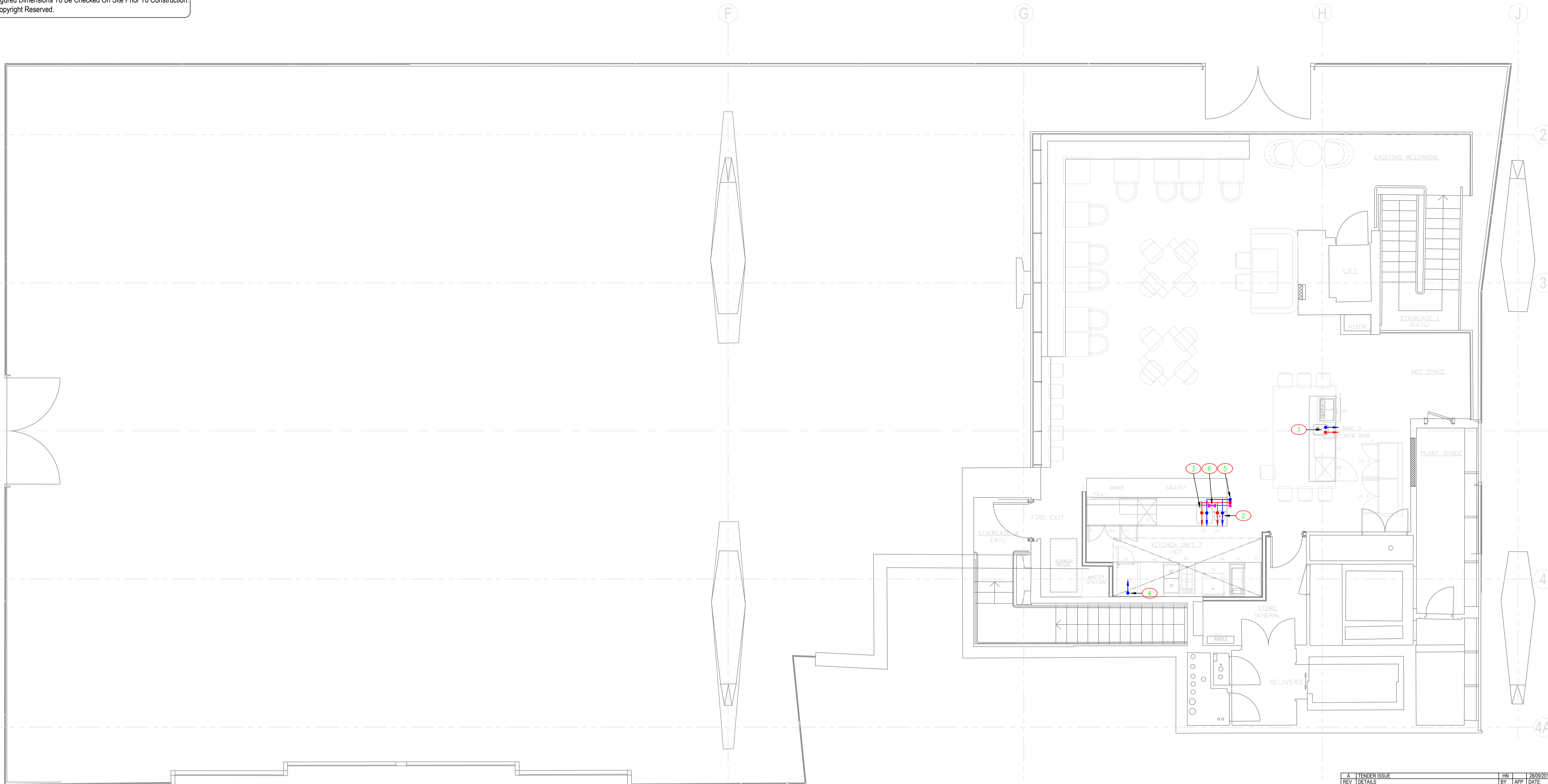

- GENERAL NOTES:**
1. ALL SERVICES/ROUTES THROUGHOUT BUILDING TO BE FULLY CO-ORDINATED ON SITE.
 2. DRAWING TO BE READ IN CONJUNCTION WITH THE INSTALLATION SPECIFICATION AND ALL OTHER RELEVANT DRAWINGS.
 3. ALL PIPEWORK TO BE INSULATED TO BS EN ISO 12241, USING CLASS O INSULATION, MINIMAL THICKNESS AS PER INSULATION SCHEDULE.
 4. ALL WATER SERVICES SHALL BE PRESSURE TESTED AND DISINFECTED AFTER INSTALLATION.
 5. ALL PLUMBING PIPEWORK TO BE COPPER. EXPOSED PIPEWORK TO BE CHROME PLATED AS COPPER, TABLE X, IN ACCORDANCE WITH BS2871, CAPILLARY JOINTED WITH LEAD FREE SOLDER.
 6. ALL SANITARY WARE TO BE FITTED WITH REGULATING / ISOLATING VALVES ON MWS AND HWS PIPEWORK.
 7. ALL CONCEALED PIPEWORK TO BE REASONABLY ACCESSIBLE THROUGHOUT ITS LENGTH IN ACCORDANCE WITH BUILDING REGULATIONS. ACCESS PANELS TO BE PROVIDED ADJACENT TO ALL VALVES WHEREVER THE SAME MIGHT OTHERWISE BE CONCEALED.

- NOTES:**
- 1 150 MWS & HWS FROM BELOW SERVING SINK
 - 2 150 MWS & HWS SERVING WHB
 - 3 150 MWS & HWS SERVING SINK
 - 4 220 MWS FROM BELOW SERVING APPLIANCE
 - 5 150 MWS, HWS & 150 HWR FROM BELOW TO LOW LEVEL
 - 6 150 HWR JOINS HWS CW BALANCING VALVE

A TENDER ISSUE		HN	28/09/2018
REV	DETAILS	BY	APP DATE
CLIENT: STREET MARKETS LTD			
PROJECT: CENTRE POINT, LINK BUILD. W1			
DRAWING TITLE: MEZZANINE LEVEL+1 PLUMBING			
DRAWN BY: J.HARPER	APPROVED BY:	DATE: SEP'18	
PROJECT No.: L2171	DRAWING No.: M009	SCALE: 1:50	
			
LEHDING SERVICES DESIGN LTD <small>Unit 10, 10 Redlands Crescent, Laine, Co. Antrim, N Ireland. BT40 1FF. Tel: +44(0) 2838 277 123. Global House, Ashley Avenue, Epsom, London, KT18 5AD. Tel: +44(0) 1372 253 207. Web: www.lehding.co.uk Email: info@lehding.co.uk</small>			