

Do Not Scale.  
All Figured Dimensions To Be Checked On Site Prior To Construction.  
All Copyright Reserved.

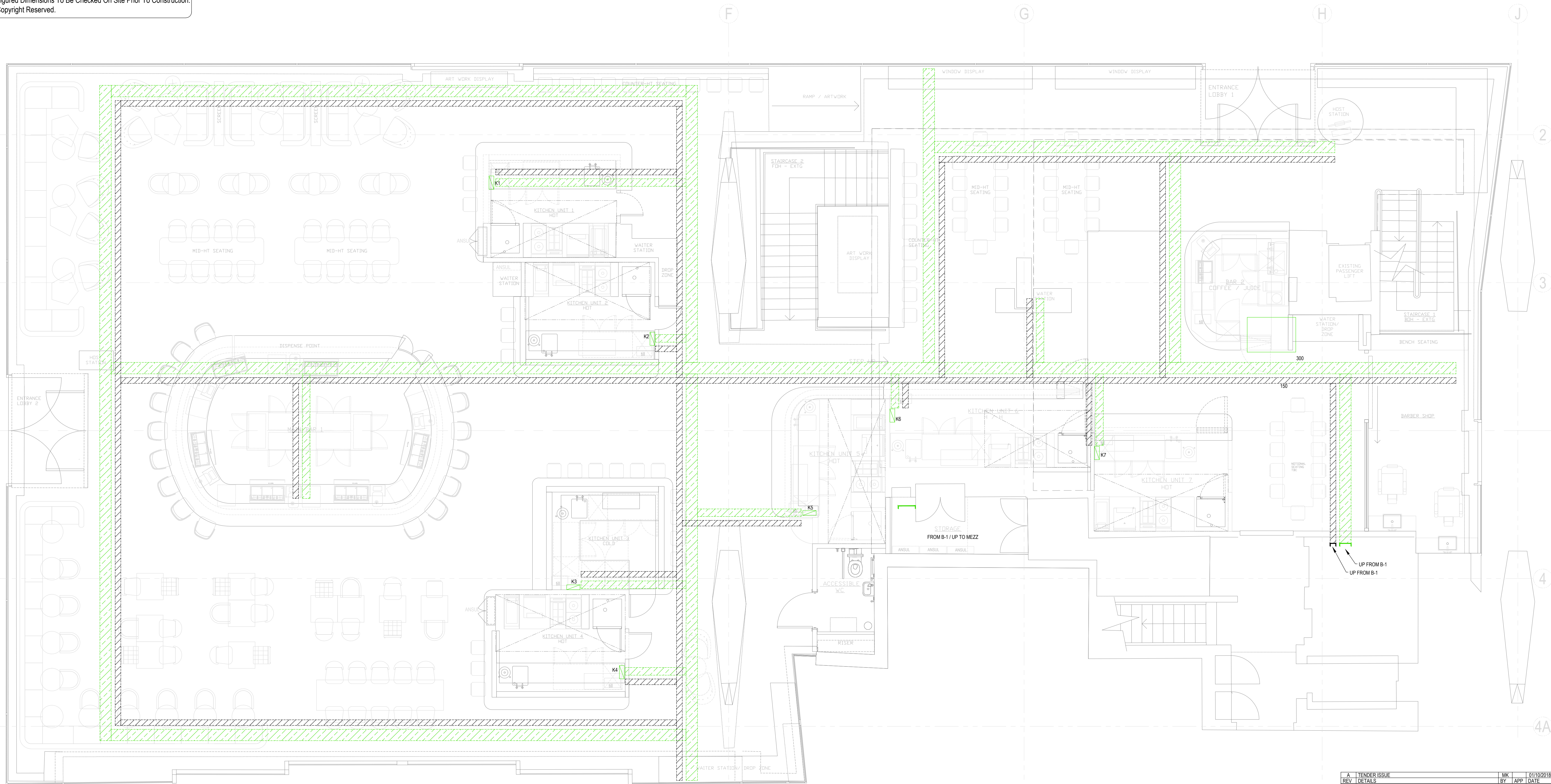

**GENERAL NOTES**

DRAWING TO BE READ IN CONJUNCTION WITH THE INSTALLATION SPECIFICATION AND ALL OTHER RELEVANT DRAWINGS.

ALL WIRING AND ELECTRICAL WORKS TO BE INSTALLED IN ACCORDANCE WITH BS7671 THE IET WIRING REGULATIONS 18th EDITION & LATEST AMENDMENTS.

THIS ELECTRICAL DESIGN IS BASED ON THE ASSUMPTION THAT THIS INSTALLATION WILL BE MANAGED BY A "SKILLED PERSON" AND USED BY "INSTRUCTED PERSONS" AS DESCRIBED IN BS7671 THE IET WIRING REGULATIONS 18th EDITION. THE INSTALLATION SHOULD BE MANAGED IN A SAFE SYSTEM OF WORKING AS LAID DOWN IN THE ELECTRICITY AT WORK ACT 1989 WITH GUIDANCE FROM BS EN 50110-1:2013 OPERATION OF ELECTRICAL INSTALLATION.

ALL CABLING AND CONTAINMENT TO BE LSZH TO BS EN 50267-2-1, BASEC MARKED AND BS EN 50625-3-11 COMPLIANT.

ALL CABLING TO BE ADEQUATELY SUPPORTED AGAINST PREMATURE COLLAPSE IN THE EVENT OF FIRE.

ALL EARTHING AND BONDING SHALL BE PROVIDED IN ACCORDANCE WITH BS7671 THE IET WIRING REGULATIONS 18th EDITION & LATEST AMENDMENTS.

ALL WIREWAYS TO BE CONCEALED WITHIN THE BUILDING FABRIC, ALSO ALL EQUIPMENT AND ACCESSORIES TO BE RECESSED IN WALLS IN A FLUSH INSTALLATION. UNDER NO CIRCUMSTANCES WILL SURFACE WIRING BE ACCEPTED.

WHERE THE COMMUNICATIONS CABLE CONTAINMENT SYSTEM REQUIRED TO PASS OVER ANY POWER CABLES etc. THEY SHALL CROSS AT 90° AND SHALL BE SEPARATED BY AN EARTH BONDED METALLIC BRIDGE.

THERE MUST BE A MINIMUM OF 100mm SEGREGATION BETWEEN COMMUNICATIONS CONTAINMENT SYSTEMS AND POWER CABLES CONTAINMENT SYSTEMS.

EQUIPMENT ON COLUMNS TO BE FULLY FIRE PROTECTED BY BUILDER.

ALL SERVICES/ROUTES THROUGHOUT BUILDING TO BE FULLY CO-ORDINATED ON SITE PRIOR TO INSTALLATION.

- NOTE:**
- INDICATIVE PRIMARY CONTAINMENT ROUTE. CONTRACTOR TO ALLOW SECONDARY CONTAINMENT TO PROVIDE A COMPLETE CONTAINMENT SYSTEM TO ALL POINTS.
  - DATA & ELV CONTAINMENT VIA BASKET OR SEPARATE IN GALVANISED TRUNKING WITH DIVIDER.
  - CONTRACTOR TO SIZE CONTAINMENT ALLOWING MIN 30% SPARE.
  - CONTAINMENT TO RUN IN CEILING / FLOOR VOIDS WHEREVER POSSIBLE.
  - WALL MOUNTED PRIMARY CONTAINMENT TO RUN AT HIGH LEVEL.
  - CONTAINMENT TO BE CONTINUOUS THROUGHOUT.

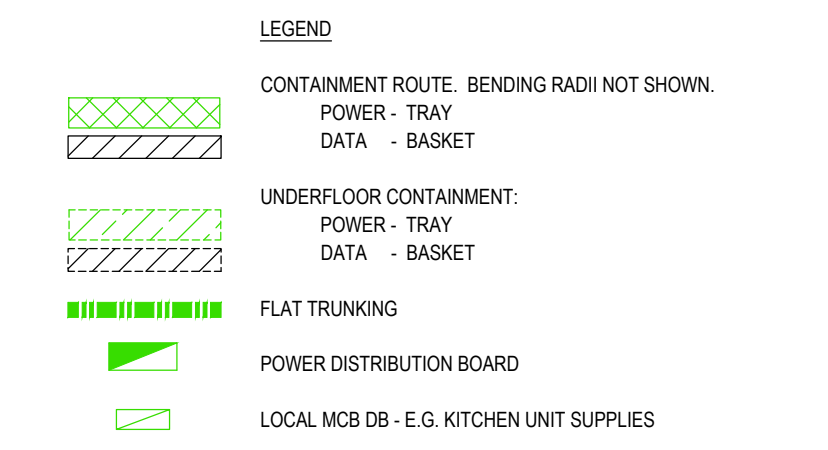

A	TENDER ISSUE	MK	01/10/2018
REV	DETAILS	BY	APP   DATE

CLIENT: **STREET MARKETS LTD**

PROJECT: **CENTRE POINT, LINK BLDG, W1**

DRAWING TITLE: **GROUND FLOOR, LEVEL 0**

**INDICATIVE PRIMARY CONTAINMENT**

DRAWN BY: <b>M.KNOTT</b>	APPROVED BY:	DATE: <b>SEP'18</b>
PROJECT No.: <b>L2171</b>	DRAWING No.: <b>E018</b>	SCALE: <b>1:50</b>



**LEHNDING SERVICES DESIGN LTD**

Unit 10, 10 Redlands Crescent, Lame, Co. Antrim, N.Ireland. BT40 1FF. Tel: +44(0) 2828 277 123.  
Global House, Ashley Avenue, Epsom, London. KT18 5AD. Tel: +44(0) 1372 253 207.  
Web: www.lehnding.co.uk Email: info@lehnding.co.uk