



NHBC REGISTERED HOUSE BUILDER

Tel: 01245 401333
Fax: 01245 401111
Email: sales@cannonpiling.com

VAT: 752 6361 29

Southend Road
Rettendon Common
Chelmsford,
Essex CM3 8DZ

SITE REF: 16049

ADDRESS: 115-119 Goldhurst Terrace, London

METHOD STATEMENT

OPEN BORE PILES

ITEM

- 1 Read through PCM notes and brief operatives on specific hazards highlighted
- 2 When taking delivery of materials ensure loading and unloading MS/RA is adhered to.
- 3 Ensure that weekly plant inspections are kept up to date and report any defects to the office immediately.
- 4 Obtain overhead / underground service drawings and visually identify areas of potential services
- 5 Use a CAT scanner to identify any electrical, gas, water, cable television / telephone utility services etc. and hand dig to expose these.
- 6 Careful excavate by hand areas around suspected services.
- 7 **ENSURE ALL SERVICES LOCATED ARE VISIBLY MARKED AND PROTECTED**

- 8 Set out pile position using 450mm long pin suitably tagged with pile number
- 9 Check fluid levels in power pack / rig, run up plant and check for leaks
- 10 Track rig to pile position
- 11 Set up rig over pile position ensuring mast vertical.
- 12 Commence drilling
- 13 Examine arisings and check that they coincide with those soils anticipated, if not stop and contact the office immediately.
- 14 Continue this process until designed depth is reached
- 15 Remove spoil arisings from work area.
- 16 Withdraw augers and (if using mini rig) neatly stack to one side
- 17 Check pile depth and verticality using tape and torch or computer.
- 18 Install reinforcing cage to required cut of level, secure and install anti heave sleeve if required.
- 19 Ensure local authority has inspected piles, record this.
- 20 If pile is not to be concreted immediately cover pile bore with suitable protection and ensure it is clearly marked.
- 21 Immediately prior to concreting check pile bore using torch
- 22 Place concrete and bring up to 300mm above cut off level

PILE LAYOUT

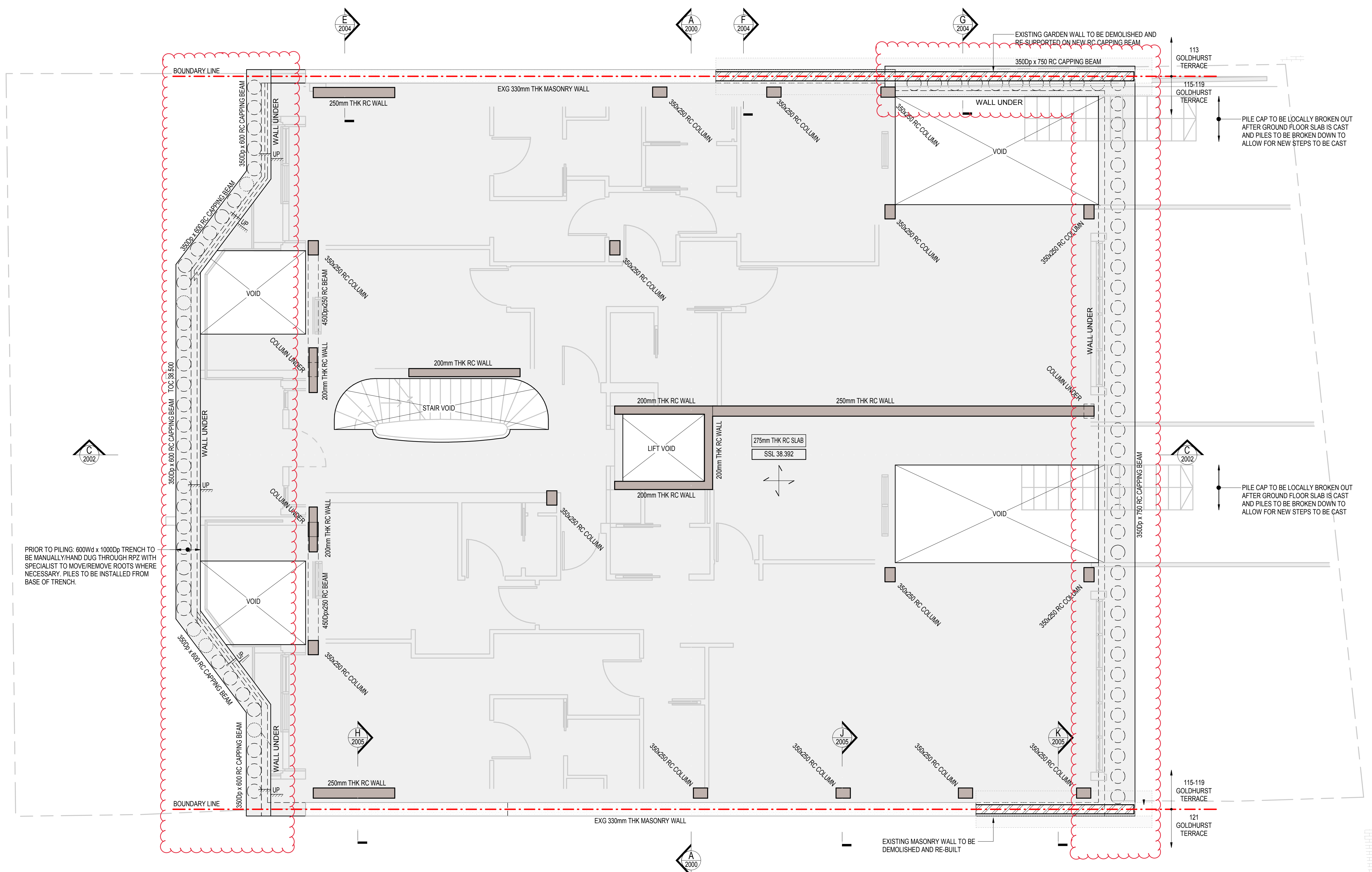

This drawing is to be read in conjunction with all relevant architects, engineers and specialists drawings and specifications.

Do not scale from this drawing.

LEGEND

- EXISTING STRUCTURE
- NEW LOAD BEARING BLOCKWORK
- NEW LOAD BEARING BRICKWORK
- NEW MASS CONCRETE
- NEW REINFORCED CONCRETE
- LOAD BEARING STRUCTURE BELOW
- EXISTING STRUCTURE TO BE REMOVED
- NEW STEEL BEAMS
- EXISTING STEEL BEAMS
- DENOTES MOMENT CONNECTION

NOTES

- REFER TO DESIGN CRITERIA REPORT, FOR ALL PERFORMANCE REQUIREMENTS AND LOADING CRITERIA.
- ALL STRUCTURAL LEVELS TO BE CONFIRMED.

NOT FOR CONSTRUCTION

rev	date	by	chk	description
P1	14.09.18	ODe	HMu	Issued for Information and Comment

elliottwood

Elliott Wood Partnership Ltd
 Wimbledon • Central London • Nottingham
 Consulting Structural and Civil Engineers
 tel: (020) 7499 5888. www.elliottwood.co.uk

project
 115-119 Goldhurst Terrace

drawing title
 Proposed Ground Floor Plan

scale (s)	date	drawn
1:50@ A1; 1:100@A3	September 2018	ODe

drawing status	status	revision
Preliminary	S0	P1
project no.	originator	zone level type role
2150657-EWP-00-00-DR-S-1000		