

Notes:
 This drawing is protected by copyright. No part of this document may be reproduced, altered, or transmitted in any form or by any means without permission.
 Do not scale off these drawings for construction purposes. If any discrepancies are found, please contact Proctor Watts Cole Rutter.

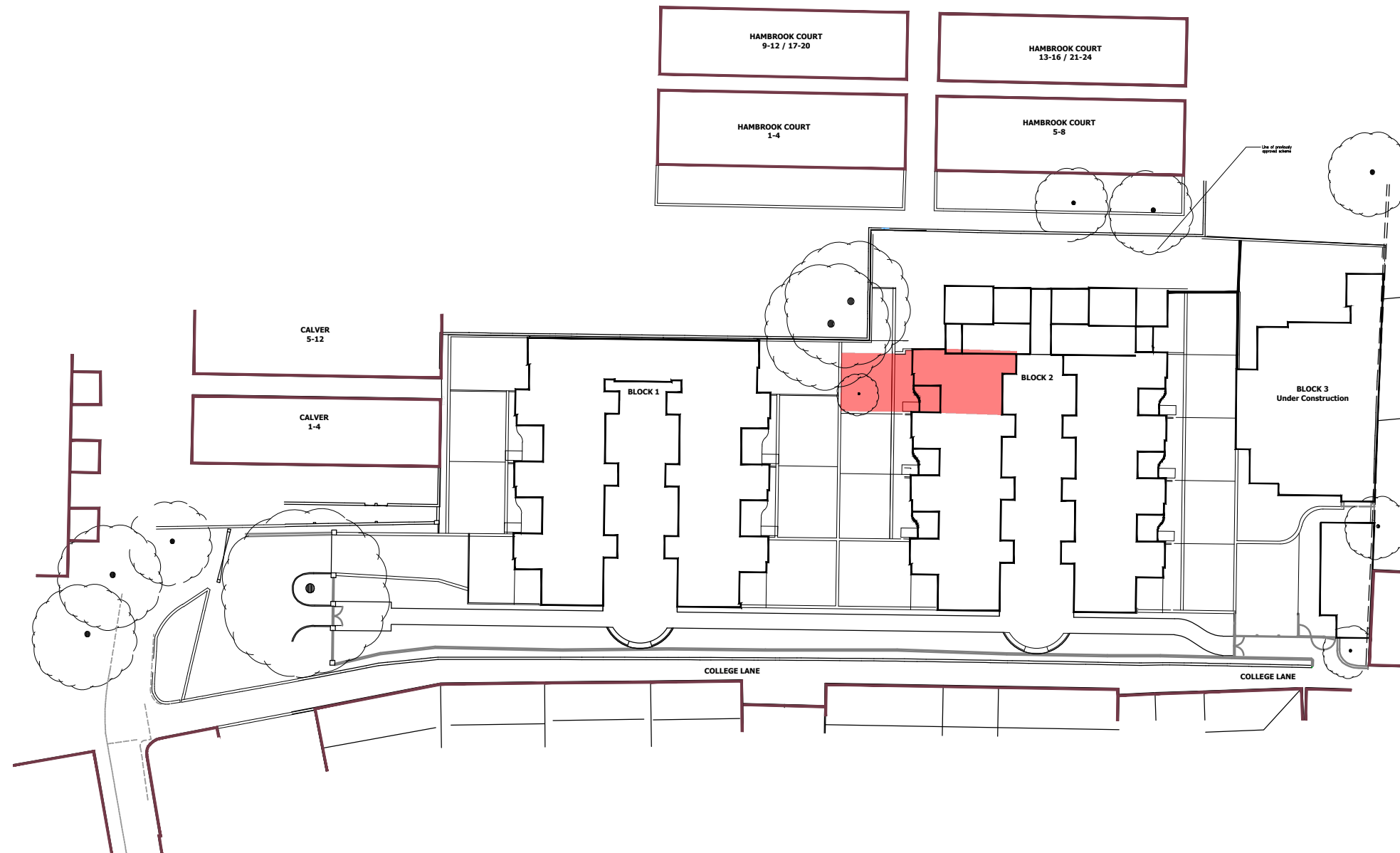

Site Plan
 Scale 1:500

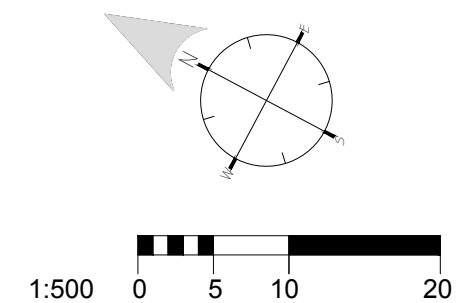

Rev.	Description:	By	Date
-	-	-	-
Client: Nicolas Weng Kan & Lorenza Soo		Drawn By:	JP
Title: Site Plan		Checked By:	-
Project: 12 Wiblin Mews, College Lane, Kentish Town, London		Scale:	1:500@A3
		Date:	18 Oct 2018
Job No:	Dwg No:	Revision:	
4672(18)	S55	-	

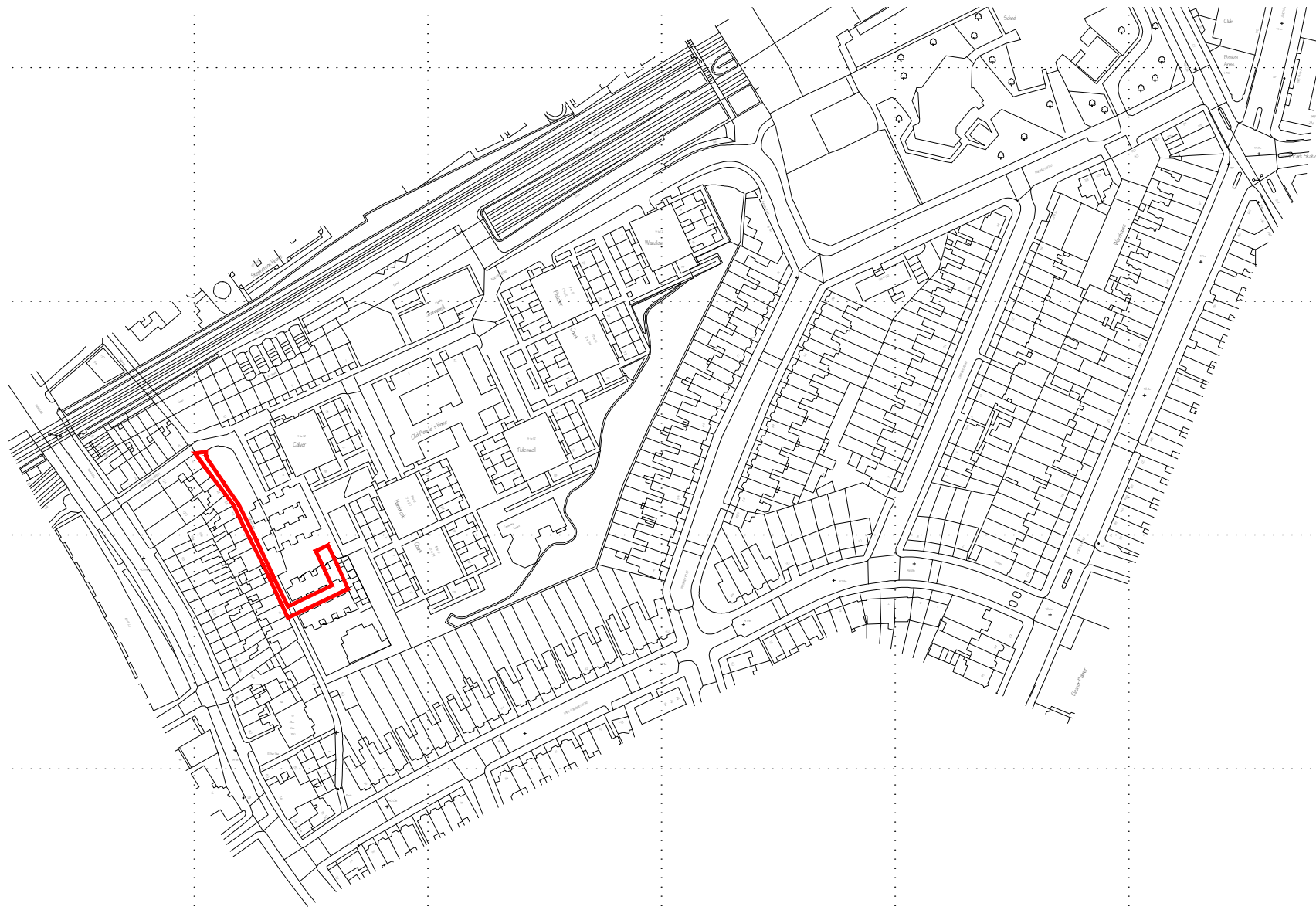

Location Plan

Scale 1:2500

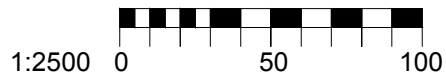
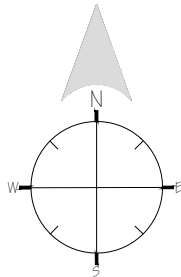

Proctor Watts Cole Rutter
Chartered Architects & Town Planners

Grosvenor House, Bleke Street, Shaftesbury, Dorset, SP7 8AW.
Phone: 01747 851881 Fax: 01747 851081
mail@pwcr.co.uk www.pwcr.co.uk

Client: Nicolas Weng Kan & Lorenza Soo
Dwg: 12 Wibun Mews, Kentish Town

Drawn By: JP
Checked By:

Job No:
4672(18)

Dwg No:
S56

Notes:

Date: 18 Oct 2018

Scale: 1:2500@A4