

CELLECTA ScreedBoard® 28 laid on timber sub-floor
 Solid timber joists
 Use with timber frame walls only

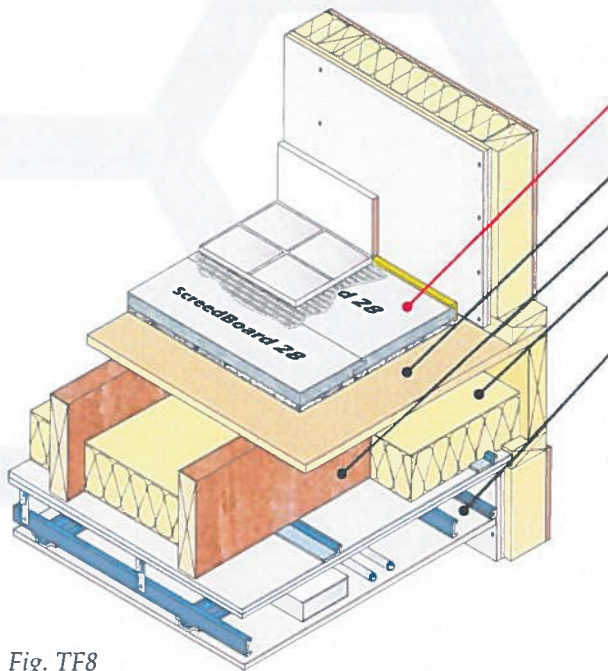

Floating floor treatment	CELLECTA ScreedBoard® 28 (See Table TF8 for full details)
Floor decking	15mm thick (min) OSB
Joists	220mm (min) solid timber joists
Absorbing material	100mm (min) quilt insulation (10-36kg/m³) between joists
Ceiling	See Table TF8 for ceiling treatment



Fig. TF8

Table TF8

PCT floating floor treatment	Perimeter resilient flanking strip required	Ceiling treatment								
<p>ScreedBoard® 28 High density composite resilient overlay treatment</p> <p>Additional layers required to complete treatment</p> <ul style="list-style-type: none"> Mineral wool quilt laid between joists 100mm (min) 10-33kg/m³ <p>No need for screws Interlocking edges glued together with CELLECTA SB joint adhesive</p> <p>Product information Board dimensions 28mm x 600mm x 1200mm Edge profile: Interlocking tongue & groove Weight: 26.00kg/m² / 18.72kg per board CELLECTA SB joint adhesive: 1L for every 33m² of boards</p> <p>Typical PCT performance^(a)</p> <table border="1"> <tr> <td>$D_{nT,w} + C_{tr} = 50dB$</td> <td>Mat 1</td> <td>Pol 1</td> <td>Hea 2</td> </tr> <tr> <td>$L_{nT,w} = 50dB$</td> <td>2</td> <td>1</td> <td>3</td> </tr> </table> <p>Code credits*</p> <p>Benefits of ScreedBoard 28 over an acoustic batten system (FFT1)</p> <ul style="list-style-type: none"> Gray dry screed finish Only 28mm thick Reduces number of brick courses required Able to accept ceramic tiles Only one component to install (+ edge strip) Interconnecting edge detail - no screws req'd Weights only 18.72kg per board (0.72m²) Same weight/m² as FFT1 treatment No need to employ a specialist contractor Quick and easy to install 	$D_{nT,w} + C_{tr} = 50dB$	Mat 1	Pol 1	Hea 2	$L_{nT,w} = 50dB$	2	1	3	<p>Proposed construction provides enhanced sound insulation value of at least 5dB above Building Regulations (45dB) for floor/ceiling separating different types of rooms/uses in adjoining dwellings</p> <p>Note there are no walls separating different types of rooms in adjoining dwellings</p>	<p>Ceiling board fixings must not penetrate or touch the floor joists</p> <p>16mm (min) metal resilient bars mounted at right angles to the joist at 400mm centres.</p> <p>Primary ceiling: CT1-Two layers of gypsum-based board, composed of 19mm (nominal 13.5kg/m²) fixed with 32mm screws and 12.5mm (nominal 10kg/m²) fixed with 42mm screws, with all joists staggered.</p> <p>CT2-Two layers of gypsum-based board, composed of 15mm (nominal 12.5kg/m²) fixed with 25mm screws and a second layer of 15mm (nominal 12.5kg/m²) fixed with 42mm screws, with all joists staggered.</p> <p>Sacrificial ceiling: Metal ceiling system with a 100mm (min) void fixed to underside of primary ceiling. One layer of nominal 8kg/m² gypsum based board.</p>
$D_{nT,w} + C_{tr} = 50dB$	Mat 1	Pol 1	Hea 2							
$L_{nT,w} = 50dB$	2	1	3							

* Code for Sustainable Homes (CSH) credits quoted are typical. Mat 1 value taken from the BRE Green Guide. Pol 1 credit is only awarded if all the other insulation products used have a GWP of <5. Hea 2 credits are based on the floor being pre-completion tested and the separating wall performing to at least the same acoustic standard. Credits subject to relevant category weighted value. See page 5 for further information.

Acoustic values
^(a) Values quoted are typical, based on the treatment being installed correctly and pre-completion tested.
 Airborne performance tested in accordance with BS EN ISO 140-4: 1998
 Impact performance tested in accordance with BS EN ISO 140-7: 1998