

KEY - MATERIALS

- 01 Existing Brickwork
- 02 Painted render
- 03 Black Painted Timber Sash Window
- 04 White Painted Timber Sash Window
- 05 Black Painted Timber Window
- 06 Black Metal Roller Shutter
- 07 Black Painted Timber Door
- 08 Natural Slate
- 09 Zinc - Anthracite
- 10 Stone coping
- 11 Slim Profile Metal Frame Window
- 12 Natural Stone panel
- 13 Stock Brick
- 14 Minimal glazing
- 15 Glass balustrade
- 16 Painted Timber Shopfront Window
- 17 Metal framed Conservation Rooflight
- 18 Lead

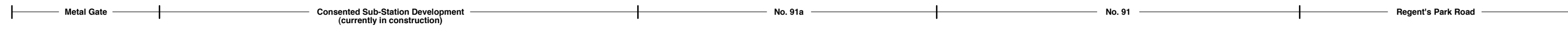

SOUTH WEST ELEVATION AS PROPOSED - REV D
Scale: 1:100 @ A3

KEY PLAN
Scale: 1:500 @ A3

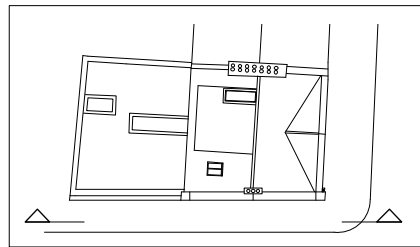

Alexander Martin Architects

22-24 Kingsford Street
London NW5 4JT
T. +44.0.20.3290.3540
E. info@amarchitects.co.uk
W. amarchitects.co.uk



© Alexander Martin Architects Limited. DO NOT SCALE.
All drawings are to be read in conjunction with the relevant structural and services drawings. All dimensions to be checked on site by Contractor. Report any discrepancies to AMA prior to construction.

Revisions

Rev	Description

Status

PLANNING	
Client	Mr Z. Keshwani
Project	91 Regents Park Road, NW11 8UT

Drawing title

PROPOSED S.W ELEVATION	
Drawn	Checked
DJ	AM
Scale	Date
1:100@A3	18.05.2017
Drawing No	Rev
168-GA-202	D

