

Existing joist to have timber firrings installed such that the salvaged floorboards are levelled without impacting on the levels and detail of skirtings, architraves and fireplaces.

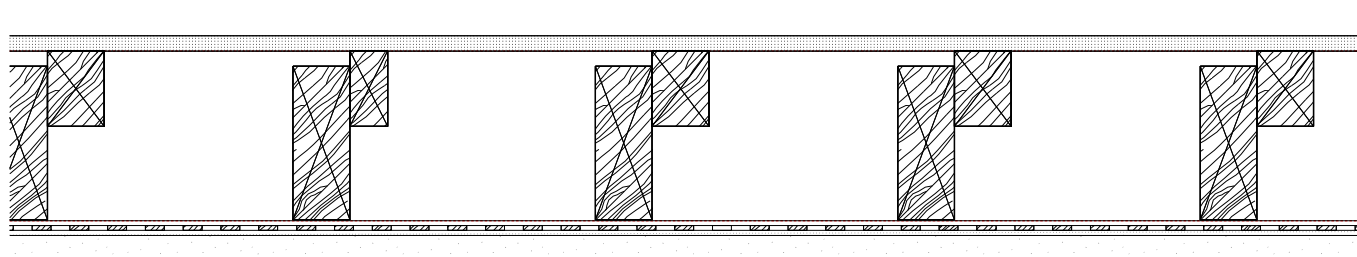

18mm Plywood
Strengthening joists (75mm x100mm)

Existing joists (200mm x 75mm)
Existing Lath & Plaster Ceiling

Type 13 - Existing Third Floor Build-up
Levelled with plywood finish

scale 1:10

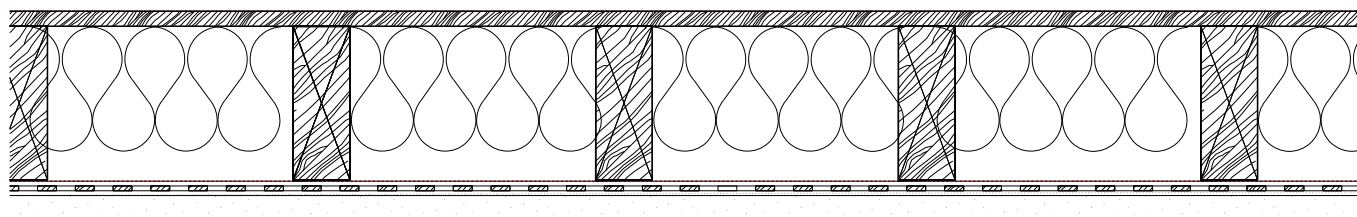

20mm Salvaged timber floor boards (220mm wide)
Existing joists (200mm x 75mm)
150mm Rockwool insulation inbetween joists

Existing Lath & Plaster Ceiling
(Existing lath and plaster ceilings to be repaired. Surface to be upgraded with 2 coats of Envirograph paint, 1 coat HWAEC and two coats of a flexible acrylic based emulsion paint.)

Type 14 - Proposed Third Floor Build-up
Salvaged boards on existing joists

scale 1:10

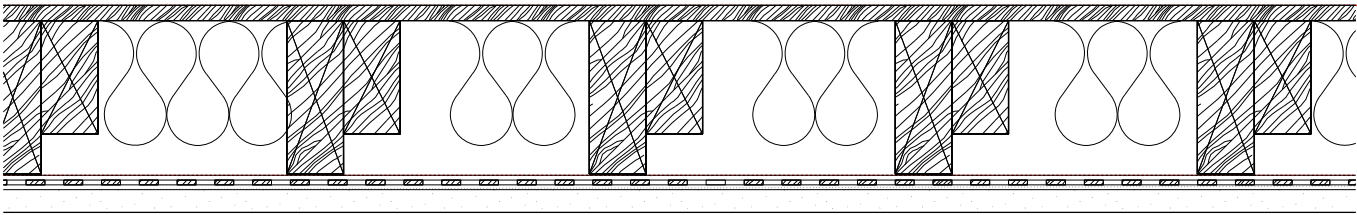

20mm Salvaged timber floor boards (220mm wide)
Existing joists (200mm x 75mm)
Strengthening joist (75mm x150mm)
150mm Rockwool insulation inbetween joists

Existing Lath & Plaster Ceiling
(Existing lath and plaster ceilings to be repaired. Surface to be upgraded with 2 coats of Envirograph paint, 1 coat HWAEC and two coats of a flexible acrylic based emulsion paint.)

Type 15 - Proposed Third Floor Build-up-
BATHROOMS ONLY
Salvaged boards on existing joists with strengthening joists for loading

scale 1:10

Rev A	19.09.18	Revised as bubbled
Rev -	09.08.18	Issued for Planning

PLANNING

Project No. 17103
Client GFZ Investments Ltd.
Date January 2018
Scale 1:10 @ A1
Project 34 Great James Street

Drawing Title: Detail Floor Types _Third
Drawing No. 400_105
Rev. A
Drawn MWh Approved MW Signed

Marek
Wojciechowski
Architects Ltd.

66 - 68 Margaret Street W1W 8SR T. 020 7580 9336 www.mw-a.co.uk
Copyright Marek Wojciechowski Architects.
No implied license exists. This drawing should not be used to calculate areas for the purposes of valuation. All dimensions to be checked on site by the contractor and such dimensions to be their responsibility. Do not scale drawings. All work must comply with relevant British Standards and Building Regulations requirements. Drawing errors and omissions to be reported to the architect.

