

Existing joist to have timber firrings installed such that the salvaged floorboards are levelled without impacting on the levels and detail of skirtings, architraves and fireplaces.

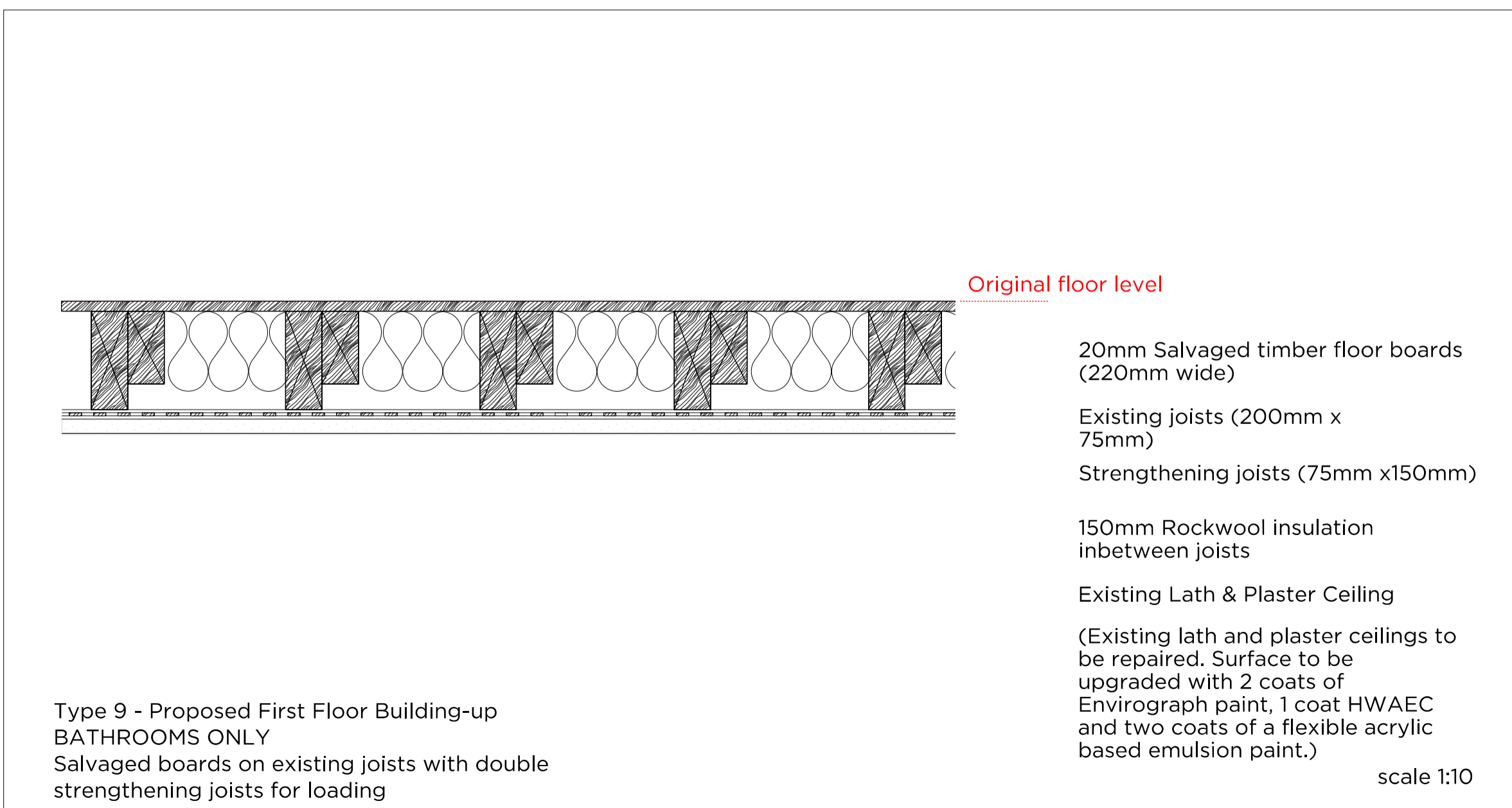
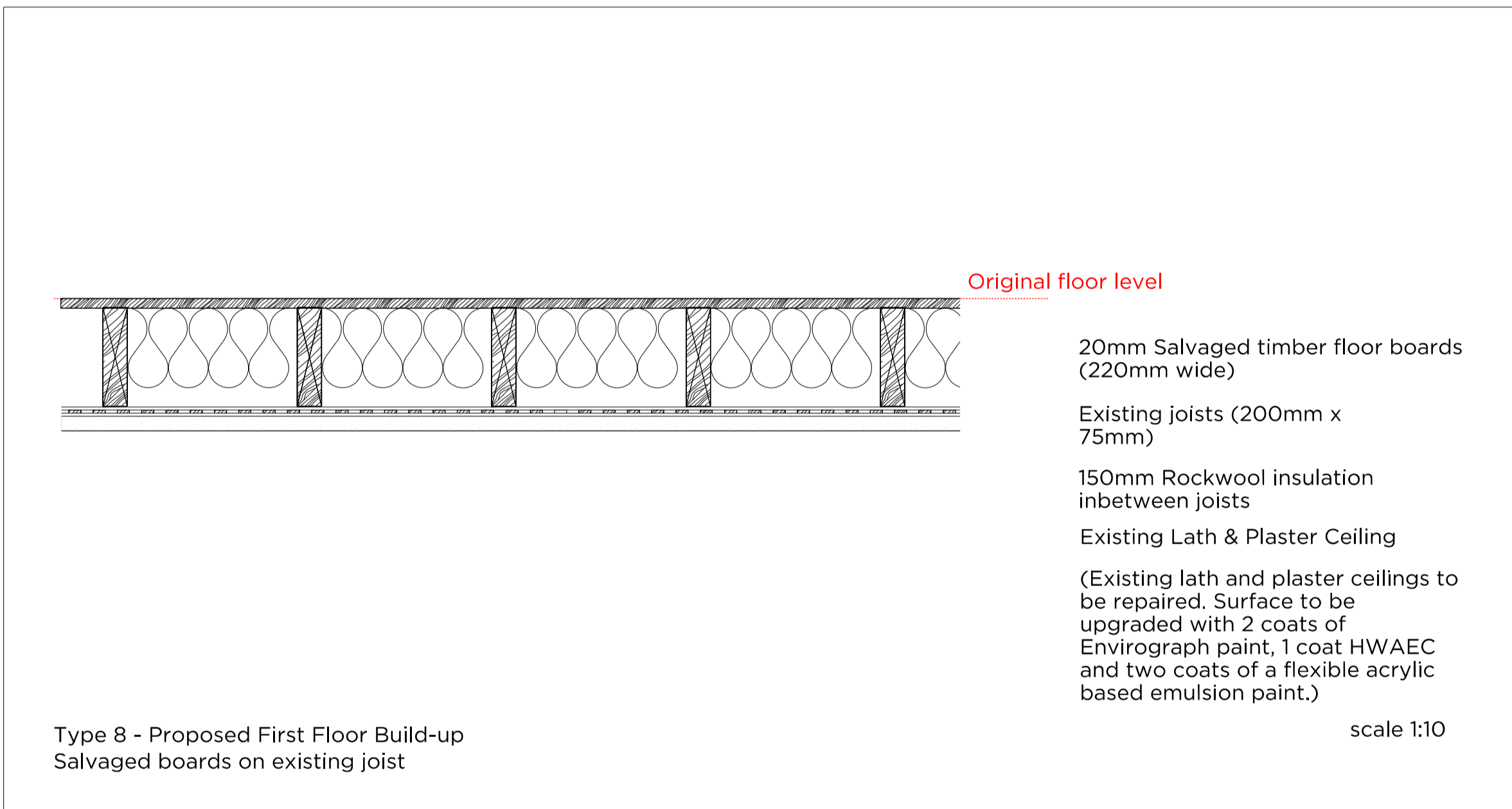
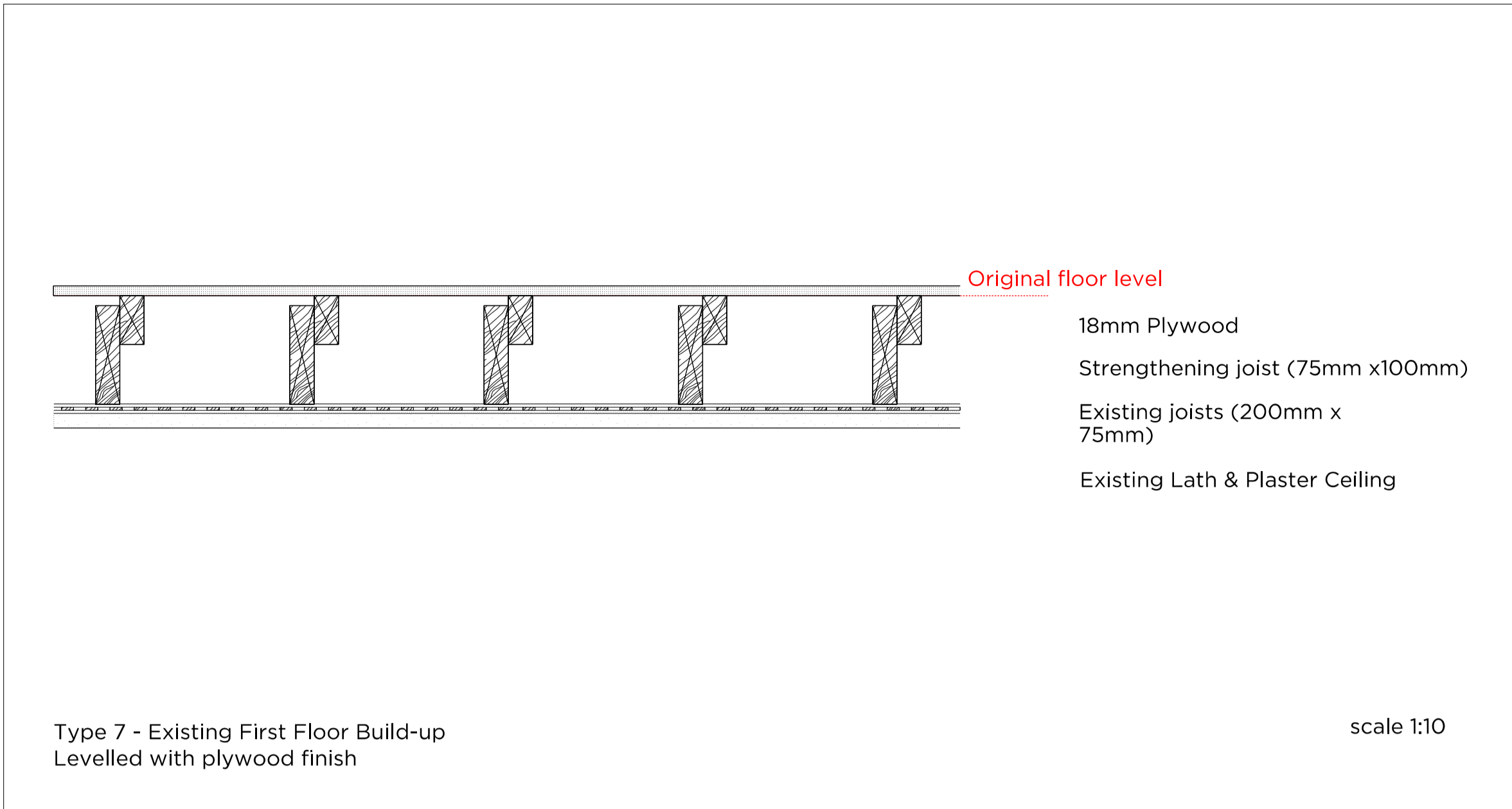

Rev A	19.09.18	Revised as bubbled
Rev -	09.08.18	Issued for Planning

# PLANNING

Project No. **17103**

Client **GFZ Investments Ltd.**

Date **January 2018**

Scale **1:10 @ A1**

Project **34 Great James Street**

Drawing Title: **Detail Floor Types \_First Floor**

Drawing No. <b>400_103</b>	Rev. <b>A</b>
Drawn <b>MWh</b>	Approved <b>MW</b>
Signed	

**Marek Wojciechowski Architects Ltd.**

66 - 68 Margaret Street W1W 8SR T. 020 7580 9336 www.mw-a.co.uk

Copyright Marek Wojciechowski Architects. No implied license exists. This drawing should not be used to calculate areas for the purposes of valuation. All dimensions to be checked on site by the contractor and such dimensions to be their responsibility. Do not scale drawings. All work must comply with relevant British Standards and Building Regulations requirements. Drawing errors and omissions to be reported to the architect.