

PROPOSED GROUND PLAN @ 1 : 50

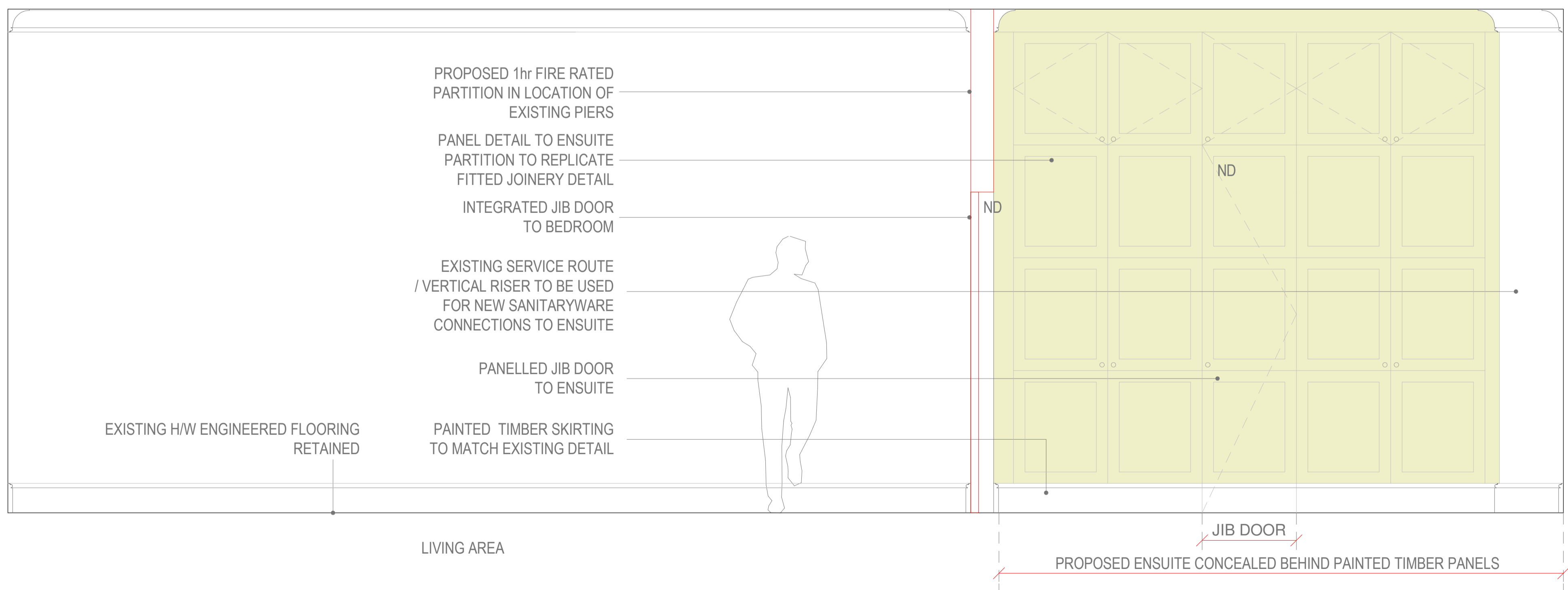

PROPOSED SECTION @ 1 : 20

- NOTES :
- ALL NEW SANITARYWARE TO CONNECT INTO EXISTING PLUMBING / MECHANICAL RISERS
  - ALL NEW CONNECTIONS AND FEEDS TO BE ROUTED THROUGH NEW PARTITIONS / BEHIND SKIRTING
  - NEW EXTRACT VENTILATION TO ENSUITE TO BE LINKED THROUGH TO BRICK VENT ON EXTERIOR REAR ELEVATION
  - ALL NEW LIGHTING TO BE LED
  - PROPOSED NEW INTERNAL PARTITION TO BE 1hr FIRE RATED, JIB DOOR TO BE FD30
  - NEW ELECTRIC BOILER TO BE INSTALLED (NO FLUE / VENTING REQUIRED)
  - ALL DETAILS SUBJECT TO L.A. APPROVAL



description	date	rev	Job Title	Drawing Title	Date	Scales	Drawing Status	Drawing Number	Revision	NOTES
			GUILFORD STREET	PROPOSED GROUND PLAN	08.10.18	1 : 50 @ A1	PLANNING	GS / SK01	-	THIS DRAWING IS FOR PLANNING APPROVAL ONLY AND IS NOT A CONSTRUCTION DRAWING. ALL DIMENSIONS TO BE CHECKED ON SITE BY CONTRACTOR. DO NOT SCALE FROM THIS DRAWING. UNLESS OTHERWISE STATED ALL DIMENSIONS ARE IN MILLIMETRES.