

NORTH WING (ZONE C)

SOUTH WING (ZONE B)

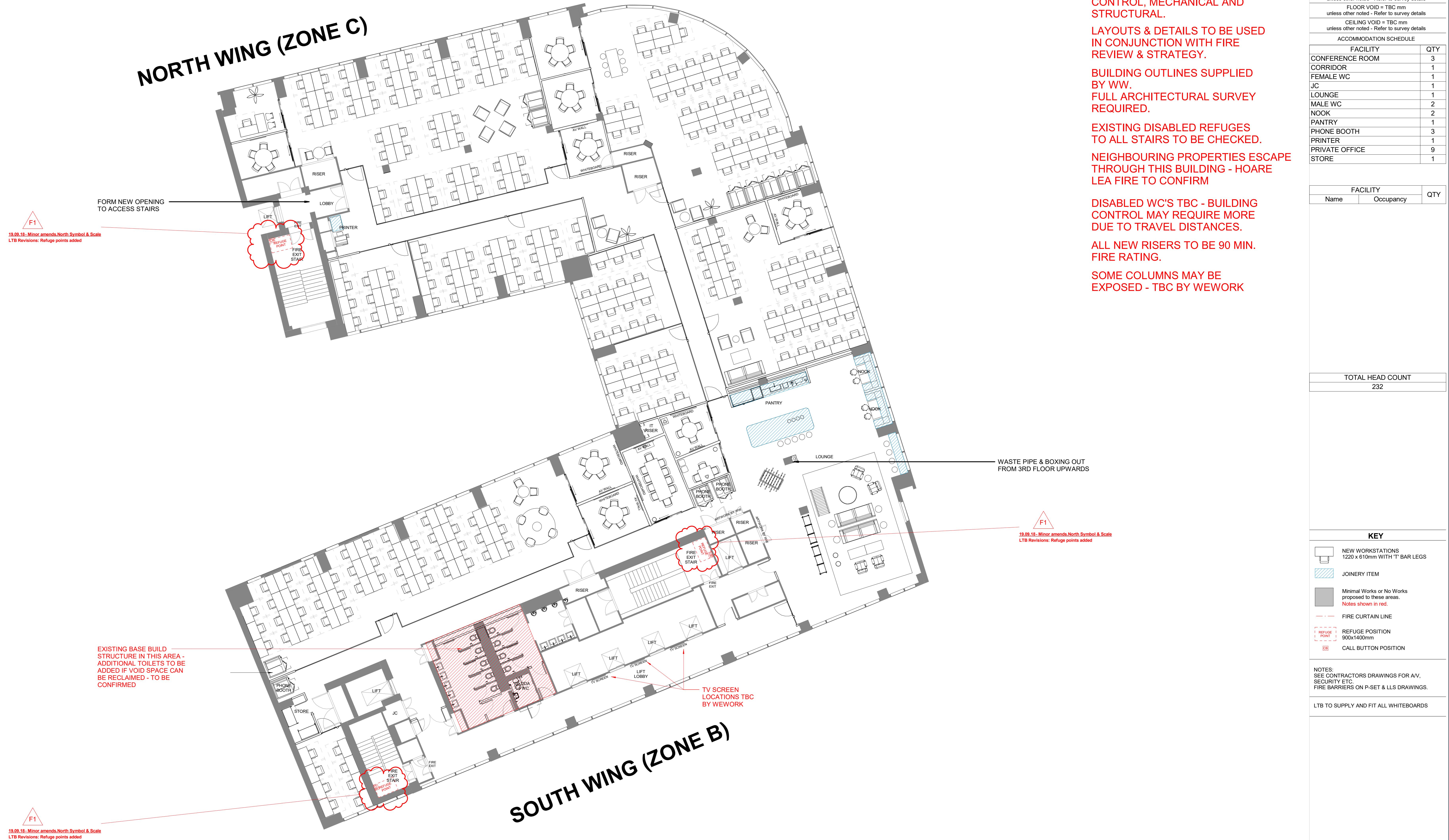

F1  
19.09.18 - Minor amends North Symbol & Scale  
LTB Revisions: Refuge points added

F1  
19.09.18 - Minor amends North Symbol & Scale  
LTB Revisions: Refuge points added

F1  
19.09.18 - Minor amends North Symbol & Scale  
LTB Revisions: Refuge points added

F2  
19.09.18 - Minor amends North Symbol & Scale

ALL LAYOUTS SUBJECT TO THE FOLLOWING APPROVALS:- CLIENT, LANDLORD, FIRE, BUILDING CONTROL, MECHANICAL AND STRUCTURAL.

LAYOUTS & DETAILS TO BE USED IN CONJUNCTION WITH FIRE REVIEW & STRATEGY.

BUILDING OUTLINES SUPPLIED BY WW. FULL ARCHITECTURAL SURVEY REQUIRED.

EXISTING DISABLED REFUGES TO ALL STAIRS TO BE CHECKED.

NEIGHBOURING PROPERTIES ESCAPE THROUGH THIS BUILDING - HOARE LEA FIRE TO CONFIRM

DISABLED WC'S TBC - BUILDING CONTROL MAY REQUIRE MORE DUE TO TRAVEL DISTANCES.

ALL NEW RISERS TO BE 90 MIN. FIRE RATING.

SOME COLUMNS MAY BE EXPOSED - TBC BY WEWORK

Floor Area m2	Floor Area ft2
1346 m <sup>2</sup>	14,485 SF
Square foot shown is based on supplied building shell and includes all columns - subject to site survey	
GENERAL CEILING HEIGHT = TBC mm unless other noted - Refer to survey details	
FLOOR VOID = TBC mm unless other noted - Refer to survey details	
CEILING VOID = TBC mm unless other noted - Refer to survey details	
ACCOMMODATION SCHEDULE	
FACILITY	QTY
CONFERENCE ROOM	3
CORRIDOR	1
FEMALE WC	1
JC	1
LOUNGE	1
MALE WC	2
NOOK	2
PANTRY	1
PHONE BOOTH	3
PRINTER	1
PRIVATE OFFICE	9
STORE	1

TOTAL HEAD COUNT		
Name	Occupancy	QTY
		232

TOTAL HEAD COUNT		
		232

**KEY**

- NEW WORKSTATIONS  
1220 x 610mm WITH T BAR LEGS
- JOINERY ITEM
- Minimal Works or No Works proposed to these areas.  
Notes shown in red.
- FIRE CURTAIN LINE
- REFUGE POSITION  
900x1400mm
- CALL BUTTON POSITION

NOTES:  
SEE CONTRACTORS DRAWINGS FOR AV, SECURITY ETC.  
FIRE BARRIERS ON P-SET & LLS DRAWINGS.

LTB TO SUPPLY AND FIT ALL WHITEBOARDS

Rev	Description	Drawn By	Date
F	Minor amends North Symbol & Scale	TK	19.09.18
E	Updated to WW comments 23.07.18	GM	01.08.18
D	Amended to match updated EC	TK	25.07.18
C	General updates to detail design	TK	16.07.18
B	General updates to detail design	CE	22.06.18
A	Revisions following design meeting & site visit	TK	15.06.18
-	Drawing First Issue	CE	08.06.18

**Construction**

Client: WeWork

Client Contact:

Project Name: 125 Kingsway

Drawing Title: 6th Floor - General Arrangement

Account Manager:

Designer: Senior Tech. Designer / Project Manager: Rebekah Webber / Tim Kirkman / Jordan Reay

Scale @ A0: 1:100

Drawn By: AN

First Drawing Date: 16/05/18

Contract Number: 1128

Floor: 06

Detail: GA

Revision: F

