

## Conveyance Note (Form C Combined Weight and Volume)

Weights and Measures Act 1983, Schedule 5, Paragraph 7

### Keltbray Group

Waste Carriers Licence No. CBDU84378

LOADED AT	DATE OF LEAVING PLACE OF LOADING
WATFORD	05/02/2018

Name & Address of Site: 80 CHARLOTTE STREET  
LONDON

Time on Site: 10.10		Time off Site: 10.25		Load No. 07	
REGISTERED NO. OF VEHICLE		NAME OF PERSON IN CHARGE OF VEHICLE			
SV64TXL		MUS			
CUBIC METRES (IN WORDS)	DESCRIPTION OF MATERIAL	TONNES			
		GROSS			
		TARE			
15M	MIXED HAZ 2	NETT			

N.B. TO CUSTOMERS, authorised agents, representatives, or responsible persons signing this delivery ticket. This is in your interest. Please read this ticket carefully, and inspect material, agreeing quantity, quality and that everything is to your satisfaction before finally signing this receipt note. We regret we cannot under any circumstances entertain any claims concerning quantity or quality, once the vehicle has left the site and a clear signature has been given.

Customers entering vehicles off the public road do so entirely on their own responsibility. We cannot accept responsibility for damage caused by our vehicles while delivering to your site.

All materials delivered to site remain the property of the vendor until paid for in full.

Certified that the above particulars are true and relate to the aggregate, sub-based materials and arising materials being conveyed or disposed of in pursuance of the sale.

Received By

Print Name

Signed for and on behalf of the seller

Print Name

Date

Job No.

No. C 519116

### PRODUCER/CURRENT HOLDER OF WASTE

Full Name

Address

The waste hierarchy has been considered in deciding the most appropriate waste management option.

SIG Code:

### WASTE CARRIER'S DETAILS

Registered Carriers Name

Address

Registered Carriers No.

Issued By

### DESCRIPTION OF WASTE

- ☐ 17.01.01 Concrete
 ☐ 17.01.02 Bricks
 ☐ 17.01.07 Hardcore
 ☐ Brown Clay / Blue Clay  
☐ 17.04.07 Mixed Metals
 ☐ 17.05.04 Soil & Stones
 ☐ 17.02.01 Wood  
☐ 17.09.04 Mixed Demolition/Construction
 ☒ Other HAZ H112

### DISPOSAL FACILITY DETAILS

Site Operator's Signature

Print Name

Site Name

Address

**Conveyance Note** (Form C Combined Weight and Volume)  
Weights and Measures Act 1963, Schedule 5, Paragraph 7

## Keltbray Group

Waste Carriers Licence No. CBDU84378

LOADED AT	DATE OF LEAVING PLACE OF LOADING
WITCHAX	05/02/2018

Name & Address  
of Site:

55 CHARLOTTE STREET  
LONDON

Time on Site: 11.00 Time off Site: 11.20 Load No. 8

REGISTERED NO. OF VEHICLE	NAME OF PERSON IN CHARGE OF VEHICLE
FF61GNV	Jonie Cook

CUBIC METRES (IN WORDS)	DESCRIPTION OF MATERIAL	TONNES
15m	NON HAZ	
		GROSS
		TARE
		NETT

N.B. To customers, authorised agents, representatives, or responsible persons signing this delivery ticket. This is in your interest. Please read this ticket carefully, and inspect material, agreeing quantity, quality and that everything is to your satisfaction before finally signing this receipt note. We regret we cannot under any circumstances entertain any claims concerning quantity or quality, once the vehicle has left the site and a clear signature has been given.

Customers ordering vehicles off the public road do so entirely on their own responsibility. We cannot accept responsibility for damage caused by our vehicles while delivering to your site.

All materials delivered to site remain the property of the vendor until paid for in full.

Certified that the above particulars are true and relate to the aggregate, sub-base materials and arising materials being conveyed or disposed of in pursuance of the sale.

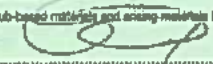
Received By:  Print Name: Jonie Cook

Signed for and on  
behalf of the seller  
Print Name: 

Date: 5 Feb 18

Job No. 145515 No. C 519117

## PRODUCER/CURRENT HOLDER OF WASTE

Full Name: Keltbray  
Address: 5 Andrews House  
Pittsmead Road, Esher  
Surrey KT10 9TA

The waste hierarchy has been considered in deciding the most appropriate waste management option.

SIC Code: 213, 11.0

wif 0941

## WASTE CARRIER'S DETAILS

Registered Carriers Name: Elmbridge Waste  
Address: CBMP 3015 DG

Registered Carriers No. Issued By

## DESCRIPTION OF WASTE

- ☐ 17.01.01 Concrete ☐ 17.01.02 Bricks ☐ 17.01.07 Hardcore ☐ Brown Clay/Blue Clay  
☐ 17.04.07 Mixed Metals ☐ 17.05.04 Soil & Stones ☐ 17.02.01 Wood  
☐ 17.09.04 Mixed Demolition/Construction ☒ Other: NON HAZ

## DISPOSAL FACILITY DETAILS

Site Operator's Signature:   
Print Name: Mohawk WHARF  
Site Name: Stratfield Road  
Address: (FP32921H)

**Haulage Conveyance Note** (Form C Combined Weight and Volume)  
 Weights and Measures Act 1983, Schedule 5, Paragraph 7
No. **H 145515/51917****PRIMAGRANGE LTD**

Waste Carriers Licence No. CB/MP3015DG

LOADED AT <b>KB</b>	DATE OF LEAVING PLACE OF LOADING <b>5/2/18</b>
------------------------	---

Name &amp; Address of Site:

**KB Charlotte St**

Time on Site:	Time off Site:	Load No.
REGISTERED NO. OF VEHICLE <b>EF61GNO</b>	NAME OF PERSON IN CHARGE OF VEHICLE <b>Janie</b>	
CUBIC METRES (IN WORDS)	DESCRIPTION OF MATERIAL	TONNES
<b>15</b>	<b>Non HAZ</b>	GROSS
		TARE
		NETT

N.B. To customers authorised agents, representatives, or responsible persons signing this delivery ticket. This is in your interest. Please read this ticket carefully, and inspect material, agreeing quantity, quality and that everything is to your satisfaction before finally signing this receipt note. We regret we cannot under any circumstances entertain any claims concerning quantity or quality, once the vehicle has left the site and a clear signature has been given.

Customers ordering vehicles off the public road do so entirely on their own responsibility. We cannot accept responsibility for damage caused by our vehicles while delivering to your site.

All materials delivered to site remain the property of the vendor until paid for in full.

Certified that the above particulars are true and relate to the aggregate, non-hazardous materials and arising materials being conveyed or disposed of in pursuance of the sale.

Received By

Print Name

Signed for and on behalf of the seller

Print Name

**Robert**

Date

**05/03/18****PRODUCER/CURRENT HOLDER OF WASTE**

Full Name

**Charlotte St Janie Cain**

Address

**Charlotte STREET**

The waste hierarchy has been considered in deciding the most appropriate waste management option.

S/C Code

**43/11-3****WASTE CARRIER'S DETAILS**Registered Carriers Name **Primagrang**Address **1 & 2 Ivy Cottages, Sandy Lane, Orpington, Kent BR5 3HY**Registered Carriers No. **CB/MP3015DG** Issued By**DESCRIPTION OF WASTE**

- ☐ 17.01.01 Concrete    ☐ 17.01.02 Bricks    ☐ 17.01.07 Hardcore    ☐ Brown Clay / Blue Clay  
☐ 17.04.07 Mixed Metals    ☐ 17.05.04 Soil & Stones    ☐ 17.02.01 Wood  
☐ 17.09.04 Mixed Demolition /Construction    ☒ Other **Non HAZ**

**DISPOSAL FACILITY DETAILS**

Site Operator's Signature

Print Name

Site Name

Address

**M. W. Harts**  
**Shepton**



## Conveyance Note (Form C Combined Weight and Volume)

Weights and Measures Act 1963, Schedule 5, Paragraph 7

### Keltbray Group

Waste Carriers Licence No. CBDU84378

LOADED AT	DATE OF LEAVING PLACE OF LOADING
WITCHEA X	05/04/2015

Name & Address of Site: 80 CHARLOTTE STREET  
LONDON

Time on Site: 11:20		Time off Site: 11:30		Load No. 09	
REGISTERED NO. OF VEHICLE		NAME OF PERSON IN CHARGE OF VEHICLE			
FA62HLV		B...			
CUBIC METRES (IN WORDS)	DESCRIPTION OF MATERIAL	TONNES			
15m	non HAZ	GROSS			
		TARE			
		NETT			

N.B. To customers, authorised agents, representatives, or responsible persons signing this delivery ticket. This is in your interest. Please read this ticket carefully, and inspect material, agreeing quantity, quality and that everything is to your satisfaction before finally signing this receipt note. We regret we cannot under any circumstances entertain any claims concerning quantity or quality, once the vehicle has left the site and a clear signature has been given.

Customers ordering vehicles off the public road do so entirely on their own responsibility. We cannot accept responsibility for damage caused by our vehicles while delivering to your site.

All materials delivered to site remain the property of the vendor until paid for in full.

Certified that the above particulars are true and relate to the aggregate, sub-based materials and arising materials being conveyed or disposed of in pursuance of the sale.

Received By: [Signature] Print Name: [Name]

Signed for and on behalf of the seller

Print Name

Date 5/2/15

Job No.

No. C 519118

### PRODUCER/CURRENT HOLDER OF WASTE

Full Name: Keltbray  
Address: 51 Millers Road, Esher, Surrey KT10 9TA

The waste hierarchy has been considered in deciding the most appropriate waste management option.

SIC Code: 43 / 1102 W4 0941

### WASTE CARRIER'S DETAILS

Registered Carriers Name: Keltbray  
Address: CBDU84378

Registered Carriers No. Issued By

### DESCRIPTION OF WASTE

- ☐ 17.01.01 Concrete ☐ 17.01.02 Bricks ☐ 17.01.07 Hardcore ☐ Brown Clay / Blue Clay  
☐ 17.04.07 Mixed Metals ☐ 17.05.04 Soil & Stones ☐ 17.02.01 Wood  
☐ 17.09.04 Mixed Demolition/Construction ☒ Other non HAZ

### DISPOSAL FACILITY DETAILS

Site Operator's Signature

Print Name: Michael K...

Site Name: Ashfield Road, Surrey

Address: E12 3 926H

## Conveyance Note (Form C Combined Weight and Volume)

Weights and Measures Act 1963, Schedule 5, Paragraph 7

### Kellbray Group

Waste Carriers Licence No. CBDU84378

LOADED AT	DATE OF LEAVING PLACE OF LOADING
WITHA X	05/02/2018

Name & Address of Site:

80 CHARLOTTE STREET  
LONDON

Time on Site: 11:25	Time off Site: 11:40	Load No. 10
---------------------	----------------------	-------------

REGISTERED NO. OF VEHICLE	NAME OF PERSON IN CHARGE OF VEHICLE
EY12VGL	B. Bagnall

CUBIC METRES (IN WORDS)	DESCRIPTION OF MATERIAL	TONNES									
15m	NON-HAZ	<table> <tr> <td>GROSS</td><td></td><td></td></tr> <tr> <td>TARE</td><td></td><td></td></tr> <tr> <td>NET</td><td></td><td></td></tr> </table>	GROSS			TARE			NET		
GROSS											
TARE											
NET											

N.B. To customer, authorised agents, representatives, or responsible persons signing this delivery ticket. This is in your interest. Please read this ticket carefully, and inspect material, agreeing quantity, quality and that everything is to your satisfaction before finally signing this receipt note. We regret we cannot under any circumstances entertain any claims concerning quantity or quality, once the vehicle has left the site and a clear signature has been given.

Customers ordering vehicles off the public road do so entirely on their own responsibility. We cannot accept responsibility for damage caused by our vehicles while delivering to your site.

All materials delivered to site remain the property of the vendor until paid for in full.

Certified that the above particulars are true and relate to the aggregate, topsoil, material and arising materials being conveyed or disposed of in pursuance of the sale.

Received By: [Signature] Print Name: [Signature]

Signed for and on behalf of the seller

Print Name

Date 5/2/18

Job No.

No. C 519119

### PRODUCER/CURRENT HOLDER OF WASTE

Full Name

Address

Kellbray  
St Andrew's House  
Post Office Road, Essex  
Surrey KT10 9TA

The waste hierarchy has been considered in deciding the most appropriate waste management option.

SIC Code:

### WASTE CARRIER'S DETAILS

Registered Carriers Name

Address

Registered Carriers No.

Issued By

### DESCRIPTION OF WASTE

- ☐ 17.01.01 Concrete 
 ☐ 17.01.02 Bricks 
 ☐ 17.01.07 Hardcore 
 ☐ Brown Clay/Blue Clay  
☐ 17.04.07 Mixed Metals 
 ☐ 17.05.04 Soil & Stones 
 ☐ 17.02.01 Wood  
☐ 17.09.04 Mixed Demolition/Construction 
 ☒ Other NON HAZ

### DISPOSAL FACILITY DETAILS

Site Operator's Signature

Print Name

Site Name

Address

Wickhams Wharf  
E16 2AY  
E16 30 9Z LH

## Conveyance Note (Form C Combined Weight and Volume)

Weights and Measures Act 1963, Schedule 5, Paragraph 7

### Keltbray Group

Waste Carriers Licence No. CBDU84378

LOADED AT	DATE OF LEAVING PLACE OF LOADING
WIT4AX	05/02/18

### Name & Address of Site:

50 Charlton Street London

Time on Site: 11:30 Time off Site: 11:45 Load No. 12

REGISTERED NO. OF VEHICLE NAME OF PERSON IN CHARGE OF VEHICLE

KM65 XYD

JOSE

CUBIC METRES (IN WORDS)	DESCRIPTION OF MATERIAL	TONNES
15m	non-HAZ	GROSS TARE NETT

N.B. To customers, authorised agents, representatives, or responsible persons signing this delivery ticket. This is in your interest. Please read this ticket carefully, and inspect material, agreeing quantity, quality and that everything is to your satisfaction before finally signing this receipt note. We regret we cannot under any circumstances entertain any claims concerning quantity or quality, once the vehicle has left the site and a clear signature has been given.

Customers ordering vehicles off the public road do so entirely on their own responsibility. We cannot accept responsibility for damage caused by our vehicles while delivering to your site.

All materials delivered to site remain the property of the vendor until paid for in full.

Certified that the above particulars are true and relate to the aggregates, sub-based materials and arising materials being conveyed or disposed of in pursuance of the sale.

Received By:  Print Name

Signed for and on behalf of the seller

Print Name

Date

05/02/18

Job No. 139436 No. C 519121

### PRODUCER/CURRENT HOLDER OF WASTE

Full Name

Address

Full Name: Keltbray  
Address: 51 Andrew's House  
115 South Road, Chess  
Surrey KT10 9TA

The waste hierarchy has been considered in deciding the most appropriate waste management option.

SIC Code:

43110 wif 0941

### WASTE CARRIER'S DETAILS

Registered Carriers Name

Address

Registered Carriers Name: Prima Range  
Address: CBMP 3015 DG

Registered Carriers No.

Issued By

### DESCRIPTION OF WASTE

- ☐ 17.01.01 Concrete ☐ 17.01.02 Bricks ☐ 17.01.07 Hardcore ☐ Brown Clay/Blue Clay  
☐ 17.04.07 Mixed Metals ☐ 17.05.04 Soil & Stones ☐ 17.02.01 Wood  
☐ 17.09.04 Mixed Demolition/Construction ☒ Other

### DISPOSAL FACILITY DETAILS

Site Operator's Signature

Print Name

Site Name

Address

Print Name: John W. Walf  
Site Name: 115 South Road, Chess  
Address: WIT4AX Surrey KT10 9TA



# PRIMAGRANGE LTD

## Haulage Conveyance Note (Form C Combined Weight and Volume)

Weights and Measures Act 1983, Schedule 5, Paragraph 7

519121 No. H 139436

### PRIMAGRANGE LTD

Waste Carriers Licence No. CB/MP3015DG

LOADED AT W1	DATE OF LEAVING PLACE OF LOADING 05-02-18
-----------------	--

Name &amp; Address of Site:

CHARLOTTE ST

Time on Site: 11:30	Time off Site: 11:45	Load No.
---------------------	----------------------	----------

REGISTERED NO. OF VEHICLE KM65XYD	NAME OF PERSON IN CHARGE OF VEHICLE JOSE
--------------------------------------	---

CUBIC METRES (IN WORDS)	DESCRIPTION OF MATERIAL	TONNES
1 load	NON HAZ	
		GROSS
		TARE
		NETT

N.B. To customers authorised agents, representatives, or responsible persons signing this delivery ticket. This is in your interest. Please read this ticket carefully, and inspect material, agreeing quantity, quality and that everything is to your satisfaction before finally signing this receipt note. We regret we cannot under any circumstances entertain any claims concerning quantity or quality, once the vehicle has left the site and a clear signature has been given.

Customers ordering vehicles off the public road do so entirely on their own responsibility. We cannot accept responsibility for damage caused by our vehicles while delivering to your site.

All materials delivered to site remain the property of the vendor until paid for in full.

Certified that the above particulars are true and relate to the aggregated, sub-based materials and arising materials being conveyed or disposed of in pursuance of the sale.

Received By Print Name

Signed for and on behalf of the seller

Print Name

Rebel

Date 05/02/18

### PRODUCER/CURRENT HOLDER OF WASTE

Full Name

Address

KELT BRA

The waste hierarchy has been considered in deciding the most appropriate waste management option.

S/C Code 413/11-0

### WASTE CARRIER'S DETAILS

Registered Carriers Name Primagranger

Address 1 & 2 Ivy Cottages, Sandy Lane,  
Orpington, Kent BR5 3HY

Registered Carriers No. CB/MP3015DG Issued By

### DESCRIPTION OF WASTE

- ☐ 17.01.01 Concrete 
 ☐ 17.01.02 Bricks 
 ☐ 17.01.07 Hardcore 
 ☐ Brown Clay / Blue Clay  
☐ 17.04.07 Mixed Metals 
 ☐ 17.05.04 Soil & Stones 
 ☐ 17.02.01 Wood  
☐ 17.09.04 Mixed Demolition /Construction 
 ☒ Other NON-HAZ

### DISPOSAL FACILITY DETAILS

Site Operator's Signature

Print Name

Site Name

Address

Date and Time of Transfer

MOHAWK WHARF  
SILVERTOWN

## Conveyance Note (Form C Combined Weight and Volume)

Weights and Measures Act 1963, Schedule 5, Paragraph 7

### Keltbray Group

Waste Carriers Licence No. GBDU84378

LOADED AT W174AX	DATE OF LEAVING PLACE OF LOADING 05/02/15
---------------------	--

#### Name & Address

of Site:

Time on Site: 12.15		Time off Site: 12.25		Load No. 13
REGISTERED NO. OF VEHICLE SN64TXH		NAME OF PERSON IN CHARGE OF VEHICLE HGVN		
CUBIC METRES (IN WORDS) 15m	DESCRIPTION OF MATERIAL non-HAZ	GROSS		
		TARE		
		NETT		

N.B. To customers, authorised agents, representatives, or responsible persons signing this delivery ticket. This is in your interest. Please read this ticket carefully, and inspect material, agreeing quantity, quality and that everything is to your satisfaction, before finally signing this receipt note. We regret we cannot under any circumstances entertain any claims concerning quantity or quality, once the vehicle has left the site and a clear signature has been given.

Customers ordering vehicles off the public road do so entirely on their own responsibility. We cannot accept responsibility for damage caused by our vehicles while delivering to your site.

All materials delivered to site remain the property of the vendor until paid for in full.

Certified that the above particulars are true and relate to the aggregate, sub-based materials and arising materials being conveyed or disposed of in pursuance of this note.

Received By: A. HGVN Print Name: HGVN

Signed for and on behalf of the seller

Print Name

Date

Job No.

No. **C 519122**

### PRODUCER/CURRENT HOLDER OF WASTE

Full Name

Address

The waste hierarchy has been considered in deciding the most appropriate waste management option.

SIC Code:

### WASTE CARRIER'S DETAILS

Registered Carriers Name

Address

Registered Carriers No.

Issued By

### DESCRIPTION OF WASTE

- ☐ 17.01.01 Concrete 
 ☐ 17.01.02 Bricks 
 ☐ 17.01.07 Hardcore 
 ☐ Brown Clay/Blue Clay  
☐ 17.04.07 Mixed Metals 
 ☐ 17.05.04 Soil & Stones 
 ☐ 17.02.01 Wood  
☐ 17.09.04 Mixed Demolition/Construction 
 ☒ Other non-HAZ

### DISPOSAL FACILITY DETAILS

Site Operator's Signature

Print Name

Site Name

Address



**Conveyance Note** (Form C Combined Weight and Volume)  
Weights and Measures Act 1963, Schedule 5, Paragraph 7

**Keltbray Group**

Waste Carriers Licence No. CBDU84378

LOADED AT <b>W174AX</b>	DATE OF LEAVING PLACE OF LOADING <b>05/02/2018</b>
----------------------------	---

**Name & Address of Site:**

**St Charles the Street, London**

Time on Site: <b>12.55</b> Time off Site: <b>13.10</b> Load No. <b>144</b>	
REGISTERED NO. OF VEHICLE <b>EU06EEF</b>	NAME OF PERSON IN CHARGE OF VEHICLE <b>John</b>
CUBIC METRES (IN WORDS) <b>15m</b>	DESCRIPTION OF MATERIAL <b>non-HAZE</b>
	TONNES
	GROSS
	TARE
	NETT

N.B. To customers, authorised agents, representatives, or responsible persons signing this delivery ticket. This is in your interest. Please read this ticket carefully, and inspect material, agreeing quantity, quality and that everything is to your satisfaction before finally signing this receipt note. We regret we cannot under any circumstances entertain any claims concerning quantity or quality, once the vehicle has left the site and a clear signature has been given.

Customers ordering vehicles off the public road do so at their own responsibility. We cannot accept responsibility for damage caused by our vehicles while delivering to your site.

All materials delivered to site remain the property of the vendor until paid for in full.

Certified that the above particulars are true and relate to the aggregates, sub-based materials and arising materials being conveyed or disposed of in pursuance of the sale.

Received By **[Signature]** Print Name **John**

Signed for and on behalf of the seller

Print Name

Date **05/02/18**

Job No. **1297**

No. **C 519123**

**PRODUCER/CURRENT HOLDER OF WASTE**

Full Name **Keltbray**  
Address **St Charles the Street, London**  
**Surrey KT10 9TA**

The waste hierarchy has been considered in deciding the most appropriate waste management option.

SIC Code: **43.11.0 wif 0941**

**WASTE CARRIER'S DETAILS Evolution**

Registered Carriers Name **Evolution**  
Address **B1WAP 55426**

Registered Carriers No. **Issued By**

**DESCRIPTION OF WASTE**

- ☐ 17.01.01 Concrete ☐ 17.01.02 Bricks ☐ 17.01.07 Hardcore ☐ Brown Clay/Blue Clay  
☐ 17.04.07 Mixed Metals ☐ 17.05.04 Soil & Stones ☐ 17.02.01 Wood  
☐ 17.09.04 Mixed Demolition/Construction ☒ Other

**DISPOSAL FACILITY DETAILS**

Site Operator's Signature

Print Name **Michael Wharf**

Site Name **Brookfield Road, Silver Town**

Address **E16 2AX**

**05/02/18**

23 Hillside Road • Dartford • Kent DA1 3NT

T: 07722 475763 E: evolutionhaulage@bt.com

**Haulage Conveyance Note** (Form C Combined Weight and Volume)

Weights and Measures Act 1963, Schedule 5, Paragraph 7

519123 No. H 1297

**FORS**FLEET OPERATOR  
RECORDING IS MANDATORY

ID:006062

Waste Carriers Licence No. CB/GE5546GQ

LOADED AT	DATE OF LEAVING PLACE OF LOADING		
	05/02/2018		
To & Address			
80 Charlotte St			
On Site:		Time off Site:	Load No.
REGISTERED NO. OF VEHICLE		NAME OF PERSON IN CHARGE OF VEHICLE	
U06EEF		John	
C METRES [WORDS]	DESCRIPTION OF MATERIAL	TONNES	
5	NON HAZ stone	GROSS	
		TARE	
		NETT	

carriers, authorized agents, representatives, or responsible persons signing this delivery ticket. This is in your interest. Please check carefully, and inspect material, agreeing quantity, quality and that everything is to your satisfaction before finally signing this note. We regret we cannot under any circumstances entertain any claims concerning quantity or quality, once the vehicle has been signed and a clear signature has been given.

vehicles off the public road do so entirely on their own responsibility. We cannot accept responsibility for damage to our vehicles while delivering to your site.

delivered to site remains the property of the vendor until paid for in full.

as shown on the invoice and relate to the aggregates, sub-based materials and other materials being conveyed or removed from the site.

Print Name J. Vallas  
and on  
the seller  
Date 05/02/18  
Dated

**PRODUCER/CURRENT HOLDER OF WASTE**

Full Name

Address

The waste hierarchy has been considered in deciding the most appropriate waste management option.

SIC Code:

**WASTE CARRIER'S DETAILS**

Registered Carriers Name Evolution Haulage Ltd

Address

23 Hillside Road, Dartford, Kent DA1 3NT

Registered Carriers No.

CB/GE5546GQ

Issued By

EA SHEFFIELD

**DESCRIPTION OF WASTE**

- ☐ 17.01.01 Concrete ☒ 17.01.02 Bricks ☐ 17.01.07 Hardcore ☐ Brown Clay/Blue Clay  
☐ 17.04.07 Mixed Metals ☒ 17.05.04 Soil & Stones ☐ 17.02.01 Wood  
☐ 17.09.04 Mixed Demolition/Construction ☐ Other

**DISPOSAL FACILITY DETAILS**

Site Operator's Signature

Print Name

Site Name

Address

John Vallas  
Vallas Wharf

## Conveyance Note (Form C Combined Weight and Volume)

Weights and Measures Act 1963, Schedule 5, Paragraph 7

### Keltbray Group

Waste Carriers Licence No. CBDU84378

LOADED AT	DATE OF LEAVING PLACE OF LOADING
W174AX	05/02/18

### Name & Address

of Site: Bocharlotte Street, London

Time on Site: <u>13:00</u>		Time off Site: <u>13:15</u>		Load No. <u>15</u>
REGISTERED NO. OF VEHICLE <u>FF61GNV</u>		NAME OF PERSON IN CHARGE OF VEHICLE <u>Chris</u>		
CUBIC METRES (IN WORDS)	DESCRIPTION OF MATERIAL	TONNES		
<u>15m</u>	<u>non-haz</u>	GROSS		
		TARE		
		NETT		

N.B. To customers, authorised agents, representatives, or responsible persons signing this delivery ticket. This is in your interest. Please read this ticket carefully, and inspect material, agreeing quantity, quality and that everything is to your satisfaction before finally signing this receipt note. We regret we cannot under any circumstances entertain any claims concerning quantity or quality, once the vehicle has left the site and a clear signature has been given.

Customers ordering vehicles on the public road do so entirely on their own responsibility. We cannot accept responsibility for damage caused by our vehicles while delivering to your site.

All materials delivered to site remain the property of the vendor until paid for in full.

Certified that the above particulars are true and relate to the aggregate, sub-based materials and arising materials being conveyed or disposed of in pursuance of the sale.

Received By: [Signature] Print Name: [Signature]

Signed for and on behalf of the seller

Print Name

Date 10/01/18

Job No. 145516

No. **C 519124**

### PRODUCER/CURRENT HOLDER OF WASTE

Full Name Keltbray  
Address St Andrew's House  
Portsmouth Road, Esher  
Surrey KT10 9TA

The waste hierarchy has been considered in deciding the most appropriate waste management option.

SIC Code: 43.110 Wif 0941

### WASTE CARRIER'S DETAILS

Registered Carriers Name Keltbray  
Address CHIMP 3015 DG

Registered Carriers No. [Blank] Issued By [Blank]

### DESCRIPTION OF WASTE

- ☐ 17.01.01 Concrete ☐ 17.01.02 Bricks ☐ 17.01.07 Hardcore ☐ Brown Clay/Blue Clay
- ☐ 17.04.07 Mixed Metals ☐ 17.05.04 Soil & Stones ☐ 17.02.01 Wood
- ☐ 17.09.04 Mixed Demolition/Construction ☒ Other

### DISPOSAL FACILITY DETAILS

Site Operator's Signature: [Signature]  
Print Name [Signature]  
Site Name [Signature]  
Address W174AX



**Haulage Conveyance Note** (Form C Combined Weight and Volume)  
 Weights and Measures Act 1963, Schedule 5, Paragraph 7
No. **H 145516/519124****PRIMAGRANGE LTD**

Waste Carriers Licence No. CB/MP3015DG

LOADED AT <b>KB</b>	DATE OF LEAVING PLACE OF LOADING <b>S. 2.18</b>
------------------------	--

Name & Address  
of Site:**KB Charlotte St**Time on Site: **13.05** Time off Site: **13.15** Load No.

REGISTERED NO. OF VEHICLE <b>KE E F61GNV</b>	NAME OF PERSON IN CHARGE OF VEHICLE <b>Chris</b>
---	---

CUBIC METRES (IN WORDS)	DESCRIPTION OF MATERIAL	TONNES									
<b>15m</b>	<b>non haz.</b>	<table> <tr><td>GROSS</td><td></td><td></td></tr> <tr><td>TARE</td><td></td><td></td></tr> <tr><td>NETT</td><td></td><td></td></tr> </table>	GROSS			TARE			NETT		
GROSS											
TARE											
NETT											

N.B. To customers authorised agents, representatives, or responsible persons signing this delivery ticket. This is in your interest. Please read this ticket carefully, and inspect material, agreeing quantity, quality and that everything is to your satisfaction before finally signing this receipt note. We regret we cannot under any circumstances entertain any claims concerning quantity or quality, once the vehicle has left the site and a clear signature has been given.

Customers ordering vehicles off the public road do so entirely on their own responsibility. We cannot accept responsibility for damage caused by our vehicles while delivering to your site.

All materials delivered to site remain the property of the vendor until paid for in full.

Certified that the above particulars are true and relate to the aggregate, sub-basid materials and arising materials being conveyed or disposed of in pursuance of the sale.

Received By

Print Name

Signed for and on  
behalf of the seller  
Print Name**R. Rubel**

Date

**05/02/18****PRODUCER/CURRENT HOLDER OF WASTE**

Full Name

Address

**KB Charlotte St**

The waste hierarchy has been considered in deciding the most appropriate waste management option.

S/C Code **43/31.0****WASTE CARRIER'S DETAILS**Registered Carriers Name **Primagranger**Address **1 & 2 Ivy Cottages, Sandy Lane,  
Orpington, Kent BR5 3HY**Registered Carriers No. **CB/MP3015DG** Issued By**DESCRIPTION OF WASTE**

- ☐ 17.01.01 Concrete ☐ 17.01.02 Bricks ☐ 17.01.07 Hardcore ☐ Brown Clay / Blue Clay  
☐ 17.04.07 Mixed Metals ☐ 17.05.04 Soil & Stones ☐ 17.02.01 Wood  
☐ 17.09.04 Mixed Demolition / Construction ☐ Other

**DISPOSAL FACILITY DETAILS**

Site Operator's Signature

Print Name

Site Name

Address

**M. Wharfs  
Silvertown**

Date and Time of Transfer

## Conveyance Note (Form C Combined Weight and Volume)

Weights and Measures Act 1963, Schedule 5, Paragraph 7

### Keltbray Group

Waste Carriers Licence No. CBDU84378

LOADED AT	DATE OF LEAVING PLACE OF LOADING
WIT4AX	05/02/18

### Name & Address of Site:

80 Charlotte Street, London

Time on Site: 13.15	Time off Site: 13.25	Load No. 16
---------------------	----------------------	-------------

REGISTERED NO. OF VEHICLE	NAME OF PERSON IN CHARGE OF VEHICLE
KX14 LOH	KICRAN

CUBIC METRES (IN WORDS)	DESCRIPTION OF MATERIAL	TONNES		
		GROSS	TARE	NETT
15m	NON-HAZ			

N.B. To customers, authorised agents, representatives, or responsible persons signing the delivery ticket. This is in your interest. Please read this ticket carefully, and inspect material, agreeing quantity, quality and that everything is to your satisfaction before finally signing this receipt note. We regret we cannot under any circumstances entertain any claims concerning quantity or quality, once the vehicle has left the site and a clear signature has been given.

Customers ordering vehicles off the public road do so entirely on their own responsibility. We cannot accept responsibility for damage caused by our vehicles while delivering to your site.

All materials delivered to site remain the property of the vendor until paid for in full.

Certified that the above particulars are true and relate to the aggregate, sub-base materials and arising materials being conveyed or disposed of in pursuance of the sale.

Received By: <i>[Signature]</i>	Print Name: <i>[Signature]</i>
---------------------------------	--------------------------------

Signed for and on behalf of the seller

Print Name

Date: 05/02/18

Job No.

No. **C 519125**

### PRODUCER/CURRENT HOLDER OF WASTE

Full Name	Keltbray
Address	St. Andrews House Pittsmeath Road, Esher Surrey KT10 9TA

The waste hierarchy has been considered in deciding the most appropriate waste management option.

SIC Code: 43.110 Wf 0941

### WASTE CARRIER'S DETAILS

Registered Carriers Name	Hobart Haulage
Address	CBDU84378
Registered Carriers No.	Issued By

### DESCRIPTION OF WASTE

<input type="checkbox"/> 17.01.01 Concrete	<input type="checkbox"/> 17.01.02 Bricks	<input type="checkbox"/> 17.01.07 Hardcore	<input type="checkbox"/> Brown Clay/Blue Clay
<input type="checkbox"/> 17.04.07 Mixed Metals	<input type="checkbox"/> 17.05.04 Soil & Stones	<input type="checkbox"/> 17.02.01 Wood	
<input type="checkbox"/> 17.09.04 Mixed Demolition/Construction	<input checked="" type="checkbox"/> Other <i>non HAZ</i>		

### DISPOSAL FACILITY DETAILS

Site Operator's Signature	
Print Name	McWilliams
Site Name	1622 Ave Road, Esher
Address	KT10 9TA

## Conveyance Note (Form C Combined Weight and Volume)

Weights and Measures Act 1963, Schedule 5, Paragraph 7

Waste Carriers Licence No. CBDU153984

LOADED AT	DATE OF LEAVING PLACE OF LOADING
	5/2/18

Name & Address  
of Site:80 CHARLOTTE ST.  
LONDON

Time on Site:	Time off Site:	Load No.
REGISTERED NO. OF VEHICLE	NAME OF PERSON IN CHARGE OF VEHICLE	
KY14 LOH	KIERAN	
CUBIC METRES (IN WORDS)	DESCRIPTION OF MATERIAL	TONNES
15M	STEEL now HAZ	GROSS TARE NETT

N.B. To customers, authorised agents, representatives, or responsible persons signing this delivery ticket. This is in your interest. Please read the ticket carefully, and inspect material, agreeing quantity, quality and that everything is to your satisfaction before finally signing this receipt note. We regret we cannot under any circumstances entertain any claims concerning quantity or quality, once the vehicle has left the site and a clear signature has been given.

Customers entering vehicles off the public road do so entirely on their own responsibility. We cannot accept responsibility for damage caused by our vehicles while delivering to your site.

All materials delivered to site remain the property of the vendor until paid for in full.

Certified that the above particulars are true and relate to the aggregate, sub-based materials and arising materials being conveyed or disposed of in pursuance of the sale.

Received By

Print Name

Signed for and on  
behalf of the seller

Print Name

Robe

Date

05/02/18

519125

CN

000043

### PRODUCER/CURRENT HOLDER OF WASTE

Full Name

Address

KELTGRAM

The waste hierarchy has been considered in deciding the most appropriate waste management option.

SIC Code:

43,110

### WASTE CARRIER'S DETAILS

Registered Carriers Name

Address

HOBAN

CBDU 153984

Registered Carriers No.

Issued By

### DESCRIPTION OF WASTE

- ☐ 17.01.01 Concrete ☐ 17.01.02 Bricks ☐ 17.01.07 Hardcore ☐ Brown Clay/Blue Clay  
☐ 17.04.07 Mixed Metals ☐ 17.05.04 Soil & Stones ☐ 17.02.01 Wood  
☐ 17.09.04 Mixed Demolition/Construction ☒ Other now HAZ

### DISPOSAL FACILITY DETAILS

Site Operator's Signature

Print Name

Site Name

Address

MOWACR

Date and Time of Transfer



## Conveyance Note (Form C Combined Weight and Volume)

Weights and Measures Act 1963, Schedule 5, Paragraph 7

### Keltbray Group

Waste Carriers Licence No. CBDU84378

LOADED AT W174AX	DATE OF LEAVING PLACE OF LOADING 05/02/18
---------------------	--

### Name & Address of Site:

50 Charlotte Street, London

Time on Site: 11.25		Time off Site: 11.55		Load No. 11	
REGISTERED NO. OF VEHICLE SN64 TXL		NAME OF PERSON IN CHARGE OF VEHICLE MUS			
CUBIC METRES (IN WORDS) 15m	DESCRIPTION OF MATERIAL non-HAZ	GROSS			
		TARE			
		NETT			

N.B. To customers, authorised agents, representatives, or responsible persons signing this delivery ticket. This is in your interest. Please read this ticket carefully, and inspect material, agreeing quantity, quality and test everything is to your satisfaction before finally signing this receipt note. We regret we cannot under any circumstances entertain any claims concerning quantity or quality, once the vehicle has left the site and a clear signature has been given.

Customers ordering vehicles off the public road do so entirely on their own responsibility. We cannot accept responsibility for damage caused by our vehicles while delivering to your site.

All materials delivered to site remain the property of the vendor until paid for in full.

Guarantee that the above particulars are true and relate to the aggregate, sub-based materials and among materials being conveyed or disposed of in pursuance of the sale.

Received By: M. C. MAZ Print Name

Signed for and on behalf of the seller

Print Name

Date 10/2/18

Job No.

No. C 519120

### PRODUCER/CURRENT HOLDER OF WASTE

Full Name Keltbray  
Address St Andrews House  
Portsmouth Road, Esher  
Surrey KT10 9TA

The waste hierarchy has been considered in deciding the most appropriate waste management option.

SIC Code: 43 / 110 wif 0941

### WASTE CARRIER'S DETAILS

Registered Carriers Name Keltbray  
Address CBDU 84378

Registered Carriers No. Issued By

### DESCRIPTION OF WASTE

- ☐ 17.01.01 Concrete ☐ 17.01.02 Bricks ☐ 17.01.07 Hardcore ☐ Brown Clay / Blue Clay  
☐ 17.04.07 Mixed Metals ☐ 17.05.04 Soil & Stones ☐ 17.02.01 Wood  
☐ 17.09.04 Mixed Demolition/Construction ☒ Other non HAZ

### DISPOSAL FACILITY DETAILS

Site Operator's Signature

Print Name M. C. MAZ

Site Name Esher Road, Esher town

Address Esher Road, Esher town

**Conveyance Note** (Form C Combined Weight and Volume)  
Weights and Measures Act 1963, Schedule 5, Paragraph 7

## Keltbray Group

Waste Carriers Licence No. CBDU84378

LOADED AT <b>WIT4AX</b>	DATE OF LEAVING PLACE OF LOADING <b>05/02/10</b>
----------------------------	---

### Name & Address

of Site: **80 Charlotte Street, London**

Time on Site: <b>13.30</b> Time off Site: <b>13.40</b> Load No. <b>17</b>	
REGISTERED NO. OF VEHICLE <b>EY12 YGL</b>	NAME OF PERSON IN CHARGE OF VEHICLE <b>B. Bayraktar</b>
CUBIC METRES (IN WORDS) <b>15m non-HAZ</b>	DESCRIPTION OF MATERIAL <b>non-HAZ</b>
	TONNES
	GROSS
	TARE
	NETT

N.B. To customers, authorised agents, representatives, or responsible persons signing this delivery ticket. This is in your interests. Please read this ticket carefully, and inspect material, agreeing quantity, quality and that everything is to your satisfaction before finally signing this receipt note. We regret we cannot under any circumstances entertain any claims concerning quantity or quality, once the vehicle has left the site and a clear signature has been given.

Customers ordering vehicles off the public road do so entirely on their own responsibility. We cannot accept responsibility for damage caused by our vehicles while delivering to your site.

All materials delivered to site remain the property of the vendor until paid for in full.

Declared that the above particulars are true and relate to the aggregates, sub-base materials and eroding materials being conveyed or disposed of in pursuance of the sale.

Received By **[Signature]** Print Name **[Signature]**

Signed for and on behalf of the seller

Print Name

Date **05/02/10**

Job No.

No. **C 519126**

### PRODUCER/CURRENT HOLDER OF WASTE

Full Name **Keltbray**

Address **80 Charlotte Street, London**

**Surrey KT10 9TA, Coker**

**Surrey KT10 9TA**

The waste hierarchy has been considered in deciding the most appropriate waste management option.

SIC Code: **43.110 1941**

### WASTE CARRIER'S DETAILS

Registered Carriers Name **Keltbray**

Address **CBDU 84378**

Registered Carriers No. **[Blank]** Issued By **[Blank]**

### DESCRIPTION OF WASTE

- ☐ 17.01.01 Concrete ☐ 17.01.02 Bricks ☐ 17.01.07 Hardcore ☐ Brown Clay / Blue Clay
- ☐ 17.04.07 Mixed Metals ☐ 17.05.04 Soil & Stones ☐ 17.02.01 Wood
- ☐ 17.09.04 Mixed Demolition/Construction ☐ Other **non-HAZ**

### DISPOSAL FACILITY DETAILS

Site Operator's Signature **[Signature]**

Print Name **[Signature]**

Site Name **[Signature]**

Address **[Signature]**

**WIT4AX**

**05/02/10**

Date and Time of Transfer

**Conveyance Note** (Form C Combined Weight and Volume)  
Weights and Measures Act 1963, Schedule 5, Paragraph 7

**Keltbray Group**

Waste Carriers Licence No. CBDU84378

LOADED AT <u>WIT 4AX</u>	DATE OF LEAVING PLACE OF LOADING <u>03/02/18</u>
-----------------------------	---

**Name & Address**

of Site: 80 Charlville Street, London

Time on Site: <u>13:40</u> Time off Site: <u>13:50</u> Load No. <u>15</u>				
REGISTERED NO. OF VEHICLE <u>CA 62 ALU</u>	NAME OF PERSON IN CHARGE OF VEHICLE <u>Boumelo</u>			
CUBIC METRES (IN WORDS) <u>15m</u>	DESCRIPTION OF MATERIAL <u>NON HAZ</u>	GROSS		
		TARE		
		NETT		

N.B. To customers, authorized agents, representatives, or responsible persons signing this delivery ticket. This is in your interest. Please read this ticket carefully, and inspect material, agreeing quantity, quality and that everything is to your satisfaction before finally signing this receipt note. We regret we cannot under any circumstances entertain any claims concerning quantity or quality, once the vehicle has left the site and a clear signature has been given.

Customers ordering vehicles off the public road do so entirely on their own responsibility. We cannot accept responsibility for damage caused by our vehicles while delivering to your site.

All materials delivered to site remain the property of the vendor until paid for in full.

Certified that the above particulars are true and relate to the aggregate, sub-based materials and arising materials being conveyed or disposed of in pursuance of the sale.

Received By Boumelo Print Name Boumelo

Signed for and on behalf of the seller

Print Name

Date 03/02/18

**Job No.**

**No. C 519128**

**PRODUCER/CURRENT HOLDER OF WASTE**

Full Name Keltbray  
Address St Andrew's House  
Portsmouth Road, Esher  
Surrey KT10 9TA

The waste hierarchy has been considered in deciding the most appropriate waste management option.

SIC Code: 43/110 WIF 0941

**WASTE CARRIER'S DETAILS**

Registered Carriers Name Keltbray  
Address CTD 84378  
Registered Carriers No. \_\_\_\_\_ Issued By \_\_\_\_\_

**DESCRIPTION OF WASTE**

- ☐ 17.01.01 Concrete ☐ 17.01.02 Bricks ☐ 17.01.07 Hardcore ☐ Brown Clay/Blue Clay  
☐ 17.04.07 Mixed Metals ☐ 17.05.04 Soil & Stones ☐ 17.02.01 Wood  
☐ 17.09.04 Mixed Demolition/Construction ☒ Other NON HAZ

**DISPOSAL FACILITY DETAILS**

Site Operator's Signature \_\_\_\_\_  
Print Name Michael Vincent  
Site Name St Andrew's  
Address Portsmouth Road, Esher  
Surrey KT10 9TA



## Conveyance Note (Form C Combined Weight and Volume)

Weights and Measures Act 1963, Schedule 5, Paragraph 7

### Keltbray Group

Waste Carriers Licence No. CBDU84378

LOADED AT	DATE OF LEAVING PLACE OF LOADING
WILT44V	05/02/19

### Name & Address

of Site:

80 Charlton Street, London

Time on Site: 13.55	Time off Site: 14.05	Load No. 19
---------------------	----------------------	-------------

REGISTERED NO. OF VEHICLE	NAME OF PERSON IN CHARGE OF VEHICLE
SA14 TXH	HONAN

CUBIC METRES (IN WORDS)	DESCRIPTION OF MATERIAL	TONNES									
15m	non-HAZ	<table> <tr> <td>GROSS</td><td></td><td></td></tr> <tr> <td>TARE</td><td></td><td></td></tr> <tr> <td>NETT</td><td></td><td></td></tr> </table>	GROSS			TARE			NETT		
GROSS											
TARE											
NETT											

N.B. To customers, authorised agents, representatives, or responsible persons signing this delivery ticket. This is in your interest. Please read this ticket carefully, and inspect material, agreeing quantity, quality and that everything is to your satisfaction before finally signing the receipt note. We regret we cannot under any circumstances entertain any claims concerning quantity or quality, once the vehicle has left the site and a clear signature has been given.

Customers ordering vehicles off the public road do so entirely on their own responsibility. We cannot accept responsibility for damage caused by our vehicles while delivering to your site.

All materials delivered to site remain the property of the vendor until paid for in full.

Certified that the above particulars are true and relate to the aggregate, sub-base materials and other materials being conveyed or disposed of in pursuance of the order.

Received By: [Signature] Print Name: HONAN

Signed for and on behalf of the seller

Print Name

Date: 05/02/19

Job No.

No. C 519129

### PRODUCER/CURRENT HOLDER OF WASTE

Full Name

Address

Keltbray  
St. Andrew's House  
1st Floor, 100, Easton  
Surrey KT10 9TA

The waste hierarchy has been considered in deciding the most appropriate waste management option.

SIC Code:

43, 110 015 0941

### WASTE CARRIER'S DETAILS

Registered Carriers Name

Address

Keltbray  
CBDU 84378

Registered Carriers No.

Issued By

### DESCRIPTION OF WASTE

- ☐ 17.01.01 Concrete ☐ 17.01.02 Bricks ☐ 17.01.07 Hardcore ☐ Brown Clay/Blue Clay  
☐ 17.04.07 Mixed Metals ☐ 17.05.04 Soil & Stones ☐ 17.02.01 Wood  
☐ 17.09.04 Mixed Demolition/Construction ☐ Other: non-HAZ

### DISPOSAL FACILITY DETAILS

Site Operator's Signature

Print Name

Site Name

Address

Mr. [Signature]  
100, Easton  
Surrey KT10 9TA  
530926H

**Conveyance Note** (Form C Combined Weight and Volume)  
Weights and Measures Act 1963, Schedule 5, Paragraph 7

## Keltbray Group

Waste Carriers Licence No. CBDU84378

LOADED AT	DATE OF LEAVING PLACE OF LOADING
WIT4AV	05/02/2018

Name & Address  
of Site:

80 Charlotte Street, London

Time on Site: 12.10		Time off Site: 12.20		Load No. 20	
REGISTERED NO. OF VEHICLE		NAME OF PERSON IN CHARGE OF VEHICLE			
KM165 XYD		JOSE			
CUBIC METRES (IN WORDS)	DESCRIPTION OF MATERIAL	TONNES			
		GROSS			
		TARE			
15m	NON HAZ	NETT			
<small>N.B. To customers, authorised agents, representatives, or responsible persons signing this delivery ticket. This is in your interest. Please read this ticket carefully, and inspect material, agreeing quantity, quality and that everything is to your satisfaction before finally signing this receipt note. We regret we cannot under any circumstances entertain any claims concerning quantity or quality, once the vehicle has left the site and a clear signature has been given.</small>					
<small>Customers ordering vehicles off the public road do so entirely on their own responsibility. We cannot accept responsibility for damage caused by our vehicles while delivering to your site.</small>					
<small>All materials delivered to site remain the property of the vendor until paid for in full.</small>					
<small>Certified that the above particulars are true and relate to the aggregated, sub-bagged materials and arising materials being conveyed or disposed of in pursuance of the sale.</small>					
Received By _____ Print Name _____					

Signed for and on  
behalf of the seller

Print Name \_\_\_\_\_

Date

5/2/18

Job No.

No. C 519130

PRODUCER/CURRENT HOLDER OF WASTE

1394137

Full Name

Address

Keltbray

St Andrew's House

127-129 High Road, Esher

Surrey KT10 9TA

The waste hierarchy has been considered in deciding the most appropriate waste management option.

SIC Code: 13.11.0

## WASTE CARRIER'S DETAILS

Registered Carriers Name

Address

Primaging

Registered Carriers No.

issued By

## DESCRIPTION OF WASTE

- ☐ 17.01.01 Concrete ☐ 17.01.02 Bricks ☐ 17.01.07 Hardcore ☐ Brown Clay / Blue Clay  
☐ 17.04.07 Mixed Metals ☒ 17.05.04 Soil & Stones ☐ 17.02.01 Wood  
☐ 17.09.04 Mixed Demolition/Construction ☒ Other NON HAZ

## DISPOSAL FACILITY DETAILS

Site Operator's Signature

Print Name

Site Name

Address

Mohamud

Broadfield Road

(F53042211)

Date and Time of Transfer

# PRIMAGRANGE LTD

**Haulage Conveyance Note** (Form C Combined Weight and Volume)  
Weights and Measures Act 1963, Schedule 5, Paragraph 7

No. **H 139437/519130**

## PRIMAGRANGE LTD

Waste Carriers Licence No. CB/MP3015DG

LOADED AT <b>W1</b>	DATE OF LEAVING PLACE OF LOADING <b>05-02-18</b>
------------------------	---

Name & Address  
of Site:

**CHARLOTTE ST**

Time on Site: <b>14:10</b>	Time off Site: <b>14:20</b>	Load No.
----------------------------	-----------------------------	----------

REGISTERED NO. OF VEHICLE <b>KM65XYD</b>	NAME OF PERSON IN CHARGE OF VEHICLE <b>JOSE</b>
---	--

CUBIC METRES (IN WORDS)	DESCRIPTION OF MATERIAL	TONNES
<b>1 Load</b>	<b>NON-HA2</b>	GROSS
		TARE
		NETT

N.B. To customers authorised agents, representatives, or responsible persons signing this delivery ticket. This is in your interest. Please read this ticket carefully, and inspect material, agreeing quantity, quality and that everything is to your satisfaction before finally signing this receipt note. We regret we cannot under any circumstances entertain any claims concerning quantity or quality, once the vehicle has left the site and a clear signature has been given.

Customers ordering vehicles off the public road do so entirely on their own responsibility. We cannot accept responsibility for damage caused by our vehicles while delivering to your site.

All materials delivered to site remain the property of the vendor until paid for in full.

Certified that the above particulars are true and relate to the aggregates, sub-based materials and arising materials being conveyed or disposed of in pursuance of the sale.

Received By

Print Name

Signed for and on  
behalf of the seller

Print Name

Date **5/2/18**

## PRODUCER/CURRENT HOLDER OF WASTE

Full Name

Address

**KELTBRAY**

The waste hierarchy has been considered in deciding the most appropriate waste management option.

S/C Code **43/110**

## WASTE CARRIER'S DETAILS

Registered Carriers Name **Primagranger**  
Address **1 & 2 Ivy Cottages, Sandy Lane,**  
**Orpington, Kent BR5 3HY**  
Registered Carriers No. **CB/MP3015DG** Issued By

## DESCRIPTION OF WASTE

☐ 17.01.01 Concrete ☐ 17.01.02 Bricks ☐ 17.01.07 Hardcore ☐ Brown Clay / Blue Clay  
☐ 17.04.07 Mixed Metals ☐ 17.05.04 Soil & Stones ☐ 17.02.01 Wood  
☐ 17.09.04 Mixed Demolition /Construction ☒ Other **NON-HA2**

## DISPOSAL FACILITY DETAILS

Site Operator's Signature

Print Name

Site Name

Address

Date and Time of Transfer

**MOORHOLE WHARF**  
**SILVER TOWN**



**Conveyance Note** (Form C Combined Weight and Volume)  
Weights and Measures Act 1963, Schedule 5, Paragraph 7

**Keltbray Group**

Waste Carriers Licence No. CBDU84378

LOADED AT <i>WIT-HAZ</i>	DATE OF LEAVING PLACE OF LOADING <i>05/02/2018</i>
-----------------------------	---

Name & Address of Site: *50 CHARLOTTE STREET LONDON*

Time on Site: <i>1425</i>		Time off Site: <i>1440</i>		Load No. <i>21</i>	
REGISTERED NO. OF VEHICLE <i>SN64 TX2</i>		NAME OF PERSON IN CHARGE OF VEHICLE <i>MUS</i>			
CUBIC METRES (IN WORDS) <i>15m</i>	DESCRIPTION OF MATERIAL <i>WIT-HAZ</i>	GROSS			
		TARE			
		NETT			

M.R. To customers, authorised agents, representatives, or responsible persons signing this delivery ticket. This is in your interest. Please read this ticket carefully, and inspect material, agreeing quantity, quality and that everything is to your satisfaction before finally signing this receipt note. We regret we cannot under any circumstances entertain any claims concerning quantity or quality, once the vehicle has left the site and a clear signature has been given.

Customers ordering vehicles off the public road do so entirely on their own responsibility. We cannot accept responsibility for damage caused by our vehicles while delivering to your site.

All materials delivered to site remain the property of the vendor until paid for in full.

Certified that the above particulars are true and relate to the aggregates, sub-base materials and arising materials being conveyed or disposed of in pursuance of the sale.

Received By: *M. Elmas* Print Name

Signed for and on behalf of the seller

Print Name

Date *05/02/18*

Job No.

No. **C 519131**

**PRODUCER/CURRENT HOLDER OF WASTE**

Full Name

Address

*Keltbray  
STANLEY'S HOUSE  
PORTSMOUTH ROAD  
SURREY KT10 9TA*

The waste hierarchy has been considered in deciding the most appropriate waste management option.

SIC Code:

*23.11.0*

**WASTE CARRIER'S DETAILS**

Registered Carriers Name

Address

Registered Carriers No.

Issued By

**DESCRIPTION OF WASTE**

- ☐ 17.01.01 Concrete ☐ 17.01.02 Bricks ☐ 17.01.07 Hardcore ☐ Brown Clay/Blue Clay  
☐ 17.04.07 Mixed Metals ☐ 17.05.04 Soil & Stones ☐ 17.02.01 Wood  
☐ 17.09.04 Mixed Demolition/Construction ☒ Other *WIT-HAZ*

**DISPOSAL FACILITY DETAILS**

Site Operator's Signature

Print Name

Site Name

Address

Date and Time of Transfer

*Michael Wilbert  
135 rlf. Rd  
(17.05.04)*

## Conveyance Note (Form C Combined Weight and Volume)

Weights and Measures Act 1963, Schedule 5, Paragraph 7

### Keltbray Group

Waste Carriers Licence No. CBDU84378

LOADED AT	DATE OF LEAVING PLACE OF LOADING
WIT4AX	05/02/2018

Name &amp; Address of Site:

80 CHARLOTTE STREET  
MILNOR

Time on Site: 15:15 Time off Site: 15:15 Load No. 22

REGISTERED NO. OF VEHICLE	NAME OF PERSON IN CHARGE OF VEHICLE
FA67 HLU	Paul H. 10

CUBIC METRES (IN WORDS)	DESCRIPTION OF MATERIAL	TONNES
15m	NOM HAZ	GROSS TARE NETT

N.B. To customers, authorized agents, representatives, or responsible persons signing this delivery ticket. This is in your interest. Please read this ticket carefully, and inspect material, signing quantity, quality and that everything is to your satisfaction before finally signing this receipt note. We regret we cannot under any circumstances entertain any claims concerning quantity or quality, once the vehicle has left the site and a clear signature has been given.

Customers ordering vehicles off the public road do so entirely on their own responsibility. We cannot accept responsibility for damage caused by our vehicles while delivering to your site.

All materials delivered to site remain the property of the vendor until paid for in full.

Confirmed that the above particulars are true and relate to the aggregated, sub-based materials and arising materials being conveyed or disposed of in pursuance of the sale.

Received By: [Signature] Print Name: [Signature]

Signed for and on behalf of the seller

Print Name

Date 5/2/18

Job No.

No. C 519132

### PRODUCER/CURRENT HOLDER OF WASTE

Full Name

Address

Keltbray  
St Andrew's House  
Portsmouth Road.

The waste hierarchy has been considered in deciding the most appropriate waste management option.

SIC Code:

43.11.0

### WASTE CARRIER'S DETAILS

Registered Carriers Name

Address

Registered Carriers No.

Issued By

### DESCRIPTION OF WASTE

- ☐ 17.01.01 Concrete ☐ 17.01.02 Bricks ☐ 17.01.07 Hardcore ☐ Brown Clay / Blue Clay  
☐ 17.04.07 Mixed Metals ☐ 17.05.04 Soil & Stones ☐ 17.02.01 Wood  
☐ 17.09.04 Mixed Demolition/Construction ☒ Other NOM HAZ

### DISPOSAL FACILITY DETAILS

Site Operator's Signature

Print Name

Site Name

Address

Date and Time of Transfer

Mon, 11th Feb 2018  
Road.  
(FP 3242)

## Conveyance Note (Form C Combined Weight and Volume)

Weights and Measures Act 1963, Schedule 5, Paragraph 7

### Keltbray Group

Waste Carriers Licence No. CBDU84378

LOADED AT <b>WIT4AX</b>	DATE OF LEAVING PLACE OF LOADING <b>15/02/18</b>
----------------------------	---

### Name & Address

of Site: **80 Charlotte Street, London**

Time on Site: <b>15.20</b>		Time off Site: <b>15.35</b>		Load No. <b>23</b>	
REGISTERED NO. OF VEHICLE <b>EY12 YGL</b>		NAME OF PERSON IN CHARGE OF VEHICLE <b>B Bayralshev</b>			
CUBIC METRES (IN WORDS)	DESCRIPTION OF MATERIAL	TONNES			
<b>15m</b>	<b>non-HAZ</b>	GROSS			
		TARE			
		NETT			

N.B. To customers, authorised agents, representatives, or responsible persons signing this delivery ticket. This is in your interest. Please read this ticket carefully, and inspect material, agreeing quantity, quality and test everything to your satisfaction before finally signing this receipt note. We regret we cannot under any circumstances entertain any claims concerning quantity or quality, once the vehicle has left the site and a clear signature has been given.

Customers ordering vehicles off the public road do so entirely on their own responsibility. We cannot accept responsibility for damage caused by our vehicles while delivering to your site.

All materials delivered to site remain the property of the vendor until paid for in full.

Certified that the above particulars are true and relate to the aggregate, sub-base material and filling materials being conveyed or deposited at in pursuance of the sale.

Received By: **[Signature]** Print Name: **[Signature]**

Signed for and on behalf of the seller

Print Name

Date

**15/02/18**

### Job No.

No. **C 519133**

### PRODUCER/CURRENT HOLDER OF WASTE

Full Name

Address

The waste hierarchy has been considered in deciding the most appropriate waste management option.

SIC Code:

**43.110 wif 0941**

### WASTE CARRIER'S DETAILS

Registered Carriers Name

Address

Registered Carriers No.

Issued By

### DESCRIPTION OF WASTE

- ☐ 17.01.01 Concrete 
 ☐ 17.01.02 Bricks 
 ☐ 17.01.07 Hardcore 
 ☐ Brown Clay / Blue Clay  
☐ 17.04.07 Mixed Metals 
 ☐ 17.05.04 Soil & Stones 
 ☐ 17.02.01 Wood  
☐ 17.09.04 Mixed Demolition/Construction 
 ☒ Other **non HAZ**

### DISPOSAL FACILITY DETAILS

Site Operator's Signature

Print Name

Site Name

Address

Date and Time of Transfer



SOIL SAMPLING LOCATIONS

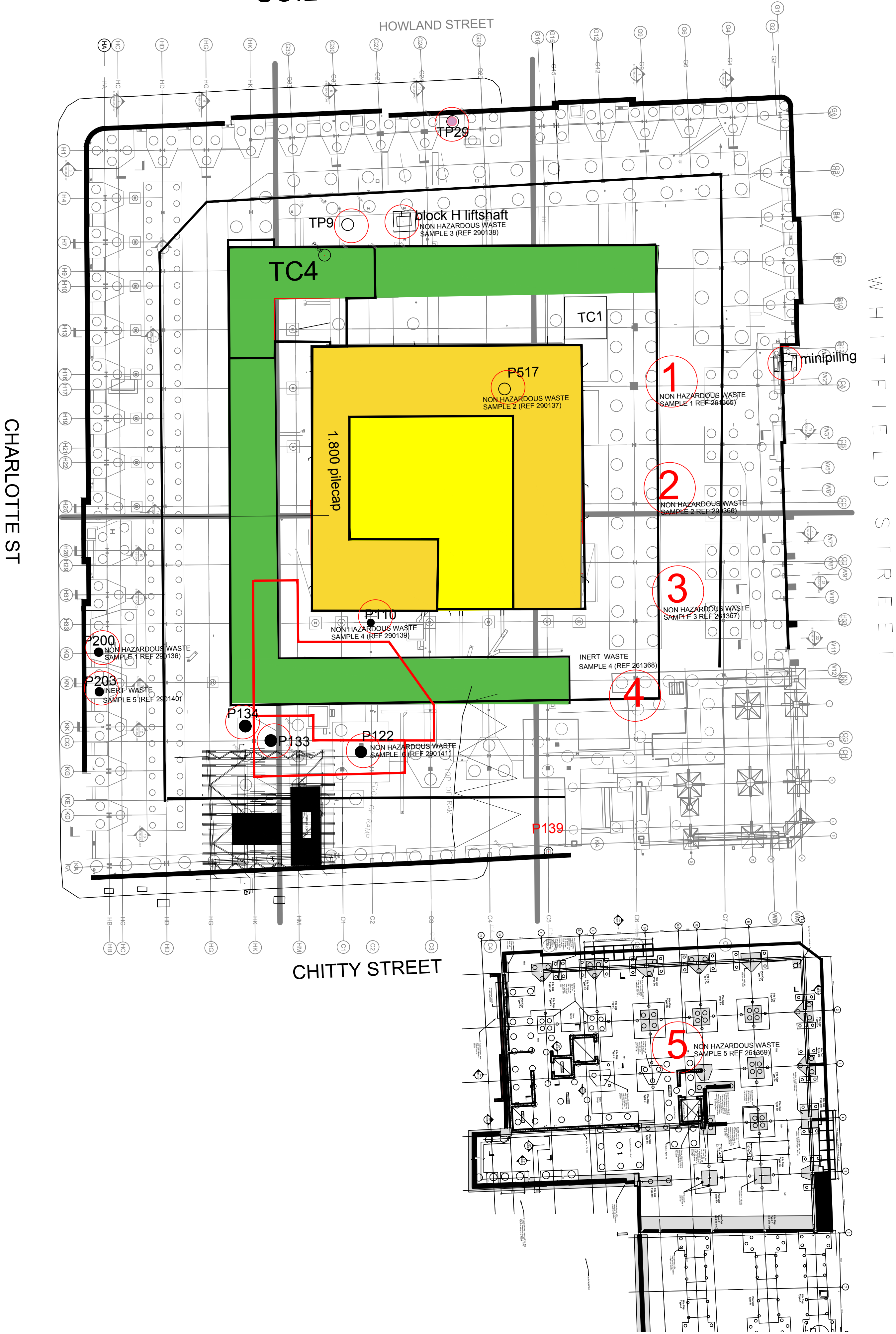

## **G2      Carrier license and waste facility permit**

---



E A NATIONAL CUSTOMER CONTACT CENTRE

THE QUADRANT

99 PARKWAY AVENUE

SHEFFIELD

S9 4WF



Environment  
Agency

The following information on this copy card is hereby certified by the Environment Agency to represent an authorised copy of the information currently (†) held on register that they maintain under Regulation 28 of the Waste (England and Wales) Regulations 2011.

SIGNATURE OF AUTHORISED  
OFFICER OF THE  
REGULATION AUTHORITY

DATE:

26 Apr 2016



Name of registered carrier: A.J (UK) LTD

Registration Number: CBDU101553

Business Name (if any): A.J (UK) LTD

Address of registered carrier's principal place of business:  
14 DEVONSHIRE ROAD

HORNCHURCH

RM12 4LQ

Telephone: 07904365300

Registration Date: 18 Apr 2016

Expiry Date (Unless revoked): 18 Apr 2019

(†) You can check whether there has been any changes to this certificate by phoning 03708 506 506 or by checking the public register at <http://www2.environment-agency.gov.uk/epr/search.asp?td=EP&type=register>



**BETA** This is a trial service – your feedback (<mailto:enquiries@environment-agency.gov.uk>) will help us to improve it.

---

[Home \(/public-register/view/index\)](/public-register/view/index) / [Search all \(/public-register/view/search-all\)](/public-register/view/search-all)  
/ Result from Waste Carriers and Brokers Public Register for England

## Registration CBDU204180 – Evolution Haulage Ltd

<b>Registration number</b>	CBDU204180
<b>Business name</b>	Evolution Haulage Ltd
<b>Company number</b>	09214714 ( <a href="http://business.data.gov.uk/id/company/09214714">http://business.data.gov.uk/id/company/09214714</a> )
<b>Registered as</b>	Carrier Dealer - Upper Tier
<b>Applicant type</b>	Company
<b>Registration date:</b>	11/10/2017
<b>Expiry date:</b>	30/10/2020

### Business address

<b>Address</b>	23, HILLSIDE ROAD, DARTFORD, DA1 3NT
<b>Postcode</b>	DA1 3NT ( <a href="http://data.ordnancesurvey.co.uk/id/postcodeunit/DA13NT">http://data.ordnancesurvey.co.uk/id/postcodeunit/DA13NT</a> )

[Back](#)

---

### Support

To contact the Environment Agency, please use [our contacts page](https://www.gov.uk/government/organisations/environment-agency#org-contacts).  
(<https://www.gov.uk/government/organisations/environment-agency#org-contacts>)

If you notice a problem with the data provided by this site, please [send us an email](mailto:enquiries@environment-agency.gov.uk)  
(<mailto:enquiries@environment-agency.gov.uk>).

[Privacy policy \(/public-register/view/privacy-policy\)](/public-register/view/privacy-policy)

Find out about the [use of cookies \(/public-register/view/cookie-policy\)](/public-register/view/cookie-policy) on this site.

## About this page



All content is available under the [Environment Agency Conditional Licence \(https://www.gov.uk/government/publications/environment-agency-conditional-licence/environment-agency-conditional-licence\)](https://www.gov.uk/government/publications/environment-agency-conditional-licence/environment-agency-conditional-licence), except where otherwise stated

Design and development by [Epimorphics \(http://www.epimorphics.com\)](http://www.epimorphics.com).

**BETA** This is a trial service – your feedback (<mailto:enquiries@environment-agency.gov.uk>) will help us to improve it.

---

[Home \(/public-register/view/index\)](/public-register/view/index) / [Search all \(/public-register/view/search-all\)](/public-register/view/search-all)  
/ Result from Waste Carriers and Brokers Public Register for England

## Registration CBDU153984 – Hoban Haulage Limited

<b>Registration number</b>	CBDU153984
<b>Business name</b>	Hoban Haulage Limited
<b>Company number</b>	10558188 ( <a href="http://business.data.gov.uk/id/company/10558188">http://business.data.gov.uk/id/company/10558188</a> )
<b>Registered as</b>	Carrier Dealer - Upper Tier
<b>Applicant type</b>	Company
<b>Registration date:</b>	14/01/2017
<b>Expiry date:</b>	14/01/2020

### Business address

<b>Address</b>	FLAT 16, URBAN BASE, BIRCHAM ROAD, SOUTHEND-ON-SEA, SS2 5FY
<b>Postcode</b>	SS2 5FY ( <a href="http://data.ordnancesurvey.co.uk/id/postcodeunit/SS25FY">http://data.ordnancesurvey.co.uk/id/postcodeunit/SS25FY</a> )

[Back](#)

### Support

To contact the Environment Agency, please use [our contacts page](https://www.gov.uk/government/organisations/environment-agency#org-contacts).  
(<https://www.gov.uk/government/organisations/environment-agency#org-contacts>)

If you notice a problem with the data provided by this site, please [send us an email](mailto:enquiries@environment-agency.gov.uk) (<mailto:enquiries@environment-agency.gov.uk>).



[Privacy policy \(/public-register/view/privacy-policy\)](/public-register/view/privacy-policy)

Find out about the [use of cookies \(/public-register/view/cookie-policy\)](/public-register/view/cookie-policy) on this site.

## About this page



All content is available under the [Environment Agency Conditional Licence \(https://www.gov.uk/government/publications/environment-agency-conditional-licence/environment-agency-conditional-licence\)](https://www.gov.uk/government/publications/environment-agency-conditional-licence/environment-agency-conditional-licence), except where otherwise stated

Design and development by [Epimorphics \(http://www.epimorphics.com\)](http://www.epimorphics.com).

[Back](#)

(<https://www.wastecarriersregistration.service.gov.uk/user/56a5db90776372136c3e0000/registrations?locale=en>)

## Certificate of Registration under the Waste (England and Wales) Regulations 2011

### Regulation authority

Name	 Environment Agency
Address	National Customer Service Centre 99 Parkway Avenue Sheffield S9 4WF
Telephone number	03708 506506

The Environment Agency certify that the following information is entered in the register which they maintain under regulation 28 of the Waste (England and Wales) Regulations 2011.

### Carriers details

Name of registered carrier	Keltbray Group Ltd
Registered as	an upper tier waste carrier
Registration number	CBDU84378
Address of place of business	Keltbray Group Ltd KELTBRAV GROUP LTD PORTSMOUTH ROAD ESHER KT10 9TA
Telephone number	0207 643 1091
Date of registration	Tuesday 26th January 2016
Expiry date of registration (unless revoked)	Sunday 17th February 2019

### Making changes to your registration

Your registration will last 3 years and will need to be renewed after this period. If any of your details change, you must notify us within 28 days of the change.

# Certificate of Registration under the Waste (England and Wales) Regulations 2011

## Regulation authority

Name



Environment  
Agency

Address

- National Customer Service Centre
- 99 Parkway Avenue
- Sheffield
- S9 4WF

Telephone number

03708 506506

The Environment Agency certify that the following information is entered in the register which they maintain under regulation 28 of the Waste (England and Wales) Regulations 2011.

## Carriers details

Name of registered carrier

Primagrang Ltd.

Registered as

an upper tier waste carrier

Registration number

CBDU86534

Address of place of business

Primagrang Ltd.  
PRIMAGRANGE LTD  
SANDY LANE  
ST. PAULS CRAY  
ORPINGTON  
BR5 3HY

Telephone number

01689 870400

Date of registration

Thursday 4th February  
2016

Expiry date of registration (unless  
revoked)

Sunday 17th February  
2019



**BETA** This is a trial service – your feedback (<mailto:enquiries@environment-agency.gov.uk>) will help us to improve it.

---

[Home \(/public-register/view/index\)](/public-register/view/index) / [Search all \(/public-register/view/search-all\)](/public-register/view/search-all)  
/ Result from Waste Carriers and Brokers Public Register for England

## Registration CBDU44332 – Silverbourne Limited

<b>Registration number</b>	CBDU44332
<b>Business name</b>	Silverbourne Limited
<b>Company number</b>	09439676 ( <a href="http://business.data.gov.uk/id/company/09439676">http://business.data.gov.uk/id/company/09439676</a> )
<b>Registered as</b>	Carrier Dealer - Upper Tier
<b>Applicant type</b>	Company
<b>Registration date:</b>	29/04/2015
<b>Expiry date:</b>	29/04/2018

### Business address

<b>Address</b>	2, THE HEIGHTS, LONDON, SE7 8JH
<b>Postcode</b>	SE7 8JH ( <a href="http://data.ordnancesurvey.co.uk/id/postcodeunit/SE78JH">http://data.ordnancesurvey.co.uk/id/postcodeunit/SE78JH</a> )

[Back](#)

---

### Support

To contact the Environment Agency, please use [our contacts page](https://www.gov.uk/government/organisations/environment-agency#org-contacts).  
(<https://www.gov.uk/government/organisations/environment-agency#org-contacts>)

If you notice a problem with the data provided by this site, please [send us an email](mailto:enquiries@environment-agency.gov.uk)  
(<mailto:enquiries@environment-agency.gov.uk>).

[Privacy policy \(/public-register/view/privacy-policy\)](/public-register/view/privacy-policy)

Find out about the [use of cookies \(/public-register/view/cookie-policy\)](/public-register/view/cookie-policy) on this site.

## About this page



All content is available under the [Environment Agency Conditional Licence \(https://www.gov.uk/government/publications/environment-agency-conditional-licence/environment-agency-conditional-licence\)](https://www.gov.uk/government/publications/environment-agency-conditional-licence/environment-agency-conditional-licence), except where otherwise stated

Design and development by [Epimorphics \(http://www.epimorphics.com\)](http://www.epimorphics.com).

## Permit with introductory note

The Environmental Permitting (England & Wales) Regulations 2010

---

Ingrebourne Valley Ltd

Ingrebourne Links

New Road  
Rainham  
Essex  
RM13 9ED

Permit number

EPR/LP3995VS



# Ingrebourne Links

## Permit Number EPR/LP3995VS

### Introductory note

***This introductory note does not form a part of the permit***

The main features of the permit are as follows.

This environmental permit allows the operator to store and subsequent use of waste for the purposes of construction work. The permit is for the recovery of waste only and does not apply to any activities involving disposal.

The status log of the permit sets out the permitting history, including any changes to the permit reference number

Status Log of the permit		
Detail	Date	Comments
Application EPR/LP3995VS/A001	Duly made 13/09/2010	
Permit determined	07/01/11	

End of Introductory Note

## Permit

The Environmental Permitting (England and Wales) Regulations 2010

## Permit

Permit number

**EPR/LP3995VS**

The Environment Agency hereby authorises, under regulation 13 of the Environmental Permitting (England and Wales) Regulations 2010

**Ingrebourne Valley Ltd** ("the operator"),

whose registered office is/whose principal office is

**Cecil House**

**Foster Street**

**Harlow Common**

**Harlow**

**Essex**

**CM17 9HY**

company registration number 02848746

to operate a waste operation at

**Ingrebourne Links**

**New Road**

**Rainham**

**Essex**

**RM13 9ED**

to the extent authorised by and subject to the conditions of this permit.

Name

Date

	<b>07/01/2011</b>
---	-------------------

**Kelly Bailey**

Authorised on behalf of the Environment Agency

# 1 Management

## 1.1 General management

- 1.1.1 The operator shall manage and operate the activities:
- (a) in accordance with a written management system that identifies and minimises risks of pollution, including those arising from operations, maintenance, accidents, incidents, non-conformances and those drawn to the attention of the operator as a result of complaints; and
  - (b) using sufficient competent persons and resources.
- 1.1.2 Records demonstrating compliance with condition 1.1.1 shall be maintained.
- 1.1.3 Any person having duties that are or may be affected by the matters set out in this permit shall have convenient access to a copy of it kept at or near the place where those duties are carried out.
- 1.1.4 The operator shall comply with the requirements of an approved competence scheme.

# 2 Operations

## 2.1 Permitted activities

- 2.1.1 The operator is only authorised to carry out the activities specified in schedule 1 table S1.1 (the “activities”).
- 2.1.2 The reclamation, restoration or improvement work subject to these conditions shall be completed in accordance with the details provided in the approved waste recovery plan, unless otherwise agreed in writing by the Environment Agency.
- 2.1.3 The operator shall submit to the Environment Agency for approval any revisions to the waste recovery plan and shall implement the approved revised plan in place of the original from the date of approval.
- 2.1.4 The quantities given in the approved recovery plan shall not be exceeded.
- 2.1.5 On completion of the reclamation, restoration or improvement work a survey of final waste levels relative to Ordnance Datum shall be submitted to the Environment Agency within one month.

## 2.2 The site

- 2.2.1 The activities shall not extend beyond the site, being the land shown edged in green on the site plan at schedule 7 to this permit.

## 2.3 Operating techniques

- 2.3.1 (a) The activities shall, subject to the conditions of this permit, be operated using the



techniques and in the manner described in the documentation specified in schedule 1, table S1.2, unless otherwise agreed in writing by the Environment Agency.

- (b) If notified by the Environment Agency that the activities are giving rise to pollution, the operator shall submit to the Environment Agency for approval within the period specified, a revision of any plan specified in schedule 1, table S1.2 or otherwise required under this permit, and shall implement the approved revised plan in place of the original from the date of approval, unless otherwise agreed in writing by the Environment Agency.

2.3.2 Waste shall only be accepted if:

- (a) it is of a type and quantity listed in schedule 2 table S2.1;
- (b) it has been identified as a suitable waste type in the approved waste recovery plan;
- (c) it conforms to the description in the documentation supplied by the producer and holder;
- (d) its chemical, physical and biological characteristics make it suitable for its intended use on the site;
- (e) any excavated soil from potentially contaminated sites has been shown by prior chemical analysis and assessment to be suitable for the intended use without significant risk of pollution; and
- (f) it is visually inspected on arrival and at the point of deposit to ensure that it complies with this permit.

2.3.3 Any waste that does not comply with 2.3.2 shall be rejected and shall be:

- (a) removed from the site; or
- (b) moved to a designated quarantine area pending removal.

2.3.4 Records demonstrating compliance with condition 2.3 (including analysis and assessment of any excavated soil from potentially contaminated sites) shall be maintained.

## **3 Emissions and monitoring**

### **3.1 Emissions of substances not controlled by emission limits**

3.1.1 Emissions of substances not controlled by emission limits (excluding odour) shall not cause pollution. The operator shall not be taken to have breached this condition if appropriate measures, including, but not limited to, those specified in any approved emissions management plan, have been taken to prevent or where that is not practicable, to minimise, those emissions.

3.1.2 The operator shall:

- (a) if notified by the Environment Agency that the activities are giving rise to pollution, submit to the Environment Agency for approval within the period specified, an emissions management plan;

- (b) implement the approved emissions management plan, from the date of approval, unless otherwise agreed in writing by the Environment Agency.

## **3.2 Odour**

- 3.2.1 Emissions from the activities shall be free from odour at levels likely to cause pollution outside the site, as perceived by an authorised officer of the Environment Agency, unless the operator has used appropriate measures, including, but not limited to, those specified in any approved odour management plan, to prevent or where that is not practicable to minimise the odour.
- 3.2.2 The operator shall:
  - (a) if notified by the Environment Agency that the activities are giving rise to pollution outside the site due to odour, submit to the Environment Agency for approval within the period specified, an odour management plan;
  - (b) implement the approved odour management plan, from the date of approval, unless otherwise agreed in writing by the Environment Agency.

## **3.3 Noise and vibration**

- 3.3.1 Emissions from the activities shall be free from noise and vibration at levels likely to cause pollution outside the site, as perceived by an authorised officer of the Environment Agency, unless the operator has used appropriate measures, including, but not limited to, those specified in any approved noise and vibration management plan to prevent or where that is not practicable to minimise the noise and vibration.
- 3.3.2 The operator shall:
  - (a) if notified by the Environment Agency that the activities are giving rise to pollution outside the site due to noise and vibration, submit to the Environment Agency for approval within the period specified, a noise and vibration management plan;
  - (b) implement the approved noise and vibration management plan, from the date of approval, unless otherwise agreed in writing by the Environment Agency.

# **4 Information**

## **4.1 Records**

- 4.1.1 All records required to be made by this permit shall:
  - (a) be legible;
  - (b) be made as soon as reasonably practicable;
  - (c) if amended, be amended in such a way that the original and any subsequent amendments remain legible, or are capable of retrieval; and
  - (d) be retained, unless otherwise agreed in writing by the Environment Agency, for at least 6 years from the date when the records were made, or in the case of the following records until permit surrender:
    - (i) off-site environmental effects; and

- (ii) matters which affect the condition of the land and groundwater.

- 4.1.2 The operator shall keep on site all records, plans and the management system required to be maintained by this permit, unless otherwise agreed in writing by the Environment Agency.

## **4.2 Reporting**

- 4.2.1 The operator shall send all reports and notifications required by the permit to the Environment Agency using the contact details supplied in writing by the Environment Agency.
- 4.2.2 Within one month of the end of each quarter, the operator shall submit to the Environment Agency using the form made available for the purpose, the information specified on the form relating to the site and the waste accepted and removed from it during the previous quarter.

## **4.3 Notifications**

- 4.3.1 The Environment Agency shall be notified without delay following the detection of:
  - (a) any malfunction, breakdown or failure of equipment or techniques, accident, or emission of a substance not controlled by an emission limit which has caused, is causing or may cause significant pollution;
  - (b) the breach of a limit specified in the permit; or
  - (c) any significant adverse environmental effects.
- 4.3.2 Any information provided under condition 4.3.1 shall be confirmed by sending the information listed in schedule 5 to this permit within the time period specified in that schedule.
- 4.3.3 Where the Environment Agency has requested in writing that it shall be notified when the operator is to undertake monitoring and/or spot sampling, the operator shall inform the Environment Agency when the relevant monitoring and/or spot sampling is to take place. The operator shall provide this information to the Environment Agency at least 14 days before the date the monitoring is to be undertaken.
- 4.3.4 The Environment Agency shall be notified within 14 days of the occurrence of the following matters, except where such disclosure is prohibited by Stock Exchange rules:

Where the operator is a registered company:

  - (a) any change in the operator's trading name, registered name or registered office address; and
  - (b) any steps taken with a view to the operator going into administration, entering into a company voluntary arrangement or being wound up.

Where the operator is a corporate body other than a registered company:

  - (a) any change in the operator's name or address; and
  - (b) any steps taken with a view to the dissolution of the operator.

In any other case:

- (a) the death of any of the named operators (where the operator consists of more than one named individual);
  - (b) any change in the operator's name(s) or address(es); and
  - (c) any steps taken with a view to the operator, or any one of them, going into bankruptcy, entering into a composition or arrangement with creditors, or, in the case of them being in a partnership, dissolving the partnership.
- 4.3.5 Where the operator proposes to make a change in the nature or functioning, or an extension of the activities, which may have consequences for the environment and the change is not otherwise the subject of an application for approval under the Regulations or this permit:
  - (a) the Environment Agency shall be notified at least 14 days before making the change; and
  - (b) the notification shall contain a description of the proposed change in operation.

## **4.4 Interpretation**

- 4.4.1 In this permit the expressions listed in schedule 6 shall have the meaning given in that schedule.
- 4.4.2 In this permit references to reports and notifications mean written reports and notifications, except where reference is made to notification being made "without delay", in which case it may be provided by telephone.



# Schedule 1 - Operations

Table S1.1 activities	
Description of activities for waste operations	Limits of activities
<b>R13:</b> Storage of waste pending any of the operations numbered R1 to R12.	Secure storage and use of wastes listed in table S2.1 for the purposes of reclamation, restoration or improvement of land as detailed in the approved waste recovery plan.  No more than 50,000 tonnes of waste shall be stored prior to treatment.
<b>R3:</b> Recycling/reclamation of organic substances which are not used as solvents  <b>R5:</b> Recycling/reclamation of other inorganic compounds.  <b>R11:</b> Use of wastes obtained from any of the operations numbered R01 to R10	Treatment consisting only of manual sorting, separation, screening or crushing of non-hazardous waste into different components.  The maximum quantity of waste treated shall not exceed 3000 tonnes per day.

Table S1.2 Operating techniques		
Description	Parts	Date Received
Waste Recovery Plan SLR Ref: 412.01526.00003/WRP	Waste Recovery Plan Approved 23/11/2010	13/08/2010
Waste Recovery Plan additional information SLR Ref: 412.01526.00003	Additional Information Approved 23/11/2010	15/11/2010
Site Operating Plan Dated August 2010	All	13/08/2010

## Schedule 2 - Waste types, raw materials and fuels

Table S2.1 Permitted waste types and quantities	
<b>Maximum quantity</b>	The maximum quantity of waste that can be accepted at the site shall be less than 600,000 tonnes per year.
<b>Exclusions</b>	<b>Exclusions</b> Wastes having any of the following characteristics shall not be accepted: <ul style="list-style-type: none"> <li>• Consisting solely or mainly of dusts, powders or loose fibres.</li> <li>• Wastes that are in a form which is liquid.</li> <li>• Hazardous wastes.</li> </ul>
<b>Waste code</b>	<b>Description</b>
<b>01</b>	<b>WASTES RESULTING FROM EXPLORATION, MINING, QUARRYING, AND PHYSICAL AND CHEMICAL TREATMENT OF MINERALS</b>
<b>0101</b>	<i>Wastes from mineral excavation</i>
010102	wastes from mineral non-metalliferous excavation
010408	waste gravel and crushed rocks other than those mentioned in 01 04 07
010409	waste sand and clays
<b>02</b>	<b>WASTES FROM AGRICULTURE, HORTICULTURE, AQUACULTURE, FORESTRY, HUNTING AND FISHING, FOOD PREPARATION AND PROCESSING</b>
<b>0204</b>	<i>Wastes from sugar processing</i>
020401	soil from cleaning and washing beet
<b>10</b>	<b>WASTES FROM THERMAL PROCESSES</b>
<b>1001</b>	<i>Wastes from power stations and other combustion plants (except 19)</i>
100102	pulverised fuel ash only
101208	waste ceramics, bricks, tiles and construction products (after thermal processing)
<b>17</b>	<b>CONSTRUCTION AND DEMOLITION WASTES (INCLUDING EXCAVATED SOIL FROM CONTAMINATED SITES)</b>
<b>1701</b>	<i>Concrete, bricks, tiles and ceramics</i>
170101*	concrete
170102*	bricks
170103*	tiles and ceramics
170107*	mixtures of concrete, bricks, tiles and ceramics other than those mentioned in 17 01 06
<b>1705</b>	<i>Soil (including excavated soil from contaminated sites), stones and dredging spoil</i>
170504	soil and stones including chalk other than those mentioned 17 05 03
170506	dredging spoil other than those mentioned in 17 05 05
170508	track ballast, soil and stones other than those mentioned in 17 05 07
<b>19</b>	<b>WASTES FROM WASTE MANAGEMENT FACILITIES, OFF SITE WASTE WATER TREATMENT PLANTS &amp; PREPARATION OF WATER INTENDED FOR HUMAN CONSUMPTION/INDUSTRIAL USE</b>
<b>1908</b>	<b>wastes from waste water treatment plants not otherwise specified</b>
190899	stone filter media (if cleaned to remove sewage contamination) only
<b>1912</b>	<i>Waste from the mechanical treatment of waste (for example sorting, crushing, compaction, pelletising) not otherwise specified</i>
191209	minerals (for example sand, stones)
<b>1913</b>	<i>Wastes from soil and groundwater remediation</i>
191302	solid wastes from soil remediation other than those mentioned in 19 13 01
<b>20</b>	<b>MUNICIPAL WASTES (HOUSEHOLD WASTE &amp; SIMILAR COMMERCIAL, INDUSTRIAL AND INSTITUTIONAL WASTES) INCLUDING SEPERATELY COLLECTED FRACTIONS</b>
<b>2002</b>	<i>Garden and parks wastes (including cemetery waste)</i>
200202*	soil and stones

## **Schedule 3 – Emissions and monitoring**

There are no emission limits or associated monitoring requirements

## **Schedule 4 - Reporting**

There is no reporting under this schedule.



## Schedule 5 - Notification

These pages outline the information that the operator must provide.

Units of measurement used in information supplied under Part A and B requirements shall be appropriate to the circumstances of the emission. Where appropriate, a comparison should be made of actual emissions and authorised emission limits.

If any information is considered commercially confidential, it should be separated from non-confidential information, supplied on a separate sheet and accompanied by an application for commercial confidentiality under the provisions of the EP Regulations.

### Part A

Permit Number	
Name of operator	
Location of Facility	
Time and date of the detection	

**(a) Notification requirements for any malfunction, breakdown or failure of equipment or techniques, accident, or emission of a substance not controlled by an emission limit which has caused, is causing or may cause significant pollution**

**To be notified within 24 hours of detection**

Date and time of the event	
Reference or description of the location of the event	
Description of where any release into the environment took place	
Substances(s) potentially released	
Best estimate of the quantity or rate of release of substances	
Measures taken, or intended to be taken, to stop any emission	
Description of the failure or accident.	

**(b) Notification requirements for the breach of a limit**

**To be notified within 24 hours of detection unless otherwise specified below**

Emission point reference/ source	
Parameter(s)	
Limit	
Measured value and uncertainty	
Date and time of monitoring	
Measures taken, or intended to be taken, to stop the emission	

Time periods for notification following detection of a breach of a limit	
Parameter	Notification period

(c) Notification requirements for the detection of any significant adverse environmental effect	
To be notified within 24 hours of detection	
Description of where the effect on the environment was detected	
Substances(s) detected	
Concentrations of substances detected	
Date of monitoring/sampling	

## Part B - to be submitted as soon as practicable

Any more accurate information on the matters for notification under Part A.	
Measures taken, or intended to be taken, to prevent a recurrence of the incident	
Measures taken, or intended to be taken, to rectify, limit or prevent any pollution of the environment which has been or may be caused by the emission	
The dates of any unauthorised emissions from the facility in the preceding 24 months.	

<b>Name*</b>	
<b>Post</b>	
<b>Signature</b>	
<b>Date</b>	

\* authorised to sign on behalf of the operator.

## Schedule 6 - Interpretation

*“accident”* means an accident that may result in pollution.

*“Annex IIA”* means Annex IIA to Directive 2006/12/EC of the European Parliament and of the Council of 5 April 2006 on Waste.

*“annually”* means once every year.

*“application”* means the application for this permit, together with any additional information supplied by the operator as part of the application and any response to a notice served under Schedule 5 to the EP Regulations.

*“authorised officer”* means any person authorised by the Environment Agency under section 108(1) of The Environment Act 1995 to exercise, in accordance with the terms of any such authorisation, any power specified in section 108(4) of that Act.

*“controlled substances”* means chlorofluorocarbons, other fully halogenated chlorofluorocarbons, halons, carbon tetrachloride, 1,1,1-trichloroethane, methyl bromide, hydrobromofluorocarbons and hydrochlorofluorocarbons listed in Annex I of Regulation (EC) No 2037/2000 of the European Parliament and of the Council of 29 June 2000 on substances that deplete the ozone layer, including their isomers, whether alone or in a mixture, and whether they are virgin, recovered, recycled or reclaimed. This definition shall not cover any controlled substance which is in a manufactured product other than a container used for the transportation or storage of that substance, or insignificant quantities of any controlled substance, originating from inadvertent or coincidental production during a manufacturing process, from unreacted feedstock, or from use as a processing agent which is present in chemical substances as trace impurities, or that is emitted during product manufacture or handling.

*“D”* means a disposal operation provided for in Annex IIA to Directive 2006/12/EC of the European Parliament and of the Council of 5 April 2006 on Waste.

*“emissions of substances not controlled by emission limits”* means emissions of substances to air, water or land from the activities, either from the emission points specified in schedule 3 or from other localised or diffuse sources, which are not controlled by an emission or background concentration limit.

*“emissions to land”* includes emissions to groundwater.

*“EP Regulations”* means The Environmental Permitting (England and Wales) Regulations SI 2010 No.675 and words and expressions used in this permit which are also used in the Regulations have the same meanings as in those Regulations.

*“groundwater”* means all water, which is below the surface of the ground in the saturation zone and in direct contact with the ground or subsoil.

*“groundwater protection zones 1 and 2”* have the meaning given in the document titled "Groundwater Protection: Policy and Practice" published by the Environment Agency in 2006.

*“hazardous waste”* has the meaning given in the Hazardous Waste (England and Wales) Regulations 2005 No.894, the Hazardous Waste (Wales) Regulations 2005 No. 1806 (W.138), the List of Wastes (England) Regulations 2005 No.895 and the List of Wastes (Wales) Regulations 2005 No. 1820 (W.148).

*"MCERTS"* means the Environment Agency's Monitoring Certification Scheme.

*"quarter"* means a calendar year quarter commencing on 1 January, 1 April, 1 July or 1 October.

*"R"* means a recovery operation provided for in Annex IIB to Directive 2006/12/EC of the European Parliament and of the Council of 5 April 2006 on Waste.

*"Waste code"* means the six digit code referable to a type of waste in accordance with the List of Wastes (England) Regulations 2005, or List of Wastes (Wales) Regulations 2005, as appropriate, and in relation to hazardous waste, includes the asterisk.

*"year"* means calendar year ending 31 December.



## Schedule 7 - Site plan

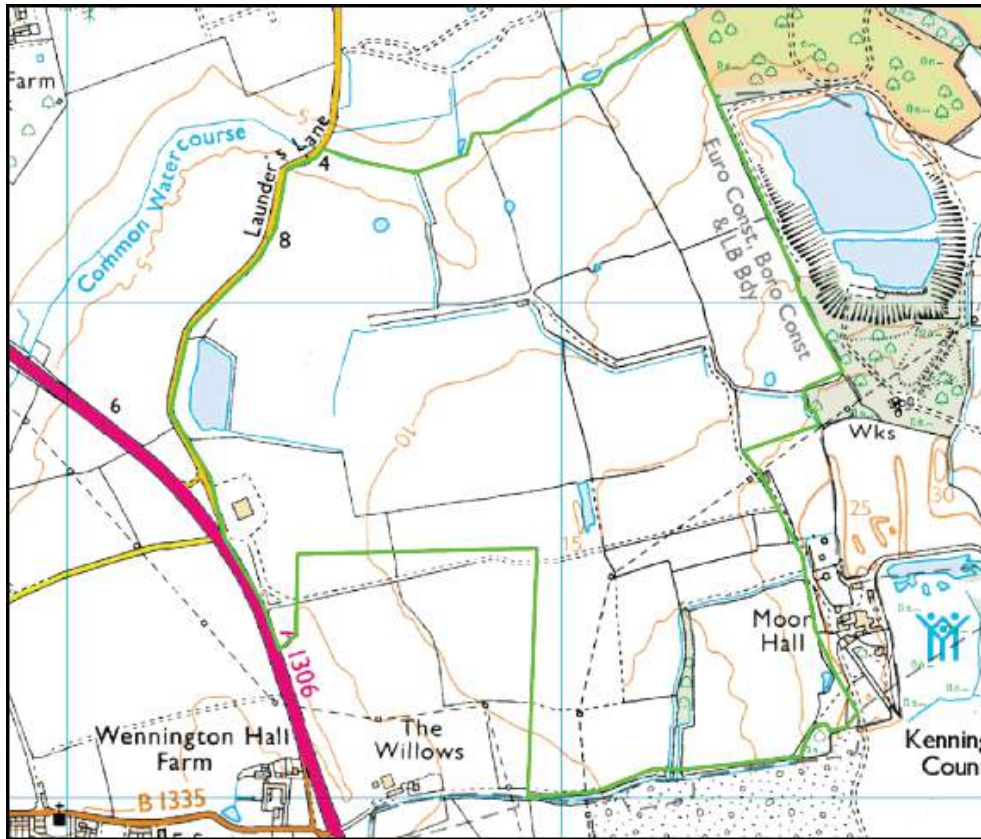

“© Crown Copyright. All rights reserved. Environment Agency, 100026380, 2011.”

END OF PERMIT

# Notice of variation and consolidation with introductory note

**The Environmental Permitting (England & Wales) Regulations 2010**

---

Keltbray AWS Limited

Mohawk Wharf Recycling Facility  
Bradfield Road  
Silvertown  
London  
E16 2AX

**Variation application number**

EPR/FP3092LH/V003

**Permit number**

EPR/FP3092LH

# Mohawk Wharf Recycling Facility

## Permit number EPR/FP3092LH

### Introductory note

#### **This introductory note does not form a part of the notice.**

Under the Environmental Permitting (England & Wales) Regulations 2010 (schedule 5, part 1, paragraph 19) a variation may comprise a consolidated permit reflecting the variations and a notice specifying the variations included in that consolidated permit.

Schedule 1 of the notice specifies the conditions that have been varied and schedule 2 comprises a consolidated permit which reflects the variations being made.

All the conditions of the permit have been varied and are subject to the right of appeal.

This variation amends the existing permit to add a soil treatment facility which will treat hazardous and non-hazardous wastes for recovery. The Facility will treat waste through the use of biopiles by means of biological remediation which shall involve incorporating micro-organism cultures into the biopiles to assist the remediation process. Wastes will be stored and treated on an impermeable surface with sealed drainage. Site mitigation in line with best available techniques is in place on site including a biofilter and dust suppression spray systems.

Mohawk Wharf Recycling Facility is located in Silvertown, East London on the banks of the River Thames (central grid reference TQ40395 79796). Waste soils and stones are transported to the installation from construction sites. Loads are initially weighed, then classified and segregated by an on-site chemist. The assessment of wastes from the construction sites are measured against the installation site acceptance criteria. Soil is then stored and stockpiled according to the level of contamination. Stockpiles are kept segregated to prevent cross contamination. Prior to treatment materials may be screened to remove oversized materials.

Soil cleaning techniques depend on the variation and concentration of pollutants in the soil. Soil suitable for biological treatment is stockpiled in biopiles in the treatment areas and, where required, treated by spraying with additives to enhance the biodegradation of hydrocarbons. Biopiles are then covered with an impermeable liner. Aeration via machine blower is also undertaken if necessary. Other treatments include soil stabilisation. Stockpiles are tested weekly by the site chemist. After reaching the site specific criteria the soils are transported to the Thames Wharf, loaded on to barges and transported via the River Thames to restoration sites.

Facilities on site comprise a weighbridge, site office, covered treatment zone capable of holding more than 7,500m<sup>3</sup> soil, storage areas for processing soil, on site water treatment facilities, heavy machine plant including wheeled shovel loaders and excavators, screeners and blowers, pipes and chemicals for soil treatment.

The site is covered in hard standing with sealed drainage throughout. All leachate collected within the treatment area is treated via the on-site water treatment plant and either re-used on site or tankered off site.

The schedules specify the changes made to the permit.

The status log of a permit sets out the permitting history, including any changes to the permit reference number.

<b>Status log of the permit</b>		
<b>Description</b>	<b>Date</b>	<b>Comments</b>
Application received EPR/FP3092LH/A001	Duly Made 05/10/2009	Application for standard rules application SR2008No11_75kte
Permit determined EPR/FP3092LH	11/12/2009	Permit issued to Keltbray AWS Limited
Application received EPR/FP3092LH/V002	Duly Made 05/10/2010	Application to vary from standard rules conditions to bespoke conditions to allow 70,000 tonnes a year of hazardous and non-hazardous construction, demolition and excavation waste
Additional Information received	05/11/2010	
Variation determined EPR/FP3092LH/V002	21/12/2010	Permit issued to Keltbray AWS Limited
Application EPR/FP3092LH/V003 (variation and consolidation)	Duly made 27/11/2014	Application to vary permit to include bioremediation treatment and update the permit to modern conditions
Response to Schedule 5 sent 27/01/2015	09/03/2015	Response to all questions detailing pre-acceptance procedures; waste acceptance procedures; waste classification, segregating and monitoring; waste rejection; record keeping and auditing; waste storage, sampling procedures; and treatment and all referenced supporting documentation
Response to Schedule 5 sent 27/01/2015 and request for further information sent 19/03/2015	02/04/2015	Response to all questions detailing waste acceptance procedures; dust suppression on site and treatment of non-hazardous waste
Variation determined EPR/FP3092LH/V003	28/04/2015	Varied and consolidated permit issued in modern condition format

End of introductory note

## Notice of variation and consolidation

### The Environmental Permitting (England and Wales) Regulations 2010

The Environment Agency in exercise of its powers under regulation 20 of the Environmental Permitting (England and Wales) Regulations 2010 varies and consolidates

#### Permit number

EPR/FP3092LH

#### Issued to

**Keltbray AWS Limited** (“the operator”)

whose registered office is

**St. Andrew's House  
Portsmouth Road  
Esher  
Surrey  
KT10 9TA**

company registration number 04836483

to operate a regulated facility at

**Mohawk Wharf Recycling Facility  
Bradfield Road  
Silvertown  
London  
E16 2AX**

to the extent set out in the schedules.

The notice shall take effect from 28/04/2015

Name	Date
Tom Swift	28/04/2015

Authorised on behalf of the Environment Agency



## **Schedule 1**

All conditions have been varied by the consolidated permit as a result of the application made by the operator.

## **Schedule 2 – consolidated permit**

Consolidated permit issued as a separate document.

# Permit

## The Environmental Permitting (England and Wales) Regulations 2010

### Permit number

**EPR/FP3092LH**

This is the consolidated permit referred to in the variation and consolidation notice for application EPR/FP3092LH/V003 authorising,

**Keltbray AWS Limited** (“the operator”),

whose registered office is

**St. Andrew's House  
Portsmouth Road  
Esher  
Surrey  
KT10 9TA**

company registration number 04836483

to operate an installation at

**Mohawk Wharf Recycling Facility  
Bradfield Road  
Silvertown  
London  
E16 2AX**

to the extent authorised by and subject to the conditions of this permit.

Name	Date
Tom Swift	28/04/2015

Authorised on behalf of the Environment Agency

# Conditions

## 1 Management

### 1.1 General management

- 1.1.1 The operator shall manage and operate the activities:
- (a) in accordance with a written management system that identifies and minimises risks of pollution, including those arising from operations, maintenance, accidents, incidents, non-conformances closure and those drawn to the attention of the operator as a result of complaints; and
  - (b) using sufficient competent persons and resources.
- 1.1.2 Records demonstrating compliance with condition 1.1.1 shall be maintained.
- 1.1.3 Any person having duties that are or may be affected by the matters set out in this permit shall have convenient access to a copy of it kept at or near the place where those duties are carried out.
- 1.1.4 The operator shall comply with the requirements of an approved competence scheme.

### 1.2 Energy efficiency

- 1.2.1 The operator shall:
- (a) take appropriate measures to ensure that energy is used efficiently in the activities;
  - (b) review and record at least every four years whether there are suitable opportunities to improve the energy efficiency of the activities; and
  - (c) take any further appropriate measures identified by a review.

### 1.3 Efficient use of raw materials

- 1.3.1 The operator shall:
- (a) take appropriate measures to ensure that raw materials and water are used efficiently in the activities;
  - (b) maintain records of raw materials and water used in the activities;
  - (c) review and record at least every four years whether there are suitable alternative materials that could reduce environmental impact or opportunities to improve the efficiency of raw material and water use; and
  - (d) take any further appropriate measures identified by a review.

### 1.4 Avoidance, recovery and disposal of wastes produced by the activities

- 1.4.1 The operator shall take appropriate measures to ensure that:
- (a) the waste hierarchy referred to in Article 4 of the Waste Framework Directive is applied to the generation of waste by the activities; and
  - (b) any waste generated by the activities is treated in accordance with the waste hierarchy referred to in Article 4 of the Waste Framework Directive; and
  - (c) where disposal is necessary, this is undertaken in a manner which minimises its impact on the environment.

- 1.4.2 The operator shall review and record at least every four years whether changes to those measures should be made and take any further appropriate measures identified by a review.

## **2 Operations**

### **2.1 Permitted activities**

- 2.1.1 The operator is only authorised to carry out the activities specified in schedule 1 table S1.1 (the “activities”).
- 2.1.2 Waste authorised by this permit shall be clearly distinguished from any other waste on the site.

### **2.2 The site**

- 2.2.1 The activities shall not extend beyond the site, being the land shown edged in green on the site plan at schedule 7 to this permit.

### **2.3 Operating techniques**

- 2.3.1 The activities shall, subject to the conditions of this permit, be operated using the techniques and in the manner described in the documentation specified in schedule 1, table S1.2, unless otherwise agreed in writing by the Environment Agency.
- 2.3.2 If notified by the Environment Agency that the activities are giving rise to pollution, the operator shall submit to the Environment Agency for approval within the period specified, a revision of any plan or other documentation (“plan”) specified in schedule 1, table S1.2 or otherwise required under this permit which identifies and minimises the risks of pollution relevant to that plan, and shall implement the approved revised plan in place of the original from the date of approval, unless otherwise agreed in writing by the Environment Agency.
- 2.3.3 Any raw materials or fuels listed in schedule 2 table S2.1 shall conform to the specifications set out in that table.
- 2.3.4 Waste shall only be accepted if:
- (a) it is of a type and quantity listed in schedule 2 tables S2.2 and S2.3;
  - (b) it conforms to the description in the documentation supplied by the producer and holder.
- 2.3.5 The operator shall ensure that where waste produced by the activities is sent to a relevant waste operation, that operation is provided with the following information, prior to the receipt of the waste:
- (a) the nature of the process producing the waste;
  - (b) the composition of the waste;
  - (c) the handling requirements of the waste;
  - (d) the hazardous property associated with the waste, if applicable; and
  - (e) the waste code of the waste.
- 2.3.6 The operator shall ensure that where waste produced by the activities is sent to a landfill site, it meets the waste acceptance criteria for that landfill.

### **Hazardous waste storage and treatment**

- 2.3.7 Hazardous waste shall not be mixed, either with a different category of hazardous waste or with other waste, substances or materials, unless it is authorised by schedule 1 table S1.1 and appropriate measures are taken.

## **3 Emissions and monitoring**

### **3.1 Emissions to water, air or land**

- 3.1.1 There shall be no point source emissions to water, air or land except from the sources and emission points listed in schedule 3 tables S3.1.
- 3.1.2 The limits given in schedule 3 shall not be exceeded.
- 3.1.3 Periodic monitoring shall be carried out at least once every 5 years for groundwater and 10 years for soil, unless such monitoring is based on a systematic appraisal of the risk of contamination.

### **3.2 Emissions of substances not controlled by emission limits**

- 3.2.1 Emissions of substances not controlled by emission limits (excluding odour) shall not cause pollution. The operator shall not be taken to have breached this condition if appropriate measures, including, but not limited to, those specified in any approved emissions management plan, have been taken to prevent or where that is not practicable, to minimise, those emissions.
- 3.2.2 The operator shall:
  - (a) if notified by the Environment Agency that the activities are giving rise to pollution, submit to the Environment Agency for approval within the period specified, an emissions management plan which identifies and minimises the risks of pollution from emissions of substances not controlled by emission limits;
  - (b) implement the approved emissions management plan, from the date of approval, unless otherwise agreed in writing by the Environment Agency.
- 3.2.3 All liquids in containers, whose emission to water or land could cause pollution, shall be provided with secondary containment, unless the operator has used other appropriate measures to prevent or where that is not practicable, to minimise, leakage and spillage from the primary container.

### **3.3 Monitoring**

- 3.3.1 The operator shall, unless otherwise agreed in writing by the Environment Agency, undertake the monitoring specified in the following tables in schedule 3 to this permit:
  - (a) point source emissions specified in tables S3.1.
- 3.3.2 The operator shall maintain records of all monitoring required by this permit including records of the taking and analysis of samples, instrument measurements (periodic and continual), calibrations, examinations, tests and surveys and any assessment or evaluation made on the basis of such data.

### **3.4 Odour**

- 3.4.1 Emissions from the activities shall be free from odour at levels likely to cause pollution outside the site, as perceived by an authorised officer of the Environment Agency, unless the operator has used appropriate measures, including, but not limited to, those specified in any approved odour management plan, to prevent or where that is not practicable to minimise the odour.
- 3.4.2 The operator shall:
  - (a) if notified by the Environment Agency that the activities are giving rise to pollution outside the site due to odour, submit to the Environment Agency for approval within the period specified, an odour management plan which identifies and minimises the risks of pollution from odour;
  - (b) implement the approved odour management plan, from the date of approval, unless otherwise agreed in writing by the Environment Agency.



### **3.5 Noise and vibration**

- 3.5.1 Emissions from the activities shall be free from noise and vibration at levels likely to cause pollution outside the site, as perceived by an authorised officer of the Environment Agency, unless the operator has used appropriate measures, including, but not limited to, those specified in any approved noise and vibration management plan to prevent or where that is not practicable to minimise the noise and vibration.
- 3.5.2 The operator shall:
- (a) if notified by the Environment Agency that the activities are giving rise to pollution outside the site due to noise and vibration, submit to the Environment Agency for approval within the period specified, a noise and vibration management plan which identifies and minimises the risks of pollution from noise and vibration;
  - (b) implement the approved noise and vibration management plan, from the date of approval, unless otherwise agreed in writing by the Environment Agency.

### **3.6 Monitoring**

- 3.6.1 The operator shall, unless otherwise agreed in writing by the Environment Agency, undertake the monitoring specified in the following tables in schedule 3 to this permit:
- (a) monitoring of biopiles specified in table S3.1.
- 3.6.2 The operator shall maintain records of all monitoring required by this permit including records of the taking and analysis of samples, instrument measurements (periodic and continual), calibrations, examinations, tests and surveys and any assessment or evaluation made on the basis of such data.
- 3.6.3 Monitoring equipment, techniques, personnel and organisations employed for the emissions monitoring programme and the environmental or other monitoring specified in condition 3.3.1 shall have either MCERTS certification or MCERTS accreditation (as appropriate), where available, unless otherwise agreed in writing by the Environment Agency.
- 3.6.4 Permanent means of access shall be provided to enable sampling/monitoring to be carried out in relation to the emission points specified in schedule 3 tables S3.1, unless otherwise agreed in writing by the Environment Agency.

### **3.7 Pests**

- 3.7.1 The activities shall not give rise to the presence of pests which are likely to cause pollution, hazard or annoyance outside the boundary of the site. The operator shall not be taken to have breached this condition if appropriate measures, including, but not limited to, those specified in any approved pests management plan, have been taken to prevent or where that is not practicable, to minimise the presence of pests on the site.
- 3.7.2 The operator shall:
- (a) if notified by the Environment Agency, submit to the Environment Agency for approval within the period specified, a pests management plan which identifies and minimises risks of pollution from pests;
  - (b) implement the pests management plan, from the date of approval, unless otherwise agreed in writing by the Environment Agency.

## **4 Information**

### **4.1 Records**

4.1.1 All records required to be made by this permit shall:

- (a) be legible;
- (b) be made as soon as reasonably practicable;
- (c) if amended, be amended in such a way that the original and any subsequent amendments remain legible, or are capable of retrieval; and
- (d) be retained, unless otherwise agreed in writing by the Environment Agency, for at least 6 years from the date when the records were made, or in the case of the following records until permit surrender:
  - (i) off-site environmental effects; and
  - (ii) matters which affect the condition of the land and groundwater.

4.1.2 The operator shall keep on site all records, plans and the management system required to be maintained by this permit, unless otherwise agreed in writing by the Environment Agency.

### **4.2 Reporting**

4.2.1 The operator shall send all reports and notifications required by the permit to the Environment Agency using the contact details supplied in writing by the Environment Agency.

4.2.2 A report or reports on the performance of the activities over the previous year shall be submitted to the Environment Agency by 31 January (or other date agreed in writing by the Environment Agency) each year. The report(s) shall include as a minimum:

- (a) a review of the results of the monitoring and assessment carried out in accordance with the permit including an interpretive review of that data;
- (b) the annual production/treatment data set out in schedule 4 table S4.2; and
- (c) the performance parameters set out in schedule 4 table S4.3 using the forms specified in table S4.4 of that schedule.

4.2.3 Within 28 days of the end of the reporting period the operator shall, unless otherwise agreed in writing by the Environment Agency, submit reports of the monitoring and assessment carried out in accordance with the conditions of this permit, as follows:

- (a) in respect of the parameters and emission points specified in schedule 4 table S4.1;
- (b) for the reporting periods specified in schedule 4 table S4.1 and using the forms specified in schedule 4 table S4.4 ; and
- (c) giving the information from such results and assessments as may be required by the forms specified in those tables.

4.2.4 The operator shall, unless notice under this condition has been served within the preceding four years, submit to the Environment Agency, within six months of receipt of a written notice, a report assessing whether there are other appropriate measures that could be taken to prevent, or where that is not practicable, to minimise pollution.

4.2.5 Within 1 month of the end of each quarter, the operator shall submit to the Environment Agency using the form made available for the purpose, the information specified on the form relating to the site and the waste accepted and removed from it during the previous quarter.

## 4.3 Notifications

- 4.3.1 The Environment Agency shall be notified without delay following the detection of:
- (a) any malfunction, breakdown or failure of equipment or techniques, accident, or emission of a substance not controlled by an emission limit which has caused, is causing or may cause significant pollution;
  - (b) the breach of a limit specified in the permit; or
  - (c) any significant adverse environmental effects.
- 4.3.2 Any information provided under condition 4.3.1 shall be confirmed by sending the information listed in schedule 5 to this permit within the time period specified in that schedule.
- 4.3.3 Where the Environment Agency has requested in writing that it shall be notified when the operator is to undertake monitoring and/or spot sampling, the operator shall inform the Environment Agency when the relevant monitoring and/or spot sampling is to take place. The operator shall provide this information to the Environment Agency at least 14 days before the date the monitoring is to be undertaken.
- 4.3.4 The Environment Agency shall be notified within 14 days of the occurrence of the following matters, except where such disclosure is prohibited by Stock Exchange rules:
- Where the operator is a registered company:
- (a) any change in the operator's trading name, registered name or registered office address; and
  - (b) any steps taken with a view to the operator going into administration, entering into a company voluntary arrangement or being wound up.
- Where the operator is a corporate body other than a registered company:
- (c) any change in the operator's name or address; and
  - (d) any steps taken with a view to the dissolution of the operator.
- 4.3.5 In the event:
- (a) that the operation of the activities gives rise to an incident or accident which significantly affects or may significantly affect the environment, the operator must immediately—
    - (i) inform the Environment Agency,
    - (ii) take the measures necessary to limit the environmental consequences of such an incident or accident, and
    - (iii) take the measures necessary to prevent further possible incidents or accidents;
  - (b) of a breach of any permit condition the operator must immediately—
    - (i) inform the Environment Agency, and
    - (ii) take the measures necessary to ensure that compliance is restored within the shortest possible time;
  - (c) of a breach of permit condition which poses an immediate danger to human health or threatens to cause an immediate significant adverse effect on the environment, the operator must immediately suspend the operation of the activities or the relevant part of it until compliance with the permit conditions has been restored.
- 4.3.6 Any information provided under condition 4.3.1 shall be confirmed by sending the information listed in schedule 5 to this permit within the time period specified in that schedule.
- 4.3.7 In any other case:

- (a) the death of any of the named operators (where the operator consists of more than one named individual);
- (b) any change in the operator's name(s) or address(es); and
- (c) any steps taken with a view to the operator, or any one of them, going into bankruptcy, entering into a composition or arrangement with creditors, or, in the case of them being in a partnership, dissolving the partnership.

4.3.8 Where the operator proposes to make a change in the nature or functioning, or an extension of the activities, which may have consequences for the environment and the change is not otherwise the subject of an application for approval under the Regulations or this permit:

- (a) the Environment Agency shall be notified at least 14 days before making the change; and
- (b) the notification shall contain a description of the proposed change in operation.

4.3.9 The Environment Agency shall be given at least 14 days notice before implementation of any part of the site closure plan.

4.3.10 Where the operator has entered into a climate change agreement with the Government, the Environment Agency shall be notified within one month of:

- (a) a decision by the Secretary of State not to re-certify the agreement;
- (b) a decision by either the operator or the Secretary of State to terminate the agreement; and
- (c) any subsequent decision by the Secretary of State to re-certify such an agreement.

## **4.4 Interpretation**

4.4.1 In this permit the expressions listed in schedule 6 shall have the meaning given in that schedule.

4.4.2 In this permit references to reports and notifications mean written reports and notifications, except where reference is made to notification being made "immediately", in which case it may be provided by telephone.

# Schedule 1 – Operations

Table S1.1 activities			
Activity reference	Activity listed in Schedule 1 of the EP Regulations	Description of specified activity and WFD Annex I and II operations	Limits of specified activity and waste types
A1	S5.3 A(1)(a)(i) Disposal or recovery of hazardous waste with a capacity exceeding 10 tonnes per day involving biological treatment	Ex-situ bioremediation of hazardous waste soil <b>R3:</b> Recycling / reclamation of organic substances which are not used as solvents (including other biological transformation processes) <b>R4:</b> Recycling / reclamation of metals and metal compounds <b>R5:</b> Recycling / reclamation of inorganic materials other than metals and metal compounds	Treatment operations shall be limited to: <ul style="list-style-type: none"> <li>Biological treatment of hazardous contaminated wastes by bioremediation and biopiles.</li> </ul> Pre-treatment operations including sorting, segregation, screening in order to facilitate remedial action. Treatment of all hazardous wastes shall be carried out on an impermeable pavement with sealed drainage. Treatment shall not include blending or mixing of hazardous wastes or hazardous wastes with non-hazardous wastes. Storage shall not exceed 10,000 tonnes per day. Treatment of hazardous waste by bioremediation shall not exceed 25,000 tonnes per annum. Waste types as specified in table S2.2. Notwithstanding the waste types permitted in table S2.2 wastes which have any of the following characteristics shall not be accepted for the bioremediation process: <ul style="list-style-type: none"> <li>waste with hazardous properties due to presence of heavy metals;</li> <li>waste comprised or contaminated with asbestos;</li> <li>liquid waste.</li> </ul>
A2	S5.4 A(1)(a)(i) Disposal or recovery of non-hazardous waste with a capacity exceeding 50 tonnes per day involving biological treatment	<b>R3:</b> Recycling/reclamation of organic substances which are not used as solvents (including other biological transformation processes) <b>R4:</b> Recycling / reclamation of metals and metal compounds <b>R5:</b> Recycling / reclamation of inorganic materials other than metals and metal compounds	Treatment of non-hazardous contaminated wastes for recovery consisting only of: Pre-treatment operations including sorting, segregation, screening in order to facilitate remedial action. Treatment of all non-hazardous wastes shall be carried out on an impermeable pavement with



Table S1.1 activities			
Activity reference	Activity listed in Schedule 1 of the EP Regulations	Description of specified activity and WFD Annex I and II operations	Limits of specified activity and waste types
			<p>sealed drainage.</p> <p>Storage of all non-hazardous wastes shall be carried out on an impermeable pavement with sealed drainage.</p> <p>Treatment shall not include blending or mixing of hazardous wastes or hazardous wastes with non-hazardous wastes.</p> <p>Storage by bioremediation shall not exceed 10,000 tonnes per day.</p> <p>Treatment of non-hazardous waste by bioremediation shall not exceed 50,000 tonnes per annum.</p> <p>Waste types as specified in Table S2.3.</p> <p>Notwithstanding the waste types permitted in table S2.3 wastes which have any of the following characteristics shall not be accepted:</p> <ul style="list-style-type: none"> <li>• waste comprised or contaminated with asbestos;</li> <li>• wastes comprised solely or mainly of dusts or powders;</li> <li>• wastes which are odour producing or likely to be odorous.</li> </ul>
A3	S5.6 A(1)(a) Temporary storage of hazardous waste with a total capacity exceeding 50 tonnes	<b>R13:</b> Storage of waste pending any of the operations numbered R1 to R12 (excluding temporary storage, pending collection, on the site where it is produced)	Storage of all hazardous wastes shall be carried out on an impermeable pavement with sealed drainage
	<b>Directly Associated Activity</b>		
A4	Screening of waste	<p>Screening of waste to remove any materials which are not suitable for use in treatment</p> <p><b>R4:</b> Recycling / reclamation of metals and metal compounds</p> <p><b>R5:</b> Recycling / reclamation of inorganic materials other than metals and metal compounds</p>	All treatment must take place on an impermeable surface with sealed drainage
A5	Temporary storage of non-hazardous waste pending recovery	<b>R13:</b> Storage of waste pending any of the operations numbered R1 to <b>R12</b> (excluding temporary storage, pending collection, on the site where it is produced)	<p>All storage must take place on an impermeable surface with sealed drainage</p> <p>Waste only as per tables S2.3</p>

Table S1.2 Operating techniques		
Description	Parts	Date Received
Application EPR/FP3092LH/V002	<ul style="list-style-type: none"> <li>Guidance for the recovery and disposal of hazardous and non hazardous waste Ref: S5.06</li> <li>Hazardous waste Ref: Technical Guidance WM2</li> <li>Environmental Management Plan</li> <li>Non Technical Summary</li> </ul>	05/10/2010
Additional information EPR/FP3092LH/V002	<ul style="list-style-type: none"> <li>Process Flow Diagram</li> </ul>	21/12/2010
Application EPR/FP3092LH/V003	Responses to Parts C2 and C3 of the application form and all referenced supporting documentation	27/11/2014
Response to Schedule 5 Notice dated 27/01/2015	<p>Response to all questions detailing pre-acceptance procedures; waste acceptance procedures; waste classification, segregating and monitoring; waste rejection; record keeping and auditing; waste storage, sampling procedures; and treatment and all referenced supporting documentation:</p> <ul style="list-style-type: none"> <li><i>CBE_CMRF_Rev01 - Pre-acceptance procedure to assess CDE waste_001.</i> Keltbray Environmental. Feb 2015</li> <li><i>KBE_CMRF_Rev01 – Waste Rejection Procedure_001.</i> Keltbray Environmental. Feb 2015</li> <li><i>KBE_CMRF_Rev01 – Document control procedure for waste_001.</i> Keltbray Environmental. Feb 2015</li> <li><i>KBY_MW_SWP_001Rev04 – Site Working Plan.</i> Keltbray Environmental. 19/02/2015</li> <li><i>KBY_MW_PPC_WAP_001Rev01 – Site Working Plan materials acceptance procedure.</i> Keltbray Environmental. 03/08/2013</li> <li><i>KB_MS_00002 – Waste segregation methodology.</i> Keltbray Environmental. May 2013</li> <li><i>KBY_MW_PPC_PTS_001Rev001 – Procedures for the treatment of soils.</i> 02/09/2013</li> </ul>	09/03/2015
Response to Schedule 5 Notice dated 27/01/2015 and Request for Further Information dated 19/03/2015	Response to all questions detailing waste acceptance procedures; waste treatment; activated carbon treatment unit, dust suppression and all referenced supporting documentation	02/04/2015

## Schedule 2 – Waste types, raw materials and fuels

Table S2.1 Raw materials and fuels	
Raw materials and fuel description	Specification
-	-

Table S2.2 Permitted waste types and quantities for activity A1 – treatment of hazardous waste by means of biological treatment	
Maximum quantity	Total annual throughput for the site shall not exceed 25,000 tonnes per annum of hazardous waste
Waste code	Description
<b>01</b>	<b>WASTES RESULTING FROM EXPLORATION, MINING, QUARRYING, AND PHYSICAL AND CHEMICAL TREATMENT OF MINERALS</b>
<b>01 05</b>	<b>drilling muds and other drilling wastes</b>
01 05 05*	oil-containing drilling muds and wastes
01 05 06*	drilling muds and other drilling wastes containing dangerous substances
<b>17</b>	<b>CONSTRUCTION AND DEMOLITION WASTES (INCLUDING EXCAVATED SOIL FROM CONTAMINATED SITES)</b>
<b>17 01</b>	<b>concrete, bricks, tiles and ceramics</b>
17 01 06*	mixtures of, or separate fractions of concrete, bricks, tiles and ceramics containing dangerous substances
<b>17 02</b>	<b>wood, glass and plastic</b>
17 02 04*	glass, plastic and wood containing or contaminated with dangerous substances
<b>17 03</b>	<b>bituminous mixtures, coal tar and tarred products</b>
17 03 01*	bituminous mixtures containing coal tar
17 03 03*	coal tar and tarred products
<b>17 05</b>	<b>soil (including excavated soil from contaminated sites), stones and dredging spoil</b>
17 05 03*	soil and stones containing dangerous substances
17 05 05*	dredging spoil containing dangerous substances
17 05 07*	track ballast containing dangerous substances
<b>17 09</b>	<b>other construction and demolition wastes</b>
17 09 03*	other construction and demolition wastes (including mixed wastes) containing dangerous substances
<b>19</b>	<b>WASTES FROM WASTE MANAGEMENT FACILITIES, OFF-SITE WASTE WATER TREATMENT PLANTS AND THE PREPARATION OF WATER INTENDED FOR HUMAN CONSUMPTION AND WATER FOR INDUSTRIAL USE</b>
<b>19 13</b>	<b>wastes from soil and groundwater remediation</b>
19 13 01*	solid wastes from soil remediation containing dangerous substances

<b>Table S2.3 Permitted waste types and quantities for activity A2 – treatment of non-hazardous waste by means of biological treatment</b>	
<b>Maximum quantity</b>	<b>Total annual throughput for the site shall not exceed 50,000 tonnes per annum of non-hazardous waste</b>
<b>Waste code</b>	<b>Description</b>
<b>17</b>	<b>CONSTRUCTION AND DEMOLITION WASTES (INCLUDING EXCAVATED SOIL FROM CONTAMINATED SITES)</b>
<b>17 01</b>	<b>concrete, bricks, tiles and ceramics</b>
17 01 01	concrete
17 01 02	bricks
17 01 03	tiles and ceramics
17 01 07	mixtures of concrete, bricks, tiles and ceramics other than those mentioned in 17 01 06
<b>17 02</b>	<b>wood, glass and plastic</b>
17 02 01	wood
17 02 02	glass
17 02 03	plastic
<b>17 03</b>	<b>bituminous mixtures, coal tar and tarred products</b>
17 03 02	bituminous mixtures other than those mentioned in 17 03 01
<b>17 05</b>	<b>soil (including excavated soil from contaminated sites), stones and dredging spoil</b>
17 05 04	soil and stones other than those mentioned in 17 05 03
17 05 06	dredging spoil other than those mentioned in 17 05 05
17 05 08	track ballast other than those mentioned in 17 05 07
<b>17 09</b>	<b>other construction and demolition wastes</b>
17 09 04	mixed construction and demolition wastes other than those mentioned in 17 09 01, 17 09 02 and 17 09 03
<b>19</b>	<b>WASTES FROM WASTE MANAGEMENT FACILITIES, OFF-SITE WASTE WATER TREATMENT PLANTS AND THE PREPARATION OF WATER INTENDED FOR HUMAN CONSUMPTION AND WATER FOR INDUSTRIAL USE</b>
<b>19 13</b>	<b>wastes from soil and groundwater remediation</b>
19 13 02	solid wastes from soil remediation other than those mentioned in 19 13 01
<b>20</b>	<b>MUNICIPAL WASTES (HOUSEHOLD WASTE AND SIMILAR COMMERCIAL, INDUSTRIAL AND INSTITUTIONAL WASTES) INCLUDING SEPARATELY COLLECTED FRACTIONS</b>
<b>20 02</b>	<b>garden and park wastes (including cemetery waste)</b>
20 02 02	soil and stones

## Schedule 3 – Emissions and monitoring

Table S3.1 Other Monitoring requirements – contaminated soil				
Emission point reference or source or description of point of measurement	Parameter	Monitoring frequency	Monitoring standard or method	Other specifications
Soil biopiles	Total Petroleum Hydrocarbons (TPH) Polycyclic Aromatic Hydrocarbons (PAH's) Pentachlorophenol (PCP) Note 1 Total Volatile Organic Compounds (VOC's) Phenols pH	Each completed batch of treated soil shall be sampled	-	Laboratory must be accredited to EN ISO/IEC ISO17025:2000 for the analysis. Specified samples to be obtained using standard sampling procedures as per BS 812

Note 1: Only if PCP contaminated soils are received for treatment



## Schedule 4 – Reporting

Parameters, for which reports shall be made, in accordance with conditions of this permit, are listed below.

<b>Table S4.1 Reporting of monitoring data</b>			
<b>Parameter</b>	<b>Emission or monitoring point/reference</b>	<b>Reporting period</b>	<b>Period begins</b>
Other monitoring requirements – contaminated soils Parameters as required by condition 3.5.1.	Biopile – Composite soil sample Total Petroleum Hydrocarbons (TPH), Polycyclic Aromatic Hydrocarbons (PAHs), Pentachlorophenol (PCP) (see Note 1), Total Volatile Organic Compounds (VOC's), Phenols and pH.	Every 3 months	1 January, 1 April, 1 July, 1 October

Note 1: Only if PCP contaminated soils are treated

<b>Table S4.2: Annual production/treatment</b>	
<b>Parameter</b>	<b>Units</b>
Bioremediation treatment	tonnes
Hazardous waste IN	tonnes
Hazardous waste OUT	tonnes
Waste recycled	tonnes
Waste disposed	tonnes

<b>Table S4.3 Performance parameters</b>		
<b>Parameter</b>	<b>Frequency of assessment</b>	<b>Units</b>
Water usage	Annually	tonnes
Energy usage	Annually	MWh

<b>Table S4.4 Reporting forms</b>		
<b>Media/parameter</b>	<b>Reporting format</b>	<b>Date of form</b>
Water usage	Form water usage 1 or other form as agreed in writing by the Environment Agency	28/04/2015
Energy usage	Form energy 1 or other form as agreed in writing by the Environment Agency	28/04/2015

## Schedule 5 – Notification

These pages outline the information that the operator must provide.

Units of measurement used in information supplied under Part A and B requirements shall be appropriate to the circumstances of the emission. Where appropriate, a comparison should be made of actual emissions and authorised emission limits.

If any information is considered commercially confidential, it should be separated from non-confidential information, supplied on a separate sheet and accompanied by an application for commercial confidentiality under the provisions of the EP Regulations.

### Part A

Permit Number	
Name of operator	
Location of Facility	
Time and date of the detection	

<b>(a) Notification requirements for any malfunction, breakdown or failure of equipment or techniques, accident, or emission of a substance not controlled by an emission limit which has caused, is causing or may cause significant pollution</b>	
<b>To be notified within 24 hours of detection</b>	
Date and time of the event	
Reference or description of the location of the event	
Description of where any release into the environment took place	
Substances(s) potentially released	
Best estimate of the quantity or rate of release of substances	
Measures taken, or intended to be taken, to stop any emission	
Description of the failure or accident.	

<b>(b) Notification requirements for the breach of a limit</b>	
<b>To be notified within 24 hours of detection unless otherwise specified below</b>	
Emission point reference/ source	
Parameter(s)	
Limit	
Measured value and uncertainty	
Date and time of monitoring	

<b>(b) Notification requirements for the breach of a limit</b>	
<b>To be notified within 24 hours of detection unless otherwise specified below</b>	
Measures taken, or intended to be taken, to stop the emission	

<b>Time periods for notification following detection of a breach of a limit</b>	
<b>Parameter</b>	<b>Notification period</b>

<b>(c) Notification requirements for the detection of any significant adverse environmental effect</b>	
<b>To be notified within 24 hours of detection</b>	
Description of where the effect on the environment was detected	
Substances(s) detected	
Concentrations of substances detected	
Date of monitoring/sampling	

## Part B – to be submitted as soon as practicable

Any more accurate information on the matters for notification under Part A.	
Measures taken, or intended to be taken, to prevent a recurrence of the incident	
Measures taken, or intended to be taken, to rectify, limit or prevent any pollution of the environment which has been or may be caused by the emission	
The dates of any unauthorised emissions from the facility in the preceding 24 months.	

<b>Name*</b>	
<b>Post</b>	
<b>Signature</b>	
<b>Date</b>	

\* authorised to sign on behalf of the operator

## Schedule 6 – Interpretation

“accident” means an accident that may result in pollution.

“application” means the application for this permit, together with any additional information supplied by the operator as part of the application and any response to a notice served under Schedule 5 to the EP Regulations.

“authorised officer” means any person authorised by the Environment Agency under section 108(1) of The Environment Act 1995 to exercise, in accordance with the terms of any such authorisation, any power specified in section 108(4) of that Act.

“disposal”. Means any of the operations provided for in Annex I to Directive 2008/98/EC of the European Parliament and of the Council on waste.

“hazardous property” has the meaning given in Schedule 3 of the Hazardous Waste (England and Wales) Regulations 2005 No.894 and the Hazardous Waste (Wales) Regulations 2005 No. 1806 (W.138).

“emissions to land” includes emissions to groundwater.

“EP Regulations” means The Environmental Permitting (England and Wales) Regulations SI 2010 No.675 and words and expressions used in this permit which are also used in the Regulations have the same meanings as in those Regulations.

“emissions of substances not controlled by emission limits” means emissions of substances to air, water or land from the activities, either from the emission points specified in schedule 3 or from other localised or diffuse sources, which are not controlled by an emission or background concentration limit.

“groundwater” means all water, which is below the surface of the ground in the saturation zone and in direct contact with the ground or subsoil.

“Industrial Emissions Directive” means DIRECTIVE 2010/75/EU OF THE EUROPEAN PARLIAMENT AND OF THE COUNCIL of 24 November 2010 on industrial emissions

“MCERTS” means the Environment Agency’s Monitoring Certification Scheme.

“Pests” means Birds, Vermin and Insects.

“quarter” means a calendar year quarter commencing on 1 January, 1 April, 1 July or 1 October.

“recovery” means any of the operations provided for in Annex II to Directive 2008/98/EC of the European Parliament and of the Council on waste.

“Waste code” means the six digit code referable to a type of waste in accordance with the List of Wastes (England) Regulations 2005, or List of Wastes (Wales) Regulations 2005, as appropriate, and in relation to hazardous waste, includes the asterisk.

“Waste Framework Directive” or “WFD” means Waste Framework Directive 2008/98/EC of the European Parliament and of the Council on waste

“year” means calendar year ending 31 December.

Where a minimum limit is set for any emission parameter, for example pH, reference to exceeding the limit shall mean that the parameter shall not be less than that limit.

Unless otherwise stated, any references in this permit to concentrations of substances in emissions into air means:

in relation to emissions from combustion processes, the concentration in dry air at a temperature of 273K, at a pressure of 101.3 kPa and with an oxygen content of 3% dry for liquid and gaseous fuels, 6% dry for solid fuels; and/or

in relation to emissions from non-combustion sources, the concentration at a temperature of 273K and at a pressure of 101.3 kPa, with no correction for water vapour content.



## Schedule 7 – Site plan



©Crown Copyright. All rights reserved. Environment Agency, 100026380, 2015.

END OF PERMIT

## G3 Waste classification testing

---



# Hydrocarbon Analysis Results

[illegible]

% Ratios estimated carbon chain proportions : HC = Hydrocarbon : PHC = Petroleum HC : FP = Fingerprint only. **Data generated by HC-1 Analyser**



## Hydrocarbon Analysis Results

<b>Client:</b>	Keltbray / Multiplex / Derwent London	<b>Samples taken</b>	03.01.18
----------------	---------------------------------------	----------------------	----------

<b>Address:</b> 80 Charlotte Street Project Office	<b>Samples extracted</b>	03.01.18
--	--------------------------	----------

**Samples analysed** 03.01.18

**Contact:** Frank Blande (MPX) / Con Varzari (Keltbray) **Operator**

Operator

**Project:** 80 Charlotte Street

													T01803
Matrix	Sample ID	Dilution used	BTEX (C6 - C9)	GRO (C5 - C10)	DRO (C10 - C35)	TPH (C5 - C35)	Total Aromatics (C10-C35)	16 EPA PAHs	BaP	% Ratios			HC Fingerprint Match
										C5 - C10	C10 - C18	C18	
s	Gate 3 Ramp G1	65.3	<1.6	<1.6	13	13	11.7	0.55	<0.033	0	92.1	7.3	Deg.Fuel 86.6%,(FCM)
s	Gate 3 Ramp G2	44.3	<1.1	<1.1	59.5	59.5	59.1	6.8	0.84	0	95.1	4.6	V.Deg.PHC 91.8%,(FCM),(BO)
	Initial Calibrator QC check			OK		Final FCM QC Check							

Concentration values in mg/kg for soil samples and mg/L for water samples. Soil values uncorrected for moisture or stone content. Fingerprints provide a tentative hydrocarbon identification.

Abbreviations :- FCM = Results calculated using Fundamental Calibration Mode : % = confidence of hydrocarbon identification : (PFM) = Poor Fingerprint Match : (T) = Turbid : (P) = Particulate detected

B = Blank Drift : (SBS)/(LBS) = Site Specific or Library Background Subtraction applied to result : (BO) = Background Organics detected : (OCR) = Outside cal range : (M) = Modified Result.

% Ratios estimated carbon chain proportions : HC = Hydrocarbon : PHC = Petroleum HC : FP = Fingerprint only. **Data generated by HC-1 Analyser**



## Hydrocarbon Analysis Results

**Client:**  
**Address:**

**Samples taken**  
**Samples extracted**  
**Samples analysed**

**Contact:**

## Operator

## Project:

													T01803
Matrix	Sample ID	Dilution used	BTEX (C6 - C9)	GRO (C5 - C10)	DRO (C10 - C35)	TPH (C5 - C35)	Total Aromatics (C10-C35)	16 EPA PAHs	BaP	% Ratios			HC Fingerprint Match
										C5 - C10	C10 - C18	C18	
s	Zone 3 15.01.18	41.6	<1	<1	20.6	20.6	9.9	0.47	<0.021	0	93.4	6.1	Deg.PHC 79.6%,(FCM),(BO)
s	Ramp Gate 1.5 15.01.18	38.5	<0.96	<0.96	30.5	30.5	26.3	2.8	0.56	0	94.1	5.6	Deg.Fuel 83.5%,(FCM),(BO)
s	Stock Pile 15.01.18	31.2	<0.78	<0.78	21.3	21.3	18.3	0.85	<0.016	0	94.2	5.3	Deg.Fuel 89.5%,(FCM)
	Initial Calibrator QC check		OK										

Concentration values in mg/kg for soil samples and mg/L for water samples. Soil values uncorrected for moisture or stone content. Fingerprints provide a tentative hydrocarbon identification.

Abbreviations :- FCM = Results calculated using Fundamental Calibration Mode : % = confidence of hydrocarbon identification : (PFM) = Poor Fingerprint Match : (T) = Turbid : (P) = Particulate detected

B = Blank Drift : (SBS)/(LBS) = Site Specific or Library Background Subtraction applied to result : (BO) = Background Organics detected : (OCR) = Outside cal range : (M) = Modified Result.

% Ratios estimated carbon chain proportions : HC = Hydrocarbon : PHC = Petroleum HC : FP = Fingerprint only. **Data generated by HC-1 Analyser**





## Hydrocarbon Analysis Results

**Client:**  
**Address:**

**Samples taken**  
**Samples extracted**  
**Samples analysed**

**Contact:**

## Operator

## Project:

													T01803
Matrix	Sample ID	Dilution used	BTEX (C6 - C9)	GRO (C5 - C10)	DRO (C10 - C35)	TPH (C5 - C35)	Total Aromatics (C10-C35)	16 EPA PAHs	BaP	% Ratios			HC Fingerprint Match
										C5 - C10	C10 - C18	C18	
s	1 Under Gantry 29.01.18	32.1	<0.8	<0.8	25.7	25.7	23.3	1.1	<0.022	0	94	5.5	Deg.Fuel 83.8%,(FCM)
s	2 Under Gantry 29.01.18	37.8	<1.9	<0.95	2.1	2.1	1.9	0.09	<0.019	0	93.4	6.1	Deg.Fuel 88.2%,(FCM),(P)
s	3 Under Gantry 29.01.18	48.8	<1.2	<1.2	11.7	11.7	10.7	1.1	0.16	0	94.6	5.1	Deg.Fuel 87.6%,(FCM),(P)
	Initial Calibrator QC check OK												

Concentration values in mg/kg for soil samples and mg/L for water samples. Soil values uncorrected for moisture or stone content. Fingerprints provide a tentative hydrocarbon identification.

Abbreviations :- FCM = Results calculated using Fundamental Calibration Mode : % = confidence of hydrocarbon identification : (PFM) = Poor Fingerprint Match : (T) = Turbid : (P) = Particulate detected

B = Blank Drift : (SBS)/(LBS) = Site Specific or Library Background Subtraction applied to result : (BO) = Background Organics detected : (OCR) = Outside cal range : (M) = Modified Result.

% Ratios estimated carbon chain proportions : HC = Hydrocarbon : PHC = Petroleum HC : FP = Fingerprint only. **Data generated by HC-1 Analyser**



## Hydrocarbon Analysis Results

<b>Client:</b>	<b>Samples taken</b>
<b>Address:</b>	<b>Samples extracted</b>
	<b>Samples analysed</b>

Contact:	Operator
----------	----------

Project:

													T01803
Matrix	Sample ID	Dilution used	BTEX (C6 - C9)	GRO (C5 - C10)	DRO (C10 - C35)	TPH (C5 - C35)	Total Aromatics (C10-C35)	16 EPA PAHs	BaP	% Ratios			HC Fingerprint Match
										C5 - C10	C10 - C18	C18	
s	Area G Contam.Area 13.02.18	33.3	<1.7	<0.83	0.38	0.38	0.17	<0.03	<0.017	0	91.6	7.4	Residual HC
w	Water Sample Siltbuster	76.0	<3.8	6.4	<0.76	6.4	<0.38	<0.08	<0.038	100	0	0	Deg.Gas,(FCM),(BO)
	Initial Calibrator QC check		OK										

Concentration values in mg/kg for soil samples and mg/L for water samples. Soil values uncorrected for moisture or stone content. Fingerprints provide a tentative hydrocarbon identification.

Abbreviations :- FCM = Results calculated using Fundamental Calibration Mode : % = confidence of hydrocarbon identification : (PFM) = Poor Fingerprint Match : (T) = Turbid : (P) = Particulate detected

B = Blank Drift : (SBS)/(LBS) = Site Specific or Library Background Subtraction applied to result : (BO) = Background Organics detected : (OCR) = Outside cal range : (M) = Modified Result.

% Ratios estimated carbon chain proportions : HC = Hydrocarbon : PHC = Petroleum HC : FP = Fingerprint only. **Data generated by HC-1 Analyser**

## **Appendix H**

Contractor contamination  
toolbox talk and daily briefing  
records

# Contaminated Land

---

## What is needed?

Site specific rules and procedures regarding contaminated land

---

## Estimated duration

10 minutes

---

## The discussion

If there is contaminated land on site a detailed plan of the contaminants and the risks involved with their removal has been drawn up prior to the commencement of work on site. It is vital that these plans are carefully followed.

The followed general points should be complied with when working with contaminated material:

- Be aware of who is responsible for dealing with contaminated material
  - Be aware of the contaminants present on site and ensure that you follow all precautions presented to you at all times
  - Make use of any decontamination facilities that are provided and do not cross contaminated areas, always be aware of the clean and dirty areas
  - Do not dig any unauthorised boreholes, excavations or trial pits
  - If you unexpectedly uncover contaminated land during excavation replace it carefully where it was found. If the material is loose carefully recover it with earth and inform either your supervisor or the person who is officially responsible for dealing with the contaminated land
  - Be aware of any watercourses on site or any water sources and do not allow any contaminated material to enter these areas
  - Make use of any wheel wash facilities provided on site especially when taking contaminated material off site
  - Ensure all vehicles are sheeted when removing contaminated material off site
  - Be aware of any security procedures that may be in place to secure the contaminated areas when not being worked upon
  - Always follow the site specific rules when working on a contaminated land site especially where personal protective.
- 

## Discussion point

Review the current procedure concerning contaminated land and discuss with the group what specific controls are in place.

---

Toolbox Talk Attendance Register	
Contract/Location: 80 Charlotte Street	Contract Number: 1105
Subject: Contaminated Land	
Talk Given By: K. Parrott	Signature: 
Start Time: 10 <sup>00</sup>	End Time: 10 <sup>15</sup>
Duration: 15 MIN	Date: 14/04/12

I hereby acknowledge that I have attended, received and understood the above-mentioned Toolbox talk

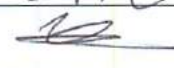
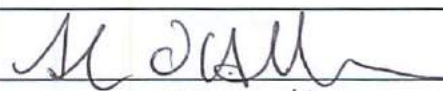
	PRINT NAME	SIGNATURE
1	A. VECCHIA	
2	B MC LAUSHLIN	B Mc L
3	M. Lyhidis	
4	A O Heilbram	
5	W Mc Ellegott	W Mc Ellegott
6	S. Lynch	S. Lynch
7		
8		
9		
10		
11		

Comments:



Toolbox Talk Attendance Register	
<b>Contract/Location:</b> 80 Charlotte Street	<b>Contract Number:</b> 1105
<b>Subject:</b> Contaminated Land	
<b>Talk Given By:</b> K. Parrott	<b>Signature:</b> 
<b>Start Time:</b> 10 <sup>00</sup>	<b>End Time:</b> 10 <sup>15</sup>
<b>Duration:</b> 15 MIN	<b>Date:</b> 14/04/14

**I hereby acknowledge that I have attended, received and understood the above-mentioned Toolbox talk**

	PRINT NAME	SIGNATURE
1	Bo Atashi	
2	IAN PROSSOR.	
3	SEAMUS LYNCH	
4	JAGJEET SINGH	
5	Kola	
6	Alex Grange	
7	C Grace	
8	M. BLATTY	
9	IVANDEEP SINGH	
10	GARY CATTEN	
11	PAVEL DRUEV	

Comments:

Daily Task Awareness Briefing			
<b>Project Name</b>	80 Charlotte Street	<b>Job Number</b>	1105
<b>Area</b> - Whole site or specific work area.	Site Wide – All Zones	<b>Date</b>	27.02.2018
<b>Lessons Learned from Yesterday - Operative Feedback</b> - Feedback and discussion of previous day's comments/concern. Ask operatives what went well; what the issues were.  <b>- CHECK THE ENVIRONEMENTAL SECTION ON THIS BRIEFING!!! - CONTAMINATED SOIL,</b>		<b>Feedback and discussion of briefing.</b>	
<b>Key Quality Issues:</b> <b>- check the level / face of the underpin once the shutters are formed, ensure there are no clashes with the new structure</b> - Engineer to check the blinding levels, and pile cropping levels, - <b>TP Pile cap installations / check levels cage details</b> - localize monitoring for the skin wall , ITP and pre-pour inspections for each pin			
<b>Daily Activities and associated Hazards &amp; Controls: DISCUSS!</b> - excavation works on the berm – for Howland Str / Charlotte Str - conveyor belt – start dismantling / and prep for the loading off site; - Tidy up all the timber off cuts, keep the area clean throughout the day!!!!  - <b>Chitty Street Elevation</b> – reduce dig, move muck/ stay away from the plant movement / do not go in the area if you're not working in the area!		<b>Permit Required/Issued?</b> Identify both the requirement and that one is issued	



<p><b>Construction Sequence:</b></p> <p>- reduce dig / concrete blinding / pile cropping / area handed over/ TW pile caps formwork/ concrete pour/ trench dig / install racking strut/ jacking /</p> <p><b>List site specific hazards &amp; mitigation measures:</b></p> <p>36T MACHINE ON THE LOADING GANTRY – LOADING TIPPERS AWAY FROM THE YARD LOW LEVEL - <b>SAFETY STANDING IN PLACE AT ALL TIMES &amp; NOT TO MOVE GET APPROVAL BEFORE MOVING APPROACHING THE LOADING GANTRY - GET THE TROUSERS UP - ON FROM THE SAME SIDE - SUPERVISION IN THE AREA</b></p> <ul style="list-style-type: none"> <li>• Slips trips &amp; Falls - <b>SAFETY STANDING IN PLACE AT ALL TIMES &amp; NOT TO MOVE</b></li> <li>• Machinery movements <b>TRACKED DUMPERS - SAFETY STANDING IN PLACE AT ALL TIMES &amp; NOT TO MOVE</b></li> <li>• Working with hazardous substances - <b>SAFETY STANDING IN PLACE AT ALL TIMES &amp; NOT TO MOVE</b></li> <li>• Leading edges - <b>SAFETY STANDING IN PLACE AT ALL TIMES &amp; NOT TO MOVE</b></li> <li>• Abrasive Wheel- <b>SAFETY STANDING IN PLACE AT ALL TIMES &amp; NOT TO MOVE</b> / Supervision</li> <li>• Manual Handling - <b>SAFETY STANDING IN PLACE AT ALL TIMES &amp; NOT TO MOVE</b></li> <li>• Noisy working area - <b>SAFETY STANDING IN PLACE AT ALL TIMES &amp; NOT TO MOVE</b></li> <li>• Hand arm vibration - <b>SAFETY STANDING IN PLACE AT ALL TIMES &amp; NOT TO MOVE</b></li> </ul>	<p><b>Permit to Dig</b></p> <p><b>Hot Works Permit</b></p>
<p><b>Forward planning:</b> Material storage areas, platform permits, deliveries</p> <p><b>Controls</b></p> <p><b>Muck away / contaminated soil - ensure correct disposal off site as per agreed method</b></p> <ul style="list-style-type: none"> <li>• Plant movements</li> <li>• Edge protection on site yard</li> <li>• Housekeeping</li> <li>• Plant Movement - <b>stay away from the areas</b></li> <li>• <b>Back K, ALL SOIL REMOVED FORM THE AREA TO BE TREATED AS NON-HASOURDOS</b></li> </ul> <p><b>ENSURE SEAT BELTS ARE WORN AT ALL TIMES WHILST DRIVING ANY MACHINE</b></p>	<p><b>MS/RA Ref:</b></p> <p>List those applicable.</p> <p>CHS-KLL-80-ZZ-MS-X-B101-109</p> <p>CHS-KLL-80-BG-MS-X-B101-098</p> <p>CHS-KLL-80-ZZ-MS-B101-105</p>
<p><b>Planned Lifting Activities:</b></p> <p>- TC1 planned lifts / TC5 planned lifts</p>	<p><b>Lift Plan Ref:</b> MCH 101</p>

**Logistics & Plant Movement** – Transit routes & planned plant movement, material routes, lighting and access.

MCE Logistics, Site Office- Gantry - new MCE walkway in place please follow the signs do not cross the barriers / edge protections.

**Interface Issues & Segregation of the works** –

- double handling of the materials and tools / site stores due to limited access / Amery and other contractors working in the yard
- avoid accessing work area through Amery's core area, access by going around, instead via the lay-down area

**3<sup>rd</sup> Party**

- access on WS is revised - now becoming a permanent access;

**Environmental Considerations** – Issues covering waste, noise, dust, vibration etc.

- Excavation on the contaminated area – segregate and store the contaminated soil separate from the clean soil on the polythene sheeting, load separately from the other tipper loads.

DO NOT POUR ANY NEW BLINDING – CONCRETE IN THE CONTAMINATED AREA UNTILL ALL THE CONTAMINATED MATERIAL IS REMOVED FROM SITE, BACKFILL TO FORMATION LEVEL WITH INERT SOIL IF CONTAMINATED SOIL REMOVAL IS REQUIRED BELOW THE FORMATION LEVEL

**Escape Routes/Emergency Plans** – Identify which routes are open/any that have restrictions /closures etc.

Muster Point in front of the church, walk along the road on Whitfield St

First aid kit in site office,

No fire drill planned today

**Others: including SOS Card feedback** – list specific hazards i.e. work at height, asbestos, confined spaces etc.

\*\*\*\* DO NOT USE SITE GATES TO EXIT OR ENTER THE SITE UNLESS AN EMERGENCY

Briefing Prepared By	C Varzari	Briefing Issued By	Scott Reid
----------------------	-----------	--------------------	------------



Daily Task Awareness Briefing Sheet			
Project name	80 Charlotte Street	Project No	1105
Area	Site Wide -Zone 1, 4, 2 & Zone 3	Date	27.02.2018

I hereby acknowledge that I have attended, received and understood the  
Daily Task Awareness Briefing

Name	Signature
TSILBY	
Vikram	Vikram
R. K. K. K.	R. K. K. K.
NALIN KEND	
PAUL SINGH	
DALIP SINGH	
A. MALAS	
ARTAN PATSILIS	
I. SADIKAZ	
F. SHIRAZ	
D. Singh	
G. TRESMAN	
S. CORBANICA	
I. HAMZA	
I. Zoumpelou	
ROGARY ORRIDGE	R. Orridge
C. EARL	
Sanmi	
Bobby	

## Daily Task Awareness Briefing Sheet

Project name	80 Charlotte Street	Project No	1105
Area	Site Wide –Zone 1, 4, 2 & Zone 3	Date	27.02.2018

I hereby acknowledge that I have attended, received and understood the  
Daily Task Awareness Briefing

[illegible]



Daily Task Awareness Briefing			
<b>Project Name</b>	80 Charlotte Street	<b>Job Number</b>	1105
<b>Area</b> - Whole site or specific work area.	Site Wide – All Zones	<b>Date</b>	24.02.2018
<b>Lessons Learned from Yesterday - Operative Feedback</b> - Feedback and discussion of previous day's comments/concern, Ask operatives what went well; what the issues were.  <b>- CHECK THE ENVIRONEMENTAL SECTION ON THIS BRIEFING!!! - CONTAMINATED SOIL,</b>		<b>Feedback and discussion of briefing.</b>	
<b>Key Quality Issues:</b> <ul style="list-style-type: none"> <li>- <b>check the level / face of the underpin once the shutters are formed, ensure there are no clashes with the new structure</b></li> <li>- Engineer to check the blinding levels, and pile cropping levels,</li> <li>- <b>TP Pile cap installations / check levels cage details</b></li> <li>- localize monitoring for the skin wall , ITP and pre-pour inspections for each pin</li> </ul>			
<b>Daily Activities and associated Hazards &amp; Controls: DISCUSS!</b> <ul style="list-style-type: none"> <li>- excavation works on the berm – for Howland Str / Charlotte Str</li> <li>- conveyor belt – start dismantling / and prep for the loading off site;</li> <li>- Tidy up all the timber off cuts, keep the area clean throughout the day!!!!</li> <li>- <b>Chitty Street Elevation</b> – reduce dig, move muck/ stay away from the plant movement / do not go in the area if you're not working in the area!</li> </ul>		<b>Permit Required/Issued?</b> Identify both the requirement and that one is issued	

<p><b>Construction Sequence:</b></p> <p>- reduce dig / concrete blinding / pile cropping / area handed over/ TW pile caps formwork/ concrete pour/ trench dig / install racking strut/ jacking /</p> <p><b>List site specific hazards &amp; mitigation measures:</b></p> <p>36T MACHINE ON THE LOADING GANTRY – LOADING TIPPERS AWAY FROM THE YARD LOW LEVEL - BANKSMANS IN PLACE AT ALL TIMES, CHECK THE AREA GET APPROVAL BEFORE YOU ARE APPROACHING THE LOADING GANTRY / GET THE THUMBS UP – OK FROM THE BANKSMAN – SUPERVISOR IN THE AREA</p> <ul style="list-style-type: none"> <li>• Slips trips &amp; Falls - site housekeeping</li> <li>• Machinery movements TRACKED DUMPERS - segregation / banksman's</li> <li>• Working with hazardous substances - PPE</li> <li>• Leading edges - suitable protection</li> <li>• Abrasive Wheel- Training / Supervision</li> <li>• Manual Handling - Training &amp; Supervision/ use of machinery and plant : plan the works in advance / use mechanical aids</li> <li>• Noisy working area - notice boards, PPE</li> <li>• Hand arm vibration - HAVs Procedures , reporting and recording</li> </ul> <p><b>Forward planning:</b> Material storage areas, platform permits, deliveries</p> <p><b>Controls</b></p> <ul style="list-style-type: none"> <li>• Muck away / contaminated soil - ensure correct disposal off site as per agreed methods</li> <li>• Plant movements</li> <li>• Edge protection on site yard</li> <li>• Housekeeping</li> <li>• Plant Movement - stay away from the areas</li> <li>• Bock K, ALL SOIL REMOVED FORM THE AREA TO BE TREATED AS NON-HASOURDOS</li> </ul> <p><b>ENSURE SEAT BELTS ARE WORN AT ALL TIMES WHILST DRIVING ANY MACHINE</b></p>	<p><b>Permit to Dig</b></p> <p><b>Hot Works Permit</b></p> <p><b>MS/RA Ref:</b></p> <p>List those applicable.</p> <p>CHS-KLL-80-ZZ-MS-X-B101-109</p> <p>CHS-KLL-80-BG-MS-X-B101-098</p> <p>CHS-KLL-80-ZZ-MS-B101-105</p>
<p><b>Planned Lifting Activities:</b></p> <p>- TC1 planned lifts / TC5 planned lifts</p>	<p><b>Lift Plan Ref:</b> MCE Lift Plan</p> <p>-</p>



**Logistics & Plant Movement** – Transit routes & planned plant movement, material routes, lighting and access.

MCE Logistics, Site Office- Gantry - new MCE walkway in place please follow the signs do not cross the barriers / edge protections.

**Interface Issues & Segregation of the works** –

- double handling of the materials and tools / site stores due to limited access / Amery and other contractors working in the yard
- avoid accessing work area through Amery's core area, access by going around, instead via the lay-down area

**3<sup>rd</sup> Party**

- access on WS is revised - now becoming a permanent access;

**Environmental Considerations** – Issues covering waste, noise, dust, vibration etc.

- Excavation on the contaminated area = segregate and store the contaminated soil separate from the clean soil on the polythene sheeting, load separately from the other tipper loads.
- DO NOT POUR ANY NEW BLINDING – CONCRETE IN THE CONTAMINATED AREA UNTILL ALL THE CONTAMINATED MATERIAL IS REMOVED FROM SITE, BACKFILL TO FORMATION LEVEL WITH INERT SOIL IF CONTAMINATED SOIL REMOVAL IS REQUIRED BELOW THE FORMATION LEVEL

**Escape Routes/Emergency Plans** – Identify which routes are open/any that have restrictions /closures etc.

Muster Point in front of the church, walk along the road on Whitfield St

First aid kit in site office,

No fire drill planned today

**Others: including SOS Card feedback** – list specific hazards i.e. work at height, asbestos, confined spaces etc.

\*\*\*\* DO NOT USE SITE GATES TO EXIT OR ENTER THE SITE UNLESS AN EMERGENCY

Briefing Prepared By	C Varzari	Briefing Issued By	Scott Reid
----------------------	-----------	--------------------	------------

## Daily Task Awareness Briefing Sheet

Project name	80 Charlotte Street	Project No	1105
Area	Site Wide -Zone 1, 4, 2 & Zone 3	Date	24.02.2018

I hereby acknowledge that I have attended, received and understood the  
Daily Task Awareness Briefing

Name	Signature
B. GYL	
ARTAN PATSILIS	
A. MAZAJ	
NEVIN REID	
C. VULLIO	
Giorgio Petrillo	
PAUL SINGH	
DALIP SINGH	
VISHAL KUMAR	
Rohitkumar	
I. SADIKAY	
F. SHIRAA	
S. COBANIKIA	
M. BEATTY	
RB HIGGINS	
ROGARY ORRIDGE	
J. Zoumpalov	
A. Haller	



## Daily Task Awareness Briefing Sheet

Project name	80 Charlotte Street	Project No	1105
Area	Site Wide –Zone 1, 4, 2 & Zone 3	Date	24.02.2018

I hereby acknowledge that I have attended, received and understood the  
Daily Task Awareness Briefing

[illegible]



Daily Task Awareness Briefing			
<b>Project Name</b>	80 Charlotte Street	<b>Job Number</b>	1105
<b>Area</b> - Whole site or specific work area.	Site Wide - Zone 1,4 & Zone 3 , Zone 2	<b>Date</b>	08/01/2018
<b>Lessons Learned from Yesterday - Operative Feedback</b> - Feedback and discussion of previous day's comments/concern, Ask operatives what went well; what the issues were.  <b>- THINK before you are starting your day work / report any unsafe working conditions</b>  <b>- Focus on your health , safety and wellbeing of the workplace and you as individuals</b>		<b>Feedback and discussion of briefing.</b>	
<b>Key Quality Issues:</b> - wailing install / correct levels and sequence to be checked by the site engineers - Engineer to check the blinding levels, and pile cropping levels, - <b>TP Pile cap installations / check levels cage details</b> - localize monitoring for jacking sequence, before/ during, after the jacking operations are completed;			
<b>Daily Activities and associated Hazards &amp; Controls: DISCUSS!</b> - excavation works on the berm – areas adjacent to the Loading Gantry/ dig out the ramp and Chitty Street Elevation muck away from the gantry - tippers on turn around / loading gantry exclusion zone for the plant loading areas/ muck shifting - Tidy up all the timber off cuts, keep the area clean throughout the day!!!!  - <b>Zone 1 &amp; Zone 2</b> – lift the wailing in position using the tc1 & 24T machine – <b>watch out for overheads lifting – STAY</b>		<b>Permit Required/Issued?</b> Identify both the requirement and that one is issued	

<p><b>AWAY</b></p> <ul style="list-style-type: none"> <li>- Ensure correct slinging techniques are adhered to for all lifting operations</li> </ul> <p><b>Construction Sequence:</b></p> <ul style="list-style-type: none"> <li>- reduce dig / concrete blinding / pile cropping / area handed over/ TW pile caps formwork/ concrete pour/ trench dig / install racking strut/ jacking /</li> </ul> <p><b>List site specific hazards &amp; mitigation measures:</b></p> <ul style="list-style-type: none"> <li>• Slips trips &amp; Falls - site housekeeping</li> <li>• Machinery movements - segregation / banksmans</li> <li>• Working with hazardous substances - PPE</li> <li>• Leading edges - suitable protection</li> <li>• Abrasive Wheel- Training / Supervision</li> <li>• Manual Handling - Training &amp; Supervision/ use of machinery and plant : plan the works in advance / use mechanical aids</li> <li>• Noisy working area - noise boards, PPE</li> <li>• Hand arm vibration - HAVs Procedures, reporting and recording</li> </ul> <p><b>Forward planning:</b> Material storage areas, platform permits, deliveries</p> <p><b>Controls</b></p> <ul style="list-style-type: none"> <li>• Muck away / contaminated soil - ensure correct disposal off site as per agreed methods</li> <li>• Plant movements</li> <li>• Edge protection on site yard</li> <li>• Housekeeping</li> <li>• Plant Movement - stay away from the area</li> <li>• Bock K, ALL SOIL REMOVED FORM THE AREA TO BE TREATED AS NON-HASOURDOS</li> </ul> <p><b>ENSURE SEAT BELTS ARE WORN AT ALL TIMES WHILST DRIVING ANY MACHINE</b></p>	<p><b>Permit to Dig</b> <b>Hot Works Permit</b></p> <p><b>MS/RA Ref:</b> List those applicable.</p> <p>CHS-KLL-80-ZZ-MS-X-B101-109</p> <p>CHS-KLL-80-BG-MS-X-B101-098</p>
<p><b>Planned Lifting Activities:</b></p> <p>- TC1 planned lifts / TC5 planned lifts</p>	<p><b>Lift Plan Ref:</b> MCE Lift Plan</p>