

**Demolitions**  
 Walls to be removed - Red  
 This dwg to be read in conjunction with all Demolition drawings.

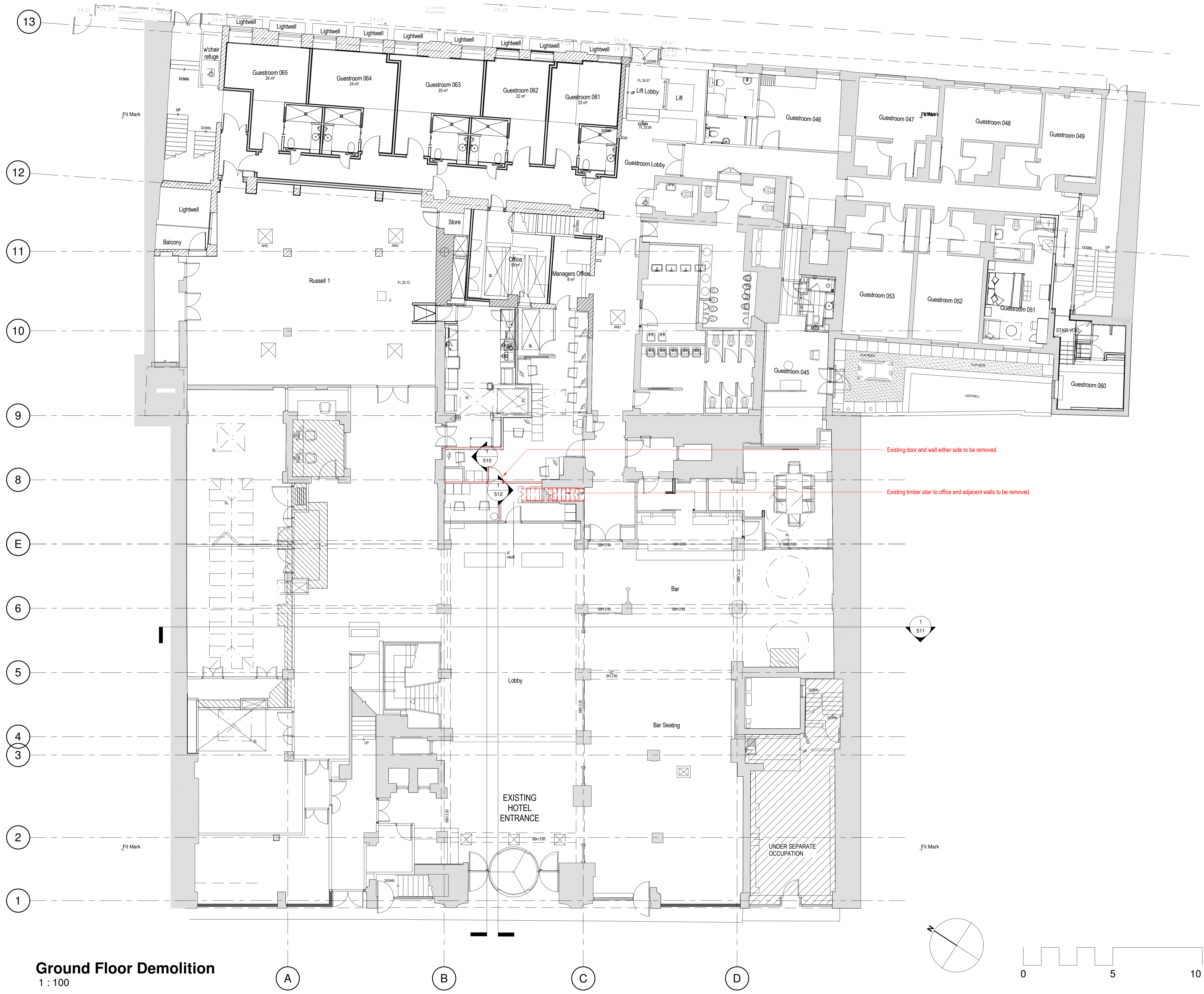

Existing door and wall either side to be removed.

Existing timber stair to office and adjacent walls to be removed.

**Ground Floor Demolition**  
 1 : 100

Revision	Description	Date
A	Drawing status changed, Planning Submission	13.07.18



**MORRISON DESIGN**  
 CHARTERED ARCHITECTS

St Alkmunds House, 103 Belper Road, Derby DE1 3ES  
 T: 01332 363355 F: 01332 291441 E: architect@morrisondesign.co.uk

Job Title  
**DoubleTree West End Hotel, Southampton Row, London, WC1B 4BH**

Phase 3 Preliminary Proposals

Drawing Title  
**Ground Floor Demolition**

File Ref.:  
 Plotter Settings:

Scale	Drawn	Checked	Date
Scale @ A1: As indicated	DR	NC	01/06/18

Job No.	Drawing No.	Revision
3984	502	A

**PLANNING SUBMISSION**

