

Do Not Scale.  
All Figured Dimensions To Be Checked On Site Prior To Construction.  
All Copyright Reserved.

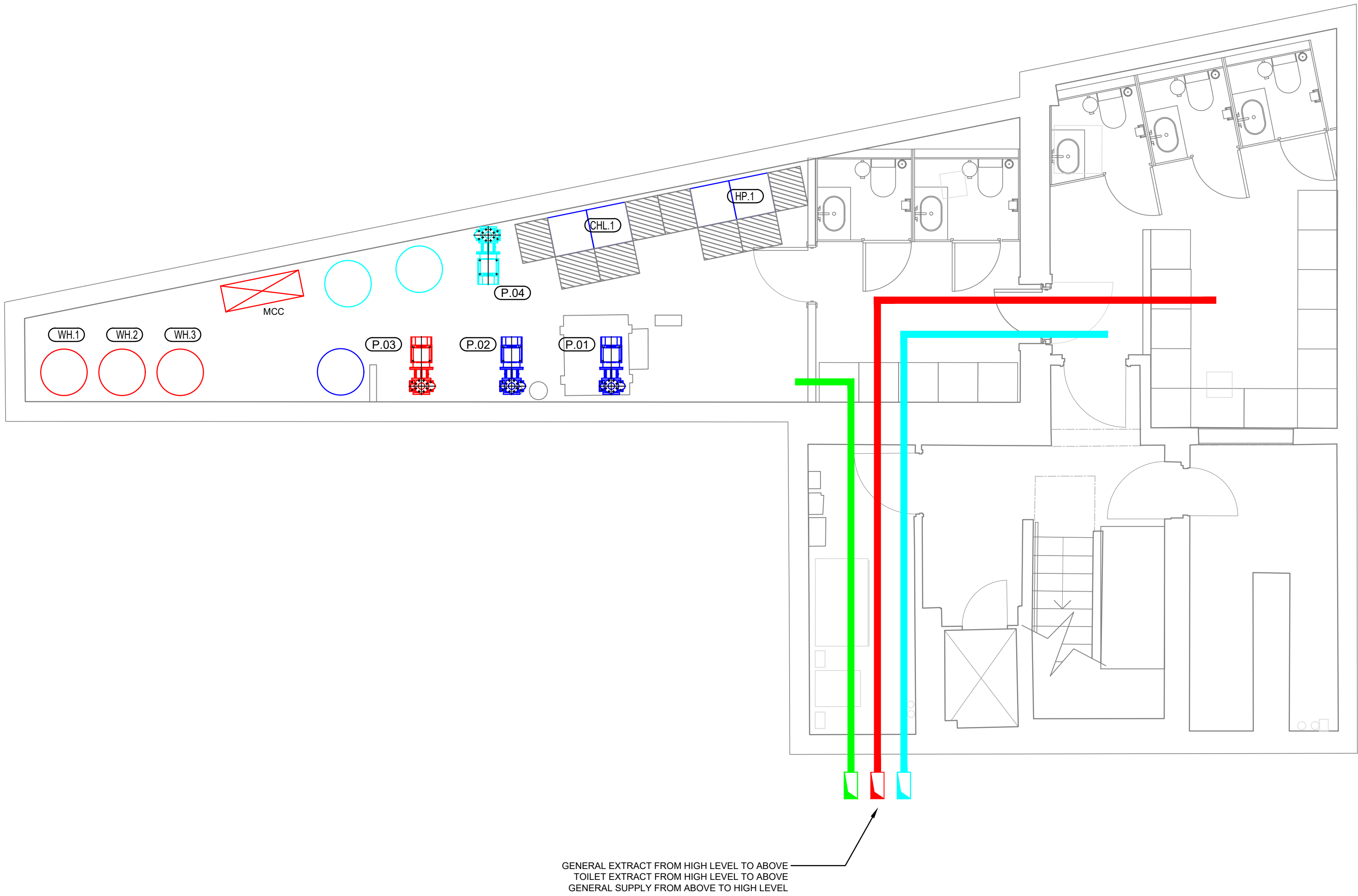

PLANT SCHEDULE:

BASEMENT - 2

AIR CONDITIONING - DAIKIN:

HP.1 - WATER COOLED HEAT PUMP FOR PRODUCTION OF LTHW  
HYDRO CUBE - EWWQ1923K BW1N  
DUTY 180 kW COOLING  
SIZE 1800 H x 600 D x 1200 W

CHL.1 - WATER COOLED CHILLER FOR PRODUCTION OF CHW  
HYDRO CUBE - EWWQ1923K BW1N  
DUTY 180 kW COOLING  
SIZE 1800 H x 600 D x 1200 W

P.1 - CONDENSE WATER PRIMARY CIRCUIT PUMP  
TWIN HEAD, DUTY TBC @ 300KPA

P.2 - CONDENSE WATER SECONDARY CIRCUIT PUMP  
TWIN HEAD, TBC @ 300KPA

P.3 - CHW PUMP  
TWIN HEAD, DUTY TBC @ 300KPA

P.4 - LTHW PUMP  
TWIN HEAD, DUTY TBC @ 300KPA

D	PRELIMINARY	HN	07/09/2018
C	PRELIMINARY	HN	04/09/2018
B	PRELIMINARY	HN	30/07/2018
A	PRELIMINARY	HN	30/07/2018
REV	DETAILS	BY	DATE

CLIENT:			STREAT MARKETS LTD		
PROJECT:			CENTRE POINT, LINK BUILDING W1		
DRAWING TITLE:			BASEMENT LEVEL -2 AC AND VENTILATION		
DRAWN BY:	HN	APPROVED BY:		DATE:	JULY 2018
PROJECT No.:	L2171	DRAWING No.:	M004	SCALE:	1:50

