

NOTE:
DRAWING TO BE READ IN CONJUNCTION WITH SUGGESTED SEQUENCE OF CONSTRUCTION - DRAWING SERIOES L(30)01 - 11

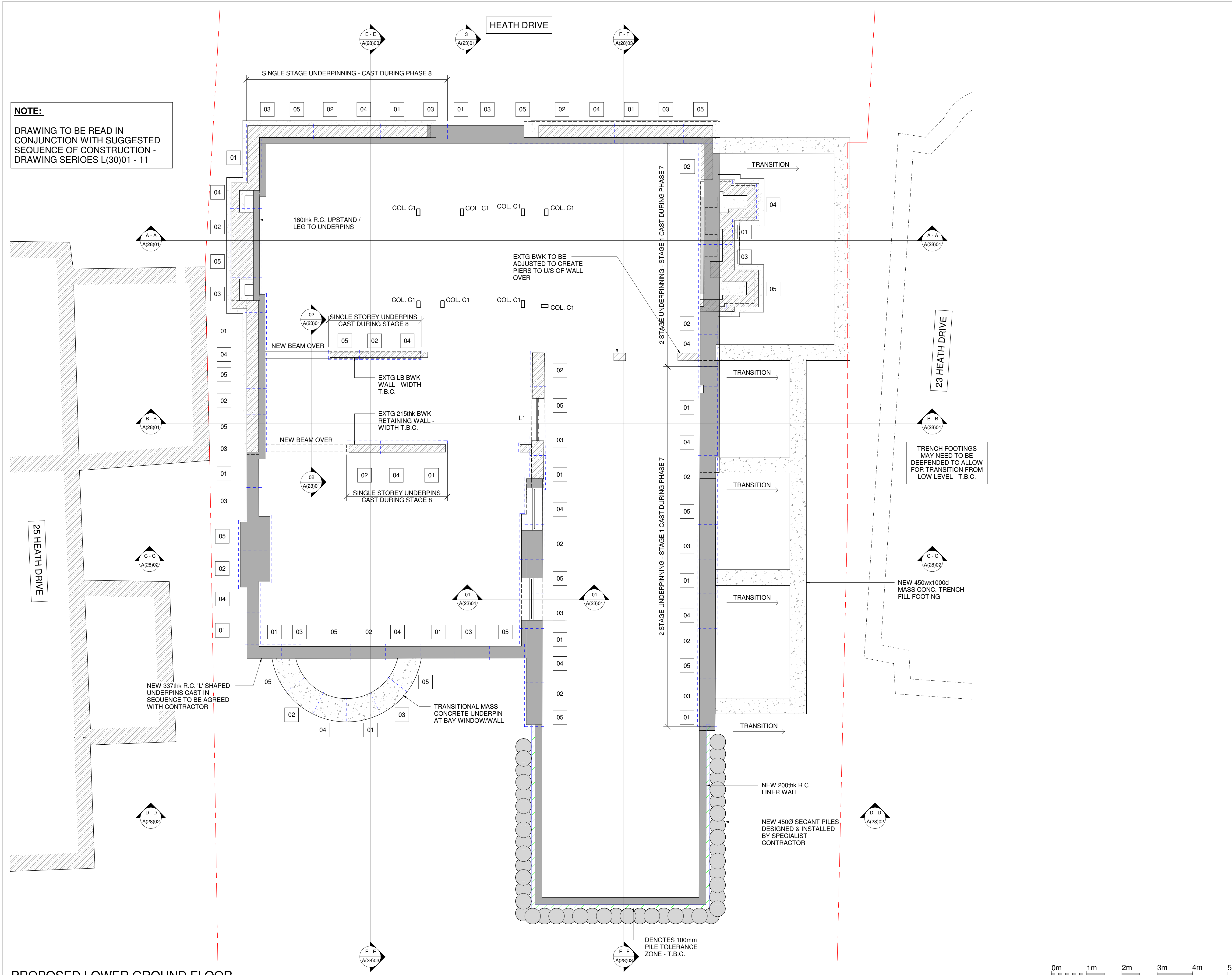

Notes
THIS DRAWING IS COPYRIGHT OF FORM.
DO NOT SCALE FROM THIS DRAWING WORK ONLY TO FIGURED DIMENSIONS.
THE CONTRACTOR IS TO VERIFY ALL DIMENSIONS ON SITE BEFORE COMMENCING WORK. ALL ERRORS AND OMISSIONS ARE TO BE REPORTED TO THE ENGINEER.
THIS DRAWING IS TO BE READ IN CONJUNCTION WITH ALL RELEVANT ARCHITECTS, SERVICES ENGINEERS AND ENGINEERS DRAWINGS AND SPECIFICATIONS.

| KEY | |
|--|--|
| EXISTING WALL | |
| NEW 20N/mm ² BRICKWORK IN DESIGNATION (iii) MORTAR. | |
| NEW 7N/mm ² MEDIUM DENSE BLOCKWORK IN DESIGNATION (iii) MORTAR. | |
| NEW LOADBEARING TIMBER STUD PARTITION (50x100 C24 STUDS AT 400c/c). | |
| NEW NON LOAD BEARING PARTITION. | |
| LOAD BEARING WALL UNDER. | |
| NEW BRICKWORK TO BE FULLY TOOTHED IN AND PACKED UP TO EXTG BRICKWORK | |
| W STAINLESS STEEL WALL EXTENSION PROFILES. | |
| ALL MASONRY BELOW DPC LEVEL TO BE FROST RESISTANT AND IN DESIGNATION (i) MORTAR. | |

| LEGEND | |
|---|--|
| NEW BEAM UNDER. | |
| DOUBLED TIMBERS TRIMMING OPENINGS/ UNDER PARTITIONS. | |
| DENOTES SPAN OF NEW 50x200 C24 TIMBER JOISTS AT 400c/c U.N.O. | |
| DENOTES SPAN OF NEW 50x150 C24 TIMBER RAFTERS AT 400c/c U.N.O. | |
| DENOTES SPAN OF NEW 75x100 C24 TIMBER RAFTERS AT 400c/c U.N.O. | |
| DENOTES SPAN OF NEW CONCRETE SLAB | |
| DENOTES SPAN OF NEW 150mm DEEP BEAM & BLOCK FLOOR. | |
| DENOTES SPAN OF EXISTING TIMBER CEILING JOISTS. ASSUMED 50x100 T.B.C. | |
| DENOTES SPAN OF EXISTING TIMBER FLOOR JOISTS. ASSUMED 50x200 T.B.C. | |
| TT DENOTES DOUBLE TRIMMER JOIST/RAFTERS SIZED AS PER SPAN | |

| STRUCTURAL COLUMN SCHEDULE | |
|----------------------------|----------------|
| MARK | SIZE |
| COL. C1 | RHS200x100x5.0 |
| COL. C3 | UC152x152x37 |

| Rev. | Date | Amendment | Drawn | Chkd |
|------|----------|------------------------|-------|------|
| P3 | 10.09.18 | REAR EXTENSION AMENDED | A.O. | B.R. |
| P2 | 26.01.18 | ISSUED FOR PLANNING | P.E | C.M |
| P1 | 13.12.17 | ISSUED FOR PLANNING | P.E | C.M |

Drawing Status: **PRELIMINARY**

Form

Job Title
**24 HEATH DRIVE
LONDON
NW3 7SB**

Drawing Title
**PROPOSED LOWER GROUND
FLOOR PLAN**

Form Structural Design Ltd 77 St John Street London EC1M 4NN
T:020 7253 2893 E:studio@form-sd.com W:www.form-sd.com

| Date | Scale | Drawn | Checked |
|-------------------|------------------------|----------------|---------|
| DEC 17 | As indicated | P.E | C.M |
| Job No. 162637 | Drawing No. L(23)01 | Revision P3 | |

