

Notes
This drawing is © Archtype Ltd.
Check this drawing is the latest revision.
Do not scale from this drawing.
Do not use the information on this drawing without checking all dimensions on site.
Do not use any areas indicated for either valuation, purchase, sale or any other form of legally binding contract.
Do not reproduce any part of this drawing without prior written consent.
Report any discrepancies on this document to Archtype.
Read this drawing in conjunction with the associated models, specifications and related consultant's documents.
Equivalent products / materials may be Approved where the Employer's Requirements, Thermal Performance, Airtightness and any other specified performance requirements are met. Subject to Archtype's Acceptance.
All materials to be certified to comply with BS 14001 or BE9001 or be able to provide a Chain of Custody certificate in order to comply Code for Sustainable Homes. All timber species and sources used in this development are not to be listed on the CITES appendices for endangered or threatened species (appendix I, II or III).

Designer's Hazard Identification
It is assumed that all works will be undertaken by a competent contractor working, where appropriate, to an approved method statement. In addition to the hazards typically associated with the types of construction detailed on this drawing, any known abnormal hazards specific to this drawing have been identified.

Preliminary Issue
Any drawing issued for preliminary issue are for information only. On no account are these drawings to be used for construction. Archtype accept no liability for proceeding on this basis and additional costs may arise to the contractor.

KEY

- Phasing Boundary
- Completed new build buildings by HPL
- Existing building constraints
- Existing trees to be retained inative only, refer to Landscape architects drawings

Rev	Date	Description	Drawn	Checked
3	20.07.18	Tree update	LM	AMF
2	19.06.18	Additional existing building	LM	AMF
1	06.05.18	First Construction Issue	LM	AMF

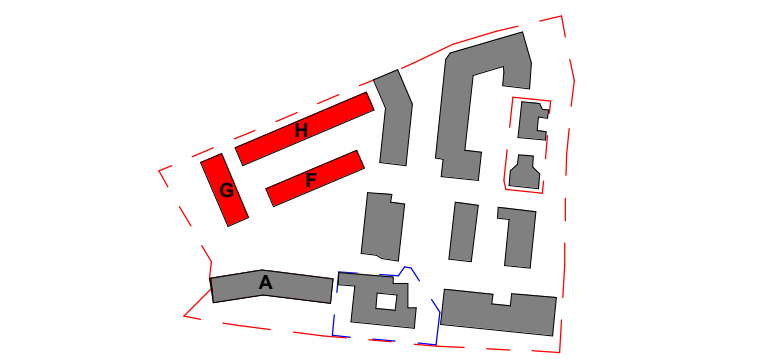

LONDON: 020 7403 2889 WWW.ARCHTYPE.CO.UK HEREFORD: 01981 542 111

Client:	Hill Partnership Ltd for Camden Council
Project:	Agar Grove Block Phase 1B Site
Drawing Title:	Site Layout Phasing Boundary - Phase 1B
Project	Originator Type Role Phase Block Unit Unique ID
T14011	- ART - DR - A - 1b B 00 - GA-007
Status:	Code Suitability Description
	A Construction Issue
Revision:	Code Revision Description
	C3 Issued For Construction
Scale:	As indicated @ A1 Date: 20 June 17
Drawn by:	LM Checked by: AMF
Internal Project Ref:	8090 & 8575 Model Ref: AG-RAC2015-A-SITE