

- Note:
1. This drawing is copyright.
  2. Contractors must check all dimensions on site.
  3. Figured dimensions are to be used in preference to scaled dimensions.
  4. Discrepancies must be reported immediately.

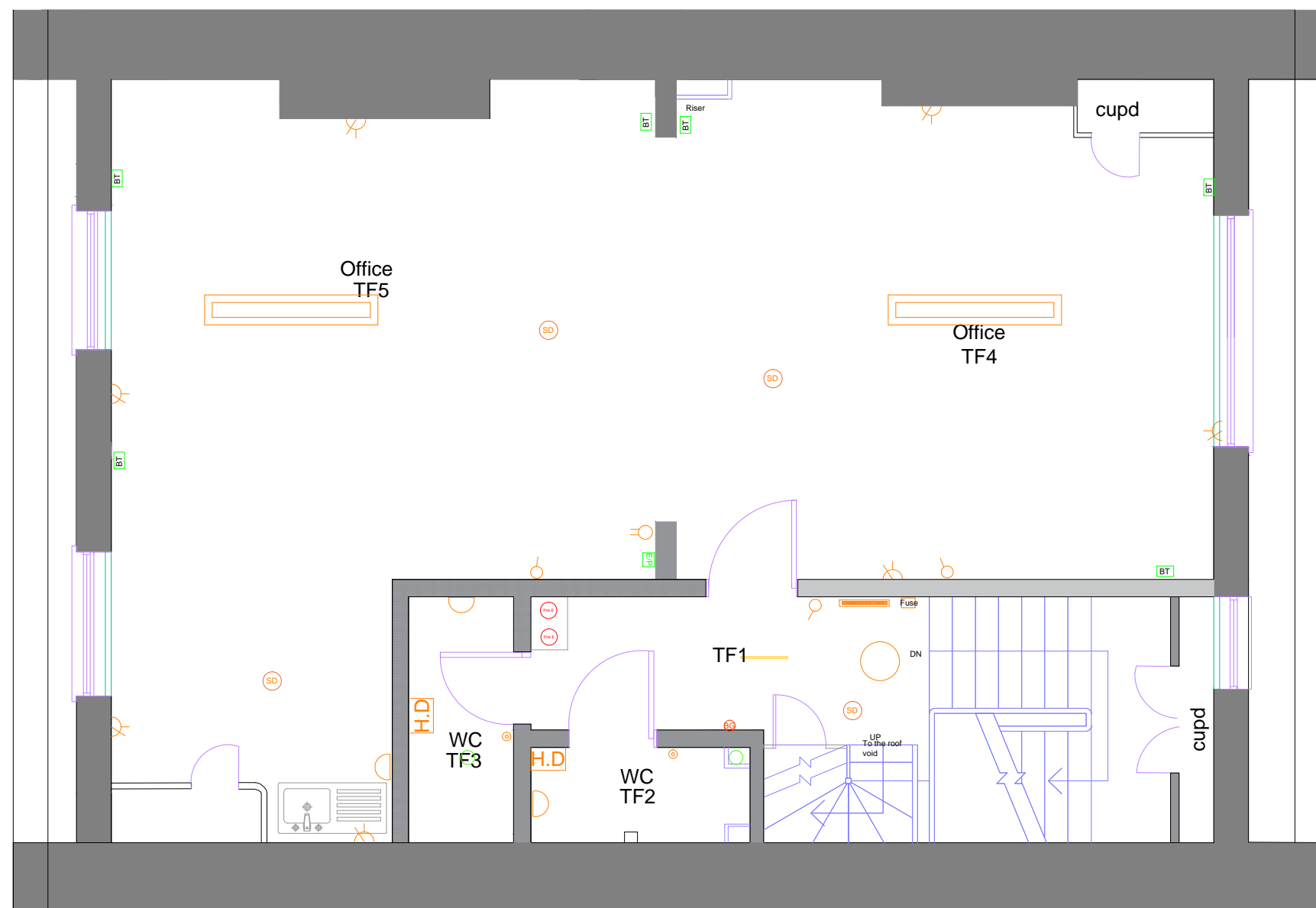

Title	Symbol
Surface mounted fluorescent light	[Symbol]
Light switch - single rocker	[Symbol]
Light switch - dimmer	[Symbol]
Light switch - double rocker	[Symbol]
Wall light fitting	[Symbol]
Double switch socket outlet	[Symbol]
Dome ceiling or wall mounted light	[Symbol]
Electric Panelled Radiator	[Symbol]
Fire alarm break glass call point	[Symbol]
Fire alarm panel	[Symbol]
Intruder alarm	[Symbol]
Distribution Board	[Symbol]
Smoke Detector	[Symbol]
Chandelier	[Symbol]
Air Cooling	[Symbol]
Emergency Light fitting	[Symbol]
Entry Phone	[Symbol]
Ventilation extract diffuser	[Symbol]
Fire extinguisher	[Symbol]
Fire alarm sounder	[Symbol]
Drainage gulley	[Symbol]
M/H drainage inspection chamber	[Symbol]
Steel Beam	[Symbol]
Stud partition	[Symbol]
FD	Fire Door
EX	Existing Door
D	Door

Notes: Alteration works

- Remove existing light fittings from all internal rooms. Install replacement LED light fittings. Linear fittings in offices TF4 and TF5 to be suspended approx 250mm below ceilings.
- New dome light to TF1. Lights to be controlled from existing switch positions.
- New wall lighting over wash hand basin affixed to new stud partitions as shown to rooms TF3 and to the kitchenette TF5.
- Retain existing emergency light fittings and external light fittings.
- Retain existing fire alarm and smoke detection system.
- Relocate power points to allow for built in units that will house the air cooling.
- Under tile heating to the toilets, beneath the tiled floor surfaces
- Extend electrical power to serve new cooling units and toilets. Hand dryers, switches and wall fitted lights. Where fixed to solid walls, will be with the minimum size hole. Otherwise the cabling to be routed within the stud partitions.
- Electric panel heater to landing TF1.
- Install new extractor vents to the toilets, connecting to the existing extractor ventilation ductwork.

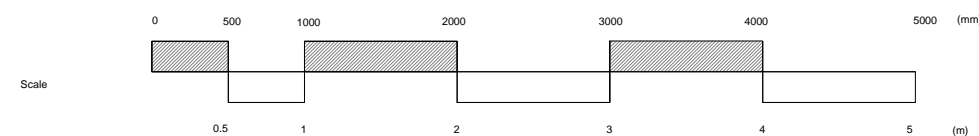

REVISION	DATE	DESCRIPTION	BY

**MATTHEWS & SON LLP**  
Chartered Surveyors  
26 Bedford Square, London, WC1B 3HP

PROJECT  
**87 GOWER STREET,  
LONDON, WC1E 6AF**

DETAIL  
**Proposed Third Floor  
Electrical Services**

DATE 20/03/2018 DRAWN BY HAB  
CHECKED BY

SCALE 1:50 @ A3

DRAWING NUMBER 13002/3/114 REVISION