

- NOTE:
1. This drawing is copyright.
 2. Contractors must check all dimensions on site.
 3. Figured dimensions are to be used in preference to scaled dimensions.
 4. Discrepancies must be reported immediately.

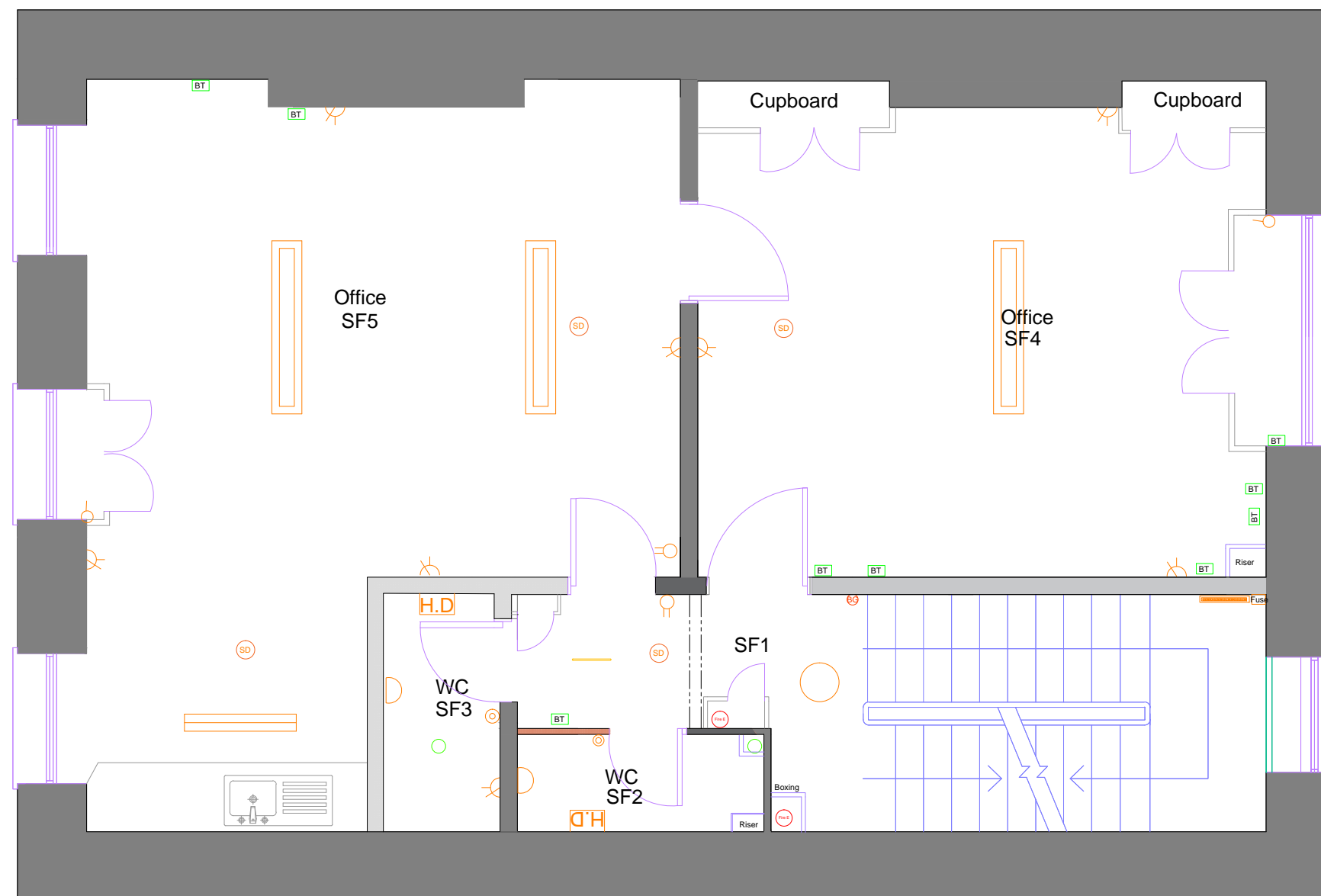

Tiles	
Surface mounted fluorescent light	
Light switch - single rocker	
Light switch - dimmer	
Light switch - double rocker	
Wall light fitting	
Double switch socket outlet	
Dome ceiling or wall mounted light	
Electric Paneled Radiator	
Fire alarm break glass call point	
Fire alarm panel	
Intruder alarm	
Distribution Board	
Smoke Detector	
Chandelier	
Air Cooling	
Emergency Light fitting	
Entry Phone	
Ventilation extract diffuser	
Fire extinguisher	
Fire alarm sounder	
Drainage gully	
MH drainage inspection chamber	
Steel Beam	
Stud partition	
FD	Fire Door
EX	Existing Door
D	Door

Notes: Alteration works

- Remove existing light fittings from all internal rooms. Install replacement LED light fittings. Linear fittings in offices SF4 and SF5 to be suspended approx 250mm below ceilings.
- New dome lights to SF1. Lights to be controlled from existing switch positions.
- New wall lighting over wash hand basin affixed to new stud partitions as shown to rooms SF2 and SF3.
- Retain existing emergency light fittings and external light fittings.
- Retain existing fire alarm and smoke detection system.
- Relocate power points to allow for built in units that will house the air cooling.
- Under tile heating to the toilets, beneath the tiled floor surfaces
- Extend electrical power to serve new cooling units and toilets. Hand dryers, switches and wall fitted lights. Where fixed to solid walls, will be with the minimum size hole. Otherwise the cabling to be routed within the stud partitions.
- Electric panel heater to the stairwell.
- Install new extractor vents to the toilets, connecting to the existing extractor ventilation ductwork.

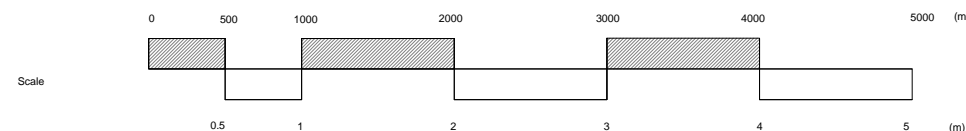

REVISION	DATE	DESCRIPTION	BY

MATTHEWS & SON LLP
Chartered Surveyors

26 Bedford Square, London, WC1B 3HP

PROJECT

**87 GOWER STREET,
LONDON, WC1E 6AF**

DETAIL

**Proposed Second Floor
Electrical Services**

DATE: 20/03/2018 DRAWN BY: HAB

SCALE: 1:50 @ A3 CHECKED BY:

DRAWING NUMBER: 13002/3/113 REVISION: