

- Note:
1. This drawing is copyright.
 2. Contractors must check all dimensions on site.
 3. Figured dimensions are to be used in preference to scaled dimensions.
 4. Discrepancies must be reported immediately.

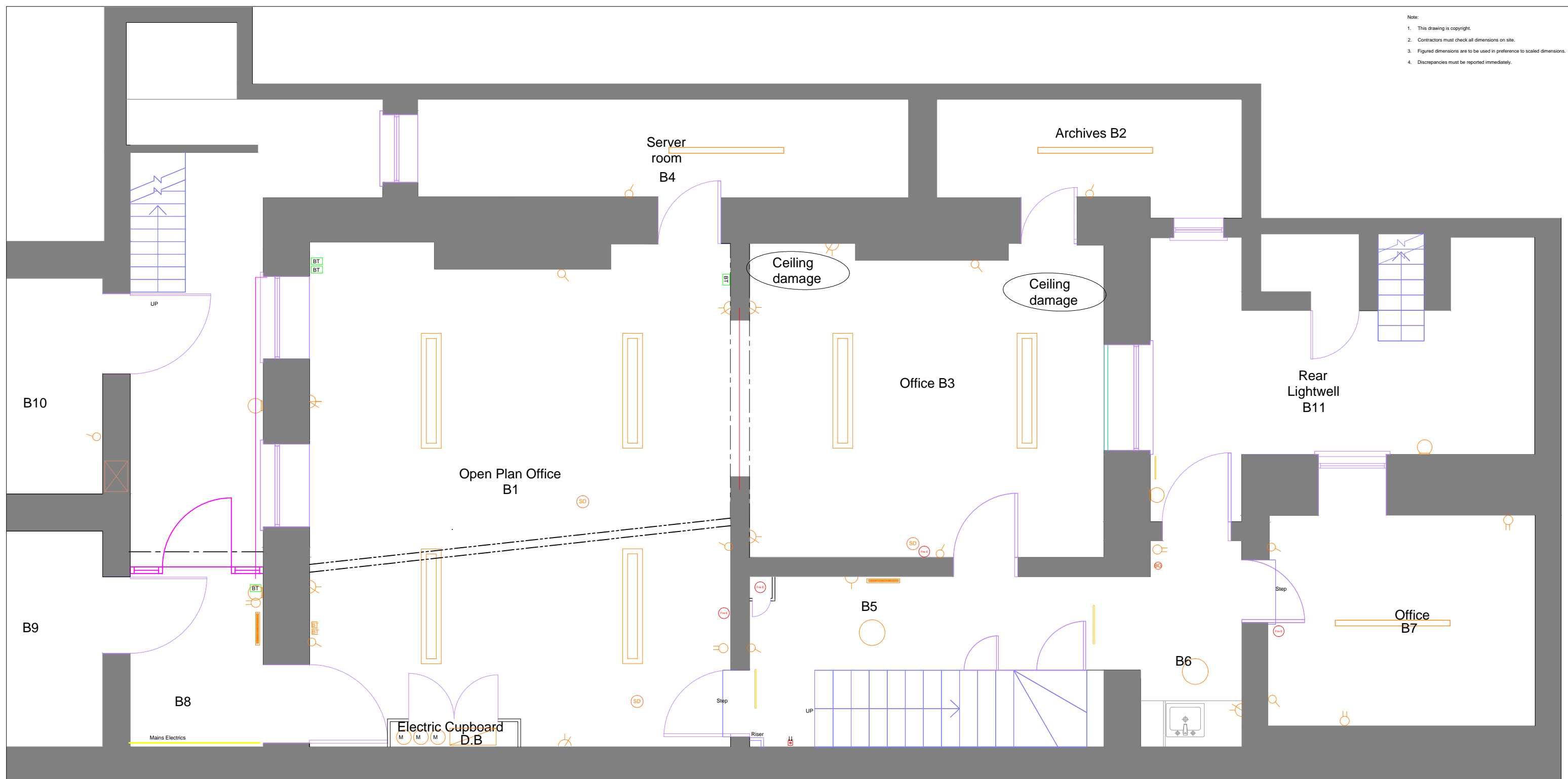

Title	Symbol
Surface mounted fluorescent light	[Symbol]
Light switch - single rocker	[Symbol]
Light switch - dimmer	[Symbol]
Light switch - double rocker	[Symbol]
Wall light fitting	[Symbol]
Double switch socket outlet	[Symbol]
Dome ceiling or wall mounted light	[Symbol]
Electric Panelled Radiator	[Symbol]
Fire alarm break glass call point	[Symbol]
Fire alarm panel	[FAP]
Intruder alarm	[I.A]
Distribution Board	[D.B]
Smoke Detector	[SD]
Chandelier	[Symbol]
Air Cooling	[Symbol]
Emergency Light fitting	[Symbol]
Entry Phone	[Symbol]
Ventilation extract diffuser	[Symbol]
Fire extinguisher	[Symbol]
Fire alarm sounder	[Symbol]
Drainage gully	[Symbol]
MH drainage inspection chamber	[Symbol]
Steel Beam	[Symbol]
Stud partition	[Symbol]
FD	Fire Door
EX	Existing Door
D	Door

- Notes: Alteration works
- Remove existing light fittings from all internal rooms. Install replacement LED light fittings. Linear fittings in offices B1, B2, B3, B4 and B7 to be suspended approx 250mm below ceilings.
 - Dome lights in lobbies B5, B6 and B8. Lights to be controlled from existing switch positions.
 - Retain existing emergency light fittings and external light fittings.
 - Retain existing fire alarm and smoke detection system.
 - Remove power sockets fitted to existing partitioning to be removed.
 - Relocate power points on lateral walls to side of new opening.
 - Retain the electric mains head and meter.
 - Replace the distribution point to the electric cupboard.
 - Extend electrical power to serve new cooling system condenser and cooling units and kitchenette to B6 and new office B7. Cabling to be surfaced mounted, not chased into the building fabric and boxed in.
 - Electric panel heaters to lobbies B5 and B8.

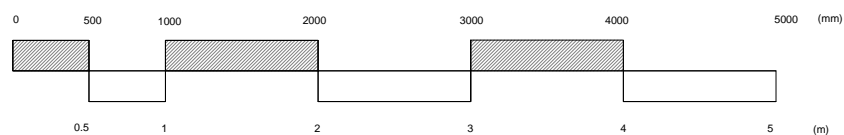

REVISION	DATE	DESCRIPTION	BY

MATTHEWS & SON LLP
Chartered Surveyors
26 Bedford Square, London, WC1B 3HP

PROJECT
**87 GOWER STREET,
LONDON, WC1E 6AF**

DETAIL
**Proposed Basement
Electrical Services**

DATE	21/03/2018	DRAWN BY	HAB
SCALE	1:50 @ A3	CHECKED BY	

DRAWING NUMBER
13002/3/110