

3 Section 01

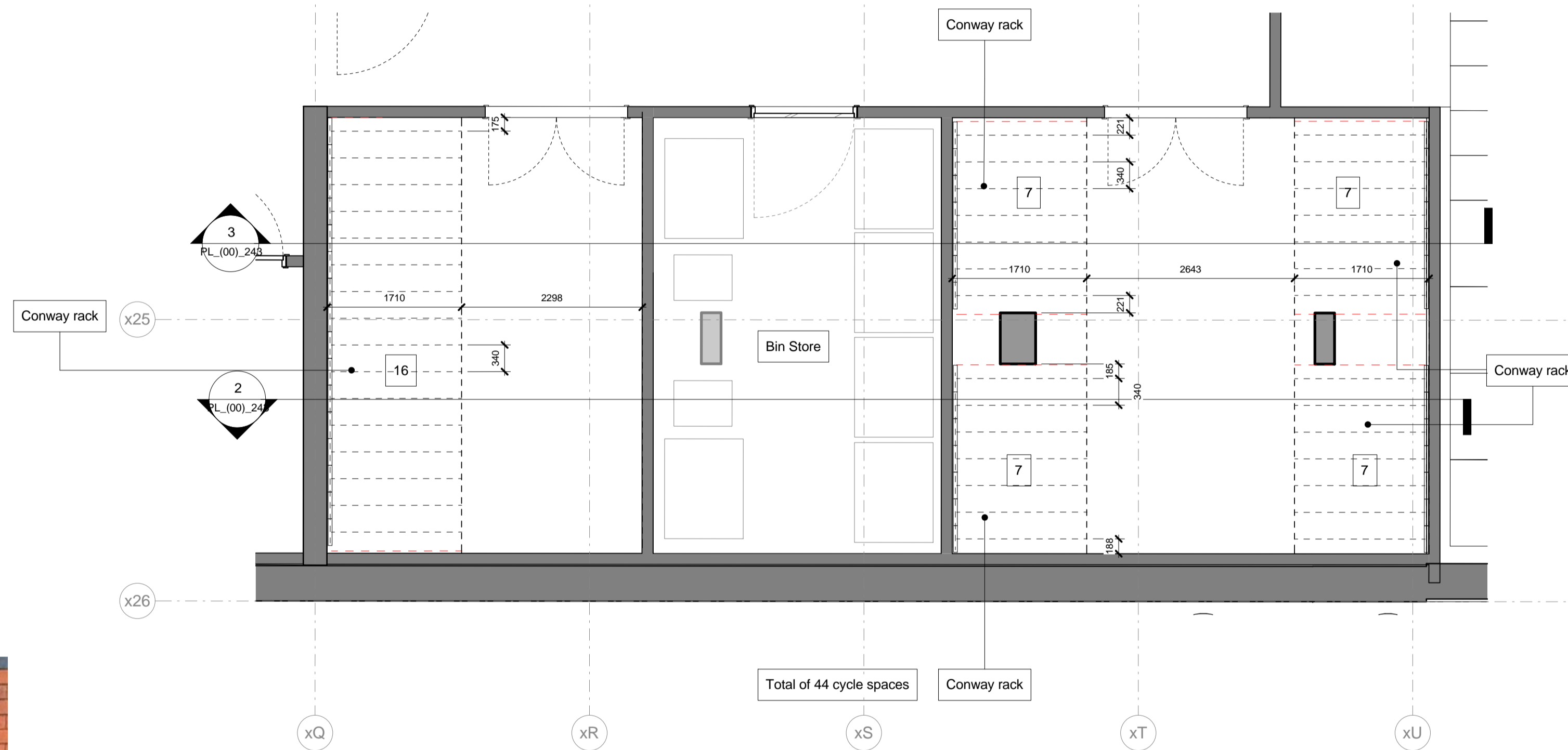

1 Residential Bike Stores



2 Section 02



Conway bike rack with additional locking hoop at 340mm centres

Conway Rack With additional locking hoop

KEY

REV	DATE	DESCRIPTION
P01	240518	PLANNING
P02	220818	PLANNING

CONSULTANTS

CLIENT:	21-31 New Oxford Street Development Ltd.
CONTRACTOR:	Laing O'Rourke
PROJECT MANAGER:	Gardiner & Theobald
STRUCTURAL ENGINEER:	Arup Structures
MECHANICAL ENGINEER:	Arup M&E
ACOUSTIC CONSULTANT:	Arup Acoustics
CLADDING CONSULTANT:	Arup Facades
COST CONSULTANT:	Arcadis

NOTE

- Do not scale from this drawing.
- All dimensions to be checked on site by the contractor and such dimensions to be his responsibility. Report all drawing errors, omissions and discrepancies to the architect.
- This document may be issued in an uncontrolled CAD format to enable others to use it as background information to make alterations and/or additions. In that instance the file will be accompanied by a PDF version. It is for those making such alterations and additions to ensure that they make use of current background information.
- AHMM Ltd accepts no liability for any such alterations or additions to the background information or arising out of changes to background information which occur prior to alterations of additions being made.
- Landscape shown is indicative only. Please refer to Landscape Consultant's report for details.

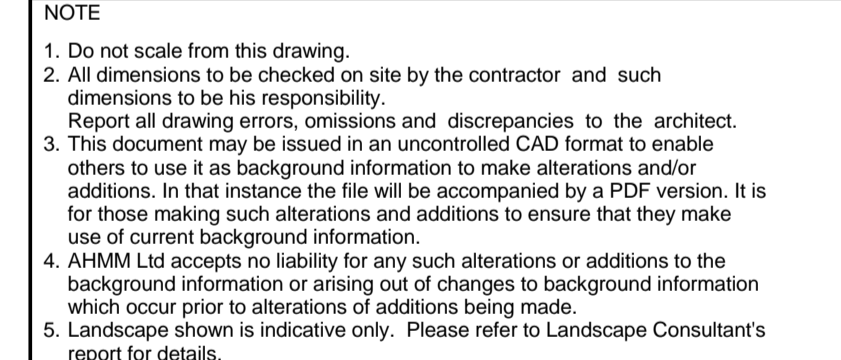

**ALLFORD HALL MONAGHAN MORRIS**  
 ARCHITECTS Ltd  
 MORELANDS, 5-23 OLD STREET LONDON EC1V 9HL  
 TEL 020 7251 5261 FAX 020 7251 5123 WEB WWW.AHMM.CO.UK  
 job title  
**The Post Building**  
 drawing title / location  
**Residential Bike Store**

drawn by	checked	scale	status
SR		1 : 50 @ A1	PLANNING
project	drawing no.	revision	
12141	PL_(00)_243	P02	