

Upstand
(Drg.No: D0901-00W_1-2Deg_201-Ext-XF301-SM_001)

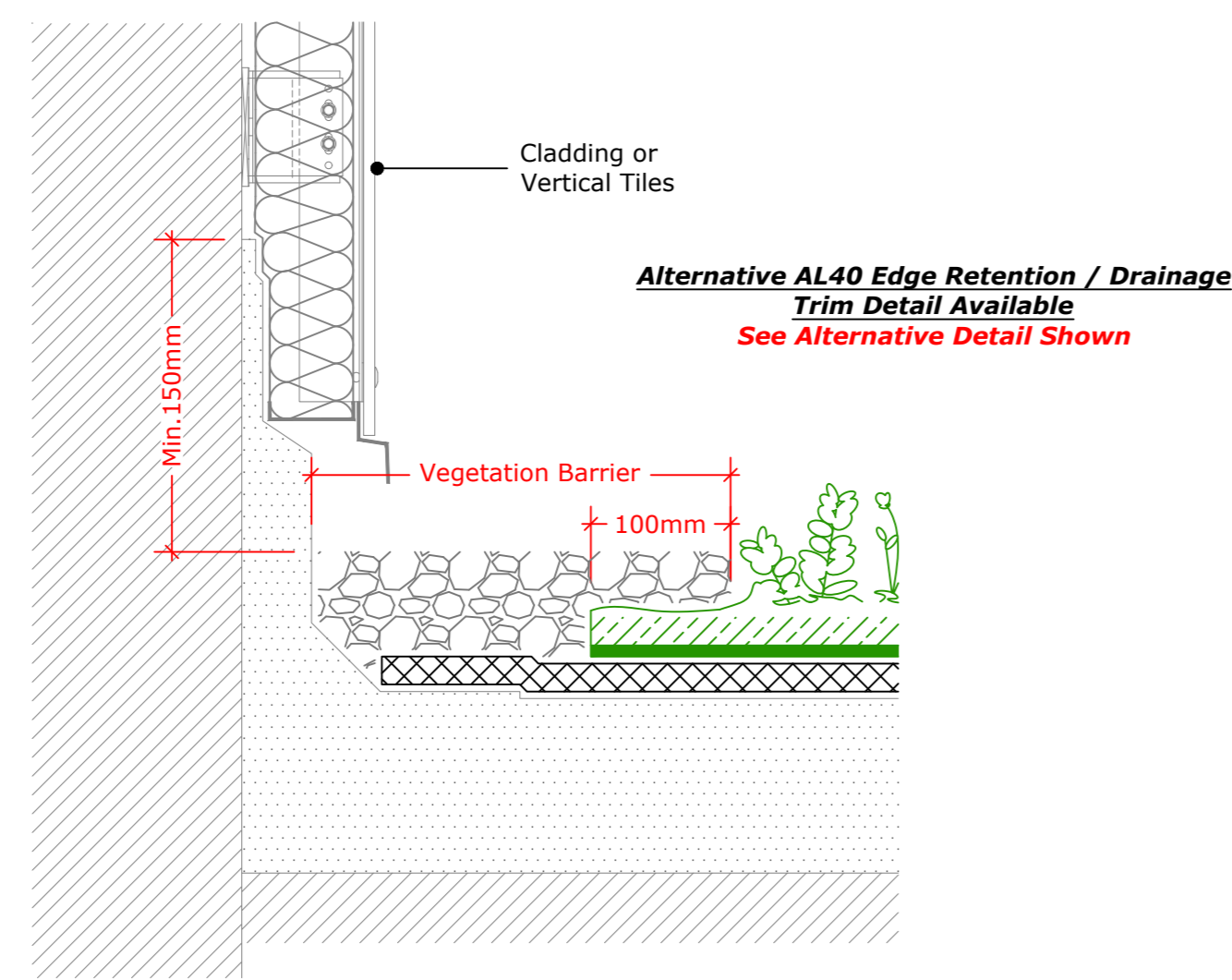

Upstand to Vertical Cladding or Slates/Tiles
(Drg.No: D0901-00W_1-2Deg_201-Ext-XF301-SM_002)

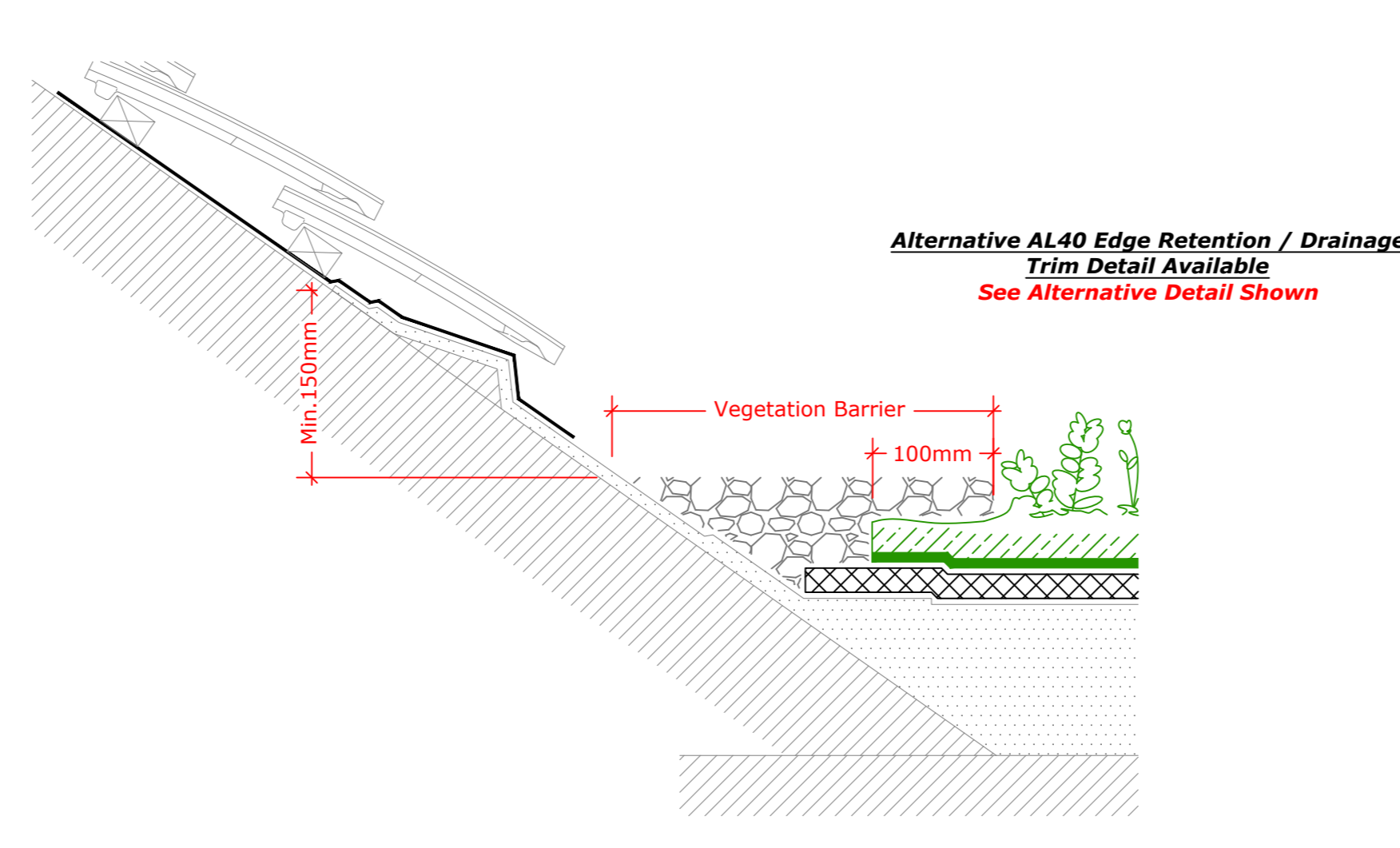

Upstand to Pitched Roof
(Drg.No: D0901-00W_1-2Deg_001-Ext-XF301-SM_004)

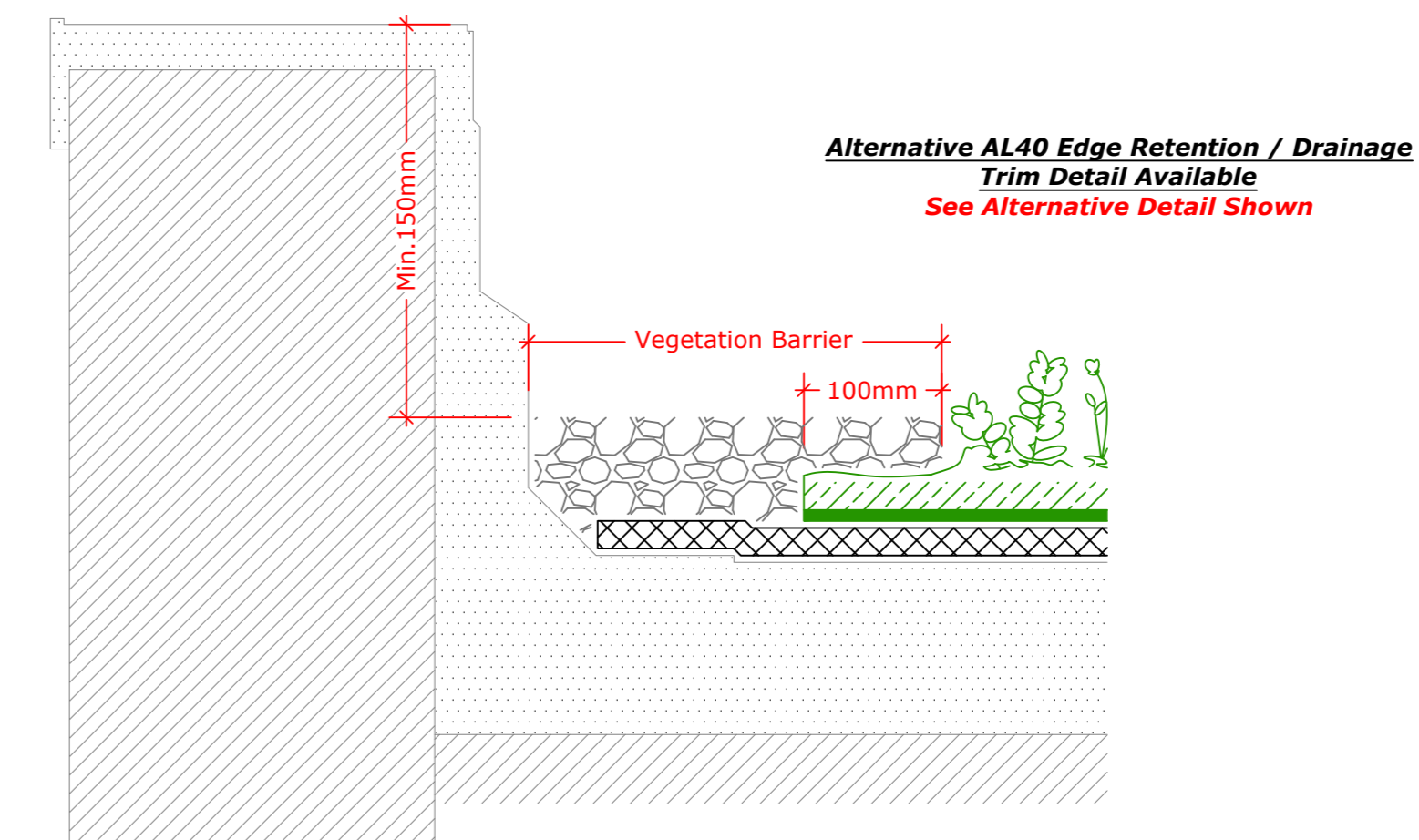

Parapet Upstand
(Drg.No: D0901-00W_1-2Deg_203-Ext-XF301-SM_001)

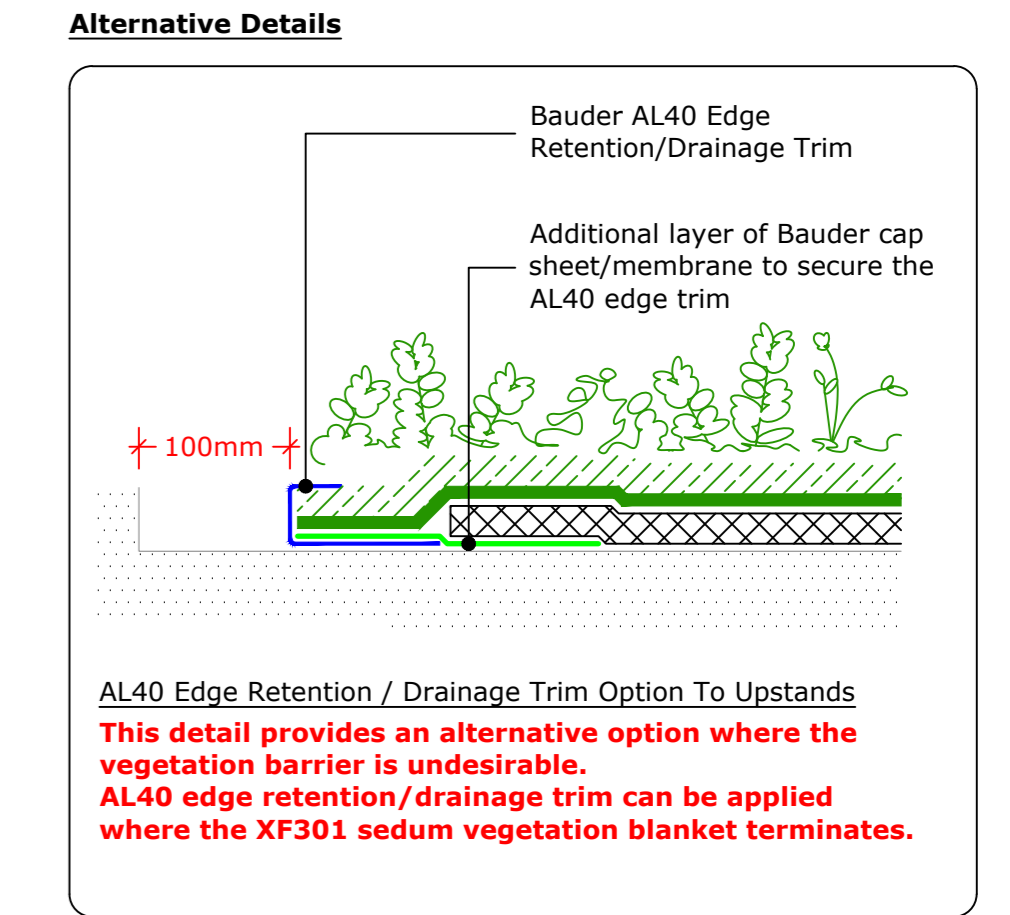

Alternative Details
Bauder AL40 Edge Retention/Drainage Trim
Additional layer of Bauder cap sheet/membrane to secure the AL40 edge trim
+100mm
AL40 Edge Retention / Drainage Trim Option To Upstands
This detail provides an alternative option where the vegetation barrier is undesirable. AL40 edge retention/drainage trim can be applied where the XF301 sedum vegetation blanket terminates.

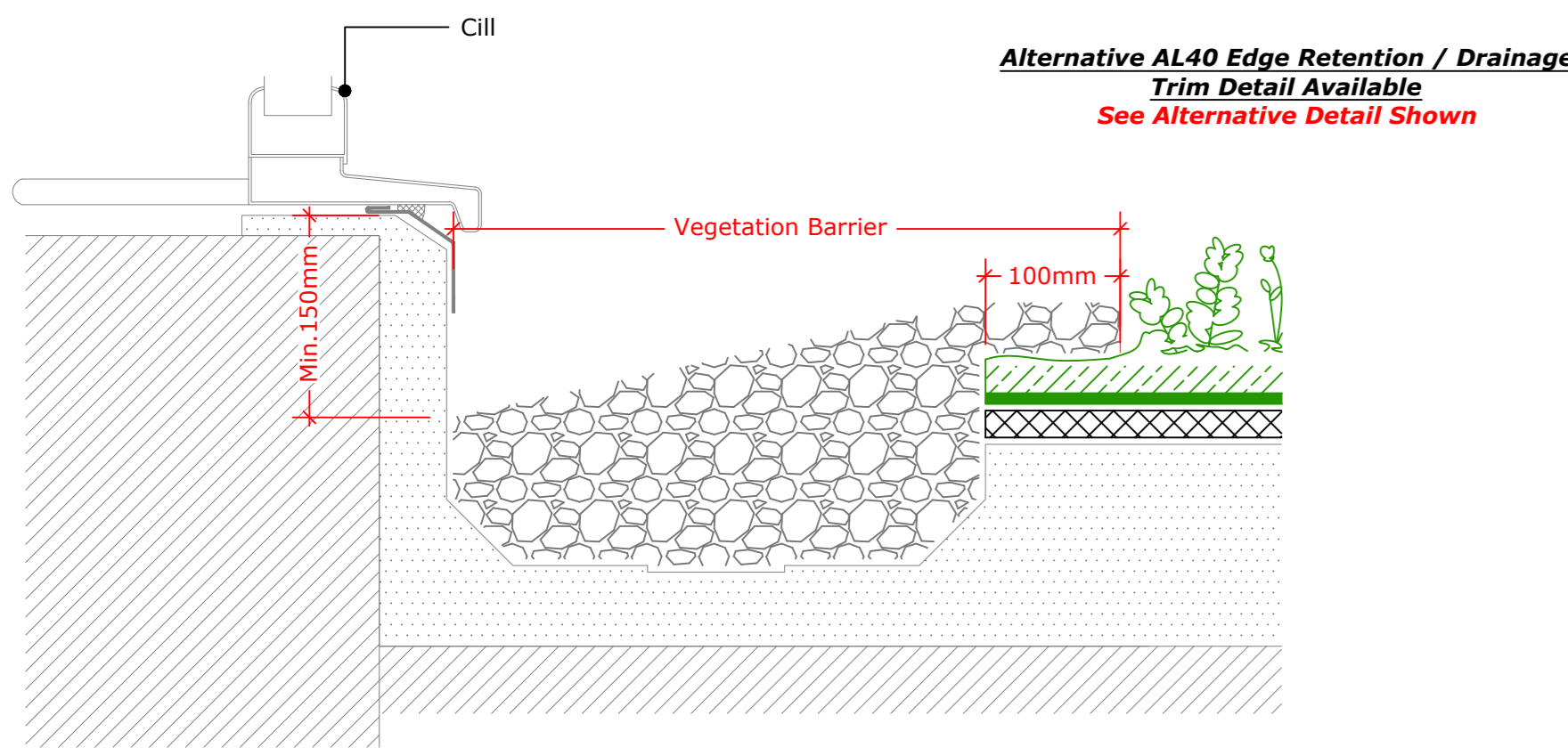

Internal Gutter to Clerestory Window
(Drg.No: D0901-00W_1-2Deg_206-Ext-XF301-SM_003)

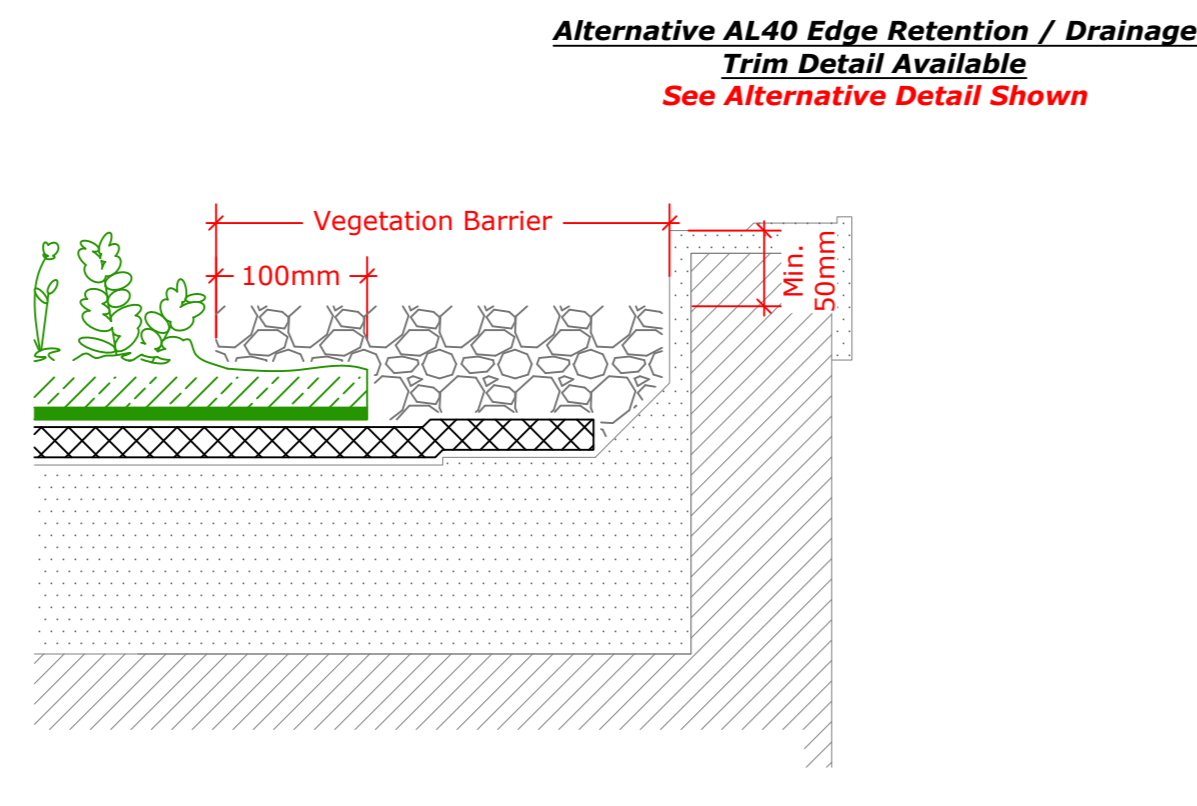

Perimeter Kerb
(Drg.No: D0901-00W_1-2Deg_002-Ext-XF301-SM_001)

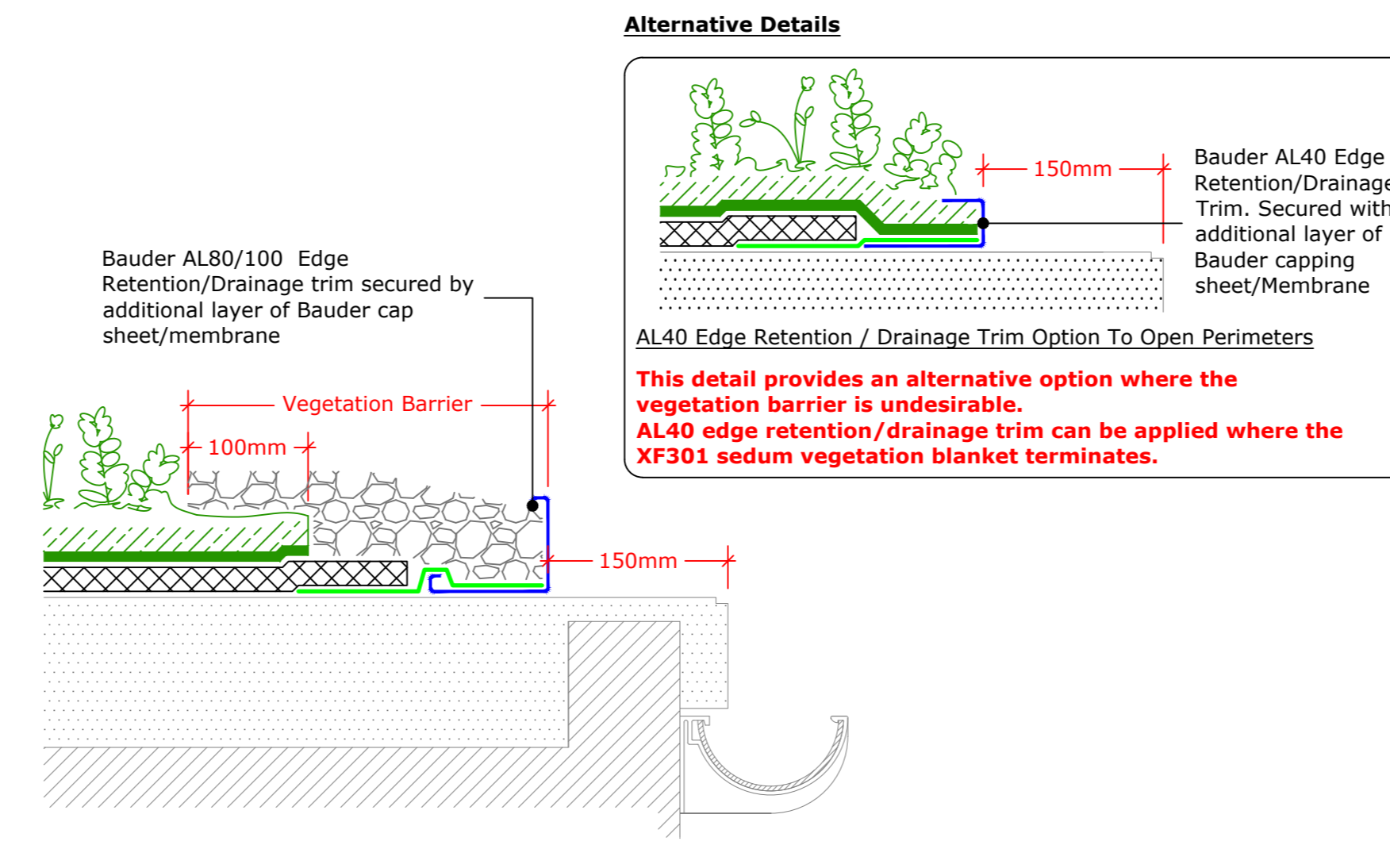

External Gutter
(Drg.No: D0901-00W_1-2Deg_006-Ext-XF301-SM_005)

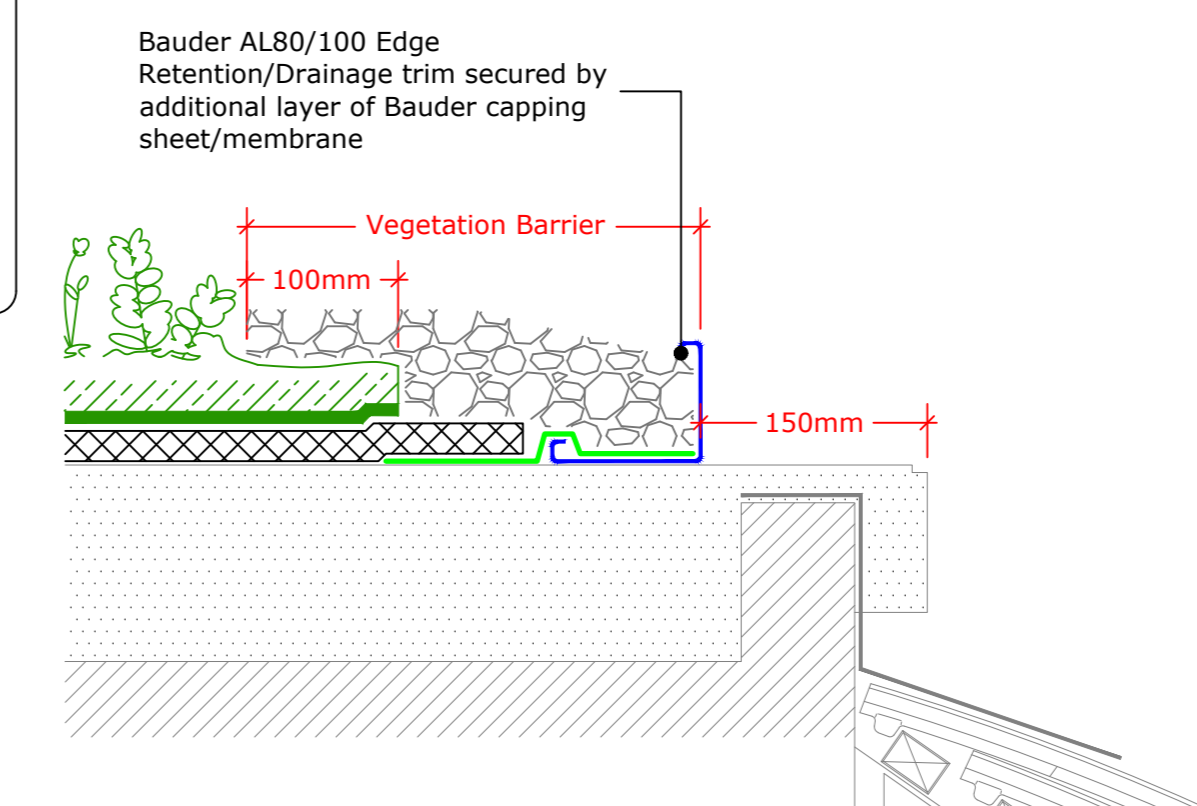

Detail to Mansard Roof
(Drg.No: D0901-00W_1-2Deg_006-Ext-XF301-SM_006)

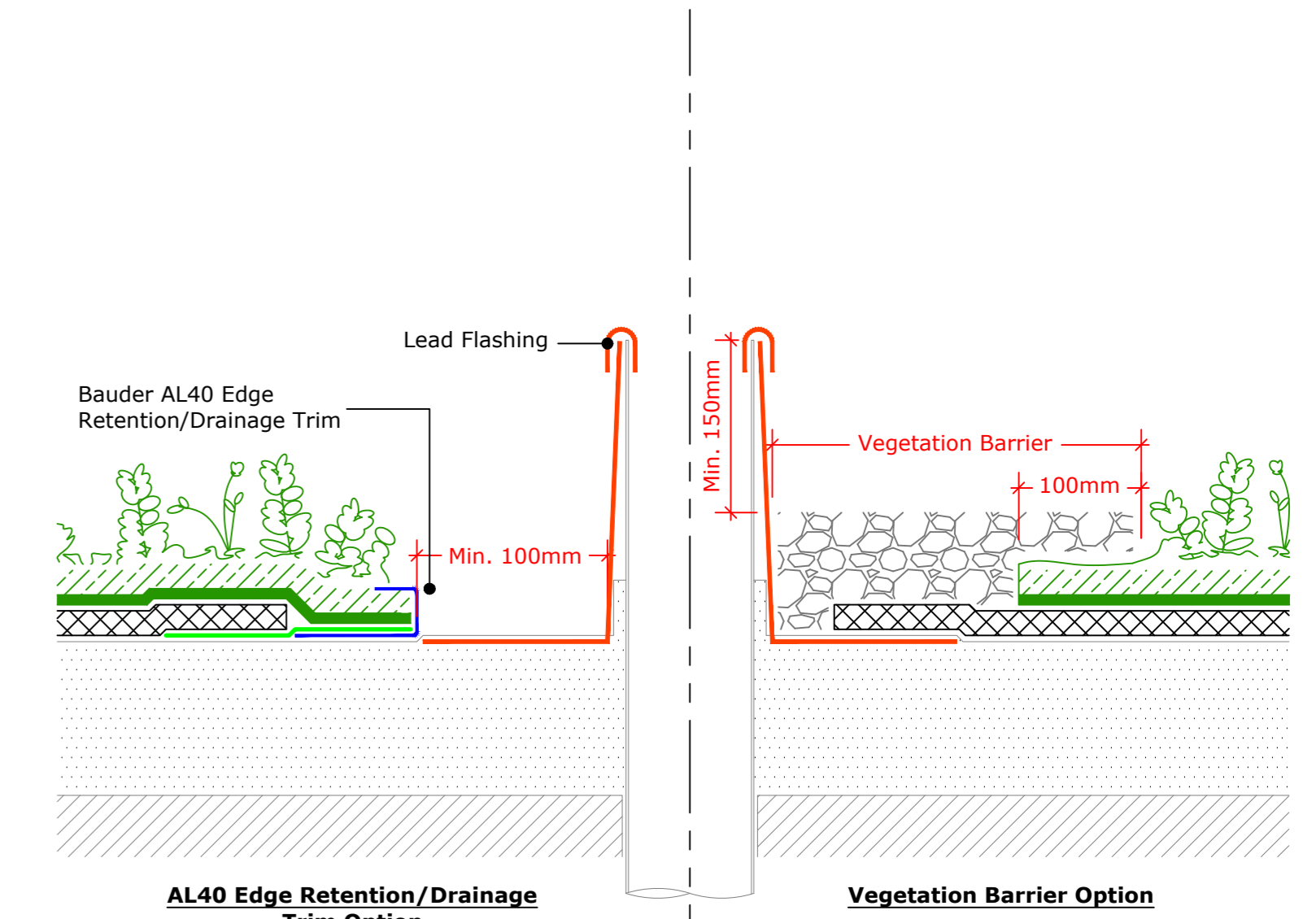

Upstand - Soil Vent Pipe
(Drg.No: D0901-00W_1-2Deg_007-Ext-XF301-SM_001)

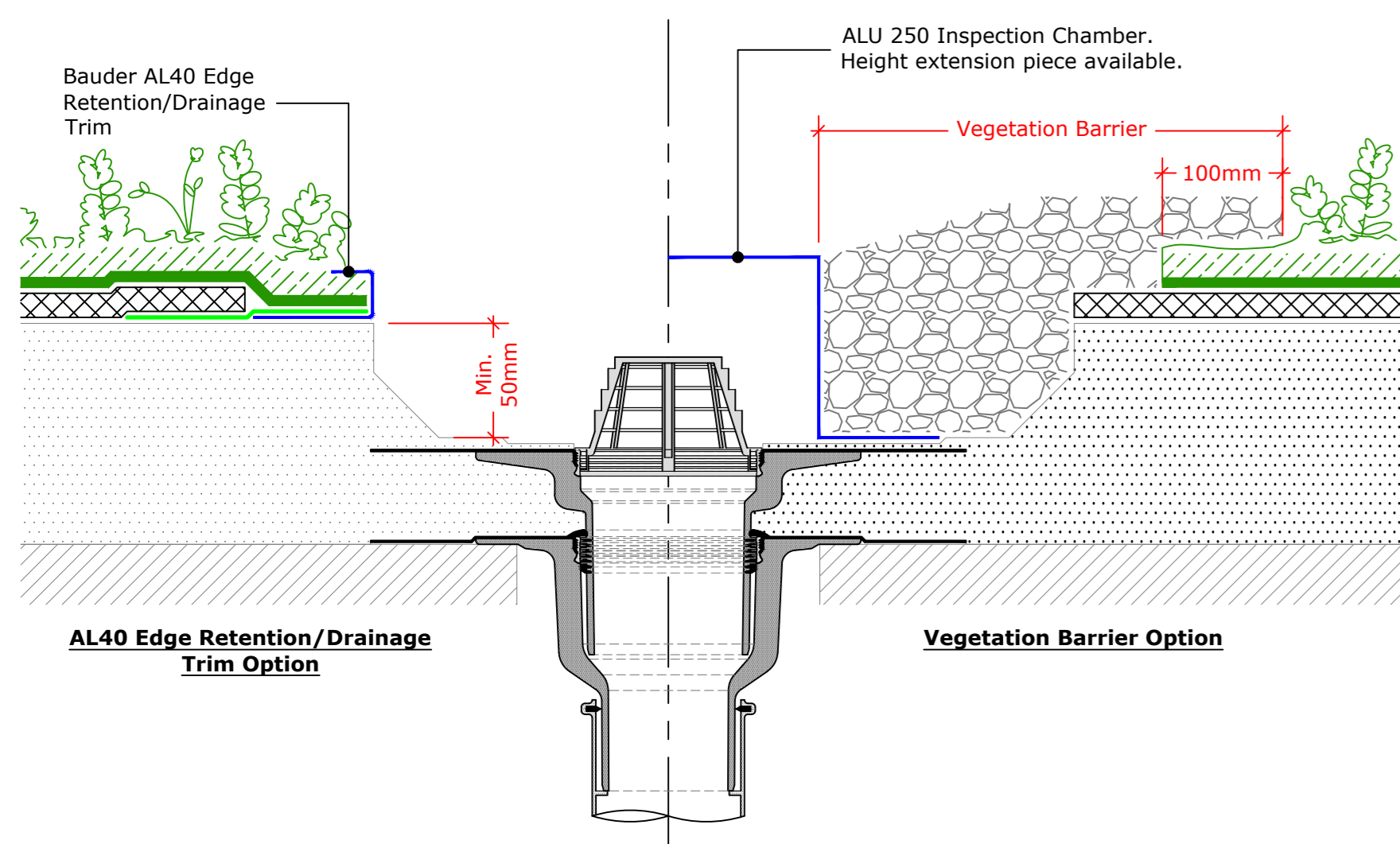

Bauder Outlet - Compact
(Drg.No: D0901-00W_1-2Deg_006-Ext-XF301-SM_001)

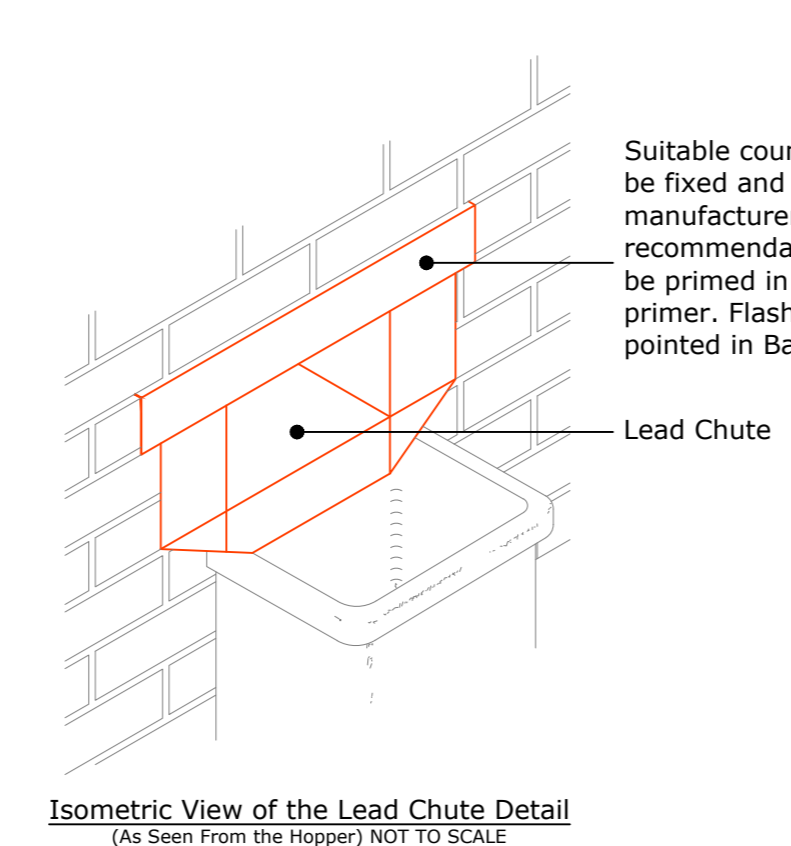

Upstand - Lead Chute
(Drg.No: D0901-00W_1-2Deg_206-Ext-XF301-SM_002)

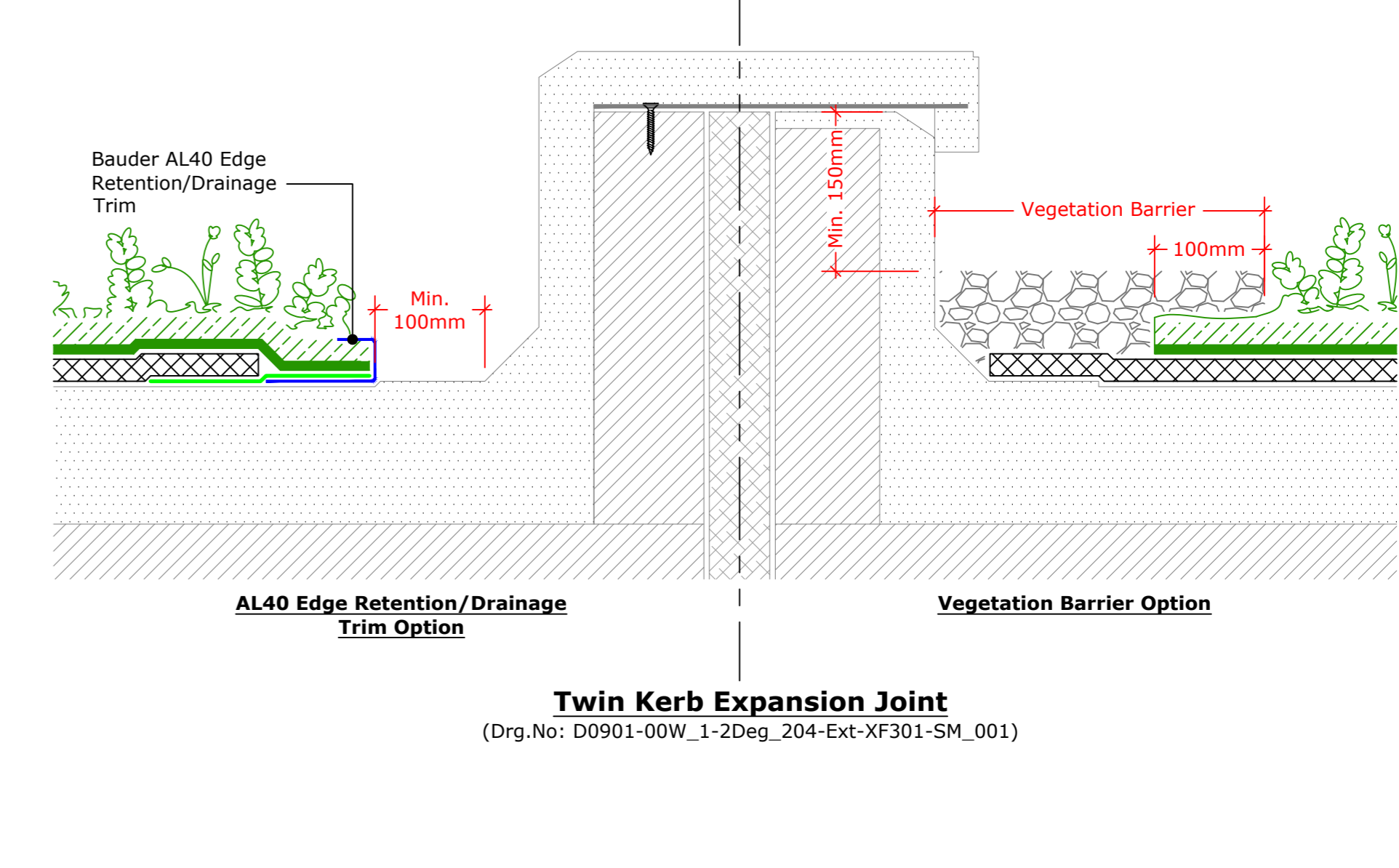
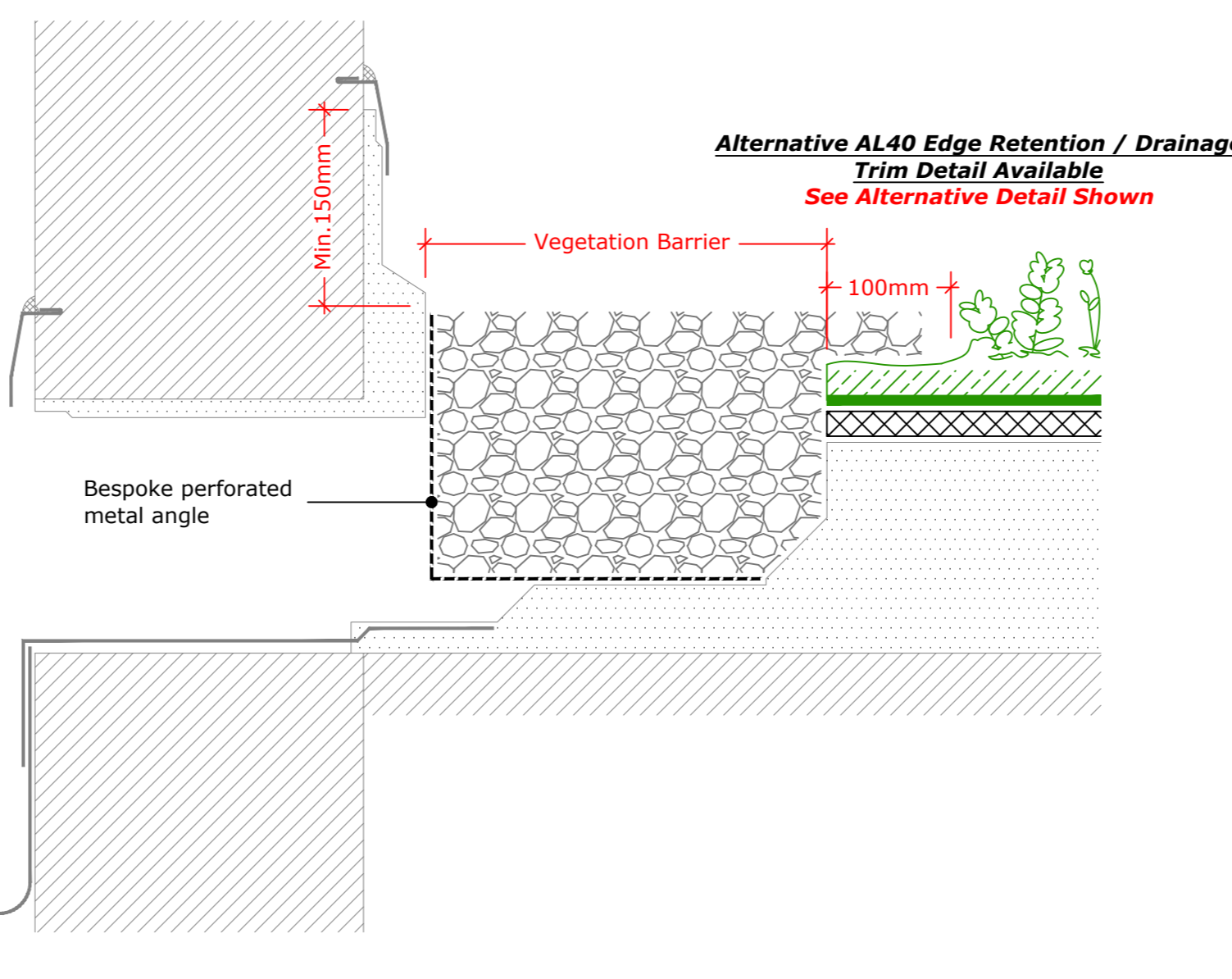

Twin Kerb Expansion Joint
(Drg.No: D0901-00W_1-2Deg_204-Ext-XF301-SM_001)

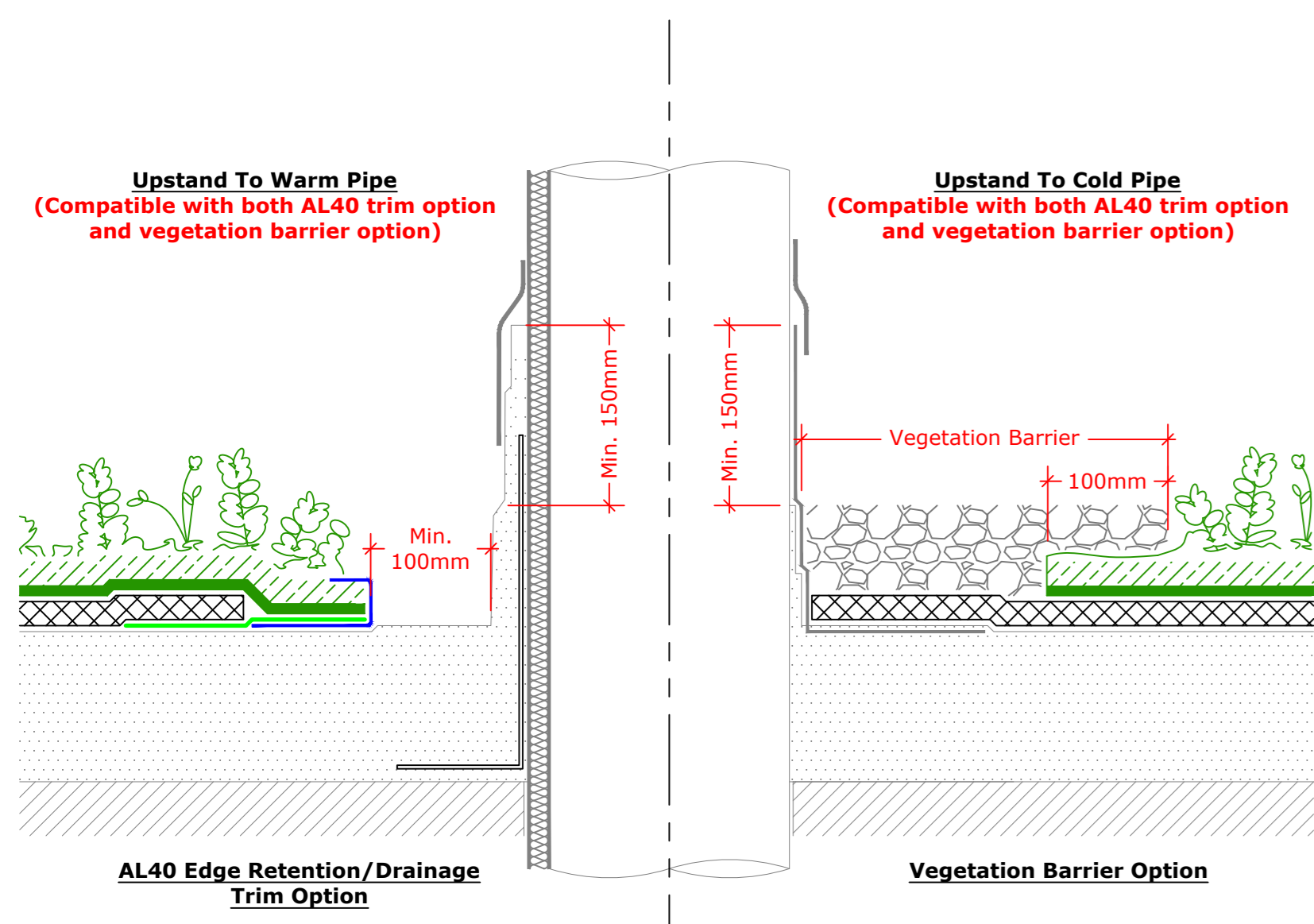

Upstand to Warm Pipe
(Drg.No: D0901-00W_1-2Deg_007-Ext-XF301-SM_002)

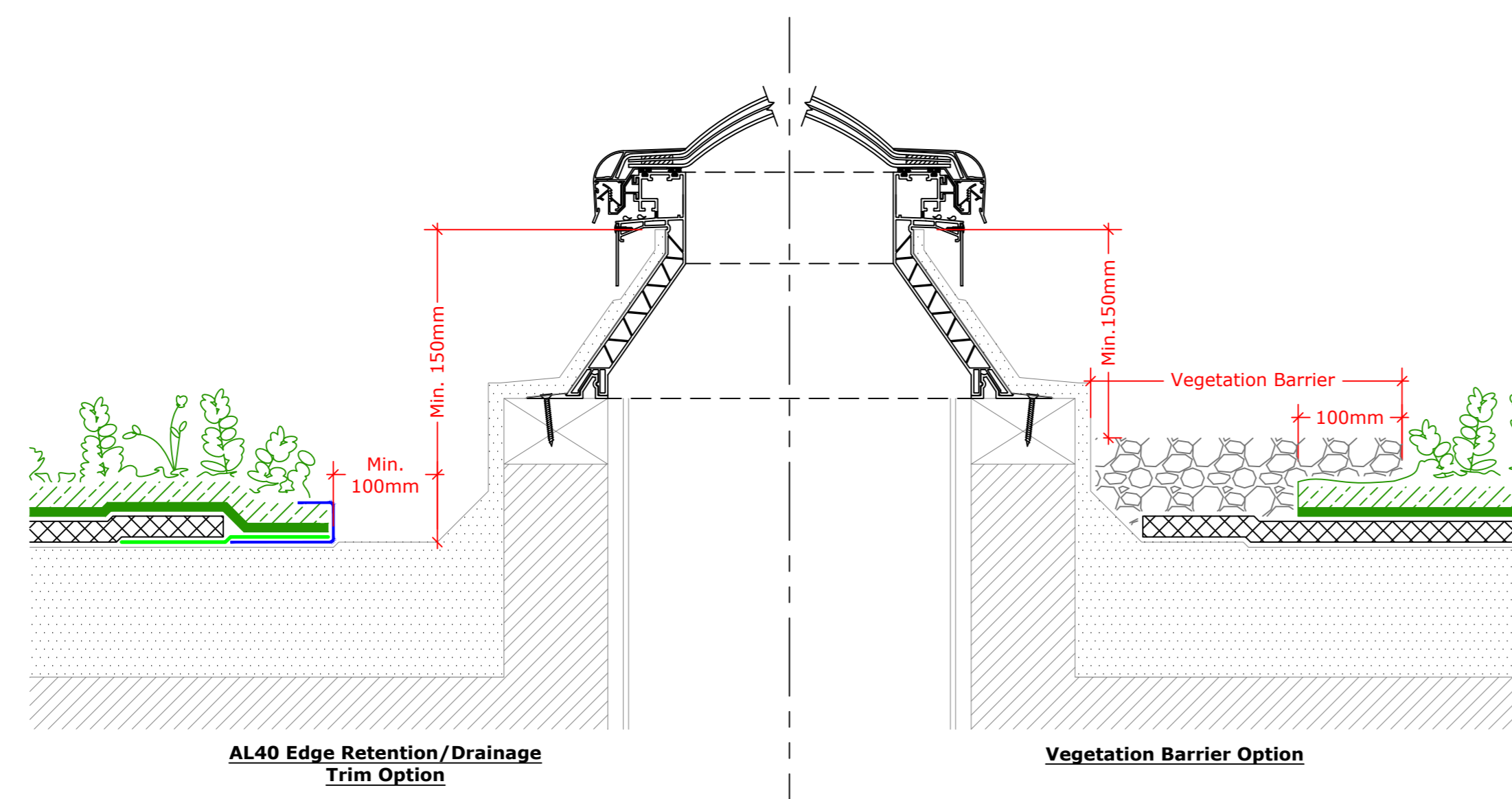

Upstand to Cold Pipe
(Drg.No: D0901-00W_1-2Deg_008-Ext-XF301-SM_001)

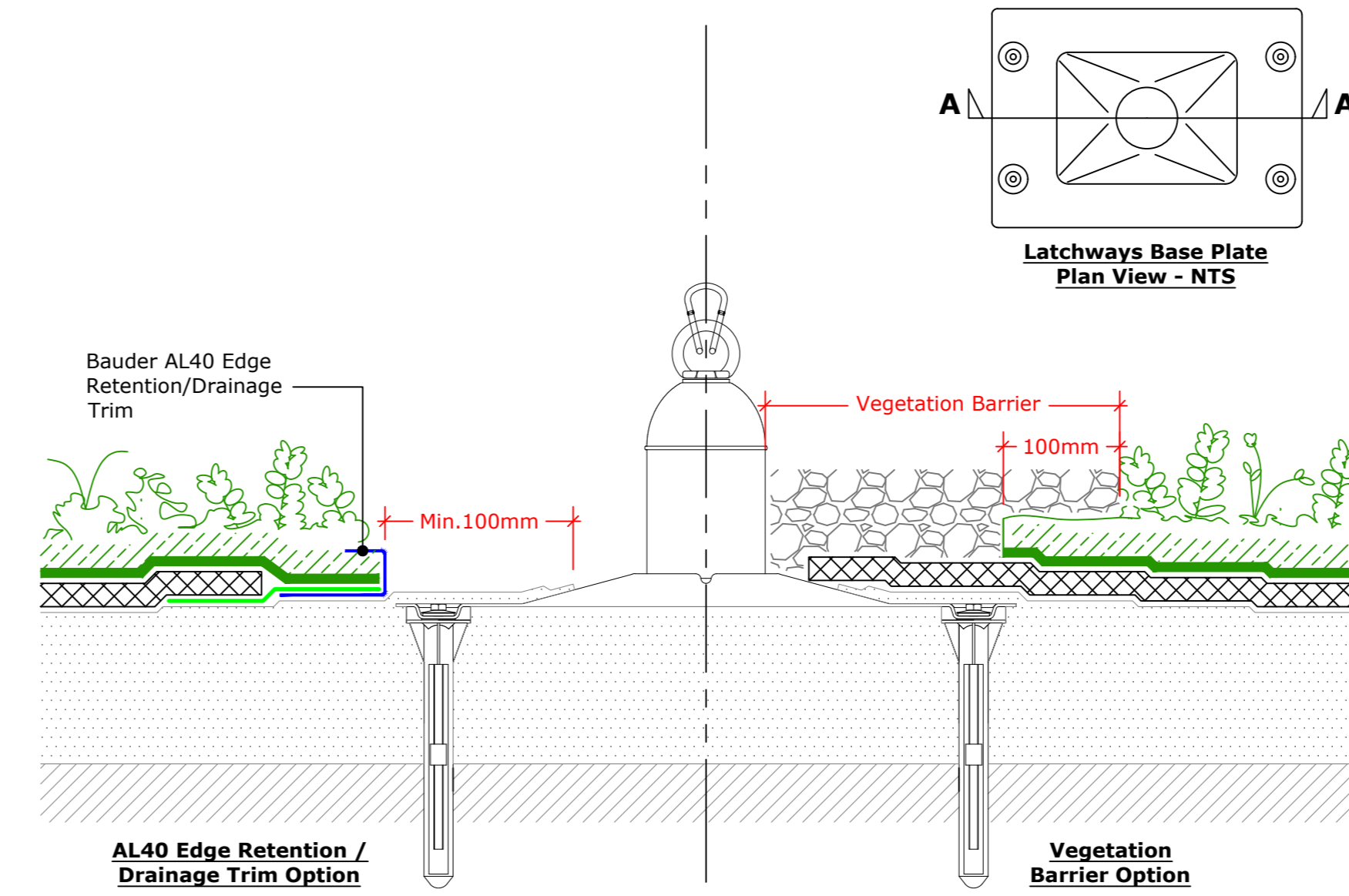

Upstand to Bauder Euroslight - Euroslight
(Drg.No: D0901-00W_1-2Deg_008-Ext-XF301-SM_001)

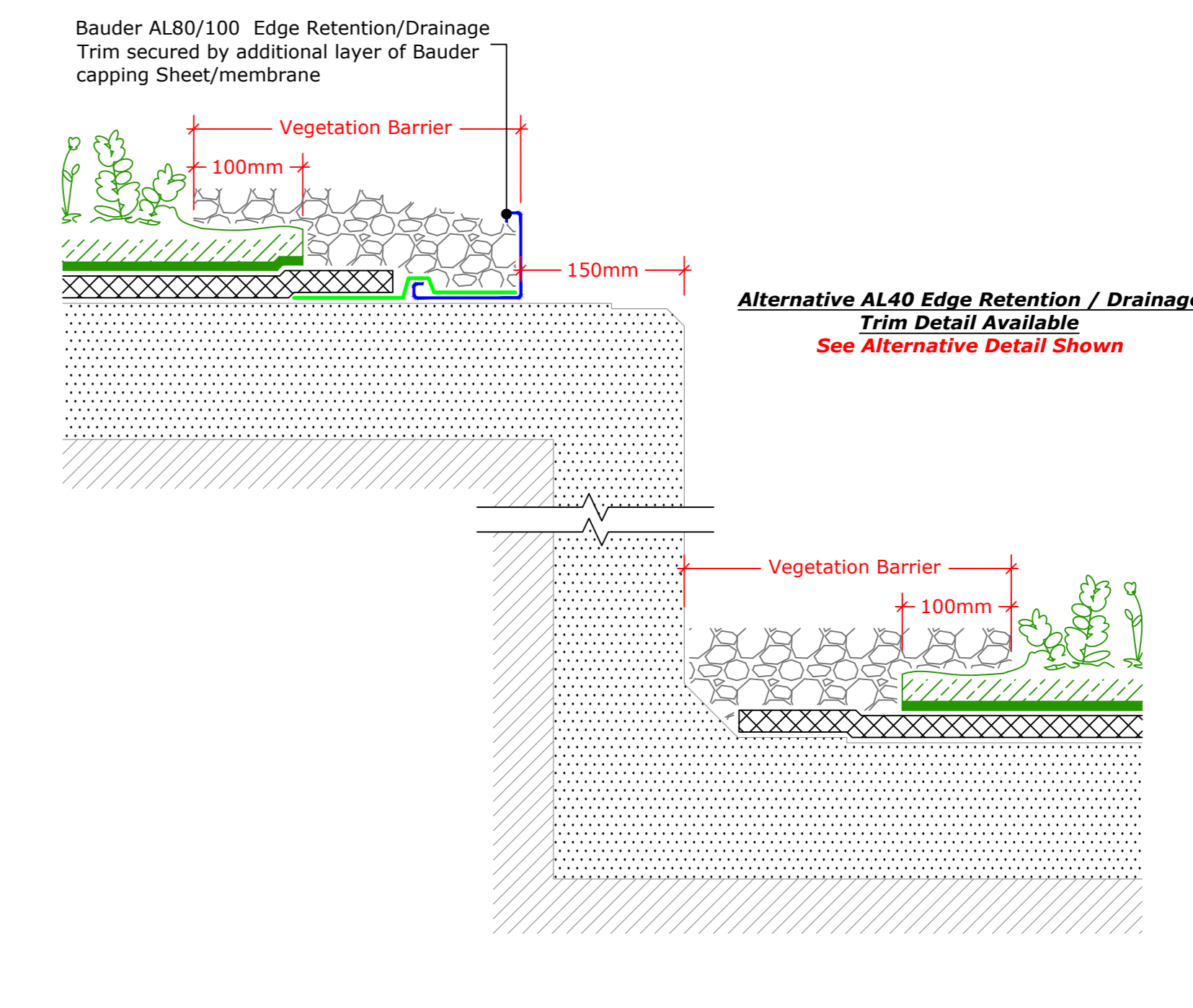

Change In Level
(Drg.No: D0901-00W_1-2Deg_210-Ext-XF301-SM_001)

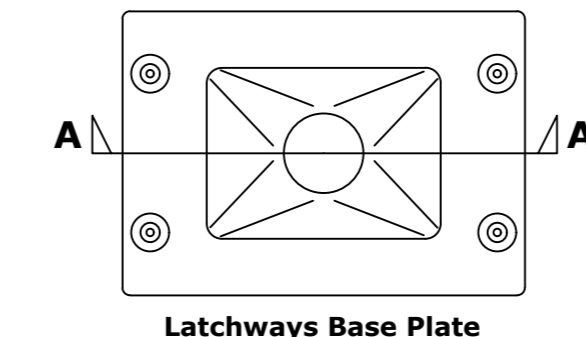

Latchways Constant Force Post
(Drg.No: D0901-00W_1-2Deg_009-Ext-XF301-SM_001)

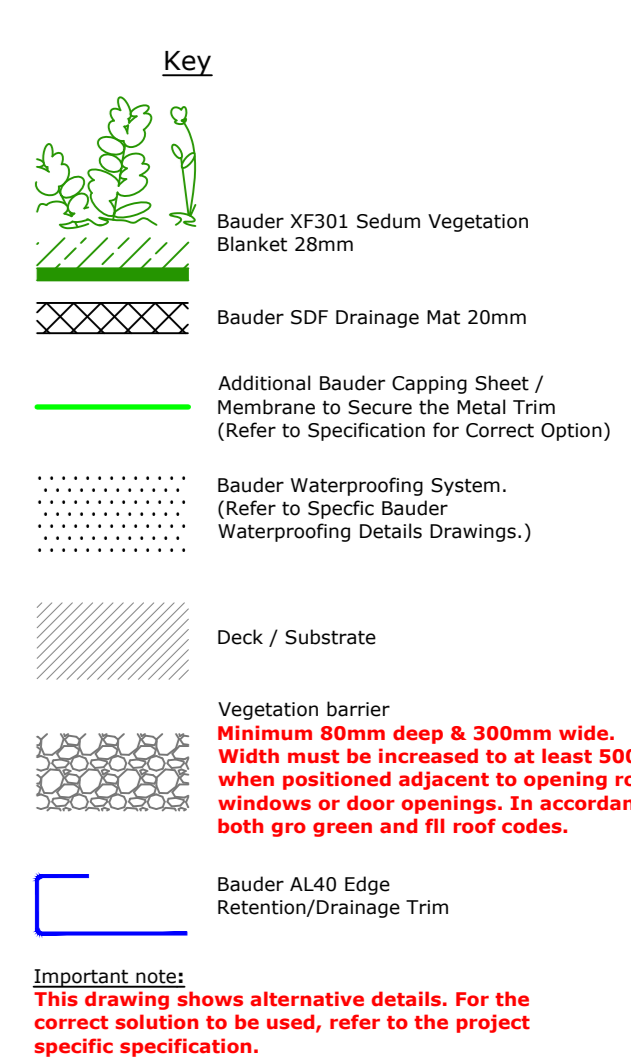

Key
Bauder XF301 Sedum Vegetation Blanket 28mm
Bauder SDF Drainage Mat 20mm
Bauder AL40 Edge Retention/Drainage Trim
Bauder Waterproofing System. (Refer to Specific Bauder Waterproofing Details Drawings.)
Deck / Substrate
Vegetation Barrier
Minimum 80mm deep & 300mm wide. Width must be increased to at least 500mm when positioned adjacent to opening rooflights, windows or door openings. In accordance with both green and fire codes.
Bauder AL40 Edge Retention/Drainage Trim

IMPORTANT NOTES:
1. These details are suitable for use on the following Bauder Systems:
Bauder Total Green Roof System
Bauder Green
2. Thermal and Thermoplastic
3. This Drawing Shows Alternative Options. For the Correct Solution to be Used, Refer to the Project Specific Specification.
4. Do not scale to ascertain dimensions.
5. All dimensions to be checked and verified on site prior to commencement of work.
6. This drawing is to be read in conjunction with the specification and associated drawings.
7. This detail is a guideline only, representing typical detailing conditions and illustrates the correct application of the above Bauder System. It may be necessary to modify this detail to suit specific project design constraints and conditions.
8. Refer to the Bauder Specification for the product description and method of application. For clarity the method of attachment has not been shown.
9. Provisions should be made by the installer for maintaining the top leading edge of all upstand details in excess of 250mm in height using appropriate fasteners.

Rev	Date	Description	Drawn By



UK OFFICE
Bauder Limited
70 Lonsdale Road, Ipswich,
Suffolk IP1 3DB,
England.
Tel: +44 (0)1473 257671
Fax: +44 (0)1473 230761
Email: technical@bauder.co.uk
bauder.co.uk

IRELAND OFFICE
Bauder Limited
Duffy Centre, Cross Lane,
Carrigrohane, Co. Wexford,
Ireland.
Tel: +353 (0)42 9692 333
Fax: +353 (0)42 9692 879
Email: technical@bauder.ie
bauder.ie

XF301 Sedum Blanket 1°-2° Slope

© Copyright. This drawing is subject to copyright. No part of this document may be reproduced in any form, without the permission of BAUDER LTD.