

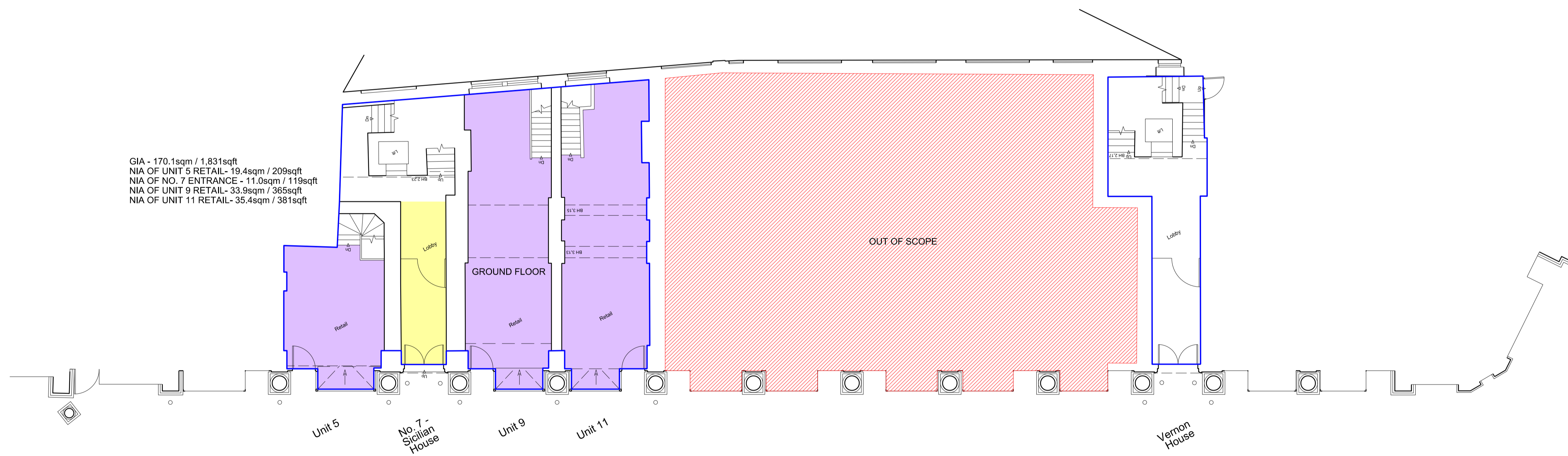



DO NOT SCALE THIS DRAWING

Contractors are to check all dimensions prior to commencement on site and notify the architect of any errors, omissions, or discrepancies.

TateHindle Limited retain copyright of this drawing. It may not be copied, altered or reproduced in any way without their written authority.

GIA - 170.1sqm / 1,831sqft
NIA OF UNIT 5 RETAIL- 19.4sqm / 209sqft
NIA OF NO. 7 ENTRANCE - 11.0sqm / 119sqft
NIA OF UNIT 9 RETAIL- 33.9sqm / 365sqft
NIA OF UNIT 11 RETAIL- 35.4sqm / 381sqft



-  GIA OUTLINE
-  NET AREA
-  OUT OF SCOPE
-  NET AREA (Retail)

Rev	Description	Date	Drawn	Checked
03	Issued for planning	31-07-18	HEG	SB
02	Issued to BC	25-06-18	HEG	SB
01	Survey drawing received, NIA & GIA added	15-06-18	JK	SB
00	Issued with pre-app	09-03-18	HEG	SB

Status
FOR INFORMATION

Client
LABs Holborn

Project
**LABs Sicilian Avenue and Vernon House
Holborn, London**

Drawing
**EXISTING
GROUND FLOOR PLAN**

Scale	Drawn	Date	Checked
1:100@A1	HEG	11-06-18	SB

Project no.	Dwg	Revision
15166	EX(03)010	03

tatehindle

TateHindle Limited
1 Lindsey Street
Smithfield
London EC1A 9HP
T 020 7332 4850
mail@tatehindle.co.uk
www.tatehindle.co.uk

