

**DO NOT SCALE THIS DRAWING**

Contractors are to check all dimensions prior to commencement on site and notify the architect of any errors, omissions, or discrepancies.

TateHindle Limited retain copyright of this drawing. It may not be copied, altered or reproduced in any way without their written authority.

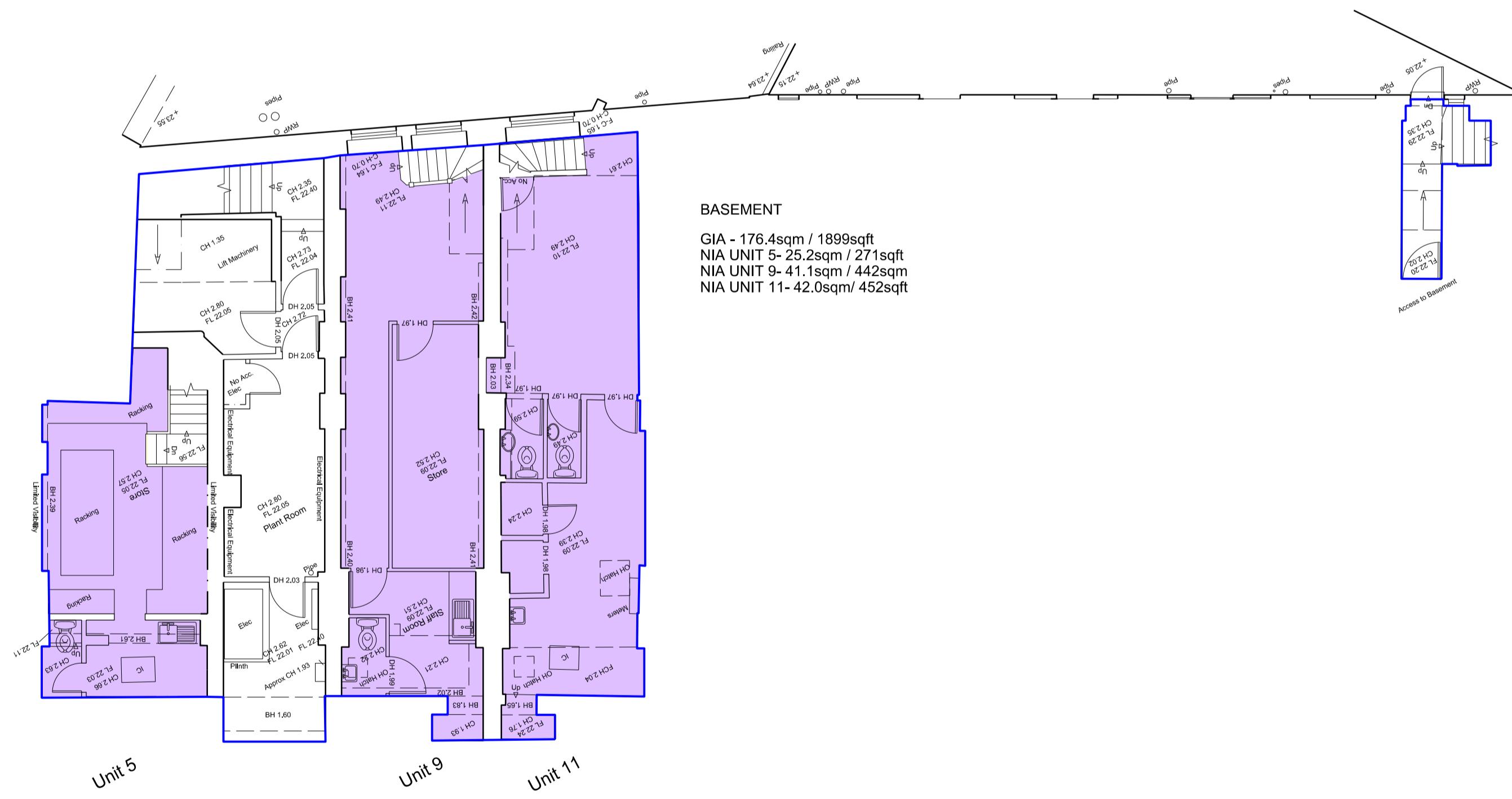

**BASEMENT**  
 GIA - 176.4sqm / 1899sqft  
 NIA UNIT 5 - 25.2sqm / 271sqft  
 NIA UNIT 9 - 41.1sqm / 442sqm  
 NIA UNIT 11 - 42.0sqm / 452sqft

- GIA OUTLINE
- NET AREA
- OUT OF SCOPE
- NET AREA (Retail)

SICILIAN AVENUE

BLOOMSBURY WAY

Rev	Description	Date	Drawn	Checked
03	Issued for planning	31-07-18	HEG	SB
02	Issued to BC	25-06-18	HEG	SB
01	Survey drawing received, NIA & GIA added	15-06-18	JK	SB
00	Issued with pre-app	09-03-18	HEG	SB

**FOR INFORMATION**

Client  
**LABs Holborn**

Project  
**LABs Sicilian Avenue and Vernon House Holborn, London**

**EXISTING BASEMENT FLOOR PLAN**

Scale	Drawn	Date	Checked
1:100@A1	HEG	11-06-18	SB
Project no.	Dwg	Revision	
15166	EX(03)009	03	

**tatehindle**

**TateHindle Limited**  
 1 Lindsey Street  
 Smithfield  
 London EC1A 9HP

T 020 7332 4850  
 mail@tatehindle.co.uk  
 www.tatehindle.co.uk

