

REVISION LEGEND
(AUGUST 2018)

CHANGES TO SCHEME FOR DENOTED FOR PLANNING

Copyright: All rights reserved. This drawing must not be reproduced without permission.

Only the original drawing should be relied upon. Contractors, subcontractors and suppliers must verify all dimensions on site before commencing any work or making any shop drawings.

All shop drawings to be submitted to the architect for comment prior to fabrication.

This drawing is to be read in conjunction with the Architect's specification, bills of quantities / schedules, structural, mechanical & electrical drawings and all discrepancies are to be reported to the architect.

Do not scale from this drawing. Dimensions are in millimetres unless otherwise stated.

revision / date / amendments	
- / 26/01/18 /	- First Issue
A / 01/03/18 /	- Indicative sump pump / chamber shown
B / 23/03/18 /	- 1. Tender Addendum (1). Indication of 4 post truss fixed at stage level for integrated automatic retractable acoustic baffles and integrated lighting rig. 2. Tender Addendum (2). New AHU + Attenuator over stage to be hung to existing relocated secondary beams in Flytower.
C / 01/03/18 /	- Door numbers updated
D / 01/06/18 /	- Listed Building Application 1. Indication of 4 post truss fixed at stage level for integrated automatic retractable acoustic baffles and integrated lighting rig. 2. New AHU + Attenuator over stage to be hung to existing relocated secondary beams in Flytower.
E / 01/08/18 /	SB.1. Storage room added with Store, Production office & AMP Room layout adjusted
F / 15/08/18 /	Colour coding added to revised drawing Rev E

LEGEND

- Proposed Works
- Existing Building Fabric KOKO née Camden Palace Theatre (1900)
- Existing Building Fabric Hope & Anchor (approx. 1850)
- Existing Building Fabric Bayham Place (from 1875)
- Existing Modern Building Fabric Bayham Place (from 2006)
- Building Fabric to be demolished
- Demolition of Flooring / Elevation / Wall
- Proposed Excavation
- Remove and retain in alternate location
- Retain and protect existing
- Retain, make good, ease and adjusted
- Means of escape Route
- Private Members Route
- Koko Customer Route
- Public Route
- Artist Route
- Proposed Riser
- Proposed Risers Above
- RM.4-06 Room Number
- D4-02 Door Number
- W4-05 Window Number
- Hope & Anchor Demise
- Koko Demise
- 1 Bayham Street & 65 Bayham Place Demise

15.08.18

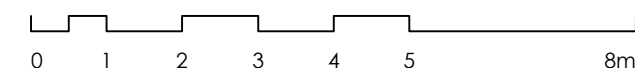
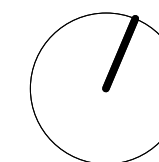

STAGE 4

Archer Humphryes Architects

Basement
Central House
142 Central Street
London, United Kingdom
EC1V 8AR
T: +44 (0) 20 7251 8555

project title	
KOKO + Hope & Anchor + Bayham Place Camden, London	
drawing title	scale date
Proposed Sub Basement Plan	1:100 (A1) 13.04.17
drawing number	drawn checked
AHA/KKG/GA/098	FR/PC DA
	revision
	F

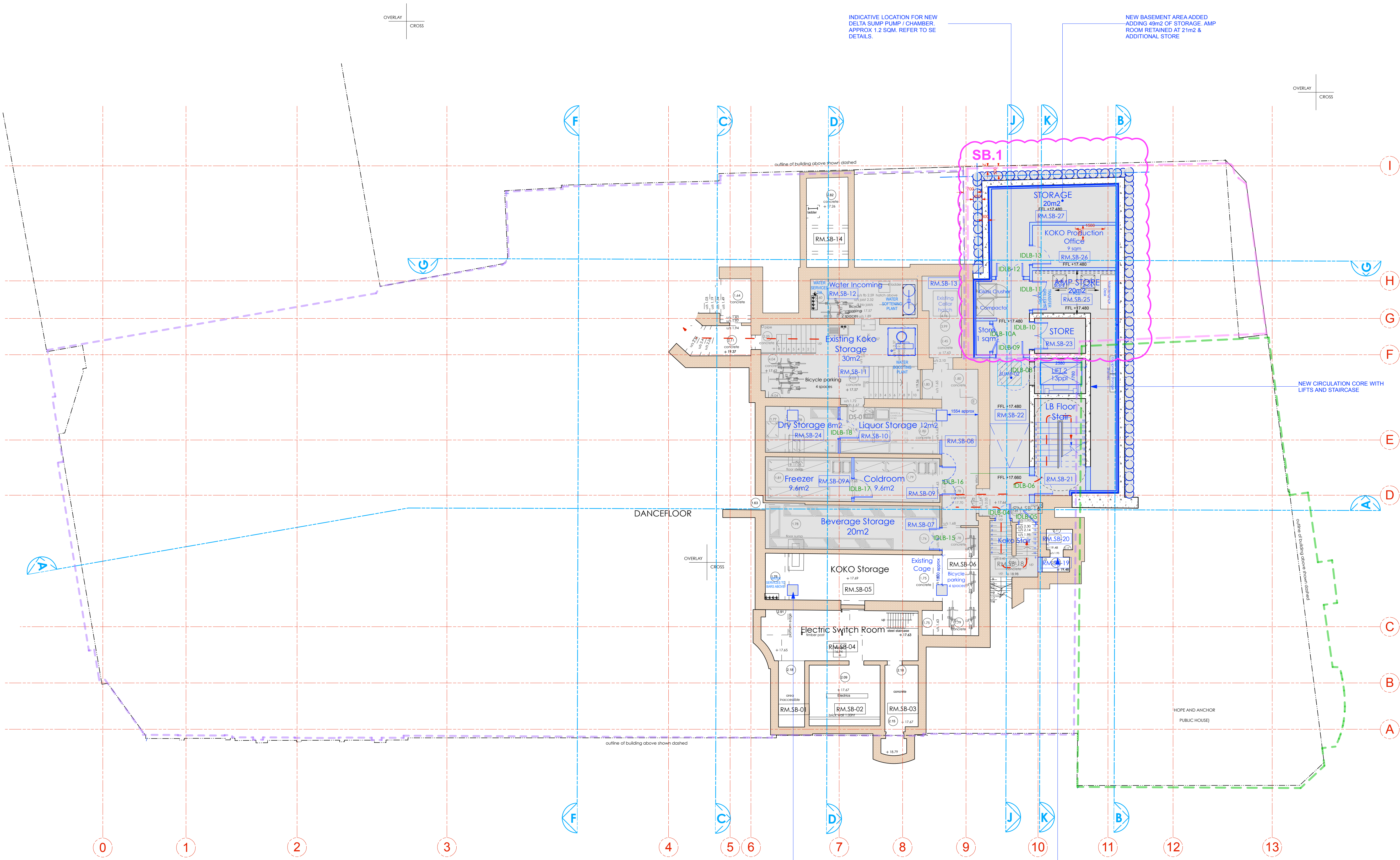

INDICATIVE LOCATION FOR NEW DELTA SUMP PUMP / CHAMBER APPROX 1.2 SQM. REFER TO SE DETAILS.

NEW BASEMENT AREA ADDED ADDING 49m2 OF STORAGE. AMP ROOM RETAINED AT 21m2 & ADDITIONAL STORE

DANCEFLOOR

NEW CIRCULATION CORE WITH LIFTS AND STAIRCASE

PROPOSED 4NO BRICK PIERS PROVIDING STRUCTURAL SUPPORT FOR NEW 4 POST TRUSS AT STAGE LEVEL. REFER TO STRUCTURAL ENGINEER'S FOR FOOTING DETAILS.

THIS SPACE WILL NO LONGER BE USABLE DUE TO REDUCED HEAD HEIGHTS

OVERLAY CROSS

OVERLAY CROSS

OVERLAY CROSS

OVERLAY CROSS

outline of building above shown dashed

outline of building above shown dashed