

REVISION LEGEND
(AUGUST 2018)

CHANGES TO SCHEME FOR DENOTED FOR PLANNING

Copyright: All rights reserved. This drawing must not be reproduced without permission.

Only the original drawing should be relied upon. Contractors, subcontractors and suppliers must verify all dimensions on site before commencing any work or making any shop drawings.

All shop drawings to be submitted to the architect for comment prior to fabrication.

This drawing is to be read in conjunction with the Architect's specification, bills of quantities / schedules, structural, mechanical & electrical drawings and all discrepancies are to be reported to the architect.

Do not scale from this drawing. Dimensions are in millimetres unless otherwise stated.

revision / date / amendments	amendments
- / 26/01/18 /	- First Issue
A / 02/02/18 /	- Addition of acoustic wall near bar in Jazz bar
B / 01/03/18 /	1. Indicative location of AHU + attenuator over stage. 2. Window numbers updated in line with window schedule.
C / 23/03/18 /	1. Tender Addendum (1). Indication of 4 post truss fixed at stage level for integrated automatic retractable acoustic baffles and integrated lighting rig. 2. Tender Addendum (2). New AHU + Attenuator over stage to be hung to existing relocated secondary beams in Flytower.
D / 12/04/18 /	- Window and door numbers updated
E / 01/06/18 /	1. Indication of 4 post truss fixed at stage level for integrated automatic retractable acoustic baffles and integrated lighting rig. 2. New AHU + Attenuator over stage to be hung to existing relocated secondary beams in Flytower.
F / 05/07/18 /	- Updated stage 4 fit out interior and kitchen layouts.
G / 31/07/18 /	2.2. Alteration to ventilation Strategy to allow higher ceiling heights 2.3. Alteration to ventilation Strategy to allow higher ceiling heights 2.4. Alteration to ventilation Strategy
H / 15/08/18 /	2.5. New Sash Windows to facade 2.7. Louver added to elevation for ventilation to WC's Colour coding added to revised drawing Rev G

- LEGEND**
- Proposed Works
 - Existing Building Fabric KOKO née Camden Palace Theatre (1900)
 - Existing Building Fabric Hope & Anchor (approx. 1850)
 - Existing Building Fabric Bayham Place (from 1875)
 - Existing Modern Building Fabric Bayham Place (from 2006)
 - Building Fabric to be demolished
 - Demolition of Flooring / Elevation / Wall
 - Proposed Excavation
 - Remove and retain in alternate location
 - Retain and protect existing
 - Retain, make good, ease and adjusted
 - Means of escape Route
 - Private Members Route
 - Koko Customer Route
 - Public Route
 - Artist Route
 - Proposed Riser
 - Proposed Risers Above
 - RM.2-06 Room Number
 - D2-02 Door Number
 - W2-05 Window Number
 - Hope & Anchor Demise
 - Koko Demise
 - 1 Bayham Street & 65 Bayham Place Demise
 - Blue Roof
 - Original brickwork exposed

15.08.18

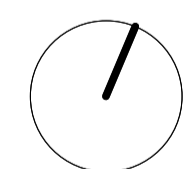

0 1 2 3 4 5 6 7 8m

STAGE 4

Archer Humphries Architects

Basement
Central House
142 Central Street
London, United Kingdom
EC1V 8AR
T: +44 (0) 20 7251 8555

project title		KOKO + Hope & Anchor + Bayham Place Camden, London	
drawing title	scale	date	
Proposed Second Floor Plan	1:100 A1:1	13.04.17	
drawing number	drawn / checked	revision	
AHA/KKG/GA/102	FR/PC DA	H	

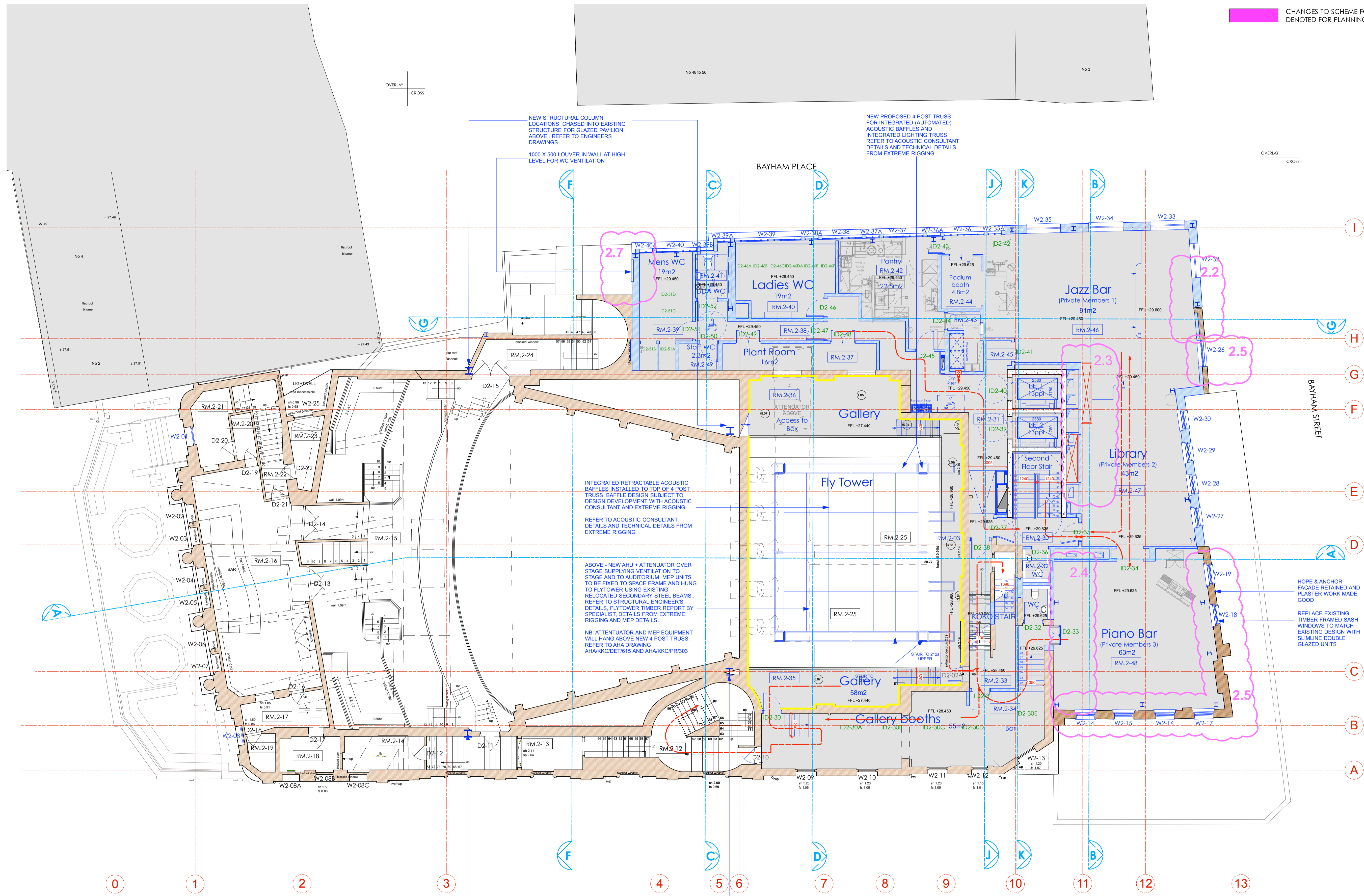

NEW STRUCTURAL COLUMN LOCATIONS CHASED INTO EXISTING STRUCTURE FOR GLAZED PAVILION ABOVE. REFER TO ENGINEERS DRAWINGS

NEW PROPOSED 4 POST TRUSS FOR INTEGRATED (AUTOMATED) ACOUSTIC BAFFLES AND INTEGRATED LIGHTING TRUSS. REFER TO ACOUSTIC CONSULTANT DETAILS AND TECHNICAL DETAILS FROM EXTREME RIGGING

INTEGRATED RETRACTABLE ACOUSTIC BAFFLES INSTALLED TO TOP OF 4 POST TRUSS. BAFFLE DESIGN SUBJECT TO DESIGN DEVELOPMENT WITH ACOUSTIC CONSULTANT AND EXTREME RIGGING. REFER TO ACOUSTIC CONSULTANT DETAILS AND TECHNICAL DETAILS FROM EXTREME RIGGING

ABOVE - NEW AHU + ATTENUATOR OVER STAGE SUPPLYING VENTILATION TO STAGE AND TO AUDITORIUM. MEP UNITS TO BE FIXED TO SPACE FRAME AND HUNG TO FLYTOWER USING EXISTING RELOCATED SECONDARY STEEL BEAMS. REFER TO STRUCTURAL ENGINEER'S DETAILS, FLYTOWER TIMBER REPORT BY SPECIALIST. DETAILS FROM EXTREME RIGGING AND MEP DETAILS.

NB: ATTENUATOR AND MEP EQUIPMENT WILL HANG ABOVE NEW 4 POST TRUSS. REFER TO AHA DRAWING AHA/KKG/DET/1615 AND AHA/KKG/PR/303

NEW STRUCTURAL COLUMN LOCATIONS CHASED INTO EXISTING STRUCTURE FOR GLAZED PAVILION ABOVE. REFER TO ENGINEERS DRAWINGS

NEW PROPOSED 4 POST TRUSS FOR INTEGRATED (AUTOMATED) ACOUSTIC BAFFLES AND INTEGRATED LIGHTING TRUSS. REFER TO ACOUSTIC CONSULTANT DETAILS AND TECHNICAL DETAILS FROM EXTREME RIGGING

HOPE & ANCHOR FACADE RETAINED AND PLASTER WORK MADE GOOD

REPLACE EXISTING TIMBER FRAMED SASH WINDOWS TO MATCH EXISTING DESIGN WITH SLIMLINE DOUBLE GLAZED UNITS

OVERLAY CROSS

OVERLAY CROSS

OVERLAY CROSS

BAYHAM STREET

BAYHAM PLACE

CROWDALE ROAD