

Up and over mechanised wooden door with chestnut finish to match existing tiling. Arched heading to emulate existing Victorian windows.

Black powder coated steel gutter down pipe.

Existing brick wall with rendered finish to be painted light grey to distinguish extension from existing dwelling

Brickwork to be finished with render and painted light grey to distinguish extension from existing dwelling. (To including the existing extension.)

NOTES:

KEY:

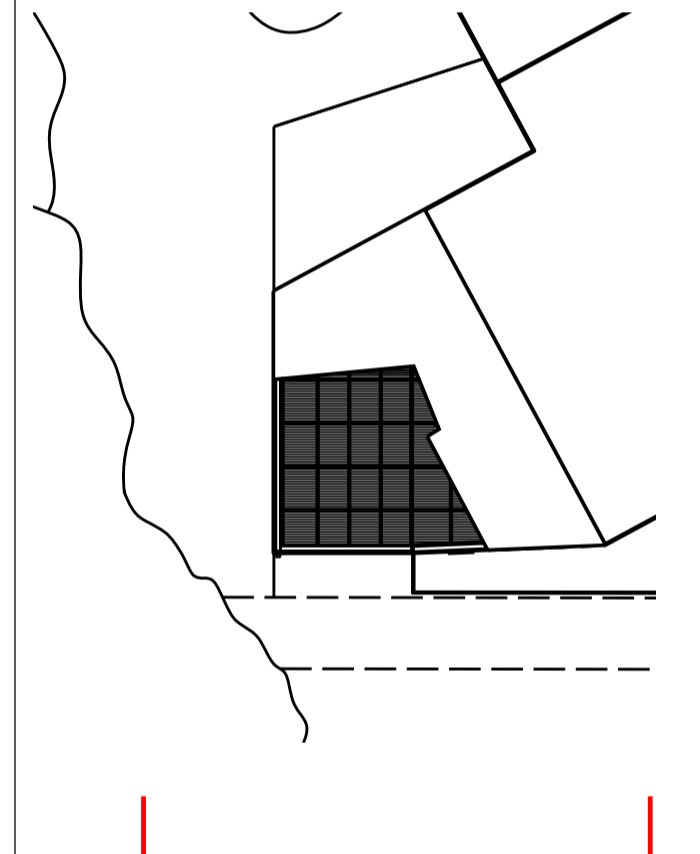

THE

PROJECT TITLE

CARLTON TAVERN GARAGE EXTENSION

DRAWING TITLE

PROPOSED FRONT ELEVATION

INITIAL ISSUE DATE
28/12/2017

SCALE
1:25 @A1
1:50 @A3

STATUS
PLANNING

DRAWN BY
MW

DRAWING NUMBER

CTG_04_P

REVISION

C

