

Stephenson House

Appendix A - Proposed Plan for Background Monitoring

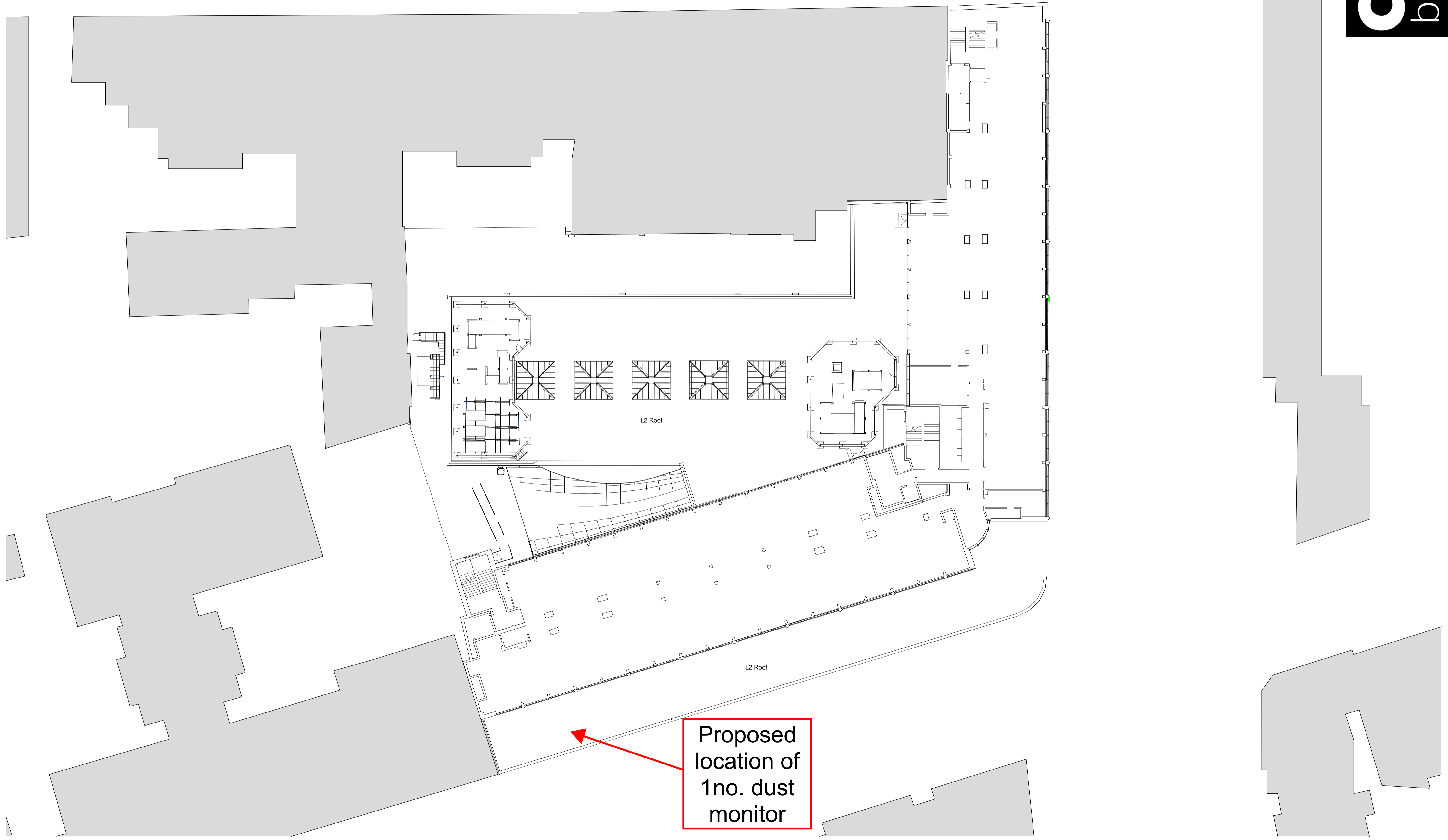
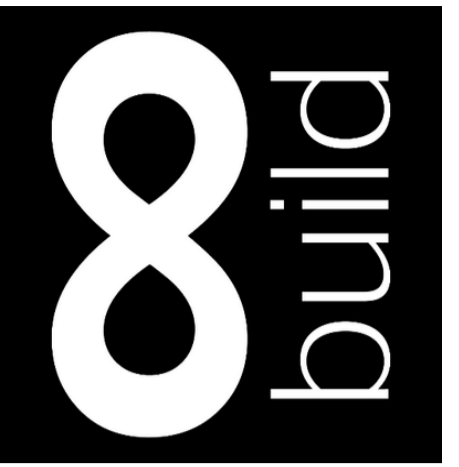

NOTES FOR ALL DRAWINGS:
 This drawing is to be read in conjunction with the contract documents and all other relevant drawings, specifications and schedules, including but not limited to the structural engineer's drawings, specifications and schedules for all structural design, sizes and performance criteria. This drawing shows the design intent only. This is not a fabrication drawing.
 Do not scale from this drawing. All dimensions, including setting out dimensions, and all levels shown are to be checked and verified by the contractor on site and are subject to a site survey. Any discrepancies found in this drawing, or between what is shown on the drawings and conditions found after opening up of the existing works, are to be reported to the Architect immediately, and in accordance with the provisions of the building contract. Any modifications to these drawings necessary to meet the performance criteria of the specification, or due to unforeseen conditions related to the existing structure or fabric, shall be agreed in writing with the Architect and issued for approval in accordance with the provisions of the building contract.
 Marks Barfield Architects has prepared this drawing using information derived from a survey prepared by Lane & Frankham dated 28 March 2017, upon which it is entitled to rely. Marks Barfield Architects accepts no liability for the survey information nor does it warrant that information shown on the drawing related to the existing structure and fabric is either accurate or complete.
 © Marks Barfield Architects 2018

Rev	Date	by	Description	Key

0 5 10 20
Metres

Note: This drawing is extracted from a 3D survey model prepared by Lane & Frankham. For detailed measured survey, refer to 2D survey drawings.

Client
Lazari Properties 2 Limited
 Greater London House
 Hampstead Road
 London NW1 7QX
 United Kingdom
 Tel +44 20 7388 5444
 Fax +44 20 7388 6557

Architect
marks barfield architects
 50 Bromells Road
 London SW4 0BG
 United Kingdom
 Tel +44 20 7501 0180

Stephenson House, 75 Hampstead Road, London, NW1 2PL				
Drawing Title Existing Second Floor General Arrangement Plan				
Job no 601	Scale (@ A1) 1 : 200	Drawing No A-0104	Revision	Status Tender 2
Date 03/24/17	Checked IR			