

KEY

- Existing
- Demolition - elevation
- Demolition - section

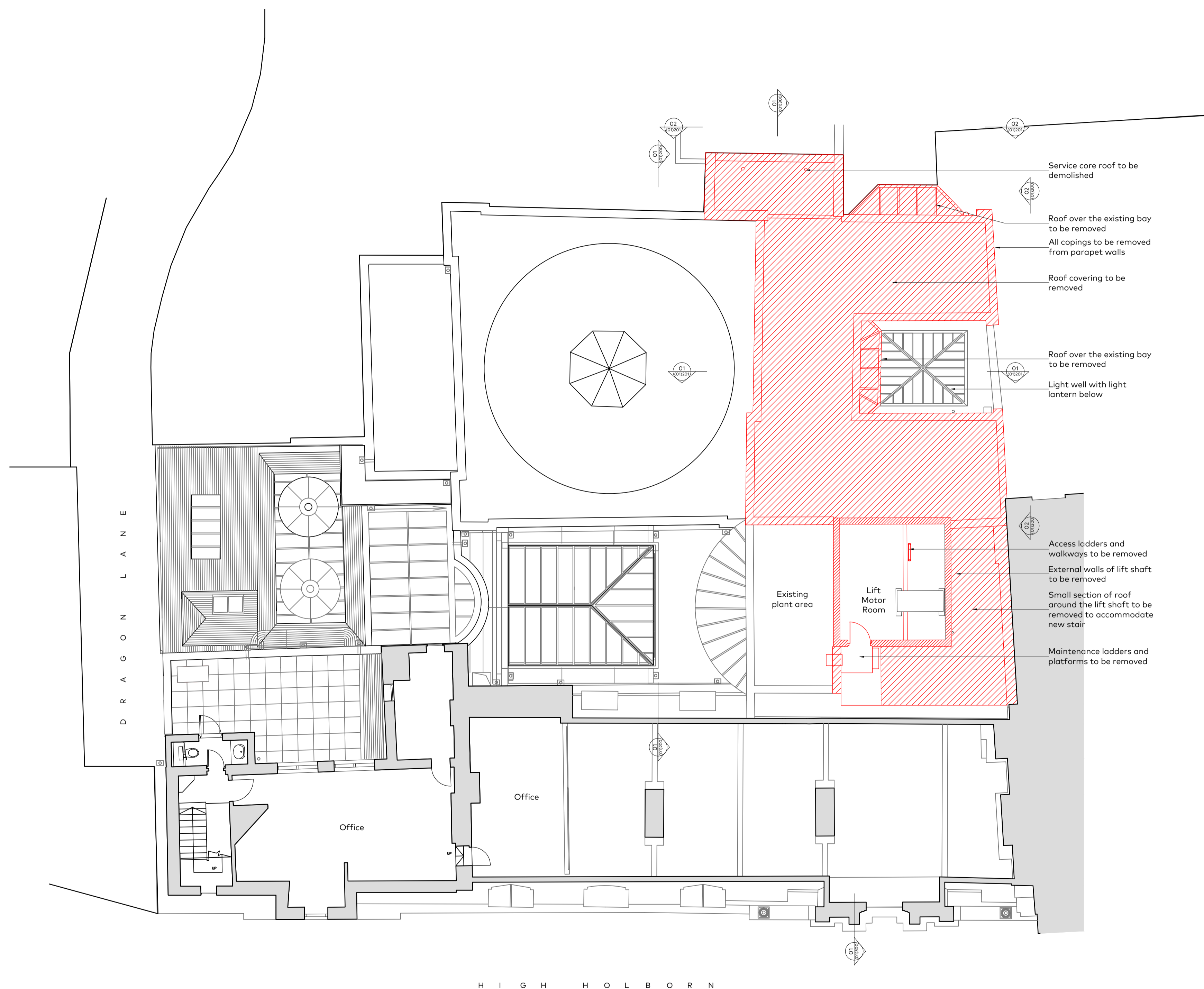

- Service core roof to be demolished
- Roof over the existing bay to be removed
- All copings to be removed from parapet walls
- Roof covering to be removed
- Roof over the existing bay to be removed
- Light well with light lantern below
- Access ladders and walkways to be removed
- External walls of lift shaft to be removed
- Small section of roof around the lift shaft to be removed to accommodate new stair
- Maintenance ladders and platforms to be removed

Rev	Issue Date	Revision Notes	Drawn
C	2018.06.27	Issued for Planning	YD
B	2018.06.07	Issued for Planning	YD
A	2017.07.11	Issued for Are-application Advice	YD
-	2017.05.26	Issued for Are-application Advice	YD

General Notes

Do not scale. All written dimensions must be checked on site before work commences on site or in shop. Figured dimensions take preference over those scaled. Discrepancies, where identified, must be reported to the Architect immediately. Any areas indicated on this drawing are for guidance purposes only. No responsibility is taken for their accuracy. All work must be carried out in accordance with the Building Regulations and to the satisfaction of the Local Authority.

Drawing Status

PLANNING

Job Number	Drawing Number	Rev	Scale
815	(01)107	C	1:100@A1 1:200@A3

Drawing Title Fifth Floor Plan As Existing with Demolitions

Project Holborn Hall

Client Mactaggart Inv Co Ltd

Date 19.05.2017 drawn YD checked



Architects and designers

Garnett & Partners LLP
Studio 303, The Print Rooms
164-180 Union Street
London SE1 0LH

+44 20 7404 7677
www.garnettpartners.com

SCALE 0 1 2 3 4 5 6 7 8 9 10 M

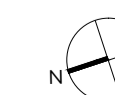

01

FIFTH FLOOR PLAN
As Existing with Demolitions