

500_404
02 Elevation A
1:20

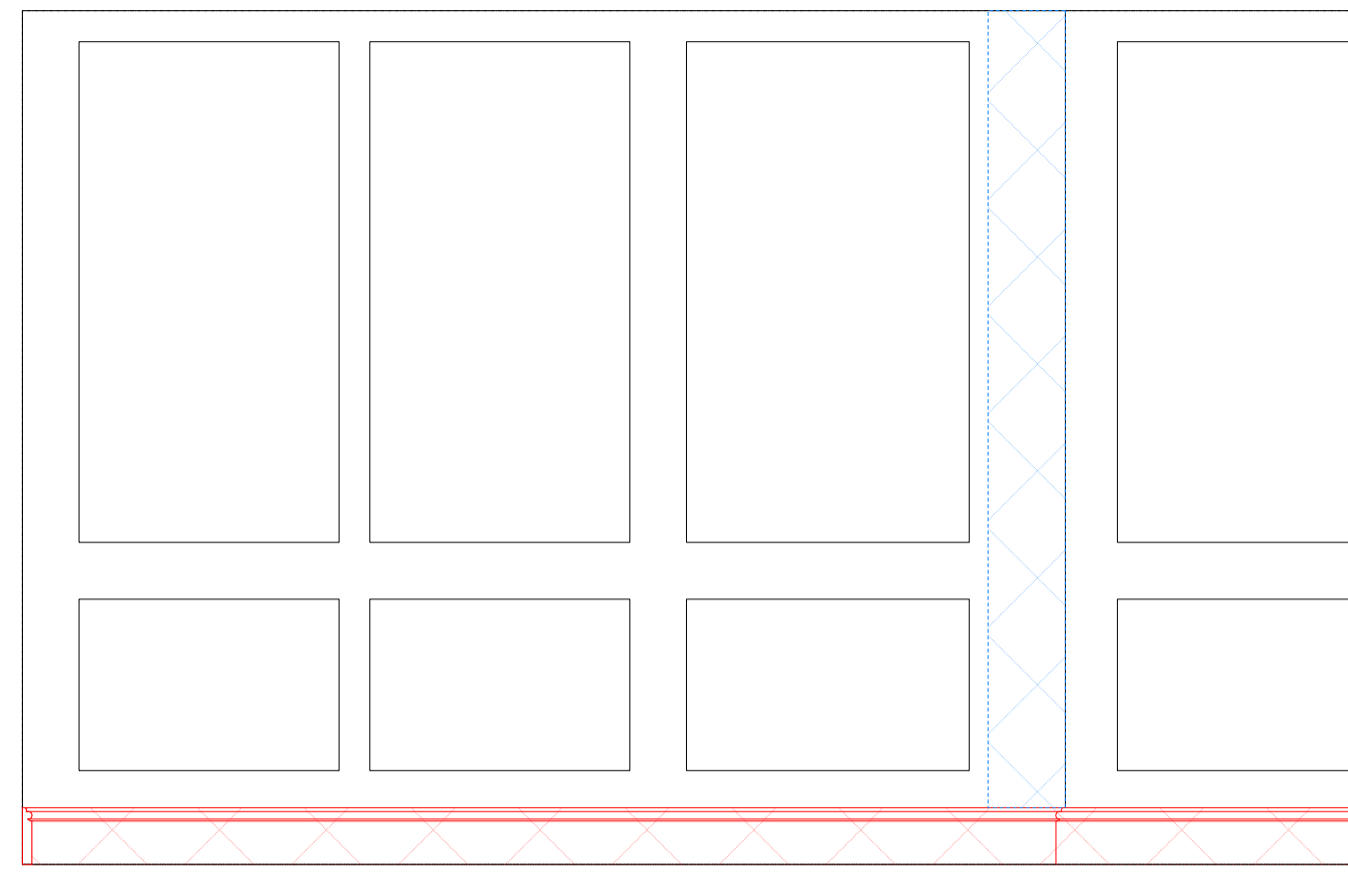

500_404
03 Elevation B
1:20

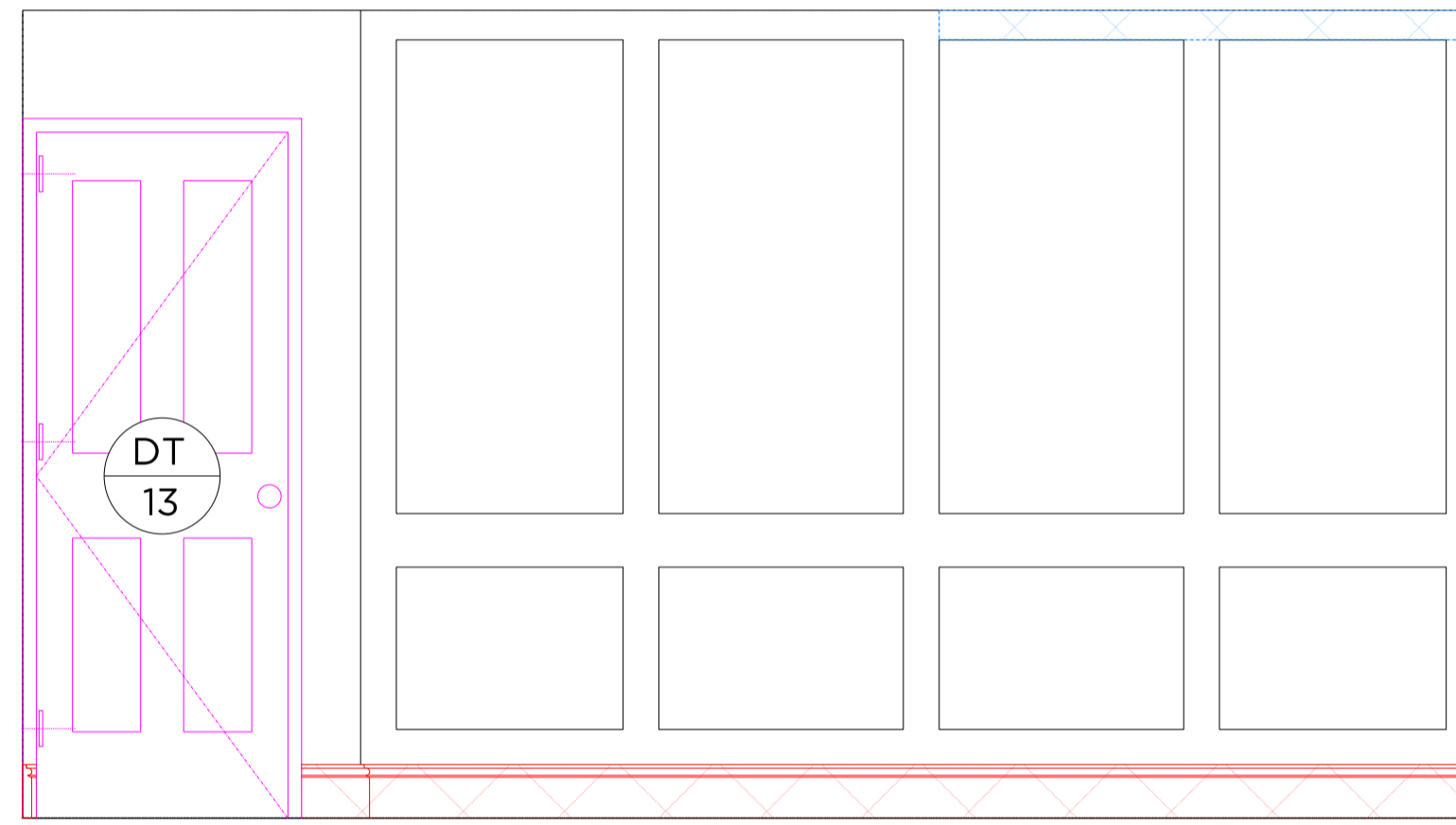

500_404
04 Elevation C
1:20

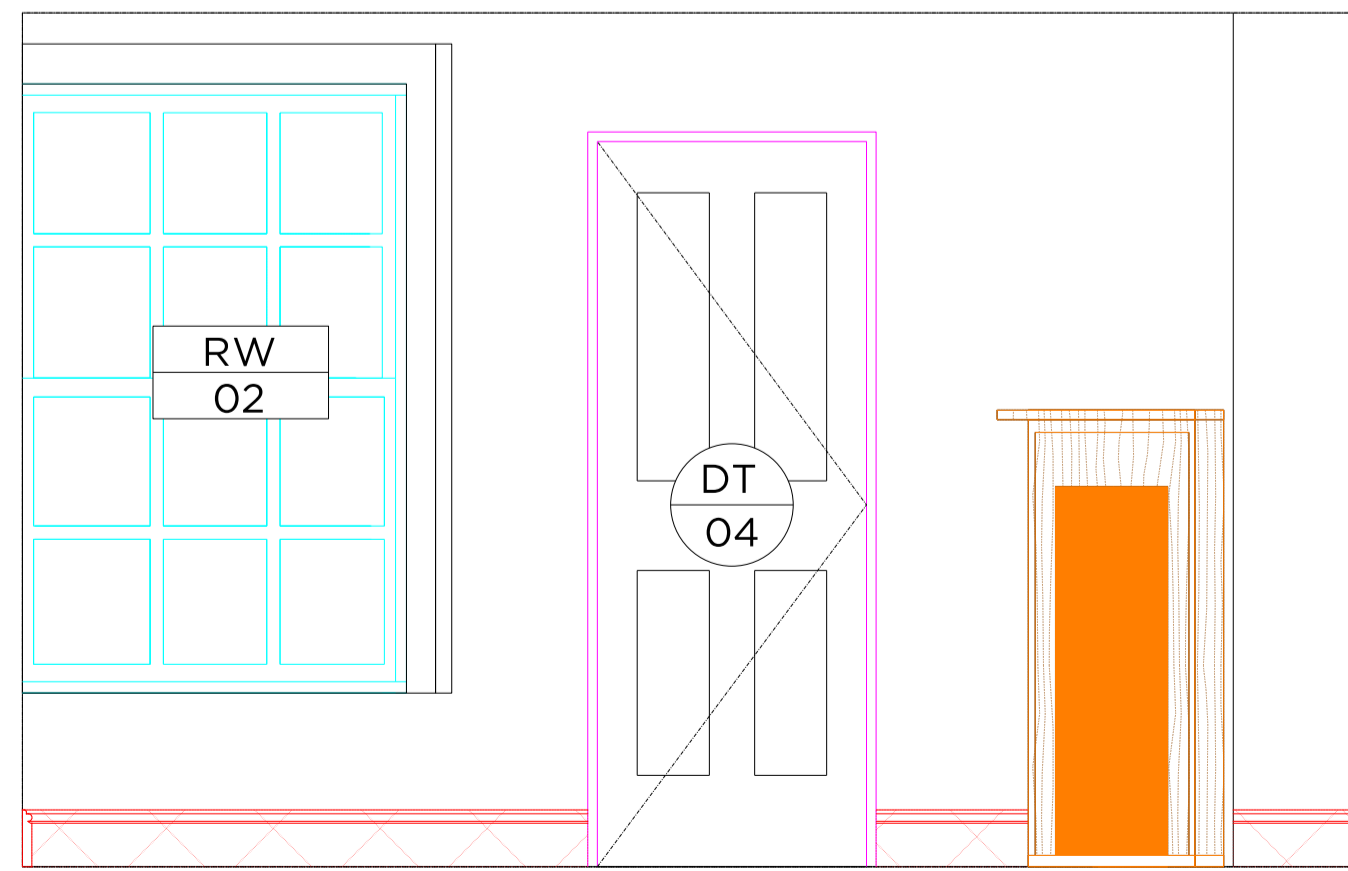

500_404
05 Elevation D
1:20

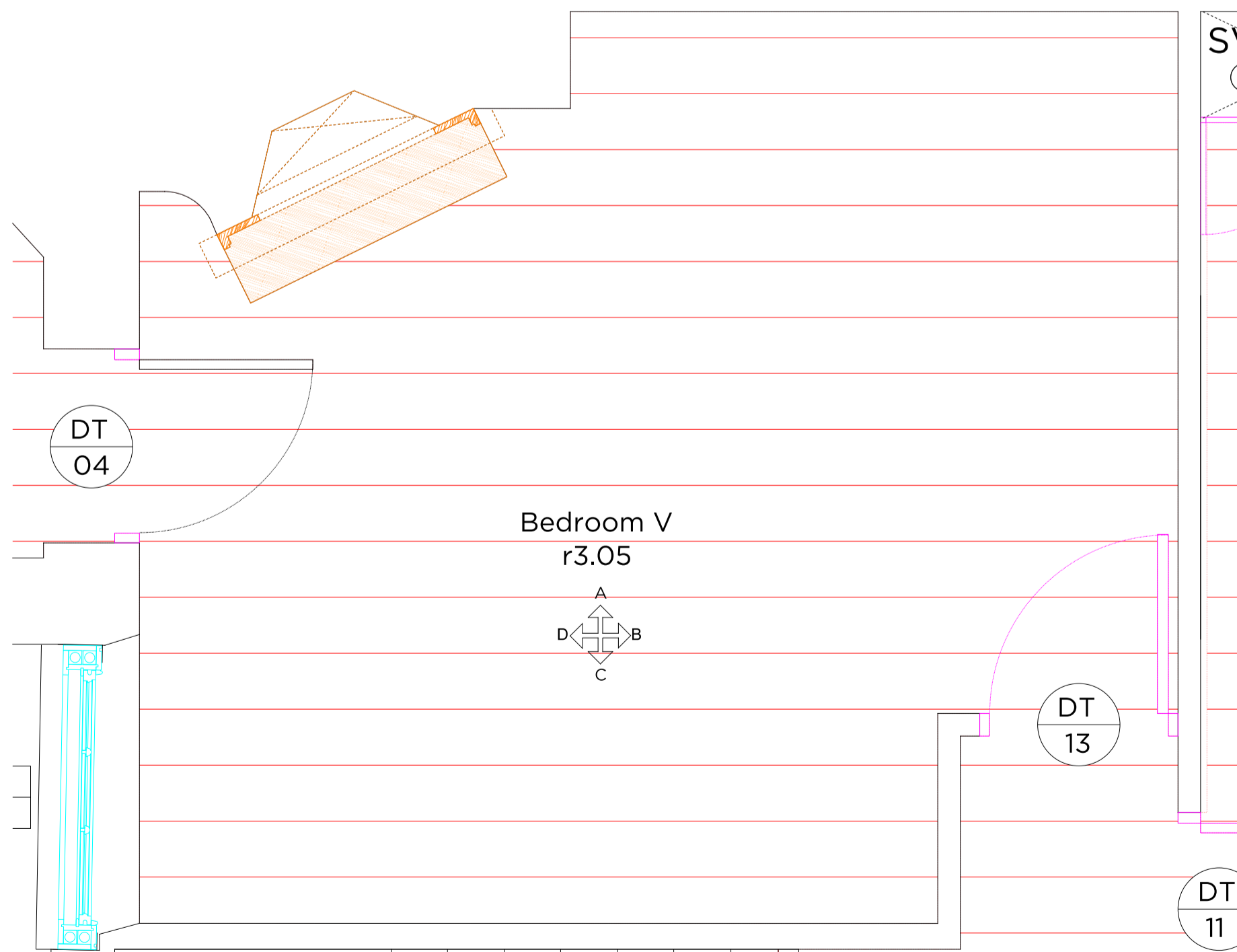

500_404
01 Bedroom V Plan
1:20

Key Plan: Third Floor

Proposed Key:

Proposed Internal Wall Finish	Metal
Proposed Door	Timber
Proposed Window	Stone
Proposed Fireplace	York Stone paving slabs (600mm x 900mm)
Proposed New Panelling to Match Existing	Existing timber floor board finish
Proposed New Skirting to Match Existing	Salvages floor boards to match existing
Proposed New Cornice to Match Existing	Carpet stair runner
Slate	Tile

SKIRTING TYPE K
REFER TO 700_101.11

Rev A 09.08.18 Revised as per Planner's comments

PLANNING

Project No. 17103

Client GFZ Investments Ltd.

Date January 2018

Scale 1:40 @ A3 / 1:20 @ A1

Project 34 Great James Street

Drawing Title: r3.05 Bedroom V Elevations

Drawing No. 500_404 Rev. A

Drawn RH	Approved MW	Signed
----------	-------------	--------

Marek Wojciechowski Architects Ltd.

66 - 68 Margaret Street W1W 8SR T. 020 7580 9336 www.mw-a.co.uk

Copyright Marek Wojciechowski Architects. No implied license exists. This drawing should not be used to calculate areas for the purposes of valuation. All dimensions to be checked on site by the contractor and such dimensions to be their responsibility. Do not scale drawings. All work must comply with relevant British Standards and Building Regulations requirements. Drawing errors and omissions to be reported to the architect.