

Second floor
118a London Wall
London EC2Y 5JA
rp@prewettbizley.com
020 7359 2692

prewett
bizley
architects

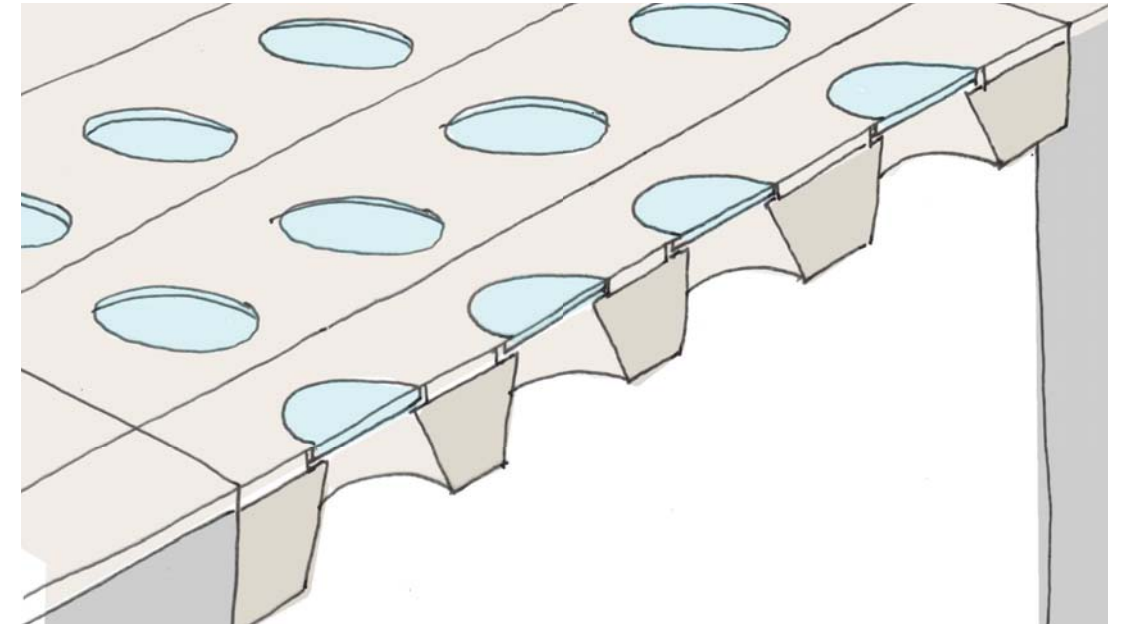

42 Doughty Street London WC1N 2LF
Application for a Variation of Condition

Contents

Introduction	2
Indicative sketches	3
Revised plan	4

Introduction

This document is submitted as part of an application to vary:

- condition 3 of planning permission 2017/6024/P
- condition 2 of listed building consent 2017/6034/L

The application seeks to vary the proposed ground and basement floor layout in a small area of the proposed rear extension that is directly to the rear of the existing building.

The approved layout, as illustrated in plan 145 P 00 rev B, includes a winding staircase and an adjacent glass/timber floor letting light into the basement. The proposed winding stair was designed to be situated partially over an existing vault (RBV-3). Further information on these items is contained on page 32 of 145 DOC B03: Heritage Statement and Impact Assessment.

Following recent opening up on site, it appears the proposed stair may impinge on the roof of the vault more than anticipated. It is therefore proposed that the stair be omitted to preserve the existing vault. Access to the basement will be maintained via the existing stair in the main house.

The adjacent glass/timber floor is retained, although adjusted to reflect the dimensions of the existing void.

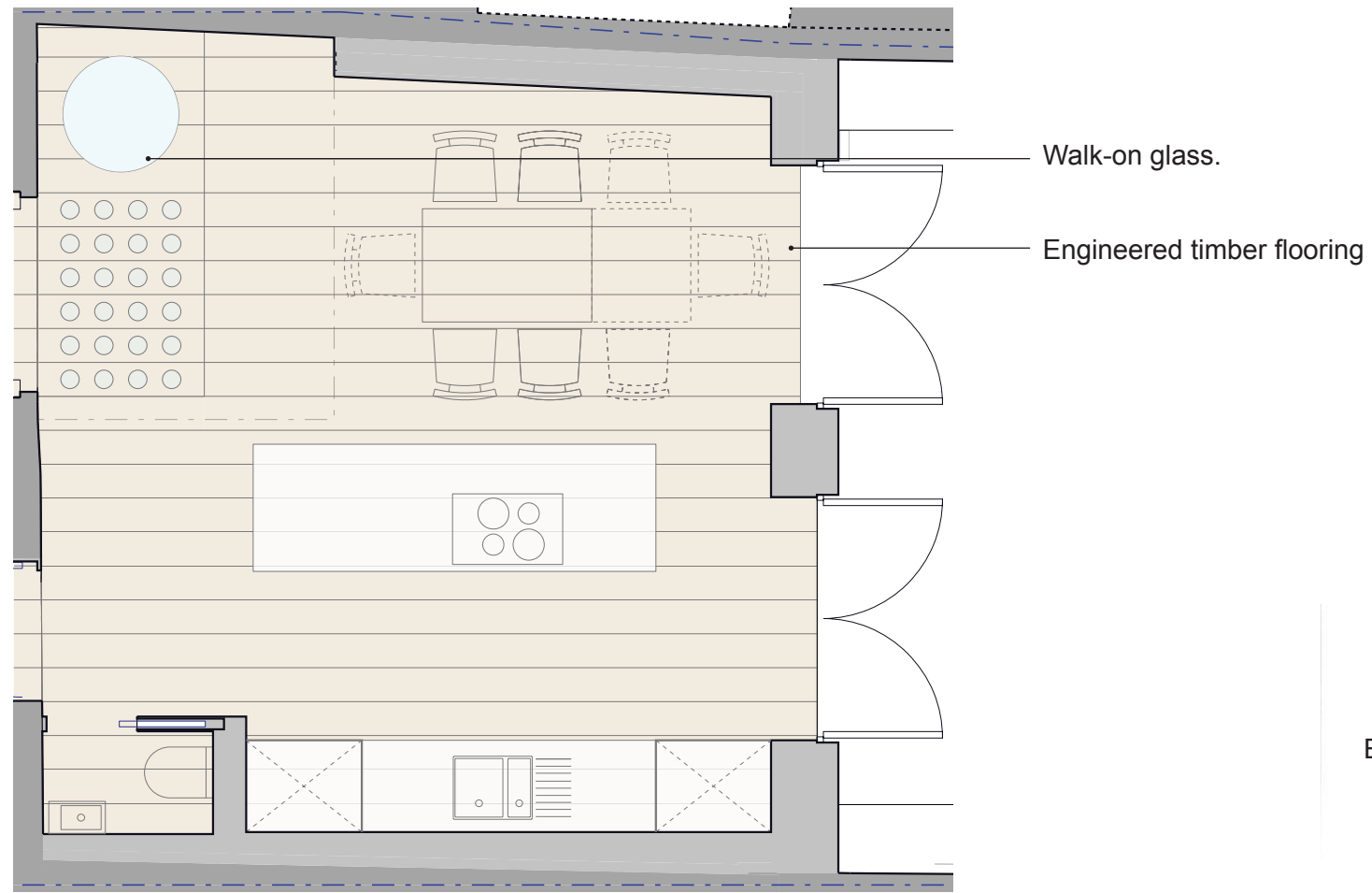

Proposed Plan.

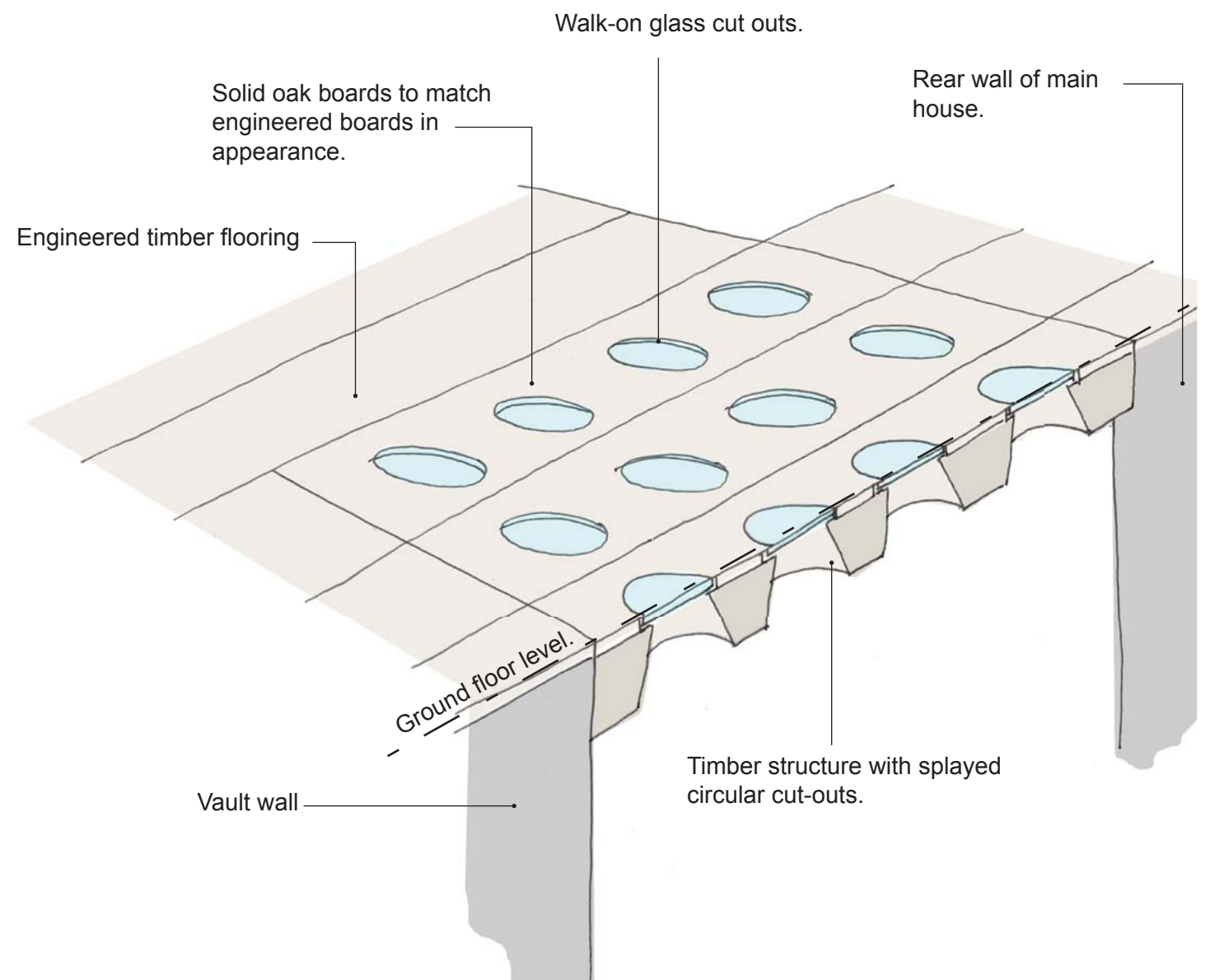

Indicative section of proposed glass/timber floor.

