

ARBORICULTURAL METHOD STATEMENT

BRITISH STANDARD 5837(2012)
 This method statement is in accordance with British Standard 5837: Trees in relation to design, demolition and construction - Recommendations (2012) which provides a methodology for the assessment and protection of trees and other significant vegetation on development sites.

TREE SURGERY WORKS
 Only tree works specified within this document may be carried out. Any uncertainty regarding trees to be pruned will be immediately confirmed with the arboricultural consultant and local authority tree officer.
 All tree works will be carried out in accordance with the recommendations given in the current BS 3998 (2010).
 All tree works should be carried out in accordance with the Wildlife and Countryside Act 1981 (as amended) and the Habitat Regulations 2010.

SITE SUPERVISION
 All key / critical activities that will affect trees during construction will be inspected and monitored by the approved arboricultural consultant and reports issued to the client and local authority.
 Supervision visits will occur as follows:
 • Inspection of tree works, tree protection prior to demolition and construction works
 • Monthly visits to inspect tree protection measures
 • During works that may affect retained trees



PROTECTIVE FENCING
 No materials or equipment other than those required to erect protective fencing, will be delivered to the site before the fencing is installed. The position of protective fencing for demolition is shown on this drawing.
 Protective fencing will be constructed of robust barriers fit for the purpose of excluding demolition and construction traffic. Signs will be fixed to every third panel stating 'Tree Protection Area Keep Out - Any incursion into the protected area must be with the agreement of the local authority or arboricultural consultant'.
 The main contractor will inform the local authority officer and the arboricultural consultant that tree protection is in place before demolition or site clearance works commence.
 No alteration, removal or repositioning of the tree protection for demolition will take place during the demolition phase without the prior consent of the arboricultural consultant.

SERVICES AND DRAINAGE
 Methods of working for installation of the drainage runs or services will follow the guidance within Table 3 of BS 5837 (2012), or National Joint Utilities Group (NJUG) Guidelines for the planning, installation and maintenance of utility apparatus in proximity to trees, Volume 4, issue 2, London NJUG 2007.
 No works will occur within the tree protection zone without prior agreement from the arboricultural consultant. No machinery will be permitted within the TPZ at any time.

GENERAL PROTECTION METHODS
 No fires will be permitted within 20m of the crown of any tree.
 No changes in soil levels will take place within the tree protection zones without prior written consent of the local authority.
 No materials, vehicles, plant or personnel will be permitted into the tree protection zones at any time without the prior consent of the arboricultural consultant.
 Any liquid materials spilled on site will be immediately cleared up and removed from the site. If liquid fuel or cement products are spilled within 2m of the tree protection zone, the contractor will report the incident to the arboricultural consultant immediately.
 The contractor will report any damage to trees or shrubs, whether caused by construction activities or from any other cause, to the arboricultural consultant immediately.

NO-DIG CONSTRUCTION AREAS
 Areas requiring no-dig methods of construction are indicated on this drawing. No-dig will involve either excavating existing hard surfacing down to sub base and building up, or laying materials to create new hard surfacing onto existing ground levels. No scraping or reducing of existing soft ground levels in the areas indicated on this plan will be undertaken, and all construction in these areas will avoid the use of machinery.
 The specification for no-dig construction is shown below.

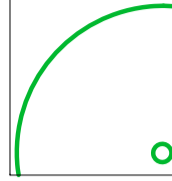
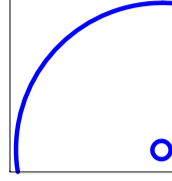
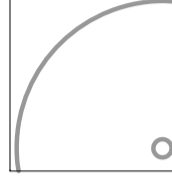
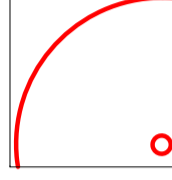
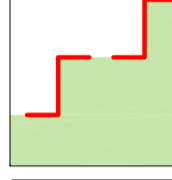
The original of this drawing was produced in colour - a monochrome copy should not be relied upon.

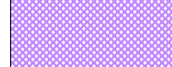
- BS 5837:2012 TREE RETENTION CATEGORIES**
-  **Category A**
Trees of high quality with an estimated remaining life expectancy of at least 40 years.
 -  **Category B**
Trees of moderate quality with an estimated remaining life expectancy of at least 20 years.
 -  **Category C**
Trees of low quality with an estimated remaining life expectancy of at least 10 years or young trees with a stem diameter below 150mm.
 -  **Category U**
Those in such a condition that the tree cannot realistically be retained as living trees in the context of the current land use for longer than 10 years.
 -  Position of protective fencing and tree protection zones.
 -  Application boundary
 -  Area requiring methods of No-Dig Construction

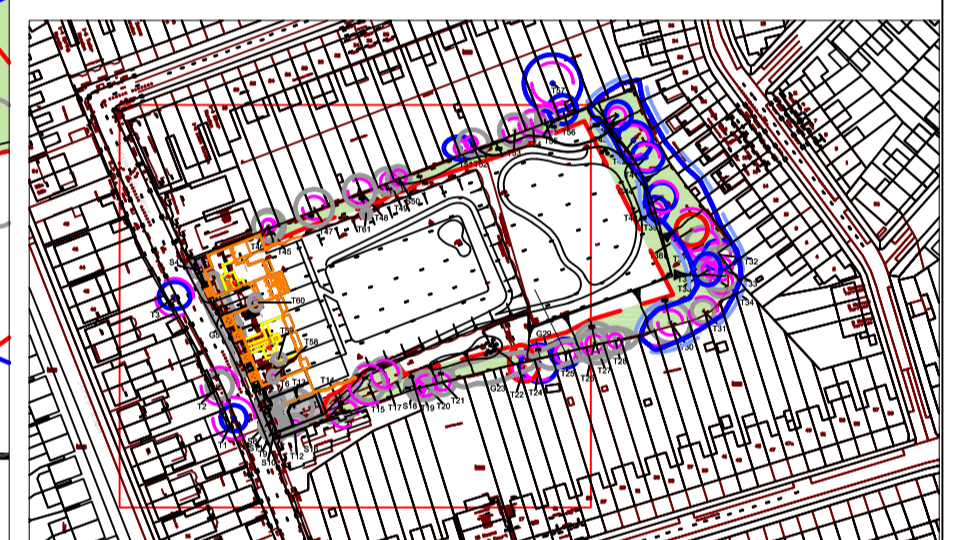
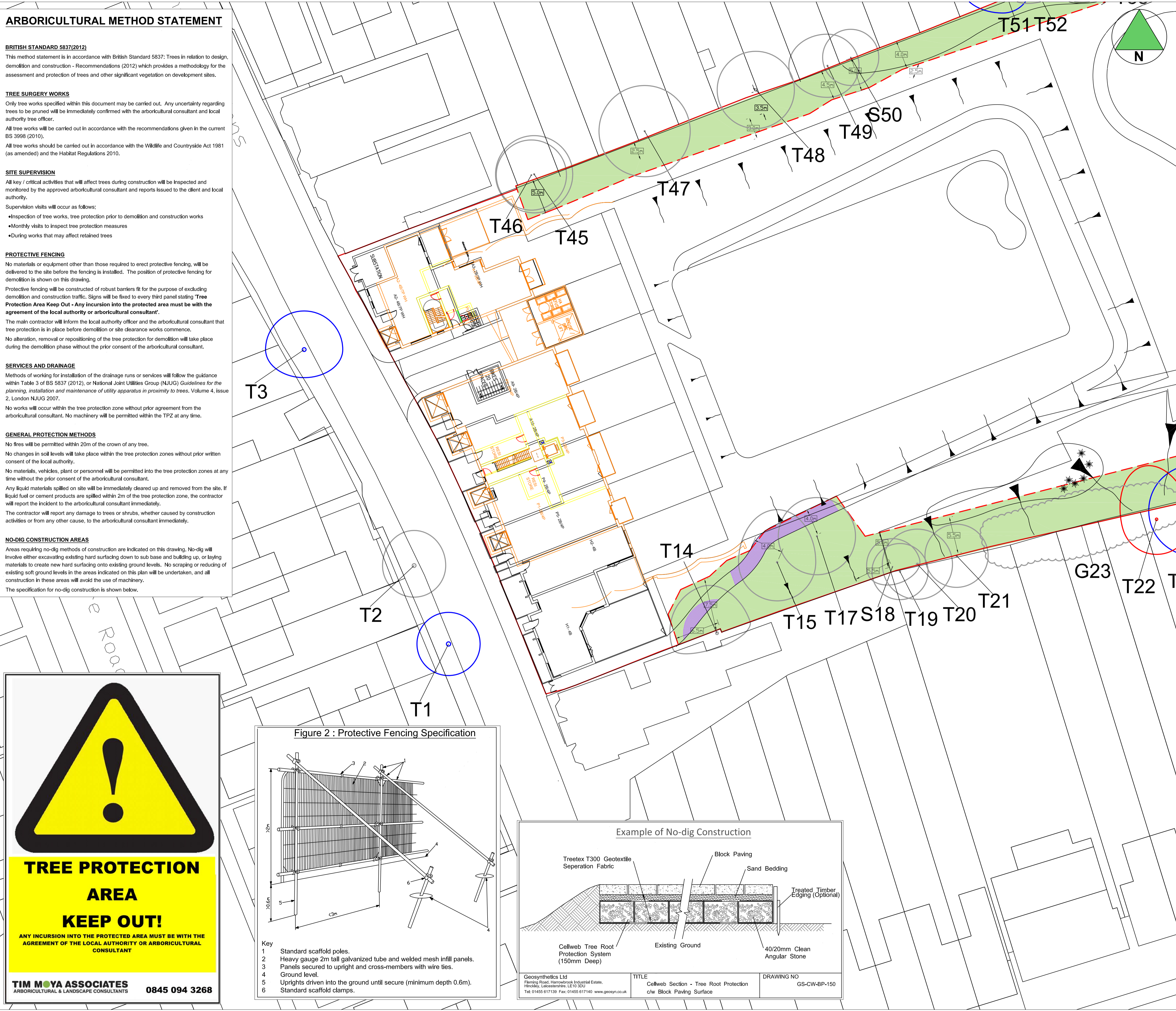

REV	DATE	DESCRIPTION	DRAWN
b	24.07.18	T20 P-1 & T20 P00	HR
a	24.05.17	525-P-XX-100	HR
-	10.05.17	170502_Gondar_Garden_Iteration_03_GA - Level 00 & 70502_Gondar_Garden_Iteration_03_GA - Level -01	HR
Base Drawing			
b	24.07.18	T20 P-1 & T20 P00	

Title
Tree Protection Plan

Client
Lifecare Residence

Project
Gondar Gardens, London NW6 1QG

Date
May 2017

Drawn by
HR

Checked by
-

Drawing No
170205-P-12-01

Rev
b

Scale
1@250@A1

DO NOT SCALE Use only figured dimensions

tma
TIM MOYA ASSOCIATES

The Barn, FeltmoresPark, Chalk Lane, Harlow, Essex CM17 0PF
 0845 094 3268 | info@tma-consultants.co.uk
 www.timmoayaassociates.co.uk

arboriculture ecology landscape innovation

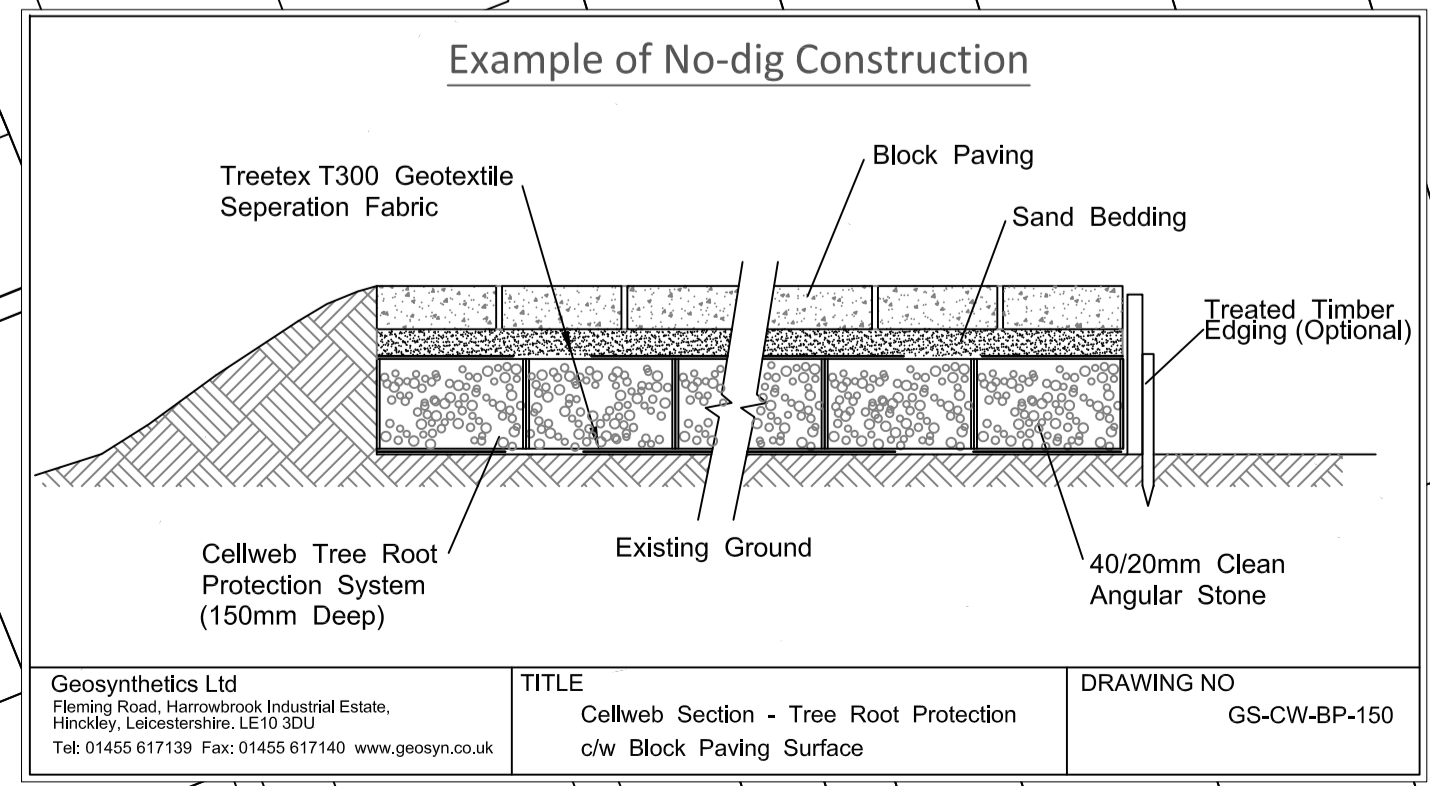
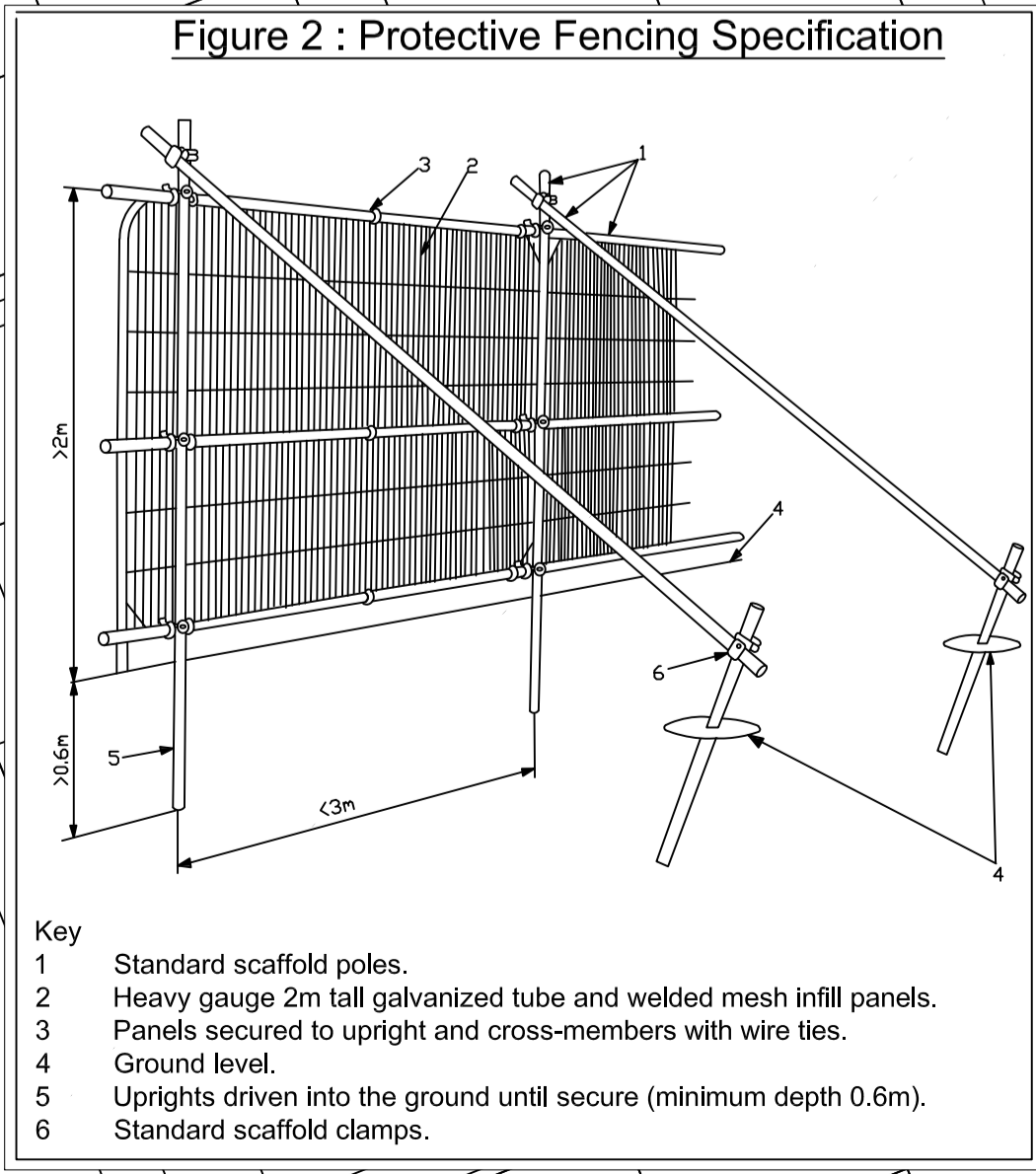

ARBORICULTURAL METHOD STATEMENT

BRITISH STANDARD 5837(2012)
 This method statement is in accordance with British Standard 5837: Trees in relation to design, demolition and construction - Recommendations (2012) which provides a methodology for the assessment and protection of trees and other significant vegetation on development sites.

TREE SURGERY WORKS
 Only tree works specified within this document may be carried out. Any uncertainty regarding trees to be pruned will be immediately confirmed with the arboricultural consultant and local authority tree officer.
 All tree works will be carried out in accordance with the recommendations given in the current BS 3998 (2010).
 All tree works should be carried out in accordance with the Wildlife and Countryside Act 1981 (as amended) and the Habitat Regulations 2010.

SITE SUPERVISION
 All key / critical activities that will affect trees during construction will be inspected and monitored by the approved arboricultural consultant and reports issued to the client and local authority.
 Supervision visits will occur as follows:
 • Inspection of tree works, tree protection prior to demolition and construction works
 • Monthly visits to inspect tree protection measures
 • During works that may affect retained trees

PROTECTIVE FENCING
 No materials or equipment other than those required to erect protective fencing, will be delivered to the site before the fencing is installed. The position of protective fencing for demolition is shown on this drawing.
 Protective fencing will be constructed of robust barriers fit for the purpose of excluding demolition and construction traffic. Signs will be fixed to every third panel stating 'Tree Protection Area Keep Out - Any Incursion into the protected area must be with the agreement of the local authority or arboricultural consultant'.
 The main contractor will inform the local authority officer and the arboricultural consultant that tree protection is in place before demolition or site clearance works commence.
 No alteration, removal or repositioning of the tree protection for demolition will take place during the demolition phase without the prior consent of the arboricultural consultant.

SERVICES AND DRAINAGE
 Methods of working for installation of the drainage runs or services will follow the guidance within Table 3 of BS 5837 (2012), or National Joint Utilities Group (NJUG) Guidelines for the planning, installation and maintenance of utility apparatus in proximity to trees, Volume 4, Issue 2, London NJUG 2007.
 No works will occur within the tree protection zone without prior agreement from the arboricultural consultant. No machinery will be permitted within the TPZ at any time.

GENERAL PROTECTION METHODS
 No fires will be permitted within 20m of the crown of any tree.
 No changes in soil levels will take place within the tree protection zones without prior written consent of the local authority.
 No materials, vehicles, plant or personnel will be permitted into the tree protection zones at any time without the prior consent of the arboricultural consultant.
 Any liquid materials spilled on site will be immediately cleared up and removed from the site. If liquid fuel or cement products are spilled within 2m of the tree protection zone, the contractor will report the incident to the arboricultural consultant immediately.
 The contractor will report any damage to trees or shrubs, whether caused by construction activities or from any other cause, to the arboricultural consultant immediately.



TREE PROTECTION AREA KEEP OUT!
 ANY INCURSION INTO THE PROTECTED AREA MUST BE WITH THE AGREEMENT OF THE LOCAL AUTHORITY OR ARBORICULTURAL CONSULTANT

TIM MOYA ASSOCIATES
 ARBORICULTURAL & LANDSCAPE CONSULTANTS 0845 094 3268

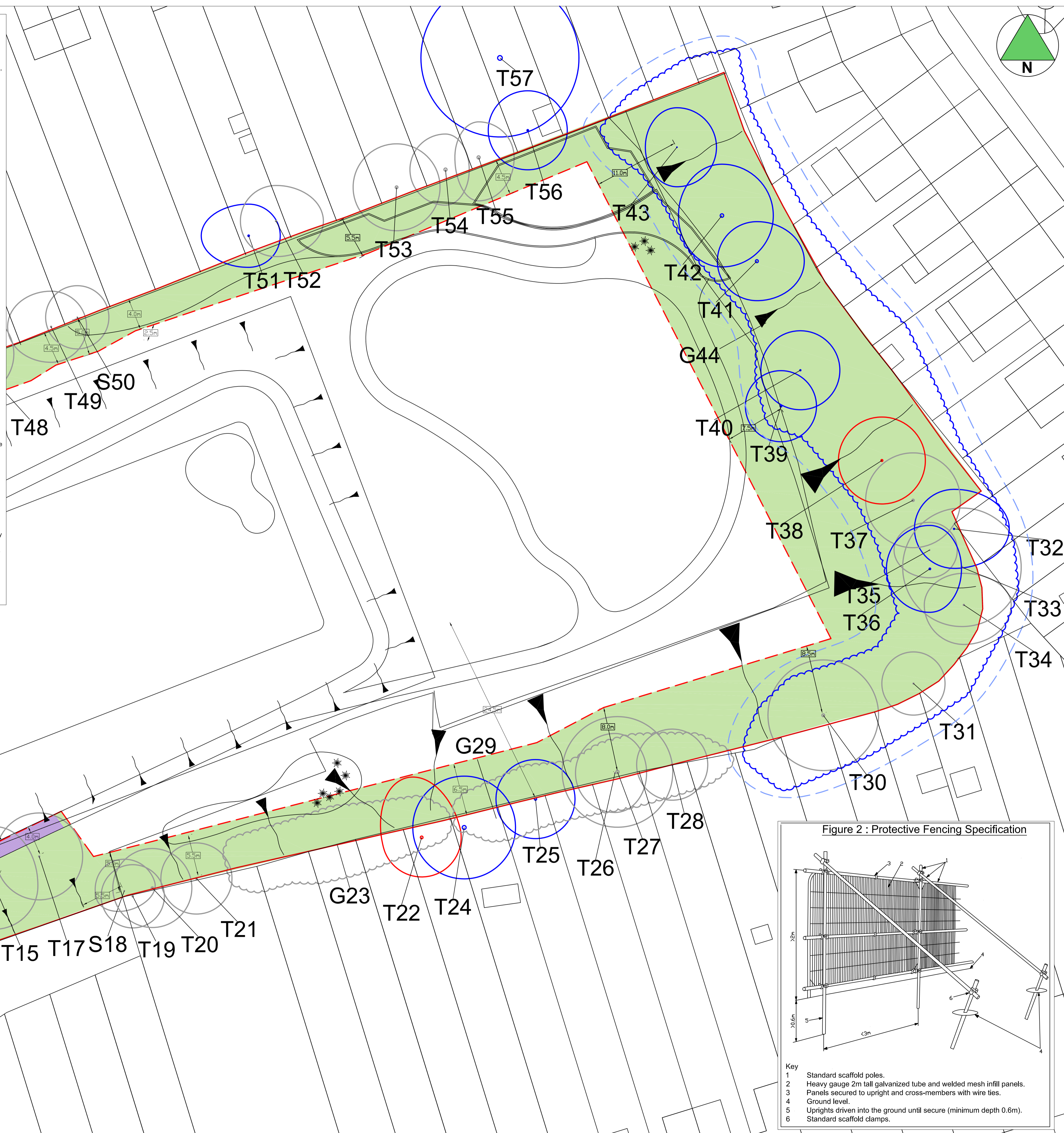

INVESTORS IN PEOPLE Gold

The original of this drawing was produced in colour - a monochrome copy should not be relied upon.

BS 5837:2012 TREE RETENTION CATEGORIES

- Category A**
Trees of high quality with an estimated remaining life expectancy of at least 40 years.
- Category B**
Trees of moderate quality with an estimated remaining life expectancy of at least 20 years.
- Category C**
Trees of low quality with an estimated remaining life expectancy of at least 10 years or young trees with a stem diameter below 150mm.
- Category U**
Those in such a condition that the tree cannot realistically be retained as living trees in the context of the current land use for longer than 10 years.

Position of protective fencing and tree protection zones.

Application boundary

Trees under Camden TPO C378 2003
Group of trees of various species

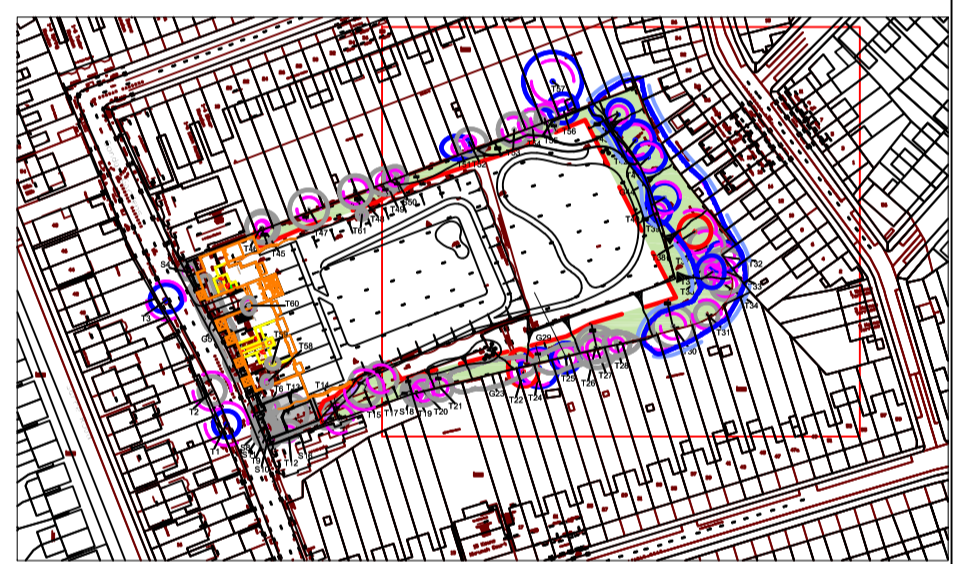

REV DATE	DESCRIPTION	DRAWN
24.07.18	T20 P-1 & T20 P00	HR
24.05.17	525-P-XX-100	HR
10.05.17	170502_Gondar_Garden_Iteration_03_GA - Level 00 & 70502_Gondar_Garden_Iteration_03_GA - Level -01	HR

Base Drawing

0 5m 10m 20m 30m 40m 50m

Title
Tree Protection Plan

Client
Lifecare Residence

Project
Gondar Gardens, London NW6 1QG

Date May 2017	Drawn by HR	Checked by -
Drawing No 170205-P-12-02	Rev b	Scale 1:250@A1

DO NOT SCALE Use only figured dimensions

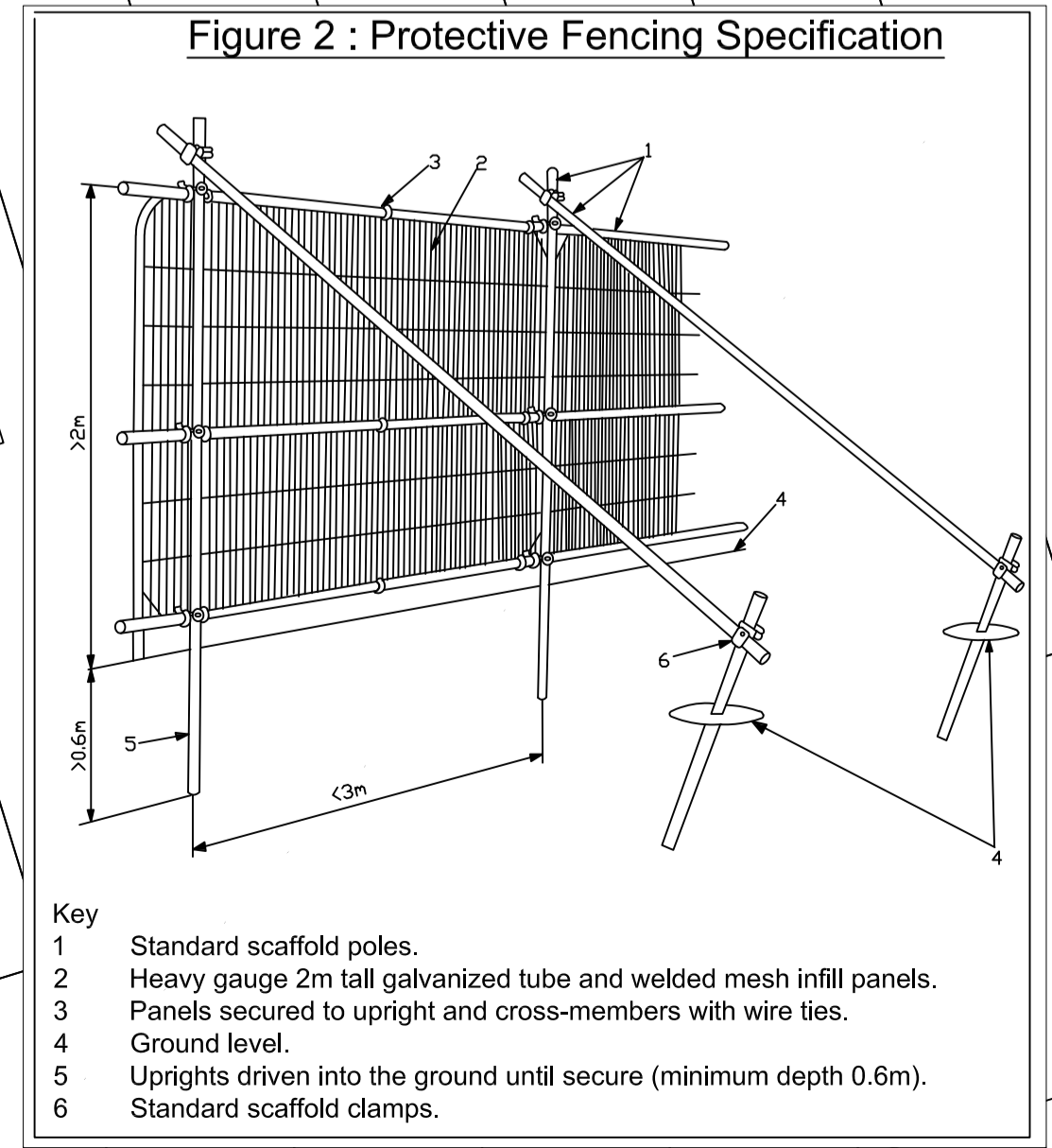

tma
 TIM MOYA ASSOCIATES

The Barn, Felthames Park, Chalk Lane, Harlow, Essex CM17 0PF
 0845 094 3268 | info@tma-consultants.co.uk
 www.timmoayaassociates.co.uk

arboriculture ecology landscape innovation