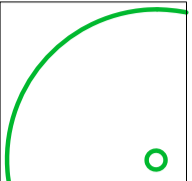
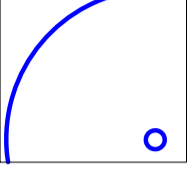
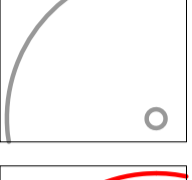

The original of this drawing was produced in colour - a monochrome copy should not be relied upon.

BS 5837:2012 TREE RETENTION CATEGORIES

- 

**Category A**  
Trees of high quality with an estimated remaining life expectancy of at least 40 years.
- 

**Category B**  
Trees of moderate quality with an estimated remaining life expectancy of at least 20 years.
- 

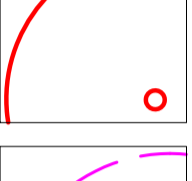
**Category C**  
Trees of low quality with an estimated remaining life expectancy of at least 10 years or young trees with a stem diameter below 150mm.
- 

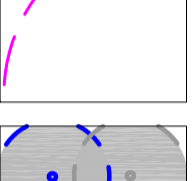
**Category U**  
Those in such a condition that the tree cannot realistically be retained as living trees in the context of the current land use for longer than 10 years.
- 

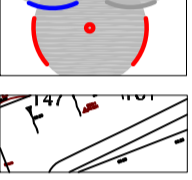
**BS5837 Root Protection Areas**  
Precautionary areas within which tree roots and soil structure must be protected. All works within these areas will require special methods of work.
- 

Trees to be removed shown shaded grey
- 

Ground Level layout shown black
- 

Lower Ground Level layout shown orange
- 

Application Boundary

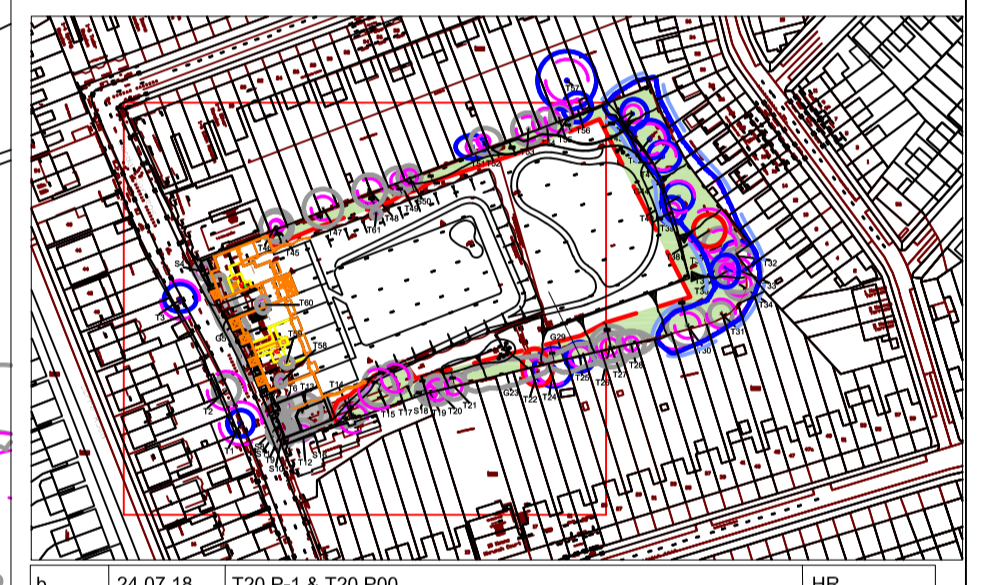

REV	DATE	DESCRIPTION	DRAWN
b	24.07.18	T20 P-1 & T20 P00	HR
a	24.06.17	525-P-XX-100	HR
-	10.05.17	170502_Gondar_Garden_Iteration_03_GA - Level 00 & 70502_Gondar_Garden_Iteration_03_GA - Level -01	HR

Base Drawing		
b	24.07.18	T20 P-1 & T20 P00

Title  
Proposed Layout and Tree Removals

Client  
Lifecare Residence

Project  
Gondar Gardens, London NW6 1QG

Date July 2018	Drawn by HR	Checked by -
-------------------	----------------	-----------------

Drawing No 170202-P-11-01	Rev b	Scale 1:250@A1
------------------------------	----------	-------------------

DO NOT SCALE Use only figured dimensions



The Barn, FeltimoresPark, Chalk Lane, Harlow, Essex CM17 0PF  
0845 094 3268 | info@tma-consultants.co.uk  
www.timmoayaassociates.co.uk

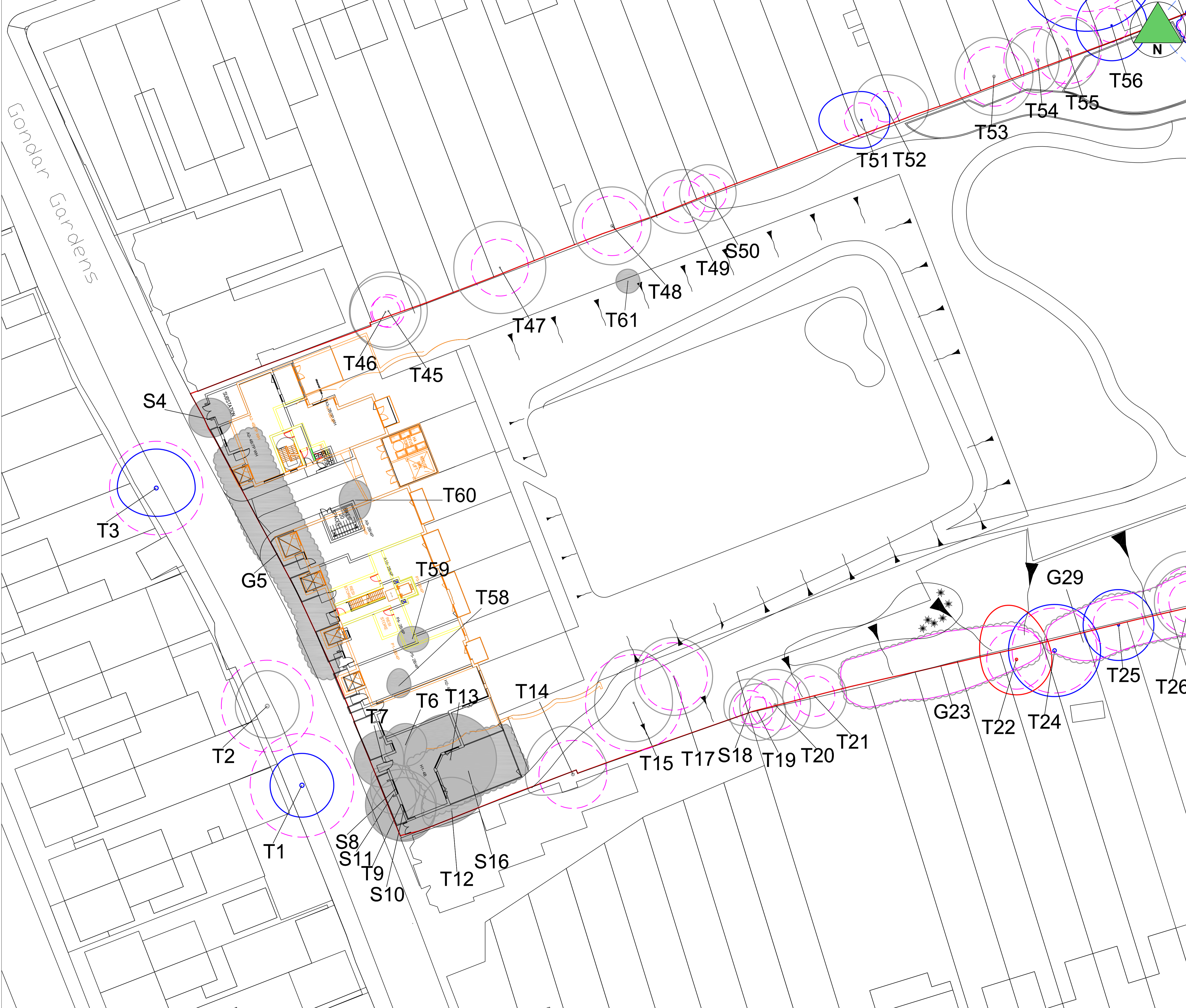

Gondar Gardens

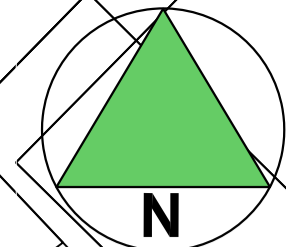

The original of this drawing was produced in colour - a monochrome copy should not be relied upon.

BS 5837:2012 TREE RETENTION CATEGORIES

- Category A**  
Trees of high quality with an estimated remaining life expectancy of at least 40 years.
- Category B**  
Trees of moderate quality with an estimated remaining life expectancy of at least 20 years.
- Category C**  
Trees of low quality with an estimated remaining life expectancy of at least 10 years or young trees with a stem diameter below 150mm.
- Category U**  
Those in such a condition that the tree cannot realistically be retained as living trees in the context of the current land use for longer than 10 years.
- BS5837 Root Protection Areas**  
Precautionary areas within which tree roots and soil structure must be protected. All works within these areas will require special methods of work.
- Trees to be removed shown shaded grey
- Ground Level layout shown black
- Application Boundary
- Trees under Camden TPO C378 2003  
Group of trees of various species

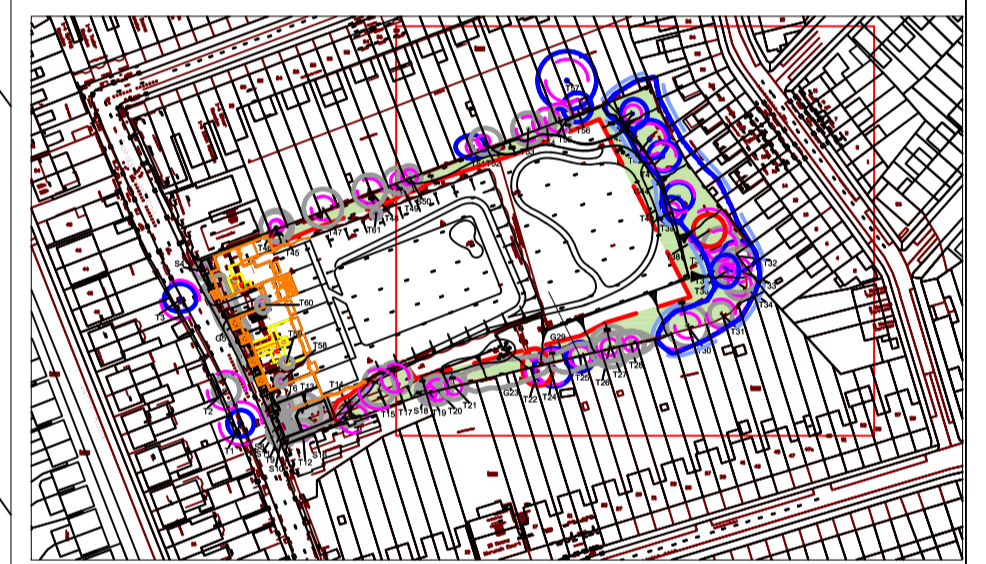

REV	DATE	DESCRIPTION	DRAWN
b	24.07.18	T20 P-1 & T20 P00	HR
a	24.05.17	525-P-XX-100	HR
-	10.05.17	170502_Gondar_Garden_Iteration_03_GA - Level 00 & 70502_Gondar_Garden_Iteration_03_GA - Level -01	HR
Base Drawing			
b	24.07.18	T20 P-1 & T20 P00	HR

Title <b>Proposed Layout and Tree Removals</b>		
Client <b>Lifecare Residence</b>		
Project <b>Gondar Gardens, London NW6 1QG</b>		
Date <b>July 2018</b>	Drawn by <b>HR</b>	Checked by <b>-</b>
Drawing No <b>170202-P-11-02</b>	Rev <b>b</b>	Scale <b>1:250@A1</b>
DO NOT SCALE Use only figured dimensions		

  
**TIM MOYA ASSOCIATES**  
 The Barn, FeltimoresPark, Chalk Lane, Harlow, Essex CM17 0PF  
 0845 094 3268 | info@tma-consultants.co.uk  
 www.timmoayaassociates.co.uk  
 arboriculture ecology landscape innovation

