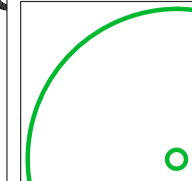
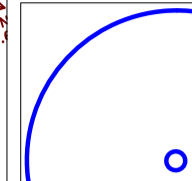
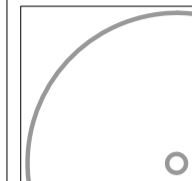

The original of this drawing was produced in colour - a monochrome copy should not be relied upon.

BS 5837:2012 TREE RETENTION CATEGORIES

- 

Category A
Trees of high quality with an estimated remaining life expectancy of at least 40 years.
- 

Category B
Trees of moderate quality with an estimated remaining life expectancy of at least 20 years.
- 

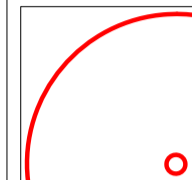
Category C
Trees of low quality with an estimated remaining life expectancy of at least 10 years or young trees with a stem diameter below 150mm.
- 

Category U
Those in such a condition that the tree cannot realistically be retained as living trees in the context of the current land use for longer than 10 years.
- 

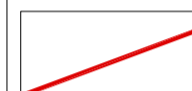
BS5837 Root Protection Areas
Precautionary areas within which tree roots and soil structure must be protected. All works within these areas will require special methods of work
- 

Application boundary

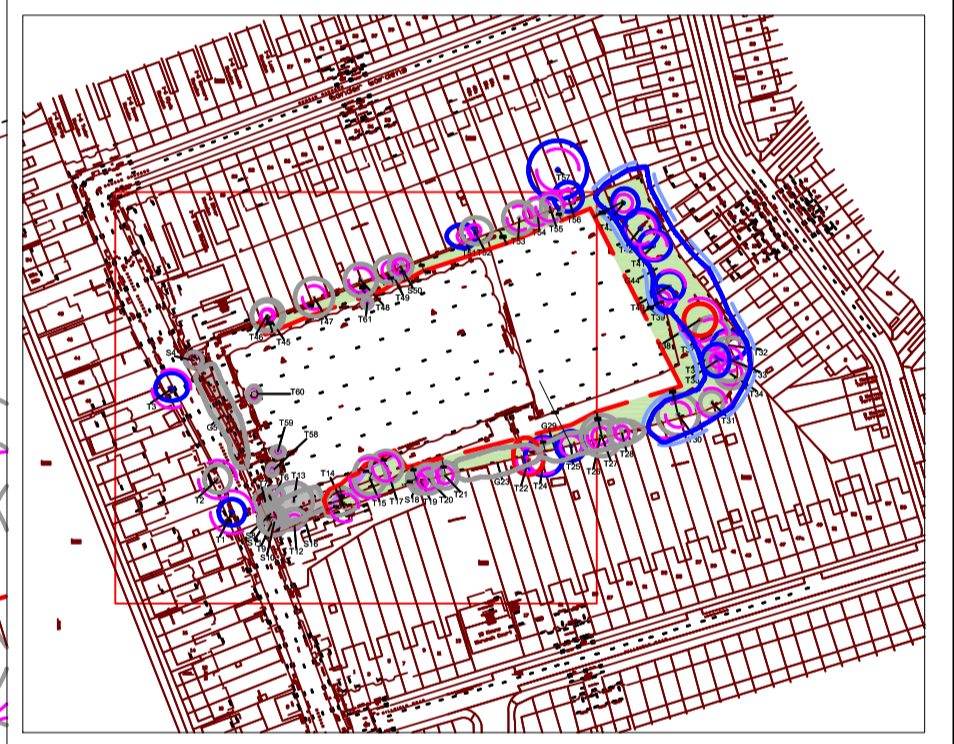

REV	DATE	DESCRIPTION	DRAWN
a	-	Updated from site visit	HR
-	10.05.17	Survey 3 (TPOD)	HR
Base Drawing			
Survey 3 (TPOD)			
0 5m 10m 20m 30m 40m 50m			

Title		
Tree Survey		
Client		
Lifecare Residences		
Project		
Gondar Gardens, London NW6 1QG		
Date	Drawn by	Checked by
May 2017	HR	-
Drawing No	Rev	Scale
170202-P-10-01	a	1:250@A1

DO NOT SCALE Use only figured dimensions





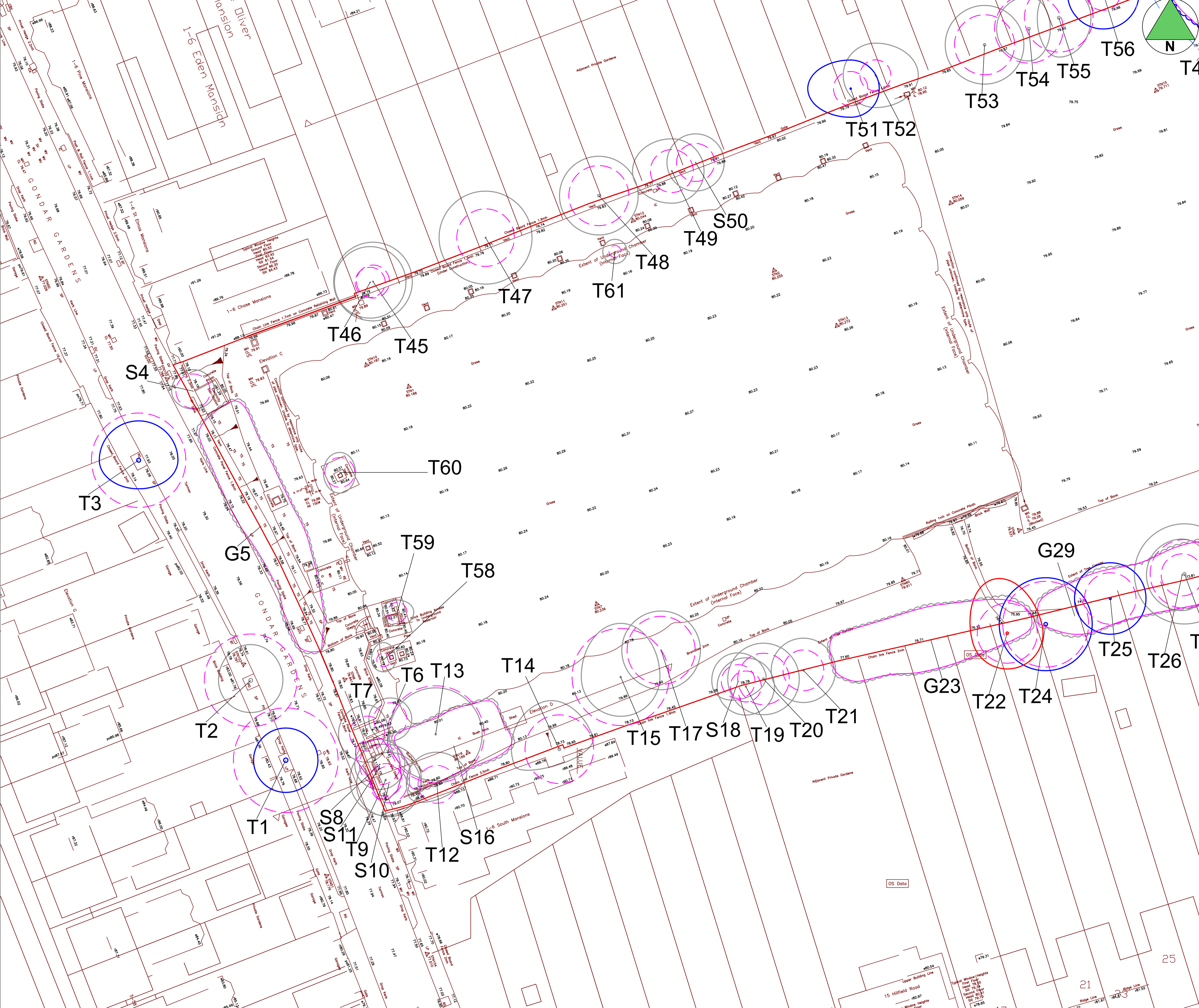

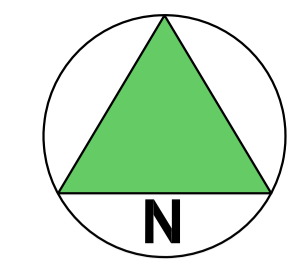
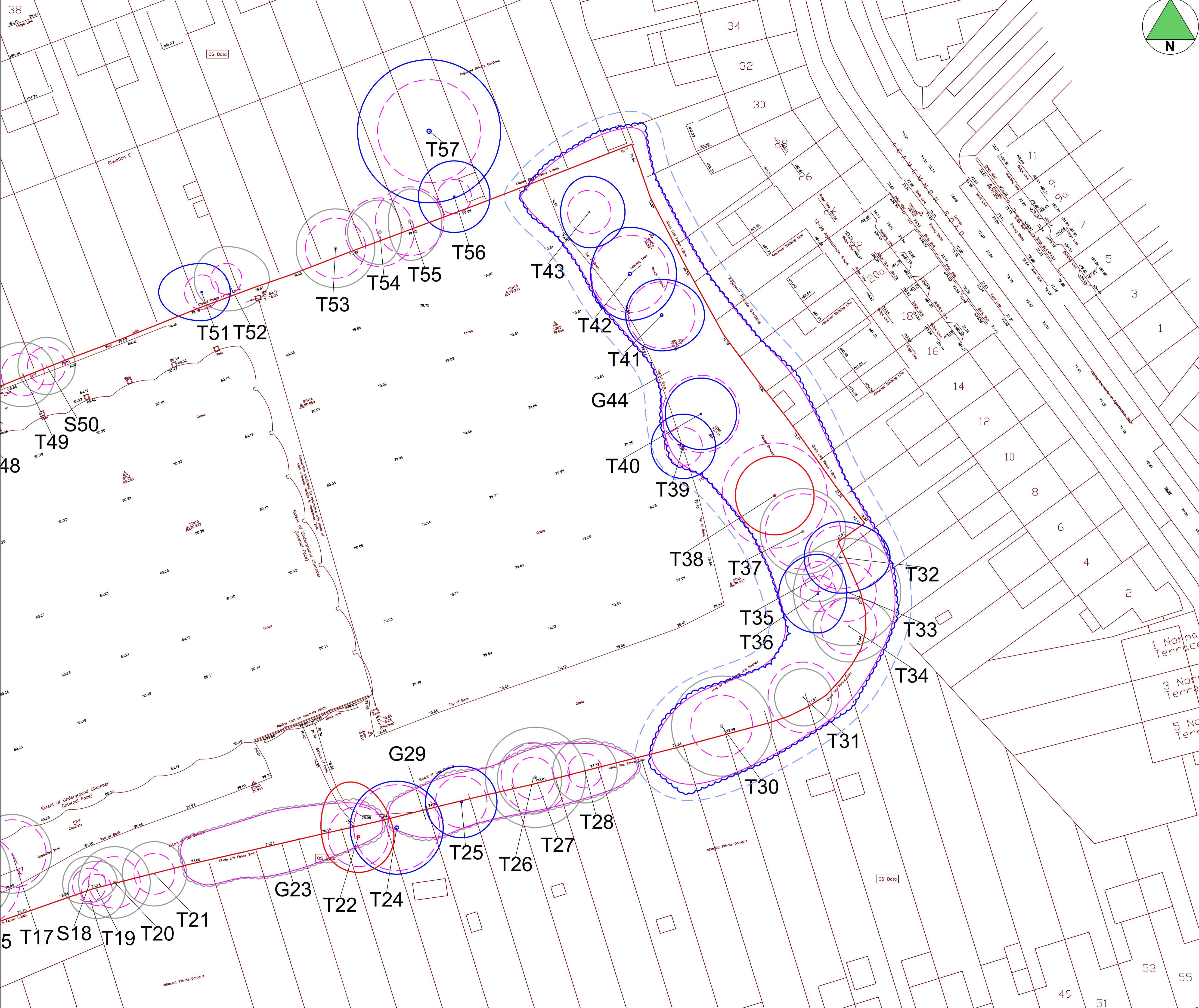
The Barn, FeltmoresPark, Chalk Lane, Harlow, Essex CM17 0PF
0845 094 3268 | info@tma-consultants.co.uk
www.timmoayaassociates.co.uk



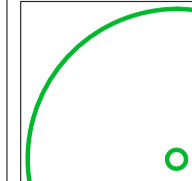
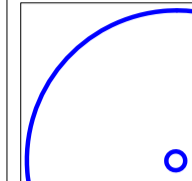
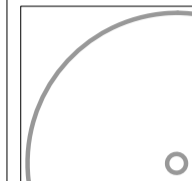
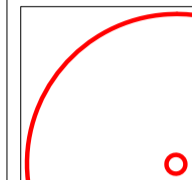

The original of this drawing was produced in colour - a monochrome copy should not be relied upon.

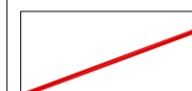
BS 5837:2012 TREE RETENTION CATEGORIES

- 
Category A
 Trees of high quality with an estimated remaining life expectancy of at least 40 years.
- 
Category B
 Trees of moderate quality with an estimated remaining life expectancy of at least 20 years.
- 
Category C
 Trees of low quality with an estimated remaining life expectancy of at least 10 years or young trees with a stem diameter below 150mm.
- 
Category U
 Those in such a condition that the tree cannot realistically be retained as living trees in the context of the current land use for longer than 10 years.
- 
BS5837 Root Protection Areas
 Precautionary areas within which tree roots and soil structure must be protected. All works within these areas will require special methods of work
- 
Application boundary
- 
Trees under Camden TPO C378 2003 Group of trees of various species

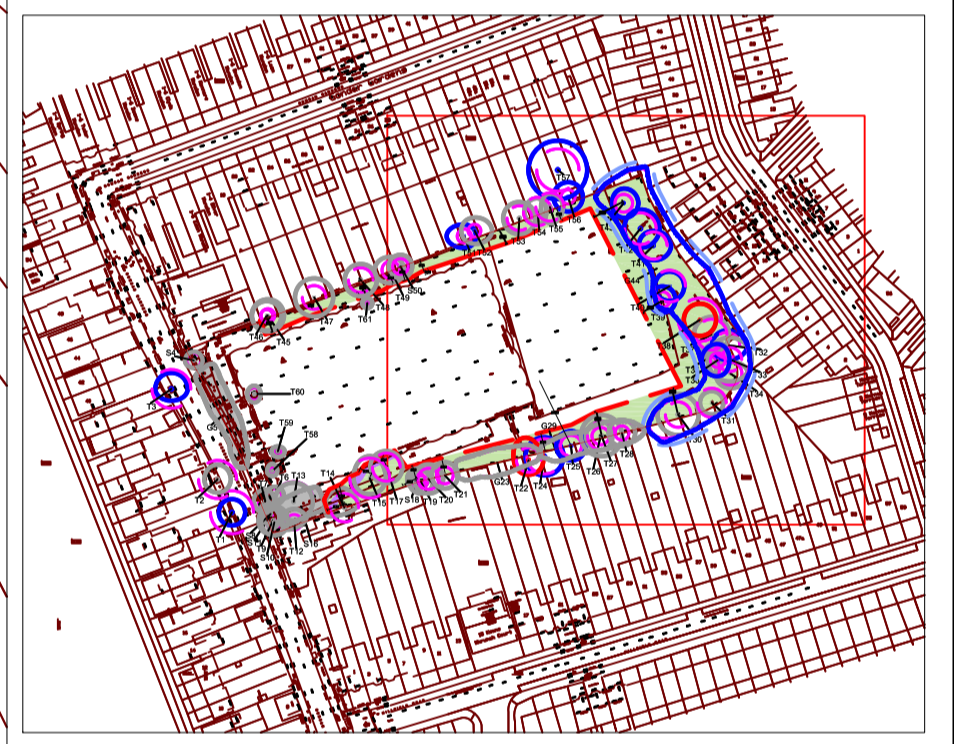

REV	DATE	DESCRIPTION	DRAWN
a	-	Updated from site visit	HR
-	10.05.17	Survey 3 (CTOPD)	HR
Base Drawing			
Survey 3 (CTOPD)			

Title		
Tree Survey		
Client		
Lifecare Residences		
Project		
Gondar Gardens, London NW6 1QG		
Date	Drawn by	Checked by
May 2017	HR	-
Drawing No	Rev	Scale
170202-P-10-02	a	1:250@A1
DO NOT SCALE Use only figured dimensions		

