

Demolition Ground Floor RCP Plan

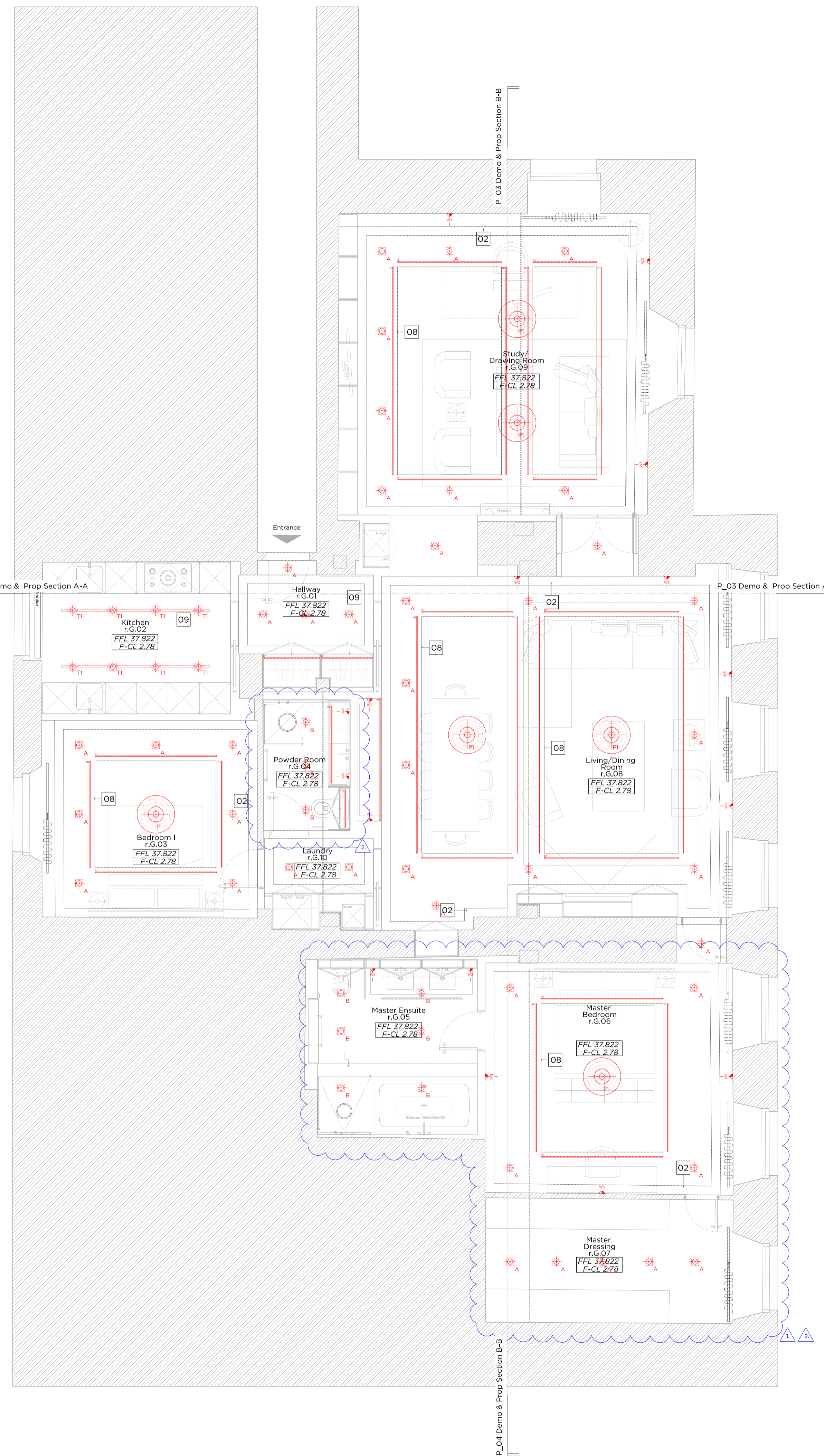

Proposed Ground Floor RCP Plan

Key Site Plan 1:250

Key:

- Hatch denotes area of demolition of existing non-original suspended ceiling
- Red line denotes existing non-original moldings to be removed

Light Fittings:

- Pendant
- Fixed down light
- Recessed track mounted downlight, adjustable
- Strip light
- Internal wall light

Other fittings:

- Curtains & recessed curtain track
- Recessed showerhead fitting

Demolition Notes:

- Non-original partitions to be removed.
- Removal of masonry to create enlarged opening.
- Removal of masonry to create new opening.
- Non-original door to be removed and replaced. Refer to Door Schedule.
- Non-original suspended ceiling to be removed and replaced. Refer to Schedule of Proposed Works.
- Non-original cornicing to be removed and replaced. Refer to Schedule of Proposed Works.
- Non-original fireplace and surround to be removed and replaced.
- Non-original sanitaryware fittings to be removed.
- Non-original joinery to be removed.
- Non-original kitchen to be removed and replaced.

Proposed Notes:

- New non-load bearing internal partition.
- New traditionally detailed cornicing. Refer to Schedule of Proposed Works.
- Proposed fireplace and surround to be traditionally detailed.
- New hardwood panelled door and architrave. Refer to Door Schedule.
- New hardwood panelled pocket door and architrave. Refer to Door Schedule.
- Enlarged opening within existing wall, retaining downstand above to relocate cornicing.
- New opening within existing wall, retaining downstand above to relocate cornicing.
- New suspended ceiling with recessed coveffed ceiling to increase ceiling heights in principal rooms, with concealed LED light fittings.
- New suspended ceiling with concealed LED light fittings.
- New hardwood joinery with cornicing above.
- New free-standing joinery, independent to existing wall and moldings.
- New traditionally detailed skirtings.
- New traditionally detailed panelled walls to principal rooms.
- Existing window to be retained and redecorated.
- New hardwood kitchen (reusing existing hob extraction).
- New floor to ceiling joinery.

Rev A - For Planning
28.06.18 1. Existing dressing room walls and joinery retained; master bedroom location amended
2. Bathroom layout amended
3. Lighting layout updated to suit amended room layouts

Rev - For Planning
06.04.18

PLANNING

Project No. 17080
Client Simon Gold
Date June 2018
Scale 1:50@A1 / 1:100@A3
Project No. 29 Cumberland Terrace

Drawing Title: Demolition and Proposed Ground Floor Plan - RCP
Drawing No. P_04 Rev. A
Drawn SW Approved RD Signed



66-68 Margaret Street W1W 8SR T. 020 7580 9336 www.mw-a.co.uk
Copyright Marek Wojciechowski Architects Limited.
No implied license exists. This drawing should not be used to calculate areas for the purposes of valuation. All dimensions to be checked on site by the contractor and such dimensions to be their responsibility. Do not scale drawings. All work must comply with relevant British Standards and Building Regulations requirements. Drawing errors and omissions to be reported to the architect.

