

Engineered timber floor NBS K21/112 laid floating on Duralay Heat Flow underlay NBS K21/112 on 65mm sand cement screed to St Eng spec with underfloor heating pipes by Myson Floortec or similar and approved on 500g polythene sheet to act as a vapour control layer with 150mm sealed laps and sealed perimeter on 140mm Kingspan Kooltherm insulation boards on min 1200g polythene DPM on grouted beam and block floor.

Outer leaf of brickwork to NBS F10/110 built overhead where necessary with black mortar to NBS Z21. 100mm full fill cavity insulation NBS F30/150 in 110mm cavity with stainless steel cavity ties at 450 ctrs both horizontally and vertically bedded into inner leaf of 100mm Tarmac Toplite GTI concrete blockwork NBS F10/355.

Bauder sedum blanket XF301 on SDF mat NBS Q37/130 on single layer polymeric roofing membrane NBS J42/110 fully adhered to vapour control layer NBS P10/311 sealed at all edges on 18mm WBP plywood NBS K11/515 on treated sw furring pieces to give 1:60 fall on 150 x 50 sw joists grade SC4 at centres to structural engineers requirements. Joists supported on steel beams and wall plates to structural engineers requirements. Gyproc MF ceiling NBS K10/210 set below joists to give clear void for MVHR duct work.

Cross ventilated floor void with blinding laid to fall towards outside walls 10no periscope vents in total NBS F30/140

SECTION CC

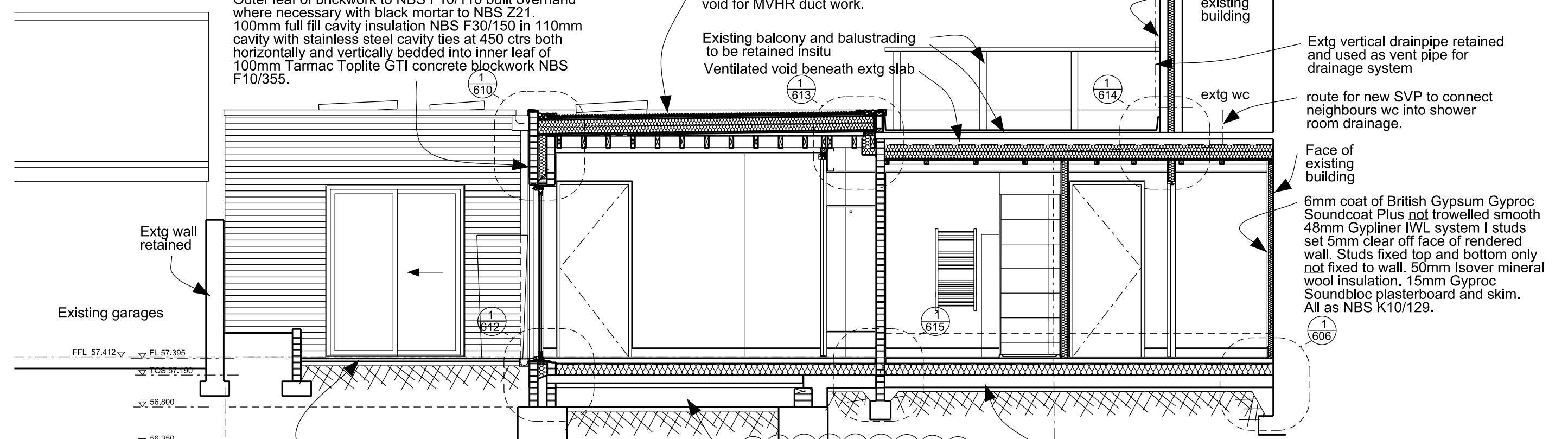

Marshalls Saxon Natural paving slabs to NBS Q25/110. 600 x 300 x 50 laid in brick bond in EW direction on well consolidated hardcore bed to min 1:60 falls to ACO RainDrain channel NBS R10/380. Paving retained on East side by low brick wall to raised planter.

Cross ventilated floor void with blinding laid to fall towards outside walls 10no periscope vents in total NBS F30/140

Solid concrete slab in lieu of beam and pot floor in existing store. All to St Eng specification.

Extg vertical drainpipe retained and used as vent pipe for drainage system

route for new SVP to connect neighbours wc into shower room drainage.

Face of existing building

6mm coat of British Gypsum Gyproc Soundcoat Plus not trowelled smooth 48mm Gypliner IWL system I studs set 5mm clear off face of rendered wall. Studs fixed top and bottom only not fixed to wall. 50mm Isover mineral wool insulation. 15mm Gyproc Soundbloc plasterboard and skim. All as NBS K10/129.

SECTION DD

D 29.06.18 Door threshold detail revised  
 C 22.02.18 Construction Issue  
 B 12.10.17 Acoustic Lining added - TENDER  
 A 05.10.17 Building Control Issue

PROJECT  
 BUNGALOW AT BROOKFIELD HOUSE  
 FOR MR C FREEMAN

DATE NO  
 BBH.17.202D  
 SCALE 1:50 @ A3  
 DATE AUG 2017

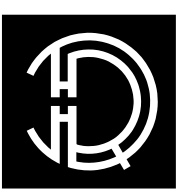

ARCHITECTS  
 INTERIOR  
 + URBAN  
 DESIGNERS  
 DAVID RICHMOND  
 AND PARTNERS LTD

The Studio  
 1 Southwood  
 Lawn Road  
 London N6 5SD  
 T 07803 084 788  
 E david@dr-p.co.uk

THIS DRAWING IS COPYRIGHT  
 ALL DIMENSIONS TO  
 BE CHECKED ON SITE  
 DO NOT SCALE

# CONSTRUCTION ISSUE