

Ground floor and courtyard plan

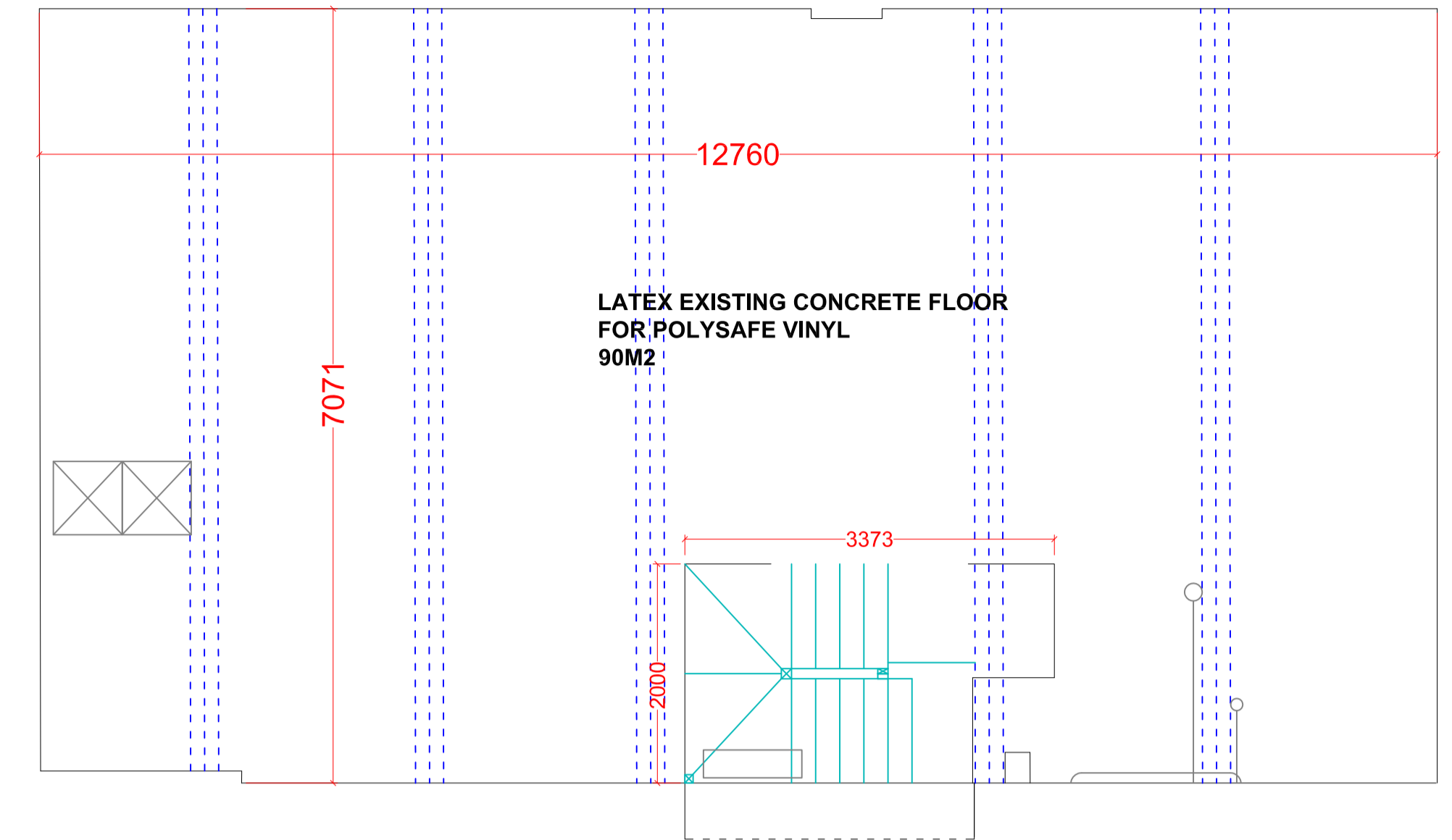

Basement plan

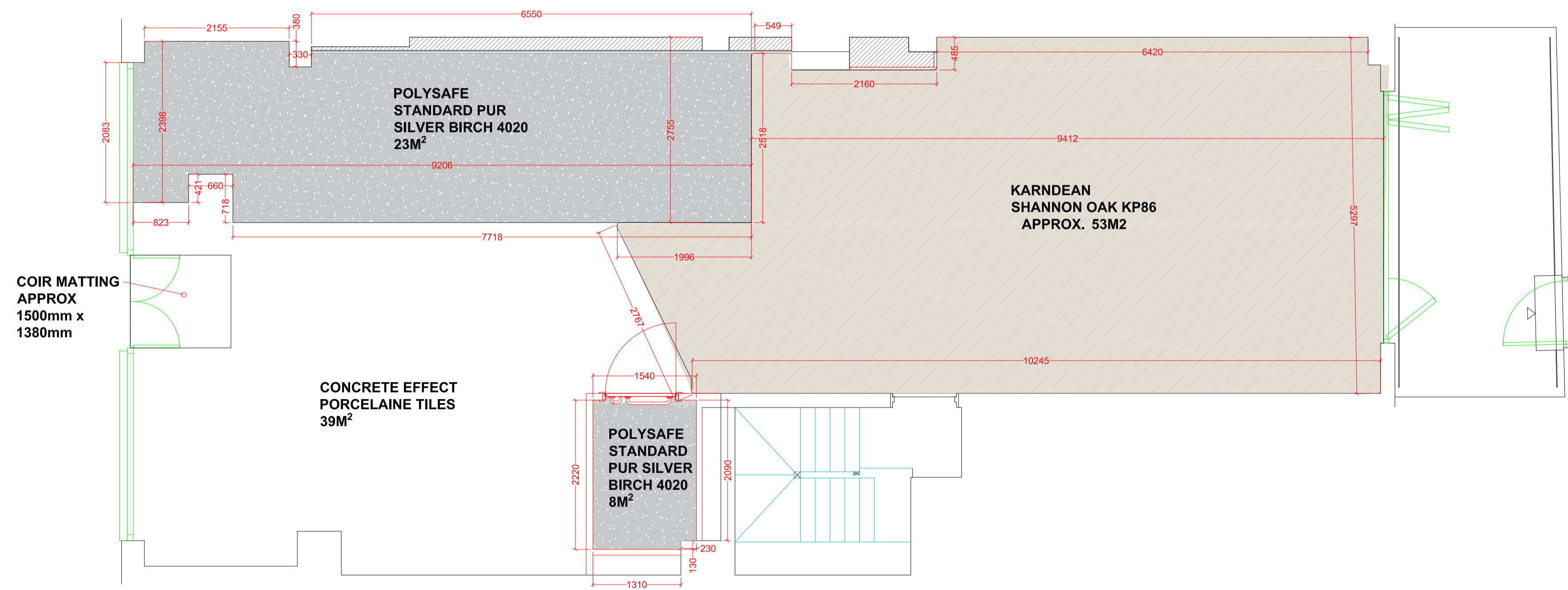

Ground floor and courtyard plan

| | | | | | |
|-----------------|---|-----------|------------|-----------|---------|
| Job Number: | HK3213-P9 | Drawn By: | JT | Scale: | 1:50@A1 |
| Drawing Title: | Planning Detail 9 - Proposed Floor Finishes | Date: | 20/07/2018 | Revision: | - |
| Revision Notes: | | | | | |

Job Title: Naturally Ltd

Site Address: 259 Kentish Town Road, London, NW4 2JT

Notes:
Any discrepancies are to be reported to HK Interiors immediately. Contractor/Manufacturer to check all dimensions on site. Do not rescale this drawing.
This drawing is copyright of HK Interiors. Copyright is reserved and the drawing should not be copied, related or reproduced in any part without prior written consent.