

POWER	
<b>CABLE TRAYS ABOVE CEILINGS</b> medium duty cable tray or basket minimum size 150mm suspended by stirrup or hanger or unistrut spaced at max 1.5m with min 10mm threaded rod all bends & tee from same manufacturer	all electrical works to be in full compliance with Pret mains distribution layout & details electrical & equipment specification sheets provided by electrical contractor
<b>SALES 250 cff</b>	u/c freezer 500 cff
<b>SALES 500 cff</b>	FRUIT floor mount 5A
<b>SALES 500 cff</b>	01no. 240V 13AMP SINGLE PHASE DOUBLE SWITCHED SOCKET - metal clad white inserts wall recessed at 500mm affl to top of socket. for u/c freezer.
<b>SALES 500 cff</b>	01no. 240V 5AMP SINGLE PHASE brushed metal 5amp recessed floor socket connected to local non-dimmable lighting circuit to turn off out of hours for fruit rack.
<b>SALES 500 cff</b>	01no. 240V 13AMP SINGLE PHASE DOUBLE SWITCHED SOCKET - brushed metal white inserts wall recessed at 500mm affl to top of socket. customer seating areas.
<b>PREP 500 cff</b>	01no. 240V 13AMP SINGLE PHASE DOUBLE SWITCHED SOCKET - metal clad white inserts wall recessed at 500mm affl to top of socket. In prep/kitchen areas/general.
<b>STAFF 500 cff</b>	01no. 240V 13AMP SINGLE PHASE DOUBLE SWITCHED SOCKET - metal clad white inserts wall recessed at 500mm affl to top of socket. In office / staff room areas.
<b>STAFF 1100 cff</b>	01no. 240V 13AMP SINGLE PHASE DOUBLE SWITCHED SOCKET - metal clad white inserts wall recessed at 1100mm affl to top of socket. In staff room areas.
<b>PRINTER 500 cff</b>	02no. 240V 13AMP SINGLE PHASE DOUBLE SWITCHED SOCKET - metal clad white inserts wall recessed at 500mm affl to top of socket. under coffee machines.
<b>COFFEE 500 cff</b>	03no. 240V 13AMP SINGLE PHASE DOUBLE SWITCHED SOCKET - metal clad white inserts wall recessed at 500mm affl to top of socket. for future coffee control.
<b>MICRO 500 cff</b>	01no. 240V 13AMP SINGLE PHASE DOUBLE SWITCHED SOCKET - metal clad white inserts surface mounted at 500mm affl to top of socket. for microwaves.
<b>COMMS above ceiling</b>	01no. 240V 13AMP SINGLE PHASE DOUBLE SWITCHED SOCKET - metal clad white inserts surface mounted above ceiling. for comms cabinet.
<b>SAFE above safe</b>	01no. 240V 13AMP SINGLE PHASE DOUBLE SWITCHED SOCKET - metal clad white inserts surface mounted above safe with mini trunking connection for safe.
<b>IP65 DW 460 cff</b>	01no. 415V 16AMP 3 PHASE SOCKET - red PVC at 460mm affl to top of socket located between double sink waste for dishwashers.
<b>DWIS</b>	01no. Isolator switch. for dishwashers.
<b>TOASTIES 2no 800 cff</b>	02no. 240V 32AMP SINGLE PHASE COMMANDO OUTLETS blue pvc - at 500mm affl to top of outlet
<b>TIS</b>	2no polished chrome isolator switches 1600mm affl in accessible locations. for toastie machines.
<b>IP65 SOUP 1100 cff</b>	01no. 415v 32AMP 3 PHASE COMMANDO OUTLET - red pvc centrally mounted 1100mm affl to top of outlet. with IP65 metal clad white inserts for soup rethermaliser.
<b>SOUPIS</b>	01no. Isolator 1600mm affl to top of switch. for soup rethermaliser.
<b>OVENS 1100 cff</b>	02no. 400V 16AMP THREE PHASE COMMANDO SOCKETS - red pvc at 1100mm affl to top of socket for each Smeg Alfa 144 oven for ovens in servery counter areas.
<b>OVENS</b>	02no. chrome (white inserts) isolator switches. 1600mm affl in accessible locations. for ovens.
<b>OFFICE TRUNKING SYSTEM - (x02no.)</b>	MK 2 compartment dado trunking underneath office worktop 500mm affl to top of trunking with 8no. MK white plastic double switched socket power outlets & 3no. RJ45 outlet sockets.
<b>3no. DS</b>	03no. 240V 13AMP DOUBLE SOCKETS - located above the patch panel for patch panel, CCTV & 1no 'Red' socket for music - In office
<b>240V 32A</b>	01no. 240V 32AMP SINGLE PHASE SUPPLY- for walk-in freezer
<b>WIFIS</b>	01no. Isolator switch - mounted on external wall at high level next to control panel for walk-in freezer
<b>HOT 300 cff</b>	01no. 415V 16AMP THREE PHASE COMMANDO SOCKET - red pvc behind langer 300mm affl to top of socket. for hot langer.
<b>COLD 1200 cff</b>	04no. 240V 16AMP SINGLE PHASE COMMANDO SOCKET - plastic blue behind langer 1200mm affl to top of socket. for cold langers.

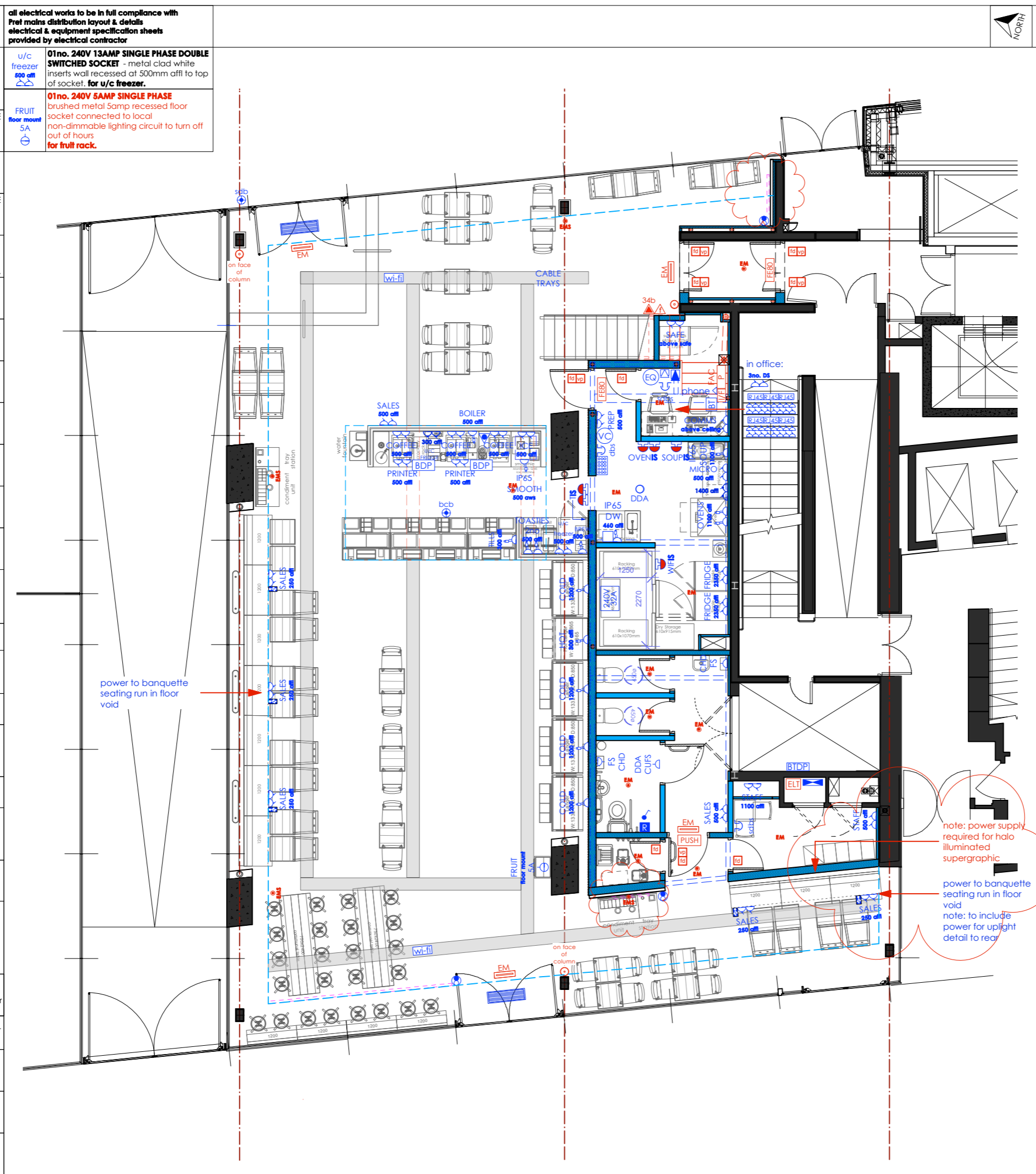

FIRE & EMERGENCY																													
<b>FRIDGE 2300 cff</b>	02no. 240V 13AMP SINGLE PHASE DOUBLE SWITCHED SOCKET - metal clad white inserts surface mounted at 2350 affl to top of socket. for freestanding tall fridge.																												
<b>CHD FS</b>	02no. 240V 13AMP SINGLE PHASE brushed metal unswitched fused spur at high level above handrier for customer hand driers front of house																												
<b>BREW 500 cff</b>	01no. 240V 16 AMP SINGLE PHASE COMMANDO OUTLET - plastic blue at 500 affl to top of outlet for Bunn brewer																												
<b>ICE 300 cff</b>	01no. 240V 13AMP SINGLE PHASE DOUBLE SWITCHED SOCKET - metal clad white inserts wall recessed at 500mm affl to top of socket. for u/c ice machine																												
<b>BOILER 300 cff</b>	01no. 240V 13 AMP SINGLE PHASE SINGLE SWITCHED SOCKET - at 500 affl to top of outlet for Marco T10 water boiler																												
<b>TILLS 300 cff</b>	01no. 240V 32AMP SINGLE PHASE COMMANDO OUTLET plastic / blue at 300mm affl to top of socket. for till units.																												
<b>IP65 SMOOTH 500 cff</b>	01no. 240V 13AMP SINGLE PHASE IP 65 DOUBLE SOCKET grey plastic - surface mounted at 500mm from above work surface to top of socket (or lower to suit low upstand wall) for smoothie blenders.																												
<b>03no.</b>	SIGNAGE POWER SUPPLIES - white switched fused spurs mounted linked to timer clock by distribution boards. for illuminated signs.																												
<b>DDA CUPS</b>	01no. 240V 13AMP SINGLE PHASE UNSWITCHED FUSED SPUR - brushed metal located above dda wc door for fireguard DDA alarm control unit																												
<b>NEW PRET ELECTRICAL DISTRIBUTION BOARDS</b>	new mains distribution board																												
<b>02no.</b>	CEILING POWER SUPPLY - for over door heater, supply to suit heater specification by electrician on site to suit ceiling height & door width.																												
<b>01no.</b>	BACK COUNTER POWER SUPPLY 47.11KW - 400V 3 PH+N + E - main contractors site electrician is to run a protected cable from distribution board, leaving a two (2) metre coil of cable with tails for final connection to the beverage counter distribution board by main contractors site electrician.																												
<b>bcs</b>	02no. BACK COUNTER BELL SOUNDER located in staff room & managers office																												
<b>DDA db</b>	01no. DDA DOOR BELL located at appropriate height by front door																												
<b>db</b>	01no. DDA DOOR BELL SOUNDER located by bank of switches near to back counter																												
<b>COMMS:</b>																													
<b>wi-fi</b>	02no. WI-FI antenna box position																												
<b>BT</b>	01no. BT HIGHWAY MM 300 ABOVE F.F.L. - (below 4 way trunking system) located in managers office																												
<b>BTDP</b>	01no. BT DISTRIBUTION POINT main incoming distribution point for BT location fbc @ pre-start																												
<b>phone</b>	01no. TELEPHONE / FAX POINT																												
<b>BDP</b>	02no. BT BACK COUNTER DATA POINT data point connection centred on low wall behind coffee machines for order printers (with 2no double socket outlets @ 500h located under counters)																												
<b>sub</b>	01no. DELIVERY/STAFF DOOR BELL located at front or rear door																												
<b>sbs</b>	02no. DELIVERY/STAFF DOOR BELL SOUNDER located in staff room & managers office																												
<b>bc</b>	01no. BACK COUNTER BELL located by bank of switches near to back counter																												
<table border="1"> <thead> <tr> <th>Rev:</th> <th>Date:</th> <th>By:</th> <th>Description:</th> </tr> </thead> <tbody> <tr> <td>A</td> <td>15.03.18</td> <td>LW</td> <td>emergency lights updated, call point locations revised</td> </tr> <tr> <td>B</td> <td>12.04.18</td> <td>PM</td> <td>power for u/c freezer added to brew station module location</td> </tr> <tr> <td>C</td> <td>09.05.18</td> <td>LW</td> <td>recessed floor power socket added for fruit rack</td> </tr> <tr> <td>D</td> <td>25.05.18</td> <td>LW</td> <td>high level power revised to suit new signage locations. note added re: power required for halo illuminated supergraphic</td> </tr> <tr> <td>E</td> <td>18.06.18</td> <td>LW</td> <td>power/projectors omitted to servery, power over safe relocated</td> </tr> <tr> <td>F</td> <td>05.07.18</td> <td>LW</td> <td>smoke lobby door arrangement revised</td> </tr> </tbody> </table>		Rev:	Date:	By:	Description:	A	15.03.18	LW	emergency lights updated, call point locations revised	B	12.04.18	PM	power for u/c freezer added to brew station module location	C	09.05.18	LW	recessed floor power socket added for fruit rack	D	25.05.18	LW	high level power revised to suit new signage locations. note added re: power required for halo illuminated supergraphic	E	18.06.18	LW	power/projectors omitted to servery, power over safe relocated	F	05.07.18	LW	smoke lobby door arrangement revised
Rev:	Date:	By:	Description:																										
A	15.03.18	LW	emergency lights updated, call point locations revised																										
B	12.04.18	PM	power for u/c freezer added to brew station module location																										
C	09.05.18	LW	recessed floor power socket added for fruit rack																										
D	25.05.18	LW	high level power revised to suit new signage locations. note added re: power required for halo illuminated supergraphic																										
E	18.06.18	LW	power/projectors omitted to servery, power over safe relocated																										
F	05.07.18	LW	smoke lobby door arrangement revised																										
<p>PROJECT <b>★ PRET A MANGER ★</b></p> <p>LOCATION <b>Units R06 &amp; R08, Centre Point House</b> St Giles Square, London, WC2H 8LW</p> <p>TITLE <b>POWER LAYOUT PLAN</b> <b>GROUND FLOOR</b></p> <p>DRAWING NO. <b>1562-PRET-09.1</b></p> <table border="1"> <thead> <tr> <th>REVISION</th> <th>DATE DRAWN</th> <th>SCALE @ A3</th> </tr> </thead> <tbody> <tr> <td>F</td> <td>28.02.18</td> <td>1:100</td> </tr> </tbody> </table> <p>All dimensions to be confirmed on site by Contractor. Structural works to be confirmed by Structural Engineer. All elements to comply with statutory requirements.</p> <p>Copyright One Red Wall Ltd Claremont House, 22-24 Claremont Rd, Surbiton, Surrey, KT6 4QU. tel. 020 83993237 www.oneredwall.com</p> <p><b>oneredwall</b></p>		REVISION	DATE DRAWN	SCALE @ A3	F	28.02.18	1:100																						
REVISION	DATE DRAWN	SCALE @ A3																											
F	28.02.18	1:100																											