

2A TEMPLEWOOD AVENUE

A2-size drawing
1:100

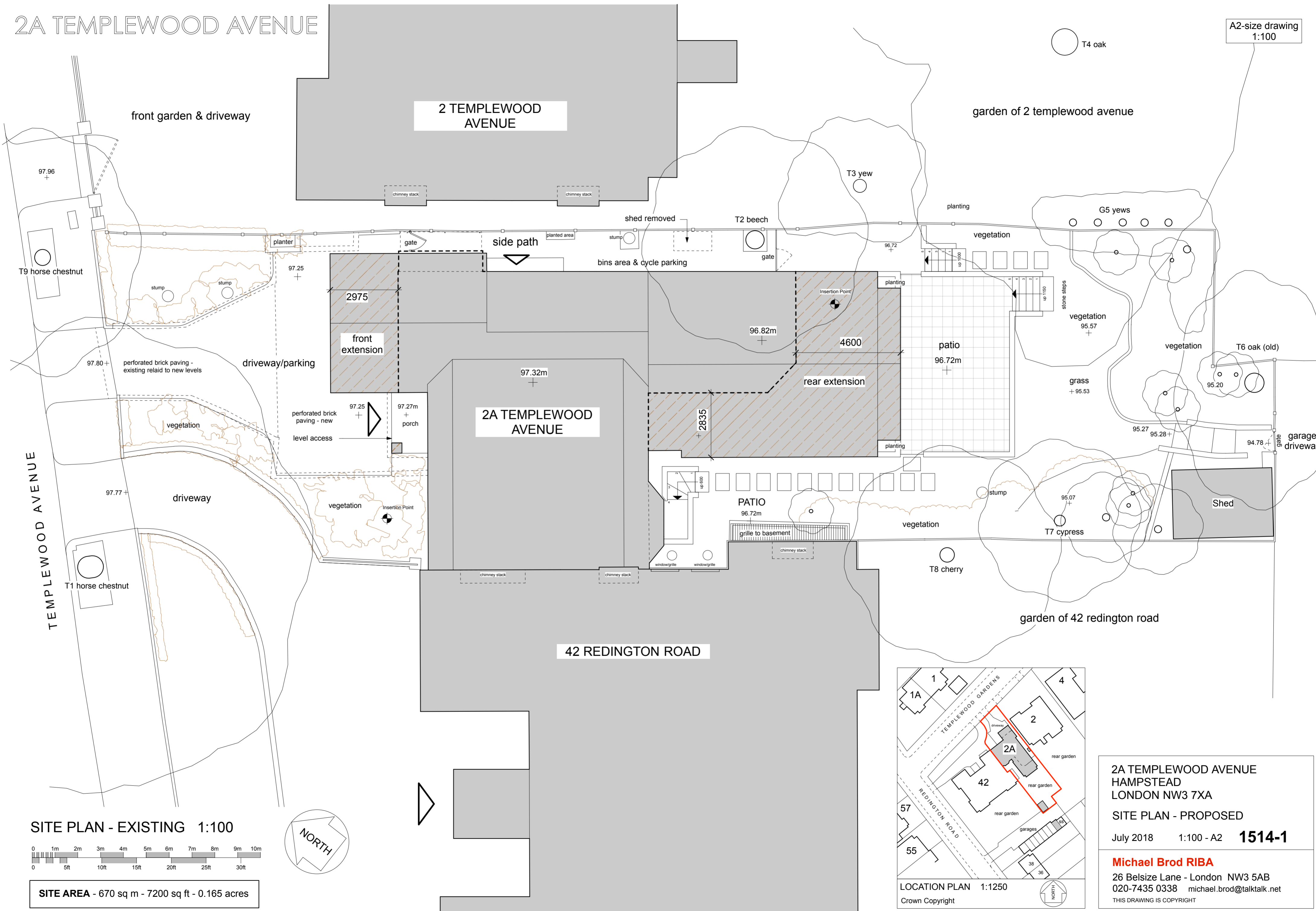

SITE PLAN - EXISTING 1:100

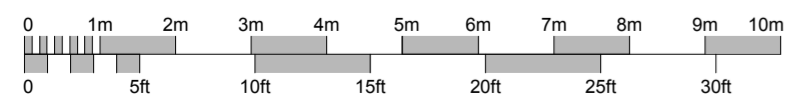

SITE AREA - 670 sq m - 7200 sq ft - 0.165 acres

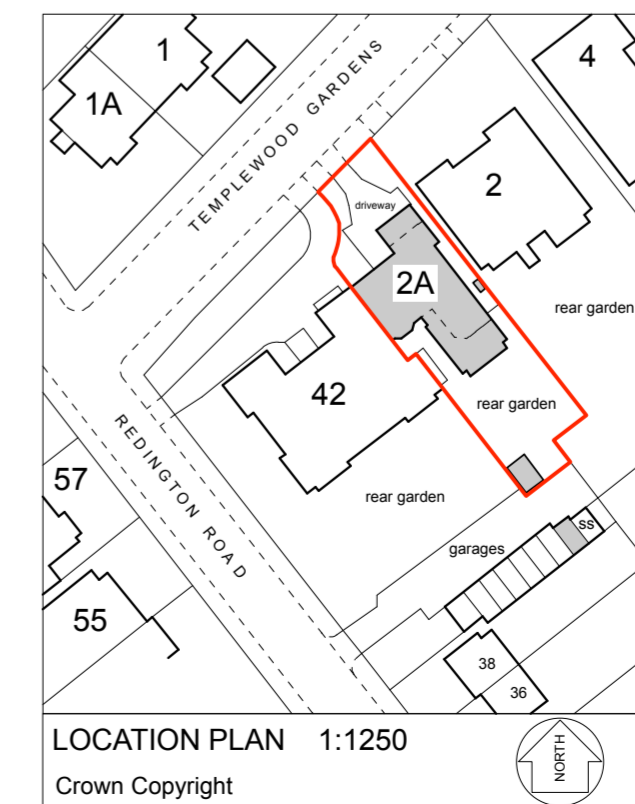

LOCATION PLAN 1:1250
Crown Copyright

2A TEMPLEWOOD AVENUE
 HAMPSTEAD
 LONDON NW3 7XA
 SITE PLAN - PROPOSED
 July 2018 1:100 - A2 **1514-1**
Michael Brod RIBA
 26 Belsize Lane - London NW3 5AB
 020-7435 0338 michael.brod@talktalk.net
 THIS DRAWING IS COPYRIGHT