

Notes: Do not scale from this drawing. Contractor to take and check all dimensions on site before work commences. Discrepancies to be reported to architect. Subcontractors to verify all dimensions on site before making shop drawings or commencing manufacture. This drawing is copyright.

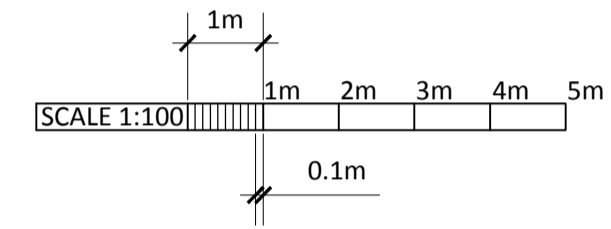

SOUTH ELEVATION TO WATERLOW PARK



EAST ELEVATION TO PLAY LAWN

Rev	Description	Date	Initial
A	HALL EXTENSION REMOVED	24/07/2018	

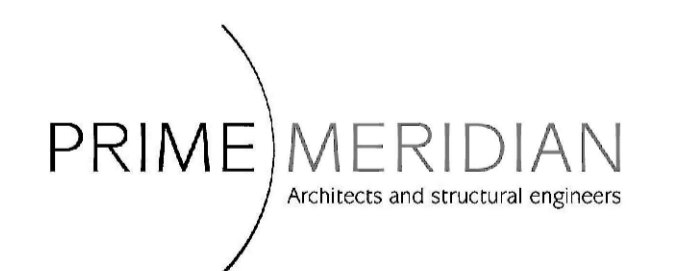

Second Floor T 020 7494 3522 The Priory, Draycott Rd T 01749 34 66 99
 26A Ganton Street F 020 7494 3533 Shepton Mallet F 01749 34 66 77
 London W1F 7QZ Somerset BA4 5HS
 info@prime-meridian.co.uk www.primemeridian.co.uk

Client: **CHANNING SCHOOL**

Project: **FAIRSEAT UNDERCROFT AND PAVILION**

Title: **PROPOSED - DRAMA STUDIO EXTENSION**

Date: 11.12.17
 Scale: 1:100@A1



WEST ELEVATION

Notes: Do not scale from this drawing. Contractor to take and check all dimensions on site before work commences. Discrepancies to be reported to architect. Subcontractors to verify all dimensions on site before making shop drawings or commencing manufacture. This drawing is copyright.

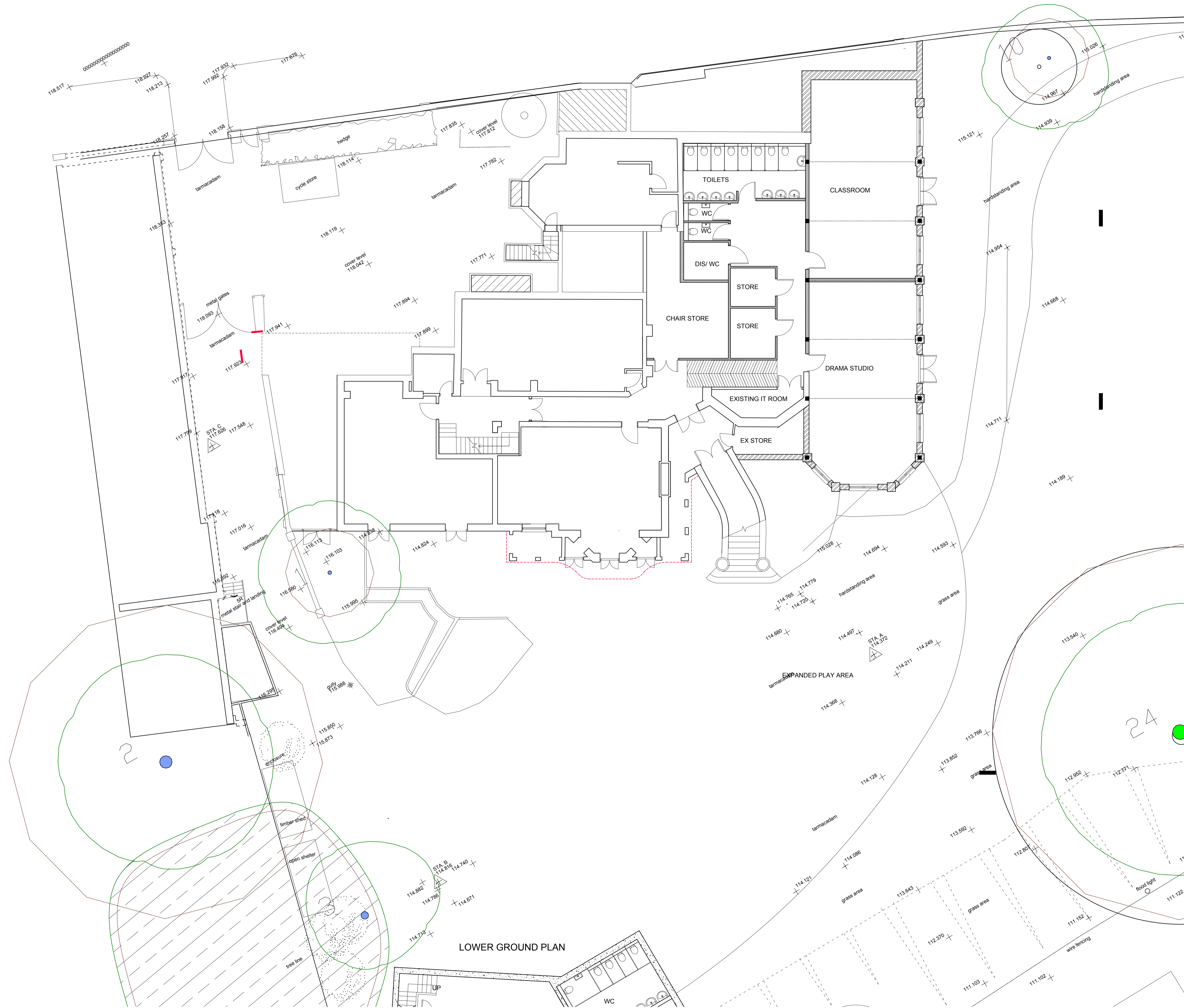
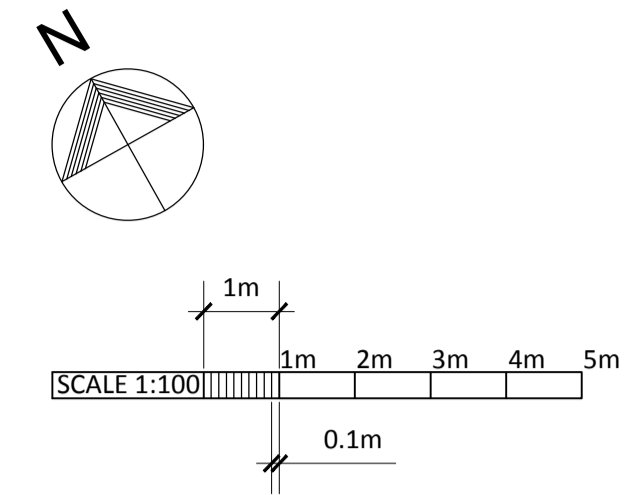

LOWER GROUND PLAN

Rev	Description	Date	Initial
	PROPOSED HALL REMOVED	29.07.18 JB	
A	Dining Hall Removed	20/07/20 BB	

PRIME MERIDIAN
Architects and structural engineers

Second Floor: 25A Canton Street, London W1F 7QZ, info@prime-meridian.co.uk
 T 020 7494 3522, F 020 7494 3533
 The Priory, Draycott Rd, Shepton Mallet, Somerset BA4 5HS, info@prime-meridian.co.uk, T 01749 34 66 99, F 01749 34 66 77

Client: **CHANNING SCHOOL**

Project: **FAIRSEAT NEW PAVILION AND CLASSROOMS**

Title: **PROPOSED LOWER GROUND FLOOR PLAN UNDERCROFT**

Date: 24.07.18
 Scale: 1:100@A1
 Drawn:
 No. 343.36/PLA20 B

Notes: Do not scale from this drawing. Contractor to take and check all dimensions on site before work commences. Discrepancies to be reported to architect. Subcontractors to verify all dimensions on site before making shop drawings or commencing manufacture. This drawing is copyright.

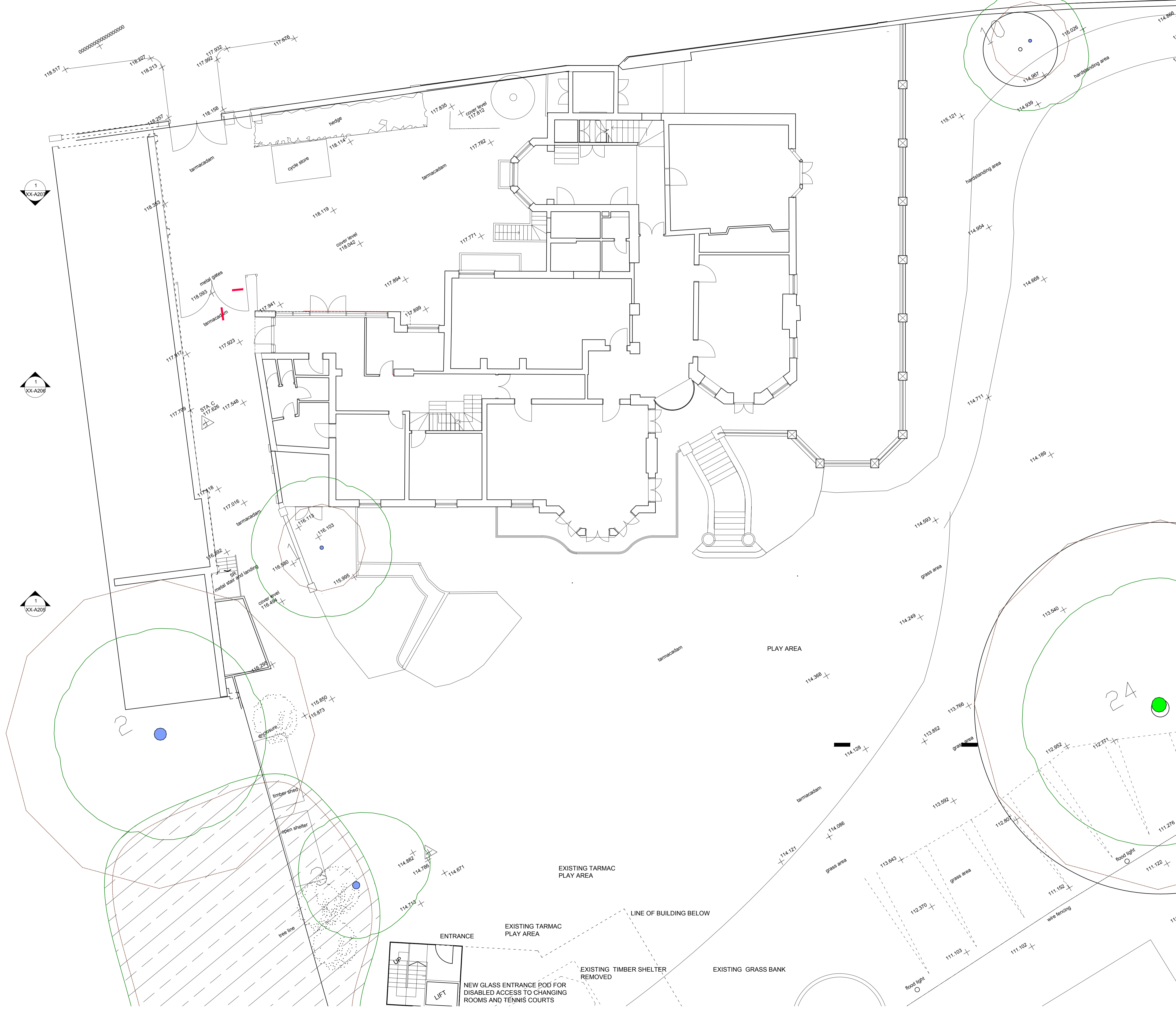
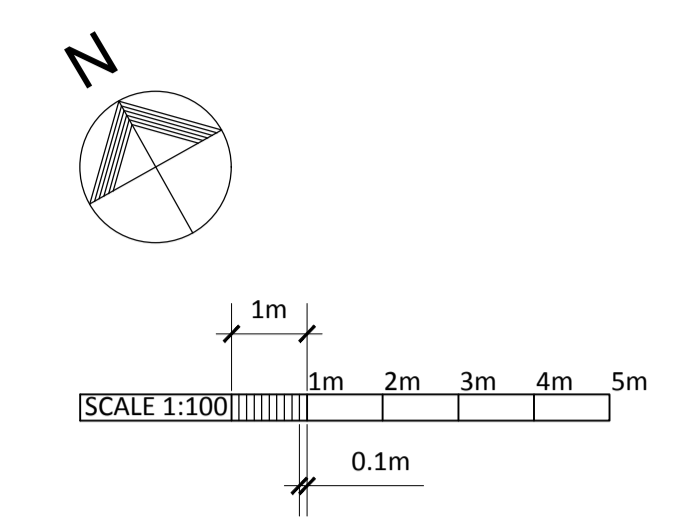

Rev	Description	Date	Initial
A	No Dining Hall	20/07/2018	

PRIME MERIDIAN
Architects and structural engineers

Second Floor T 020 7494 3522 The Priory, Draycott Rd T 01749 34 66 99
26A Ganton Street F 020 7494 3533 Shepton Mallet F 01749 34 66 77
London W1F 7GZ Somerset BA4 5HS www.prime-meridian.co.uk

Client: **CHANNING SCHOOL**

Project: **FAIRSEAT PAVILION AND CLASSROOMS**

Title: **PROPOSED GROUND FLOOR PLAN UNDERCROFT**

Date: 21.07.18
Scale: 1:100@A1
Drawn:

Notes: Do not scale from this drawing. Contractor to take and check all dimensions on site before work commences. Discrepancies to be reported to architect. Subcontractors to verify all dimensions on site before making shop drawings or commencing manufacture. This drawing is copyright.

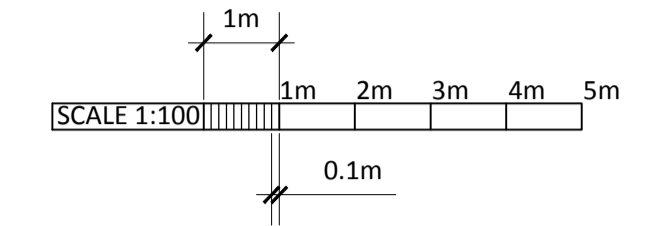
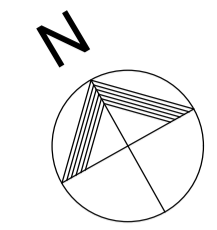

Rev	Description	Date	Initial
A	Dinning Hall Removed	20/07/2018	



Second Floor T 020 7494 3522 The Priory, Draycott Rd T 01749 34 66 99
 26A Ganton Street F 020 7494 3533 Shepton Mallet F 01749 34 66 77
 London W1F 7QZ Somerset BA4 5HS
 info@prime-meridian.co.uk www.primem-meridian.co.uk

Client: **CHANNING SCHOOL**

Project: **FAIRSEAT
NEW PAVILION AND
UNDERCROFT**

Title: **PROPOSED GROUND
FLOOR PLAN
PAVILION**

Date: 24.07.18
Scale: 1:100@A1

No. 343.36/PLA22 A

Notes: Do not scale from this drawing. Contractor to take and check all dimensions on site before work commences. Discrepancies to be reported to architect. Subcontractors to verify all dimensions on site before making shop drawings or commencing manufacture. This drawing is copyright.



WATERLOW PARK

ELEVATION TO WATERLOW PARK FORMAL GARDEN

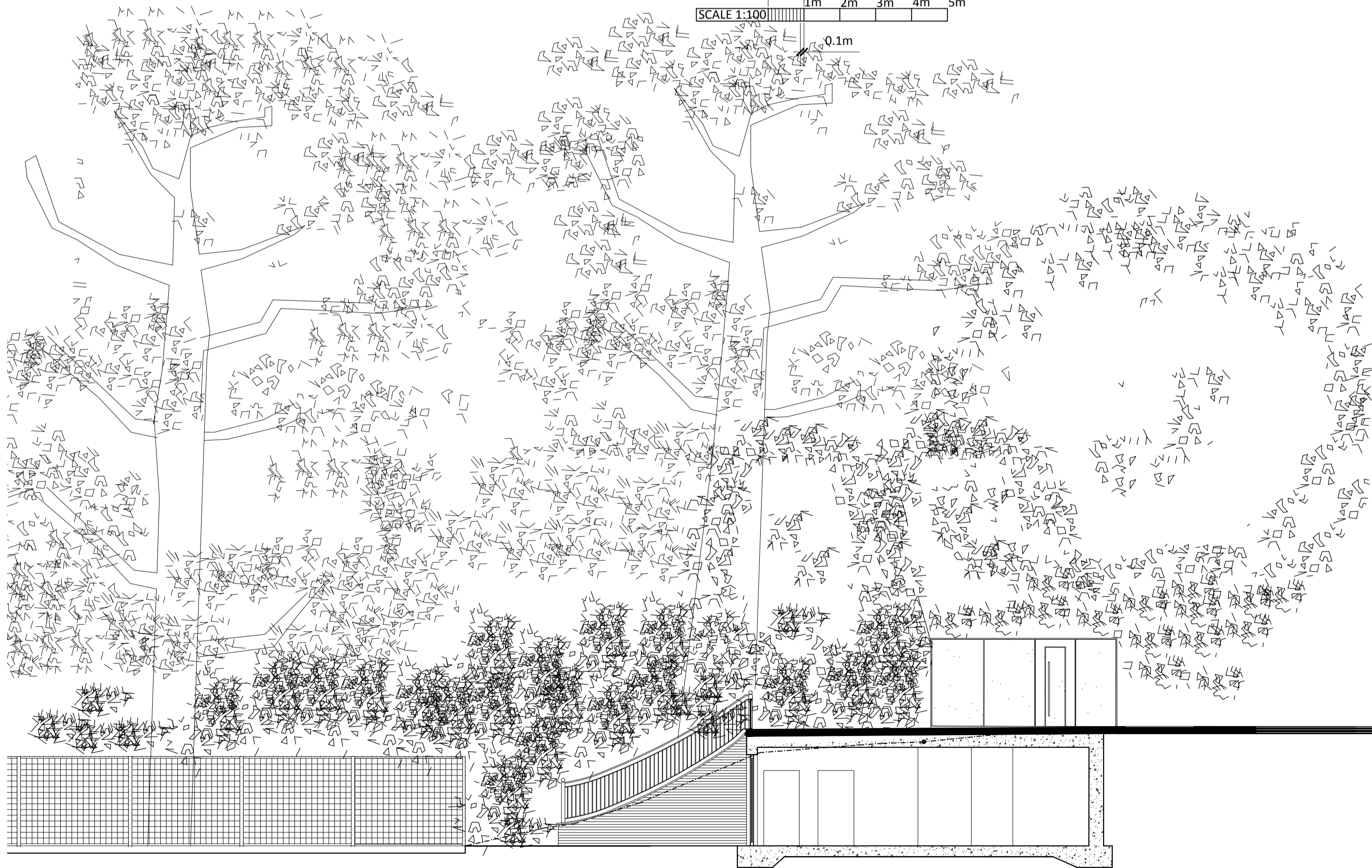
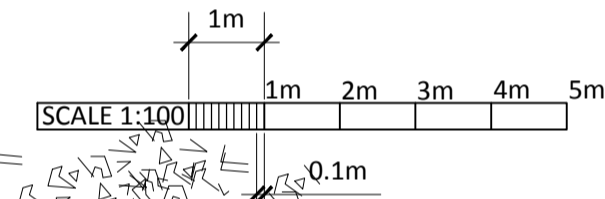

EAST ELEVATION TO PLAY LAWN



Rev	Description	Date	Initial
A	GLASS BOX LOWERED AND HALL REMOVED	24/07/2018	

PRIME MERIDIAN
Architects and structural engineers

Second Floor T 020 7494 3522 The Priory, Draycott Rd T 01749 34 66 99
 26A Ganton Street F 020 7494 3533 Shepton Mallet F 01749 34 66 77
 London W1F 7QZ Somerset BA4 5HS
 info@prime-meridian.co.uk www.primemeridian.co.uk

Client: **CHANNING SCHOOL**

Project: **FAIRSEAT PAVILION CLASSROOMS**

Title: **PROPOSED - PAVILION ELEVATIONS**

Date: 11.12.17
 Scale: 1:100@A1
 Drawn:

Notes: Do not scale from this drawing. Contractor to take and check all dimensions on site before work commences. Discrepancies to be reported to architect. Subcontractors to verify all dimensions on site before making shop drawings or commencing manufacture. This drawing is copyright.

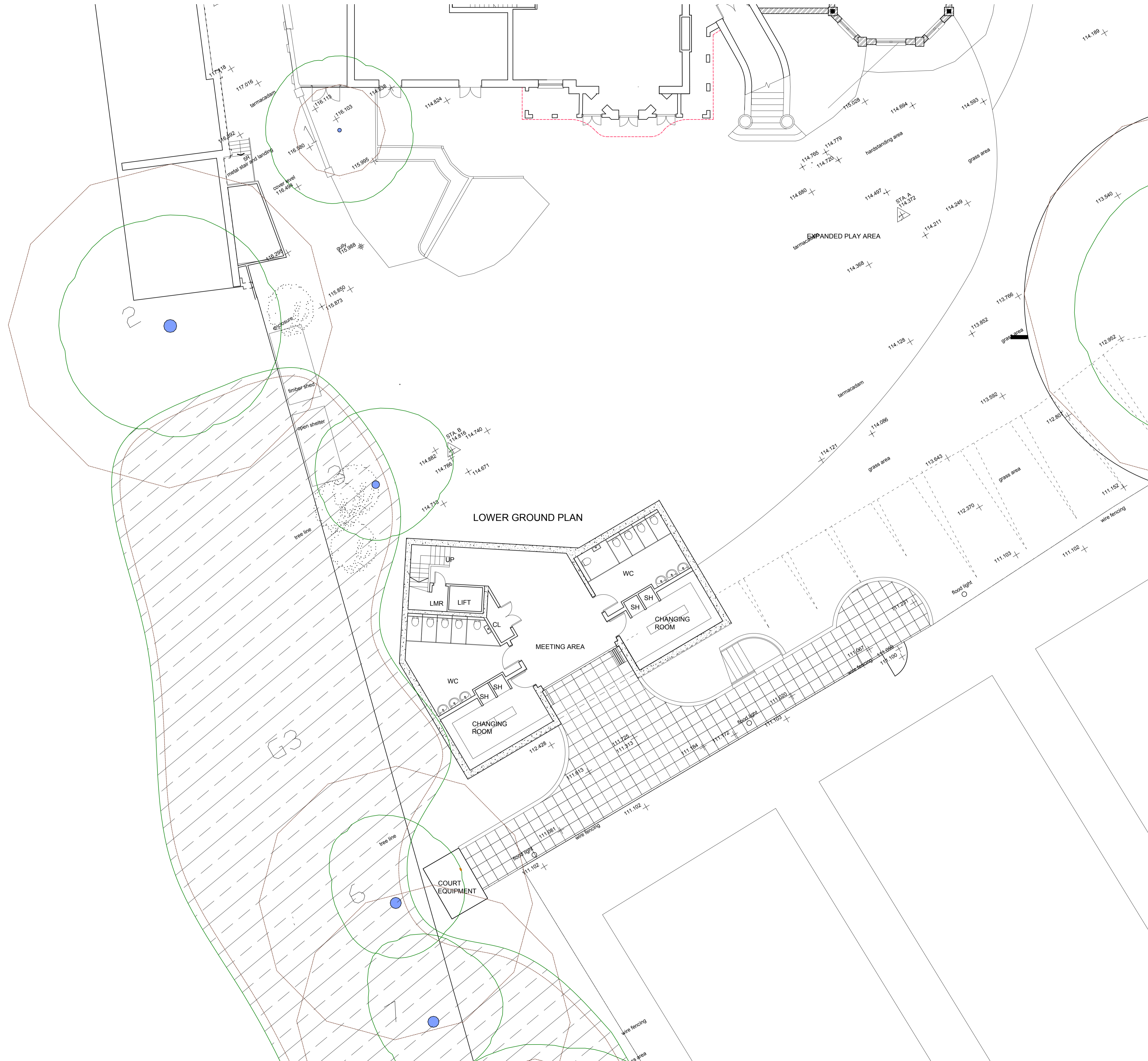
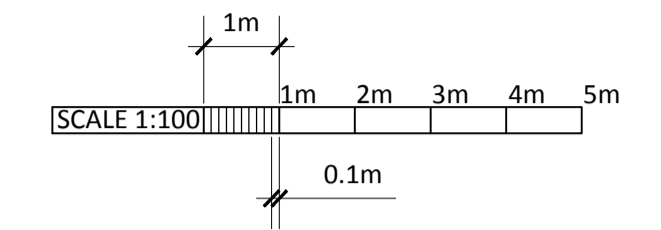
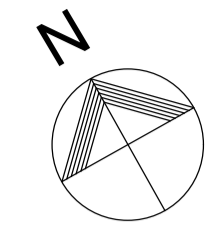

Rev	Description	Date	Initial
A	Dinning Hall Removed	20/07/2018	



Second Floor 25A Canton Street London W1F 7QZ info@prime-meridian.co.uk
 T 020 7494 3522 F 020 7494 3533
 The Priory, Draycott Rd Shepton Mallet Somerset BA4 5HS www.prime-meridian.co.uk
 T 01749 34 66 99 F 01749 34 66 77

Client: **CHANNING SCHOOL**

Project: **FAIRSEAT NEW PAVILION AND UNDERCROFT**

Title: **PROPOSED LOWER GROUND FLOOR PLAN PAVILION**

Date: 24.07.18
 Scale: 1:100@A1
 Drawn: _____
 No. 343.36/PLA23 A