



## Notes

1. DRAWING TO BE READ IN CONJUNCTION WITH FULL SET OF DRAWINGS, SCHEDULES, CONTROL BOOK AND INFORMATION FROM LOCAL ARCHITECT, MECHANICAL ENGINEER, LIGHTING CONSULTANTS & OTHER CONSULTANTS.
2. CONTRACTOR TO CHECK ALL DIMENSIONS ON SITE AND CO-ORDINATE WITH DESIGN TEAM PRIOR TO PRODUCTION OF ANY SHOP DRAWINGS, FABRICATION AND COMMENCEMENT ON SITE.
3. ALL COMPONENTS TO BE BASED ON THE DESIGN INTENT DRAWINGS AND ILLUSTRATION GIVEN AND TO THE DIMENSIONS SHOWN. ANY FURTHER DESIGN DEVELOPMENT TO BE ISSUED BY MANUFACTURER AS DETAILED DRAWINGS AND FINISHES SAMPLES FOR APPROVAL BY DESIGNER PRIOR TO MANUFACTURING AND MUST NOT INFRINGE ANY DESIGN COPYRIGHT.
4. MANUFACTURER TO PROVIDE SHOP DRAWINGS AND FINISHES SAMPLE FOR DESIGNER APPROVAL. REFER TO CONTROL BOOK FOR FIXTURE AND FITTINGS SPECIFICATION.
5. CONTRACTOR TO REFER ALL DISCREPANCIES TO DESIGNER. REFURBISHMENT AND PROTECTION OF EXISTING FEATURES TO BE RETAINED TO BE ASSESSED WITH THE HOTEL AND LOCAL ARCHITECT.
6. ALL WORK TO COMPLY WITH CURRENT BUILDING REGULATIONS. ANY DISCREPANCIES BETWEEN PROPOSALS WITH BUILDING REGULATIONS TO BE REFERRED TO THE DESIGNER AND LOCAL ARCHITECT.
7. TENDER DOCUMENTATION FOR COSTING PURPOSES ONLY. UNLESS MARKED "FOR CONSTRUCTION" DRAWINGS ARE NOT TO BE USED FOR CONSTRUCTION.

ALL DIMENSIONS TO BE  
CHECKED ON SITE

## PLANNING

**ROLLER SHUTTER SPEC:**  
SECURITY DIRECT, SECEUROSHIELD  
CONTINENTAL 75 20G- TUBE MOTOR SOLID  
CURTAIN SHUTTER  
YC750SM 500X160  
YC752SM 600X160

**BAR CLADDING SPEC:**  
BLACKENED STELL FINISH  
TO BE SUPPLIED BY METALL FX  
FINISH TO BE MATT AND SUITABLE FOR  
EXTERNAL USE

**COAT HOOK:**  
CHELSEA CLIP, BLACK, 11050, THE  
CHELSEA CLIP

P2	16/7/18	ROLLERSHUTTER SPECIFICATION
P1	21/05/18	ISSUED FOR CONSTRUCTION

Project

### Casa Pastor Kings Cross

Client

Hart Bros Restaurants

Drawing Title

## External Bar Details Setting Out

Scale	Date Created
<b>Varies</b>	<b>17.11.17</b>

Drawing Number  
**17007-305**

Revision	Revision Date
<b>P2</b>	<b>16.07.18</b>

Drawn By  
**AG**

Checked By  
**MC**

Do not scale from drawing, all dimensions to be checked on site. Report omissions and discrepancies to the architect immediately



**Michaelis Boyd Associates**  
108 Palace Gardens Terrace  
London W8 4RT

44 20 7221 1237  
hello@michaelisboyd.com  
michaelisboyd.com



This grille has been designed to match the blackened steel finish of the bar structure (RAL 9005). It will be plain. The shutters will only be down post 'clean down' each night until the morning team arrive. This is roughly 1.30/2am until 6am.





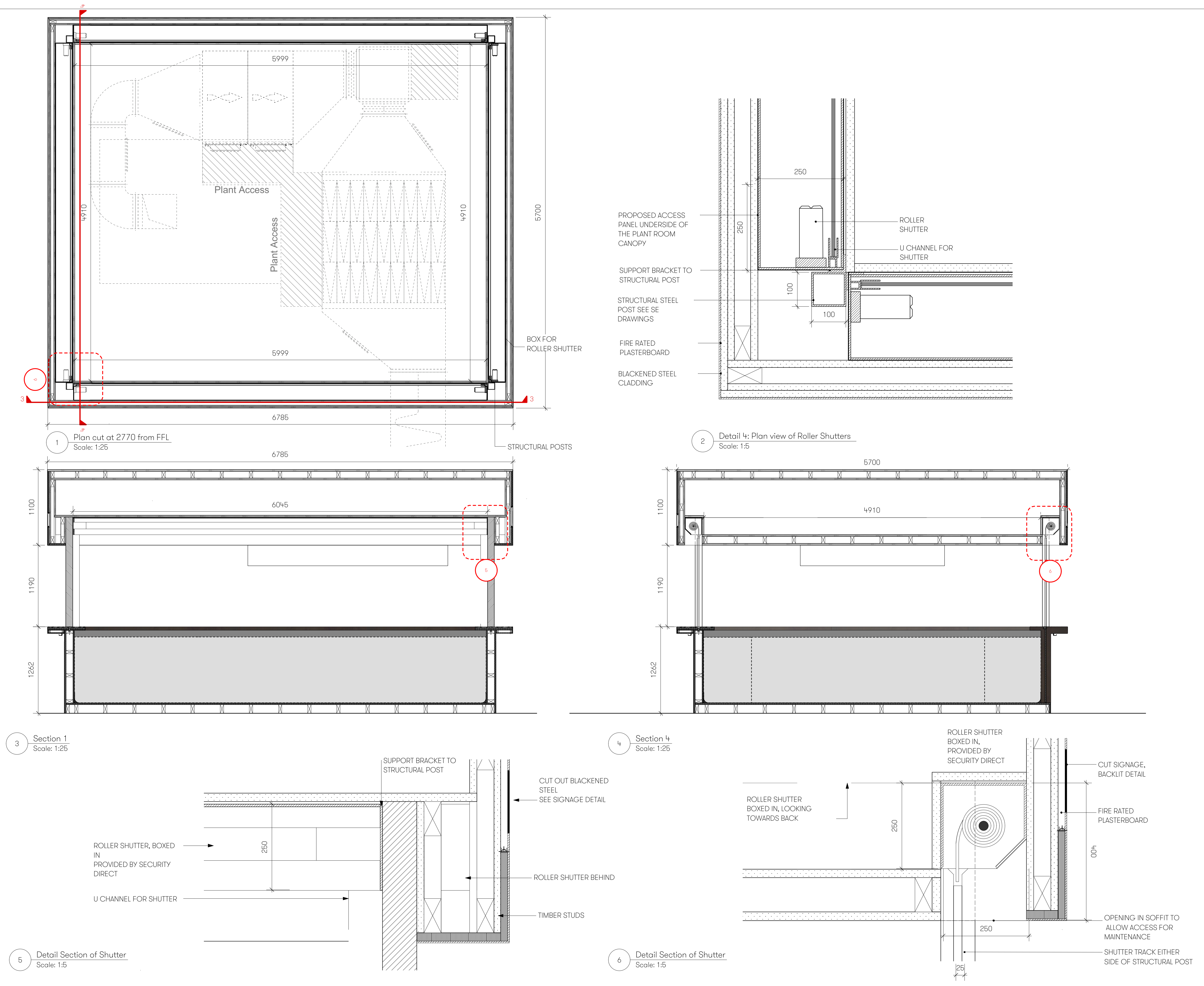

- Notes
- DRAWING TO BE READ IN CONJUNCTION WITH FULL SET OF DRAWINGS, SCHEDULES, CONTROL BOOK AND INFORMATION FROM LOCAL ARCHITECT, MECHANICAL ENGINEER, LIGHTING CONSULTANTS & OTHER CONSULTANTS.
  - CONTRACTOR TO CHECK ALL DIMENSIONS ON SITE AND CO-ORDINATE WITH DESIGN TEAM PRIOR TO PRODUCTION OF ANY SHOP DRAWINGS, FABRICATION AND COMMENCEMENT ON SITE.
  - ALL COMPONENTS TO BE BASED ON THE DESIGN INTENT DRAWINGS AND ILLUSTRATION GIVEN AND TO THE DIMENSIONS SHOWN. ANY FURTHER DESIGN DEVELOPMENT TO BE ISSUED BY MANUFACTURER AS DETAILED DRAWINGS AND FINISHES SAMPLES FOR APPROVAL BY DESIGNER PRIOR TO MANUFACTURING AND MUST NOT INFRINGE ANY DESIGN COPYRIGHT.
  - MANUFACTURER TO PROVIDE SHOP DRAWINGS AND FINISHES SAMPLE FOR DESIGNER APPROVAL. REFER TO CONTROL BOOK FOR FIXTURE AND FITTINGS SPECIFICATION.
  - CONTRACTOR TO REFER ALL DISCREPANCIES TO DESIGNER. REFURBISHMENT AND PROTECTION OF EXISTING FEATURES TO BE RETAINED TO BE ASSESSED WITH THE HOTEL AND LOCAL ARCHITECT.
  - ALL WORK TO COMPLY WITH CURRENT BUILDING REGULATIONS. ANY DISCREPANCIES BETWEEN PROPOSALS WITH BUILDING REGULATIONS TO BE REFERRED TO THE DESIGNER AND LOCAL ARCHITECT.
  - TENDER DOCUMENTATION FOR COSTING PURPOSES ONLY. UNLESS MARKED 'FOR CONSTRUCTION' DRAWINGS ARE NOT TO BE USED FOR CONSTRUCTION.

## PLANNING

**ROLLER SHUTTER SPEC:**  
SECURITY DIRECT, SECEUROSHIELD  
CONTINENTAL 75 20G- TUBE MOTOR SOLID  
CURTAIN SHUTTER  
YC750SM 500X160  
YC752SM 600X160

**BAR CLADDING SPEC:**  
BLACKENED STEEL FINISH  
TO BE SUPPLIED BY METALL FX  
FINISH TO BE MATT AND SUITABLE FOR  
EXTERNAL USE

**COAT HOOK:**  
CHELSEA CLIP, BLACK, 11050, THE  
CHELSEA CLIP

P2 16/7/18 ROLLER SHUTTER  
SPECIFICATION

P1 21/05/18 ISSUED FOR PLANNING

Project

Casa Pastor Kings Cross

Client

Hart Bros Restaurants

Drawing Title

External Bar Details  
Roller Shutters

Scale	Date Created
Varies	18.01.18

Drawing Number  
17007-306 P

Revision	Revision Date
P2	16.07.18

Drawn By	Checked By
AG	MC

Do not scale from drawing, all dimensions to be checked on site. Report omissions and discrepancies to the architect immediately

**M B**

**Michaelis Boyd Associates**  
108 Palace Gardens Terrace  
London W8 4RT

44 20 7221 1237  
hello@michaelisboyd.com  
michaelisboyd.com

# YC752SM 600X160 SPECIFICATION

## ITEM. 1 – DOOR 1

### SeceuroShield Continental 75 22g - Tube Motor Shutter (YC752SM)



### Configuration Summary

Clear Opening Width	5819	Overall Width	5999
Clear Opening Height	1290	Overall Height	1590
Drive End	Left	Fitting	Internal
End-plate Size	250	Channel	UPH250
Bottom Lath Height	50.00	Left Guide Length	1340
Visible Lath Count	17	Right Guide Length	1340
Drive Type	SeceuroDrive 240v 100Nm tube motor option with override - Standard Safety brake not required with this configuration. – Rigid extension override eye with 1100mm crook handle (exit: F)		
Shutter Application	Window		
Drive End Fitment	Reveal fitting		
Non-Drive End Fitment	Reveal fitting		

### Options & Accessories

#### Manual Override

Rigid extension override eye with 1100mm crook handle

#### Channel

UPH250

#### Bottom Lath

T rail

#### Control

Somfy Inis Uno single pole switch

#### Canopy

Hood – 3 faced front cover

Fascia – 2 faced back cover

#### Curtain

Solid

#### Colours

Curtain  Standard: Black (RAL9005) – Satin

Bottom Lath  Standard: Black (RAL9005) – Satin

Box Assembly  Standard: Black (RAL9005) – Satin

Channels  Standard: Black (RAL9005) – Satin

# YC752SM 600X160 PLAN DRAWING

ITEM. 1 – DOOR 1

SeceuroShield Continental 75 22g - Tube Motor Shutter (YC752SM)

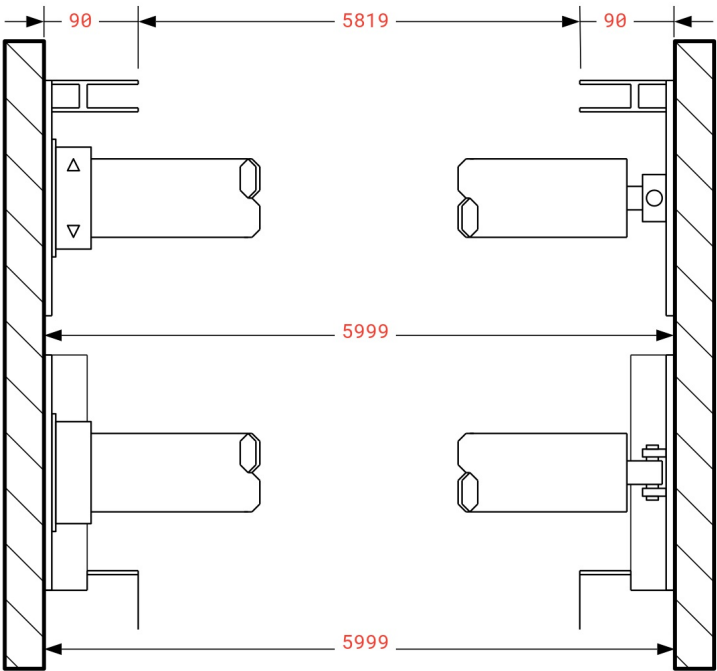

11954 | YC752SM

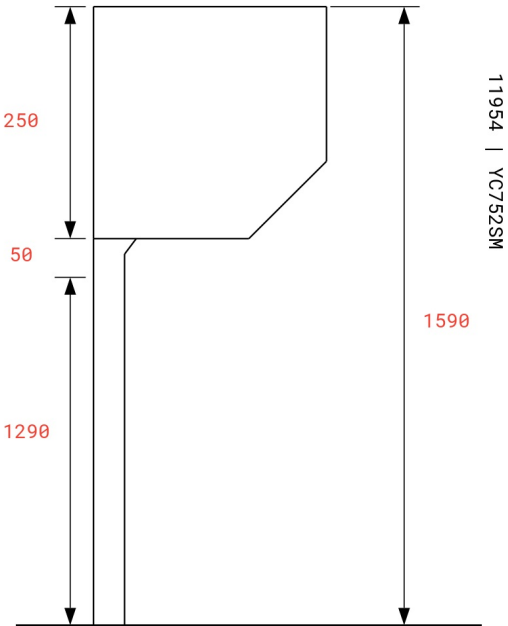

# YC750SM 500X160 SPECIFICATION

## ITEM. 2 – DOOR 2A

### SeceuroShield Continental 75 20g - Tube Motor Shutter (YC750SM)



### Configuration Summary

Clear Opening Width	4730	Overall Width	4910
Clear Opening Height	1290	Overall Height	1590
Drive End	Left	Fitting	Internal
End-plate Size	250	Channel	UPH250
Bottom Lath Height	50.00	Left Guide Length	1340
Visible Lath Count	17	Right Guide Length	1340
Drive Type	SeceuroDrive 240v 100Nm tube motor option with override - Standard Safety brake not required with this configuration. – Rigid extension override eye with 1100mm crook handle (exit: F)		
Shutter Application	Window		
Drive End Fitment	Reveal fitting		
Non-Drive End Fitment	Reveal fitting		

### Options & Accessories

#### Manual Override

Rigid extension override eye with 1100mm crook handle

#### Channel

UPH250

#### Bottom Lath

T rail

#### Control

Somfy Inis Uno single pole switch

#### Canopy

Hood – 3 faced front cover

Fascia – 2 faced back cover

#### Curtain

Solid

#### Colours

Curtain  Standard: Black (RAL9005) – Satin

Bottom Lath  Standard: Black (RAL9005) – Satin

Box Assembly  Standard: Black (RAL9005) – Satin

Channels  Standard: Black (RAL9005) – Satin

# YC750SM 500X160 PLAN DRAWING

ITEM. 2 – DOOR 2A

SeceuroShield Continental 75 20g - Tube Motor Shutter (YC750SM)

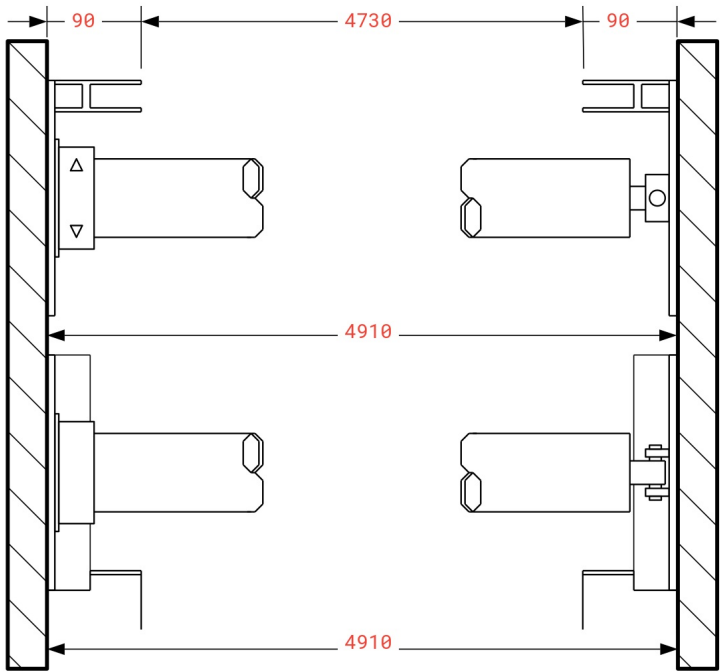

11954 | YC750SM

