

FP BRAINSTORM - 2ND FLOOR - FLOOR PLAN
1:25

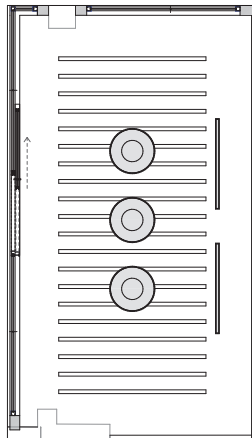

BCP BRAINSTORM - BASEMENT - FLOOR PLAN
1:25

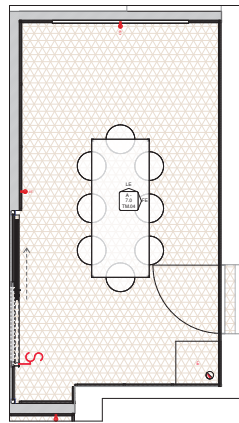

FP BRAINSTORM - BASEMENT - FLOOR PLAN
1:25

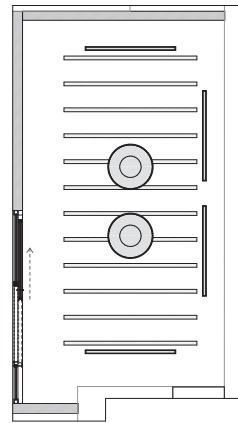

BCP BRAINSTORM - BASEMENT - FLOOR PLAN
1:25

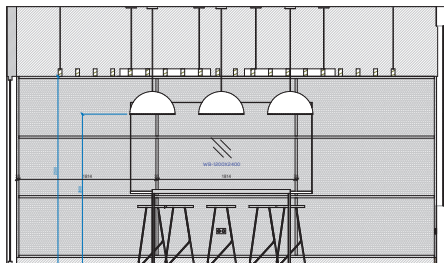

FE BRAINSTORM - 2ND FLOOR - FRONT ELEVATION
1:25

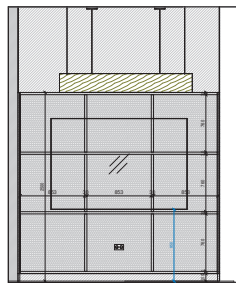

LE BRAINSTORM - BASEMENT - LEFT ELEVATION
1:25

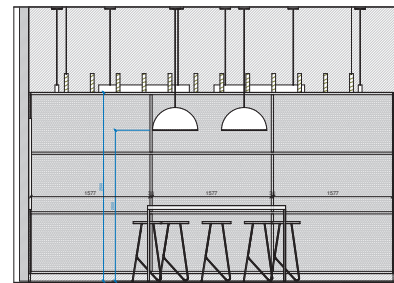

FE BRAINSTORM - BASEMENT - FRONT ELEVATION
1:25

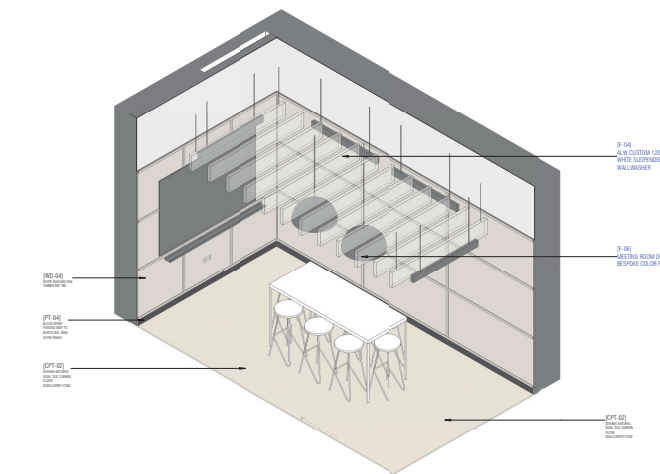
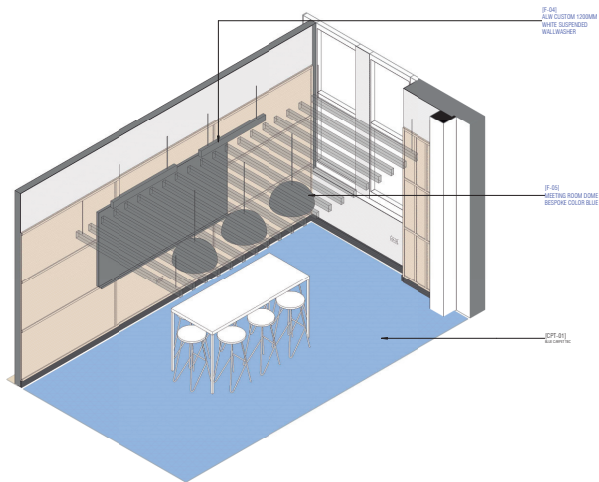

BASEMENT - SCHEME B

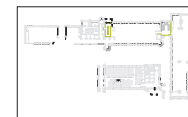

GROUND FLOOR - SCHEME A



1ST FLOOR - SCHEME B



2ND FLOOR - SCHEME A



4TH FLOOR - SCHEME B



5TH FLOOR - SCHEME A

1. WHEN SETTING OUT CARPETS AND TILES ALWAYS BEGIN LAYING WITH A FULL TILE AT FRONT OF ROOM OR MAIN SIZE OF WALL OR FLOOR.
2. ALL EXPOSED JOINT IN PLYWOOD MUST BE MITERED.
3. ALL CABINET DOOR MUST HAVE FINGER PULL DETAIL.

Client: **wework**

Project: **LONDON 1 Waterhouse Sq**

Address: **Waterhouse SQ 1, LONDON**

Client's representative:
 Wework
 Signature: _____

B ISSUE FOR CONSTRUCTION - FULL PACK 18/07/16
 A ISSUE FOR TENDER 18/06/16

Rev. Description Date

labit group
 Avda de America 52 E. Interguadalupe
 28002 Madrid W. wework.com
 Spain T. +34 915 103 033

Architect: **Elvira Conajero Crespo**

Signature: _____

Job No.: **LB-PB-WW-18**

Scale: **As Indicated@A0**

Title: **BRAINSTORM**

Sheet: **A - 7.0 TM.04** Rev. **B**

